

GRIPPS®

GRIPPS® Technical Specification Sheet.

GRIPPS® Tethering Station Models: H01145, H01147, H01147-RC



H01145
Grippls Tethering Station - 25T
Max Load (D-Ring): 1KG / 2.2lbs

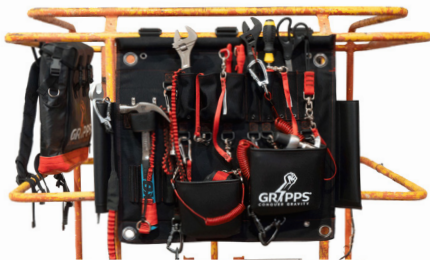

H01147 / H01147-RC
Grippls Tethering Station - 20T - 1.0kg /
Grippls Tethering Station - 20T Rain Cover
Max Load (D-Ring): 1.0kg / 2.2lbs

FOR PRODUCT SUPPORT CONTACT:

support@gripps.com | +61 3 8383 9458

WWW.GRIPPS.COM

GRIPPS® Tethering Station

SAFETY INFORMATION

⚠️ WARNING Before using the GRIPPS® Tethering Station, read all provided safety information pertaining to the use of your Dropped Tool Prevention (DTP) device. **FAILURE TO DO SO COULD RESULT IN INJURY OR DEATH.**

The user of a DTP device bears the responsibility of reading all safety information contained herein. Keep this manual for future reference.

Intended Use:

When used properly, the GRIPPS® Tethering Station can prevent workplace hazards resulting from dropped tools. These may include personal injury and material damage.

GRIPPS® does not approve use of this device for any activities not described in the User Instructions. This device is not intended to be used in any recreational activity, as a personal fall-arrest device or in any other manner not described herein.

⚠️ WARNING Misuse of this device could result in serious injury or death.

Adhere to all manufacturer recommendations regarding the operation and maintenance of this device. For additional information, contact GRIPPS® customer support.

Read and adhere to the following in order to ensure correct operational functionality:

- Your DTP should never be used as a personal fall-arrest device or restraint system.
- Do not use this device with tools that exceed the specified maximum load/weight.
- A DTP device used in applications that exceed the limits of operation specified by the manufacturer should be considered unsafe and should be replaced.
- Do not tether a tool over 2.5kg/5.5lbs directly to your clothing or person.
- Inspect your DTP device before each use.
- Ensure the DTP device is securely connected to a load rated tool connector or anchor point before use.
- Inspect any tool connector point before it is connected to the DTP device.
- Modification of the DTP device voids all warranties and violates manufacturer recommendations.
- Do not use a tool that cannot be connected to your DTP in the manner specified by GRIPPS®.
- It is unsafe to extend the length of the DTP product by any means.
- Do not use this product if it will create an unsafe working environment.
- Use extra precaution around moving machinery, moving parts, electrical hazards, extreme temperatures, chemical hazards, or combustion hazards.
- Avoid contact between the Coil Hard Hat Tether and rough or sharp edges.
- All connected tools and equipment, including connection points, must be compatible for use with this DTP device.
- Always wear appropriate personal protective equipment.

- If a tether has arrested a dropped tool or object, it should be taken out of service and replaced.
- All procedures shown in this instruction are for GRIPPS® Coil Hard Hat Tether products only.

GENERAL USE AND CARE

The GRIPPS® Tethering Station is a fully functional mobile tethering workstation suitable for various environments. They are constructed from extra heavy-duty 26oz. canvas, the minimal and isolated use of metals, and non-conductive tether anchors make the GTS safe for works around live electricity. Attach the GTS to scaffold tubes, handrails or EWP cages for all works at height using the load-rated and hard-wearing straps. Reinforced eyelets allow the GTS to be hung via hooks or tied off with rope to suit virtually any other conceivable environment.

Recommended Use of GRIPPS® Tethering Station:

1. Apply all three straps when in use at heights.
2. Use the four corner eyelets to tie down the GTS when in use at heights.

Before Use:

Thoroughly inspect your GRIPPS® DTP device before each use. Do not use any component that presents deformities or deterioration.

HOW TO USE / INSTRUCTIONS:

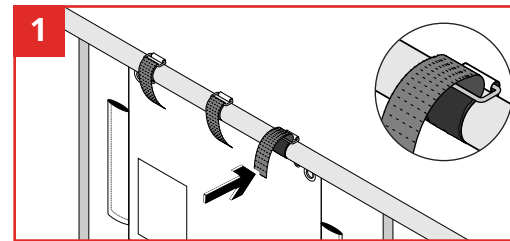

To attach to a rail, wrap straps around tube and feed back through the buckle.

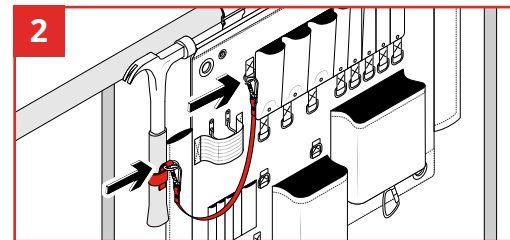

Ensure all tools are connected to an anchor point using an appropriate GRIPPS® load-rated tether.

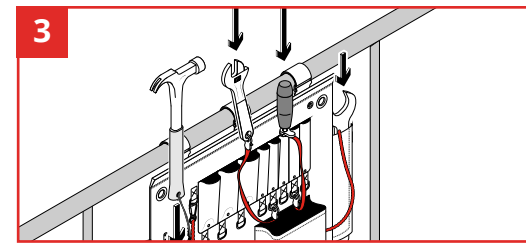

Insert tools into pockets for storage.

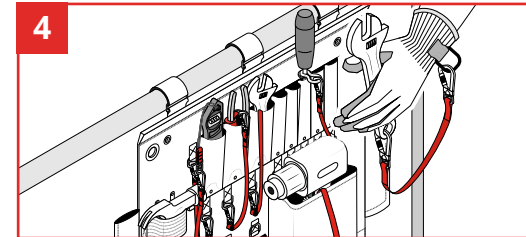

Before removing a tool, connect the tether to a suitable anchor point such as a GRIPPS® Glove or Belt-Loop Anchor.

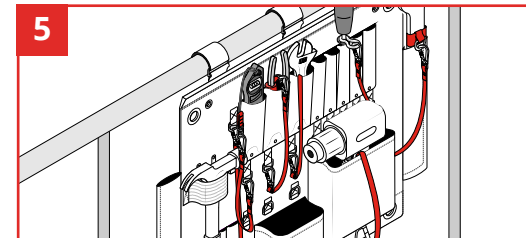

When you no longer need the tool, place back into the GTS pouch, reattaching the tether to an anchor point.

After Use Care:

Clean and inspect the Tethering Station. For tougher stains, use warm water and a mild soap or detergent. Do not use again until dry.

Store in a clean and dry environment. Proper care will help to ensure that it will operate effectively and extend its service.

GRIPPS®



linkedin.com/company/grippsglobal



facebook.com/grippsglobal



youtube.com/@gripps3480grippsglobal



instagram.com/grippsglobal