

GRIPPS®

GRIPPS Technical Specification Sheet:

GRIPPS® Tool Grapple®
Models: H01123, H01122-C



H01123
Tool Grapple® With Auto-Stop
Max Load: 2.5kg / 5.5lbs
Max Length: 1.25m / 49"



H01122
Tool Grapple® With Dual Locking Carabiner
Max Load: 2.5kg / 5.5lbs
Max Length: 1.25m / 49"

FOR PRODUCT SUPPORT CONTACT:

support@gripps.com | +61 3 8383 9458

WWW.GRIPPS.COM

GRIPPS® Tool Grapple®

SAFETY INFORMATION

⚠️ WARNING Before using the GRIPPS® Tool Grapple®, read all provided safety information pertaining to the use of your Dropped Tool Prevention (DTP) device. **FAILURE TO DO SO COULD RESULT IN INJURY OR DEATH.**

The user of a DTP device bears the responsibility of reading all safety information contained herein. Keep this manual for future reference.

Intended Use:

When used properly, the GRIPPS® Tool Grapple® can prevent workplace hazards resulting from dropped tools. These may include personal injury and material damage.

GRIPPS® does not approve use of this device for any activities not described in the User Instructions. This device is not intended to be used in any recreational activity, as a personal fall-arrest device or in any other manner not described herein.

⚠️ WARNING Misuse of this device could result in serious injury or death.

Adhere to all manufacturer recommendations regarding the operation and maintenance of this device. For additional information, contact GRIPPS® customer support.

Read and adhere to the following in order to ensure correct operational functionality:

- Your DTP should never be used as a personal fall-arrest device or restraint system.
- Do not use this device with tools that exceed the specified maximum load/weight.
- A DTP device used in applications that exceed the limits of operation specified by the manufacturer should be considered unsafe and should be replaced.
- Do not tether a tool over 2.5kg/5.5lbs directly to your clothing or person.
- Inspect your DTP device before each use.
- Ensure the DTP device is securely connected to a load rated tool connector or anchor point before use.
- Inspect any tool connector point before it is connected to the DTP device.
- Modification of the DTP device voids all warranties and violates manufacturer recommendations.
- Do not use a tool that cannot be connected to your DTP in the manner specified by GRIPPS®.
- It is unsafe to extend the length of the DTP product by any means.
- Do not use this product if it will create an unsafe working environment.
- Use extra precaution around moving machinery, moving parts, electrical hazards, extreme temperatures, chemical hazards, or combustion hazards.
- Avoid contact between the E-Tether and rough or sharp edges.
- All connected tools and equipment, including connection points, must be compatible for use with this DTP device.
- Always wear appropriate personal protective equipment.

- If a tether has arrested a dropped tool or object, it should be taken out of service and replaced.
- All procedures shown in this instruction are for GRIPPS® Tool Grapple® product only.

GENERAL USE AND CARE

The GRIPPS® Tool Grapple® is designed to provide a compact tethering solution for most handheld tools. The load rated synthetic housing allows the Tool Grapple® to be mounted to a belt or harness.

Recommended Use of GRIPPS® Tool Grapple®:

1. Use for tools under 2.5kg/5.0lbs
2. When anchoring to Belts or Harnesses, inspect the material to ensure there is no visible damage or fraying.

Before Use:

Thoroughly inspect your GRIPPS® DTP device before each use. Do not use any component that presents deformities or deterioration. Before use: Thoroughly clean tool of any soiling and grease prior to application

HOW TO USE / INSTRUCTIONS:

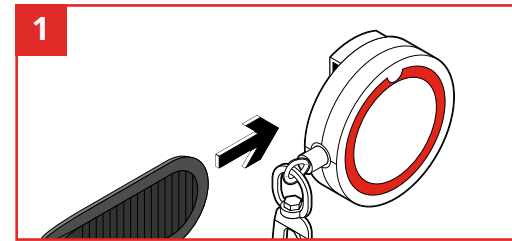

Slide belt through belt housing. If that is not possible, then unscrew the belt cover from the Tool Grapple® housing.

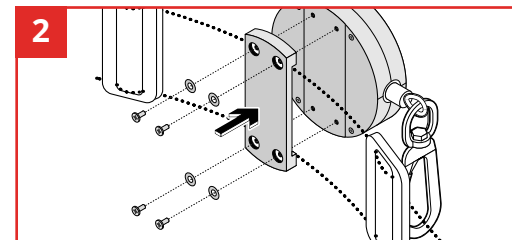

Place harness or belt on Tool Grapple then screw the belt cover back on. Ensure the position of the Tool Grapple® does not interfere with the functionality of the harness.

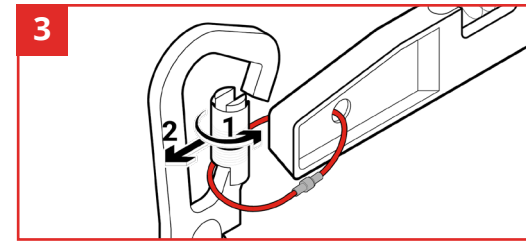

Connect the Tool Grapple® carabiner to your tool.

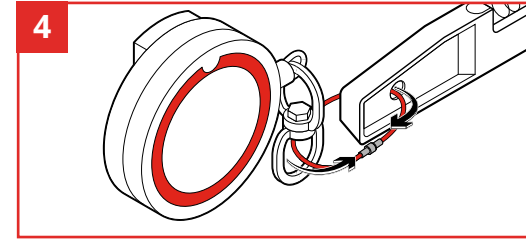

For the Auto-Stop unit, pass a Gripplock Cable or Screwlock Cable through the spare D-Ring and fasten the Cable.

After Use Care:

Clean and inspect the Tool Grapple® and connected tool. For tougher stains, use warm water and a mild soap or detergent. Do not use again until dry.

Store in a clean and dry environment. Proper care will help to ensure that it will operate effectively and extend its service.

GRIPPS®

linkedin.com/company/grippsglobal

facebook.com/grippsglobal

youtube.com/@gripps3480grippsglobal

instagram.com/grippsglobal