

GRIPPS®

GRIPPS Technical Specification Sheet:

GRIPPS® Lifting Bag Insert Models: H01109

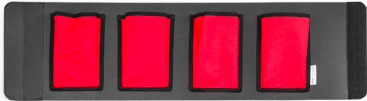

H01109
Lifting Bag Insert
Size: 93cm x 27cm x 4.0mm | 37" x 11" x 0.15"
Diameter Range: 27cm - 29cm | 10" - 11"

FOR PRODUCT SUPPORT CONTACT:

support@gripps.com | +61 3 8383 9458

WWW.GRIPPS.COM

GRIPPS® Lifting Bag Insert

SAFETY INFORMATION

⚠️ WARNING Before using the GRIPPS® Lifting Bag Insert, read all provided safety information pertaining to the use of your Dropped Tool Prevention (DTP) device. **FAILURE TO DO SO COULD RESULT IN INJURY OR DEATH.**

The user of a DTP device bears the responsibility of reading all safety information contained herein. Keep this manual for future reference.

Intended Use:

When used properly, the GRIPPS® Lifting Bag Insert can prevent workplace hazards resulting from dropped tools. These may include personal injury and material damage.

GRIPPS® does not approve use of this device for any activities not described in the User Instructions. This device is not intended to be used in any recreational activity, as a personal fall-arrest device or in any other manner not described herein.

⚠️ WARNING Misuse of this device could result in serious injury or death.

Adhere to all manufacturer recommendations regarding the operation and maintenance of this device. For additional information, contact GRIPPS® customer support.

Read and adhere to the following in order to ensure correct operational functionality:

- Your DTP should never be used as a personal fall-arrest device or restraint system.
- Do not use this device with tools that exceed the specified maximum load/weight.
- A DTP device used in applications that exceed the limits of operation specified by the manufacturer should be considered unsafe and should be replaced.
- Do not tether a tool over 2.5kg/5.5lbs directly to your clothing or person.
- Inspect your DTP device before each use.
- Ensure the DTP device is securely connected to a load rated tool connector or anchor point before use.
- Inspect any tool connector point before it is connected to the DTP device.
- Modification of the DTP device voids all warranties and violates manufacturer recommendations.
- Do not use a tool that cannot be connected to your DTP in the manner specified by GRIPPS®.
- It is unsafe to extend the length of the DTP product by any means.
- Do not use this product if it will create an unsafe working environment.
- Use extra precaution around moving machinery, moving parts, electrical hazards, extreme temperatures, chemical hazards, or combustion hazards.
- Avoid contact between any connected tethers and rough or sharp edges.
- Regularly inspect the Velcro on the Bolt-Vault to ensure it is free from any dust, grime or debris.
- All connected tools and equipment, including connection points, must be compatible for use with this DTP device.

- Always wear appropriate personal protective equipment.
- If a tether has arrested a dropped tool or object, it should be taken out of service and replaced.
- All procedures shown in this instruction are for GRIPPS® Lifting Bag Insert products only.

GENERAL USE AND CARE

Instantly transform your GRIPPS® Lifting Bag into a workable tool bag with the GRIPPS® Lifting Bag Insert.

Compatible with all GRIPPS® Lifting Bags, this heavy-duty Nylon insert holds the lifting bag open and provides multiple pockets for tool organisation.

Before Use:

Thoroughly inspect your GRIPPS® DTP device before each use. Do not use any component that presents deformities or deterioration.

HOW TO USE / INSTRUCTIONS:

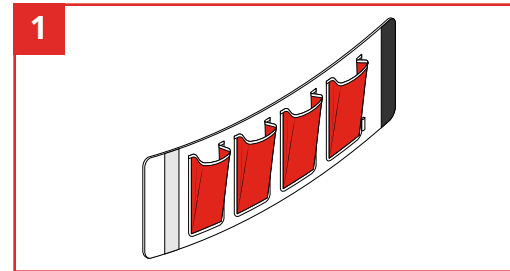

Lay out Lifting Bag insert and begin to flex into a circular shape, keeping pockets on the inside of the ring created.

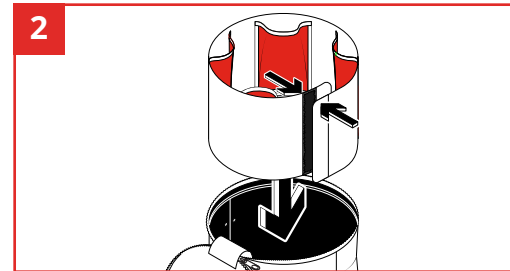

Open tool bag and insert Lifting Bag Insert in main compartment, bending as required. Ensure velcro edges are joined evenly and overlaps.

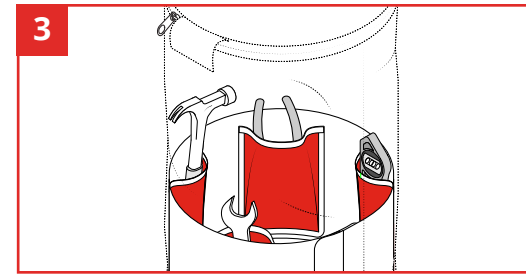

Insert tools as desired into pockets. Tool bag should not be tipped upside down at any point.

After Use Care:

Clean and inspect the Lifting Bag and any connected tethers. For tougher stains, use warm water and a mild soap or detergent. Do not use again until dry.

Store in a clean and dry environment. Proper care will help to ensure that it will operate effectively and extend its service.

GRIPPS®



linkedin.com/company/grippsglobal



facebook.com/grippsglobal



youtube.com/@gripps3480grippsglobal



instagram.com/grippsglobal