

GRIPPS®

H02105 BOLT-VAULT

The Bolt-Vault is designed to mitigate the risk of small objects used during live-edge works. The patented design creates a protected environment around the wearer's hand, while two reinforced interlace panels allow for the insertion of tools and working applications (such as bolt threads).

Constructed from heavy-duty nylon, the Bolt-Vault has been strenuously tested in commercial environments to guarantee a long life under harsh working conditions. The tactical nylon weave allows tools and other objects to come into the working environment while maintaining the integrity of the drop protection zone.

The Bolt-Vault is secured to the wrist with industrial-grade Velcro and features two integrated and fully load rated tether anchor points, allowing the user to attached tools of up to 2.5kg/5.0lbs each directly to the Bolt- Vault itself.



5.0 LB **2.5** KG

MAX LOAD:



THE LEADER IN FALLING OBJECT PREVENTION

GRIPPS.COM

KEY FEATURES



HOW TO USE

1

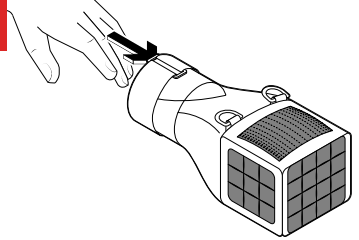

Place hand inside Bolt-Vault, firmly strapping around the wrist by feeding the strap through the buckle and pulling tight.

2

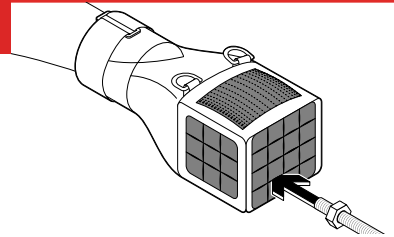

Attach or disconnect fasteners by pushing the bolt through either of the nylon weave panels.

3

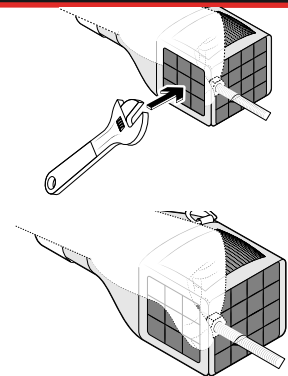

Tools such as a spanner can be inserted into the secondary nylon weave panel if needed to loosen nuts or bolts.

*** NEVER EXCEED MAX LOAD ***

SPECIFICATIONS

SKU	MAX LOAD (D-RING)	MAX LOAD (POUCH)	DIMENSION
H02105	2.5KG 5.0LBS	2.5KG 5.0LBS	13CM x 11CM x 25CM 5.0" x 4.25" x 10"

@GRIPPSGLOBAL



#ConquerGravity