

# GRIPPS®

## H01079 WEBBING TETHER EXTRA HEAVY DUTY DUAL-ACTION - 36.9KG

*Engineered for superior performance at height, the Webbing Tether Extra Heavy-Duty Dual-Action is load rated to a massive 36.9kg/81lbs.*

A dual-action carabiner at each end enables tethering to a variety of anchor points and tool tether points, including scaffolding and rails, allowing you to work with heavy tools safely at height.

- Two Dual-Action Carabiners
- Huge maximum load rating



**81.0<sub>LB</sub> 36.9<sub>KG</sub>**

**MAX LOAD:**



THE LEADERS IN FALLING OBJECT PREVENTION

GRIPPS.COM

# GRIPPS®

## KEY FEATURES

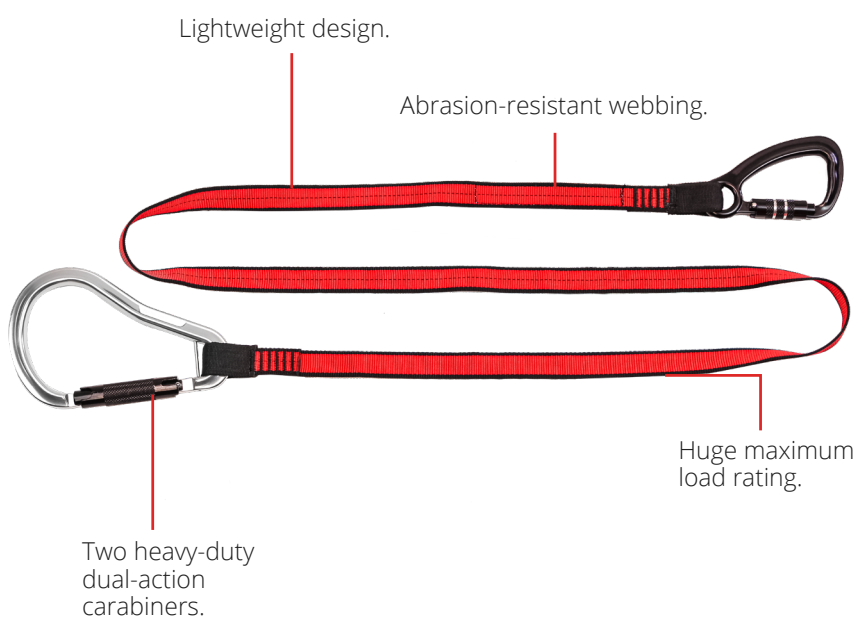

## HOW TO USE

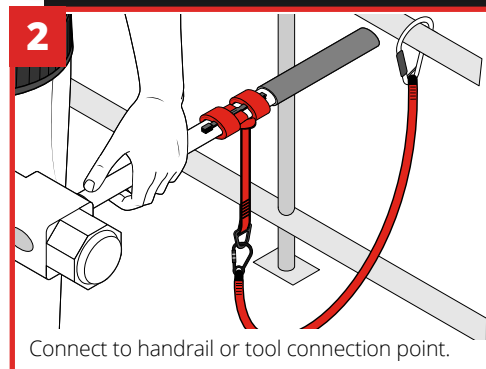
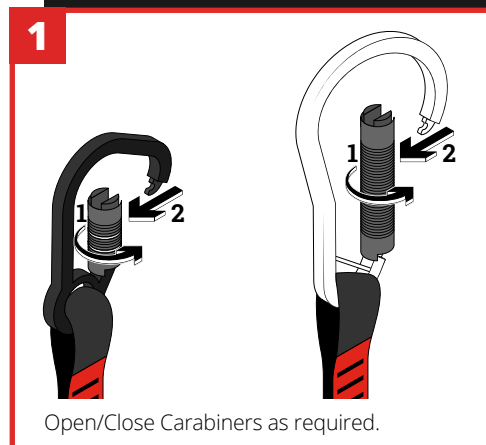

## SPECIFICATIONS

SKU	MAX LOAD	LENGTH
H01079	36.9KG   81.0LBS	1.8M   71"

@GRIPPSGLOBAL



#ConquerGravity