

GRIPPS®

ANSI/ISEA
121-2018
COMPLIANT

H01071 BUNGEE HEAVY-DUTY TETHER DUAL-ACTION - 18.0KG

40.0^{LB} 18.0^{KG}

MAX LOAD:

Designed for heavy tools, the Bungee Tether Heavy-Duty Dual-Action features an over-sized dual-action carabiner, elasticized webbing made from heavy-duty polyester and a hi-vis wide tail loop with additional grip-weave to fasten securely to tools or anchor points.

Along with being incredibly lightweight, the elastic properties of the durable bungee material absorbs the downward force from a dropped tool.



THE LEADERS IN FALLING OBJECT PREVENTION

GRIPPS.COM

KEY FEATURES



HOW TO USE

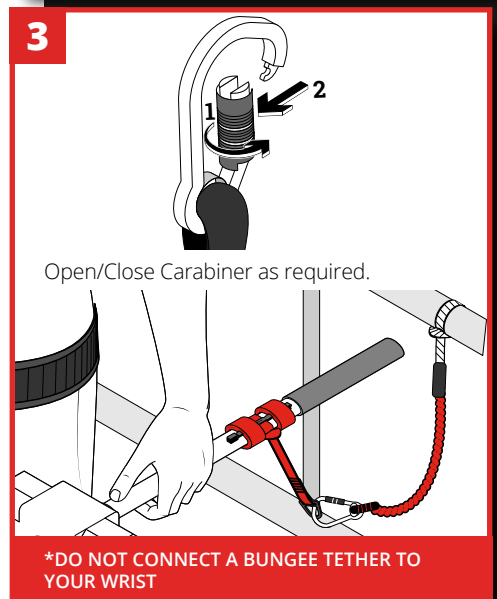
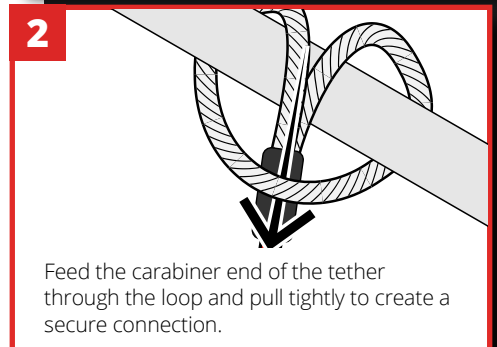
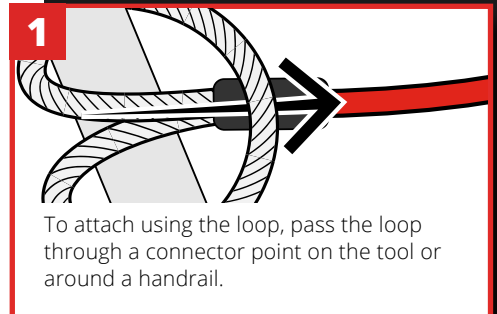

SPECIFICATIONS

SKU	MAX LOAD	MIN LENGTH	MAX LENGTH
H01071	18.0KG 40.0LBS	90CM 35"	1.3M 51"