



CF8608 Air Purifier

User Manual



READ AND SAVE THESE INSTRUCTIONS WARNINGS

Failure to comply with the warnings listed below may result in electric shock or serious injury.



This product should be used only in accordance with the specifications outlined in this manual. Usage other than what has been specified here may result in serious injury.

To reduce the risk of electrical shock, fire or injury to persons: Read all instructions before using the air purifier.

- This appliance can be used by children aged from 8 years and above and persons with reduced physical, sensory or mental capabilities or lack of experience and knowledge if they have been given supervision or instruction concerning use of the appliance in a safe way and understand the hazards involved. Children should not play with the appliance. Cleaning and user maintenance shall not be made by children without supervision.
- This appliance is not intended for use by persons (including children) with reduced physical, sensory or mental capabilities, or lack of experience and knowledge, unless they have been given supervision or instruction concerning use of the appliance by a person responsible for their safety.
- If the supply cord is damaged, it must be replaced by the manufacturer, its service agent, or similarly qualified persons in order to avoid a hazard.
- This appliance is not a substitute for proper ventilation, regular vacuum cleaning or use of an extractor hood or fan while cooking.
- Leave at least 20cm free space behind and on both sides of the appliance and leave at least 30cm free space above the appliance.
- During the operation of the product, please place the unit at least 2m away from equipment which involve electric wave such as televisions, radios, or wave clocks, in case electrical interference occurs to such equipment.
- Remove the power plug from the wall outlet before cleaning the unit and when not using the unit. Electrical shock from bad insulation and or fire from short circuit may occur as a result.

- When removing the power plug, always hold the plug and never pull the cord. Electrical shock and/or fire from short circuit may occur as result.
- Do not use the air purifier if the power cord or plug is damaged or the connection to the wall outlet is loose.
- Do not insert fingers or foreign objects into the intake or air outlet.
- Do not use this air purifier near gas appliances or fireplaces.
- Do not block the air inlet and outlet, e.g. by placing items on the air outlet or in front of the air inlet.
- Do not let water or any other liquid or flammable detergent enter the appliance to avoid electric shock and/or a fire hazard.
- Do not clean the appliance with water or any other liquid or a (flammable) detergent to avoid electric shock and/or a fire hazard.
- Do not place anything on top of the appliance and do not sit on the appliance.
- Do not place the appliance directly below an air conditioner to prevent condensation from dripping into the appliance.
- Do not use this appliance when you have used indoor smoke-type insect repellents or in places with oily residues, burning incense or chemical fumes.
- Do not use the appliance in a room with major temperature changes, as this may cause condensation inside the appliance.
- Do not use the appliance in wet surroundings or in surroundings with high ambient temperatures, such as the bathroom, toilet or kitchen.
- This device contains a UV lamp. If the device is used incorrectly or the casing is damaged, it may cause dangerous UV radiation to overflow. Even a small dose of UV radiation may damage glasses and skin.

Structure

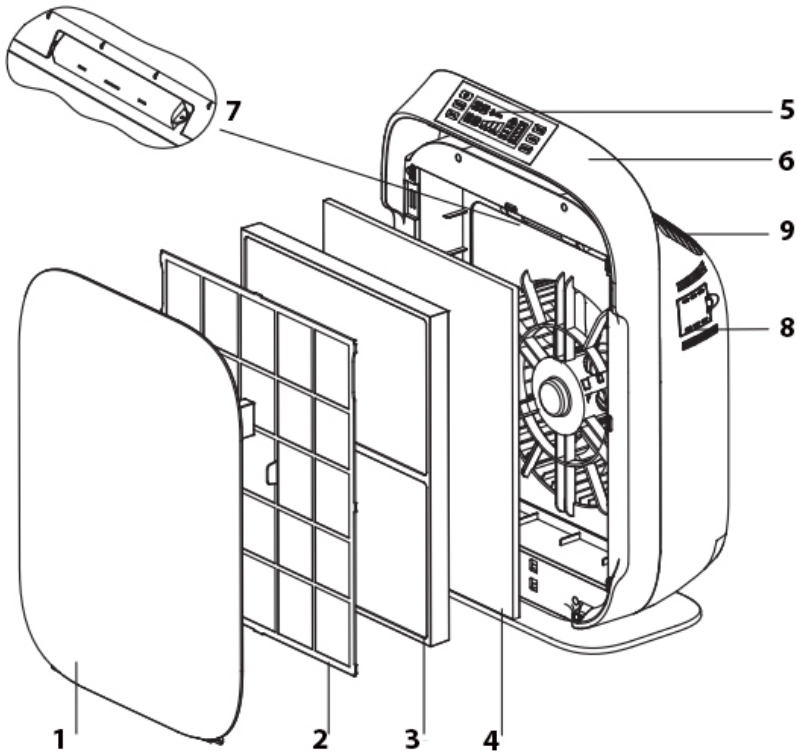

1. Front cover
2. Pre-filter
3. H13 HEPA with antiviral filter
4. Activated Carbon filter
5. Control panel & display
6. Handle
7. UV-C lamp & PCO
8. Dust sensor and Filter reset button
9. Air outlet

Before first use

Placing the filters

The appliance comes with all filters still in protective packaging and fitted inside the unit. Before using the unit, remove the filters from the unit and then **remove the packaging** from the filters before replacing them again in the same order in which you removed them. White tags to be facing outward.

Remove all filters, unpack them, then place them back into the appliance as described below.

Note: Make sure you insert the filters in the correct position.

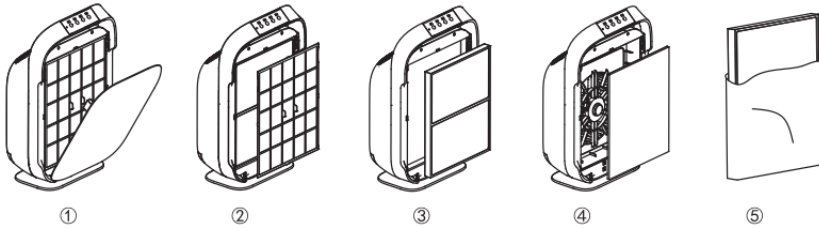

Step 1. Place your fingers in the recesses of the side panels and gently pull the top part of the front panel towards you. Then lift the hooks at the bottom of the panel out of the bottom of the appliance.

Step 2. Remove pre-filter from the appliance.

Step 3. Remove H13 HEPA with antiviral filter from the appliance.

Step 4. Remove Activated Carbon filter from the appliance.

Step 5. Remove all packaging material from the filters.

Step 6. Place Activated Carbon filter back into the appliance, ensuring the side with the white tags are facing towards you.

Step 7. Place H13 HEPA with antiviral filter back into the appliance, ensuring the side with the white tags are facing towards you.

Step 8. Place Pre-filter back into the appliance with the side with flange faces towards you

Step 9. To reattach the front panel, insert the bottom hooks into the bottom of the appliance first. Then push the panel against the body of the appliance.

UV Lamp replacement

Noted: Ultraviolet radiation is dangerous to eyes and skin, please do not use UVC emitter outside the device. Please contact the after-sales service center to replace the UV lamp and do not look into the UV lamp when it is ON.

1. Open the UV lamp cover with a screwdriver.
2. The UV Bulb is removed by carefully grasping the bulb with a clean cloth or tissue and twisting the bulb 1/4 turn. Remove from unit.
3. Install the new UV lamp and re-attach the cover.

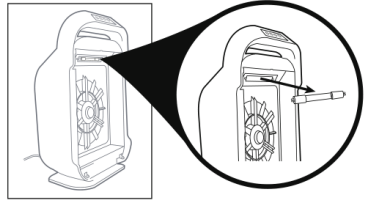

Solenco CF8608 Multi-Stage Air Purifier

This unit offers extremely high air filtration efficiency, capturing and destroying airborne particles including allergens, viruses, bacteria, pollen, dust, smoke, and pet dander.

1. **Washable Pre-filter:** Removes large airborne particles and helps extend the life of HEPA with antiviral filter and Activated Carbon filter.
2. **H13 HEPA filter:** Captures 99.975% of harmful particles such as dust, pollen, pet dander, mould spores and traps bacteria and viruses down to 0.1 micron in size.
3. **Activated Carbon filter:** Removes volatile organic compounds (VOCs), odours and other gaseous pollutants from the air.
4. **ANTIVIRAL FILTER:** Against virus such as SARS-CoV-2 & H1N1
- 5+6. **UV-C & PCO:** A powerful air purification technology that has the ability to destroy particles, bacteria and viruses as small as 0.001 microns.

Operation guidance

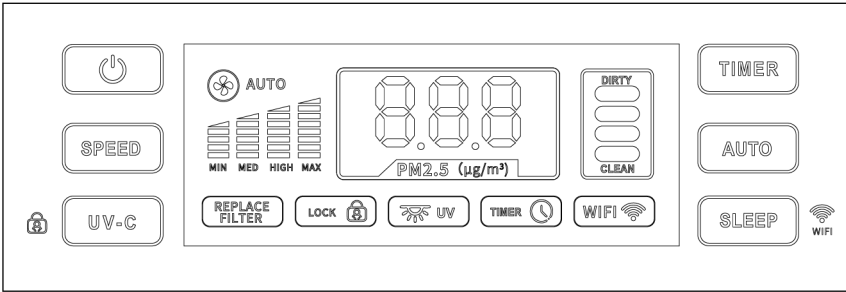

Power button : Soft press to turn on/ off the unit.



Fan speed button: press this button to select the desired fan speed. The corresponding fan speed light indicates the fan speed (Low, Med, High, Turbo).



UV /Child Lock button: Short press this button to turn on / turn off UV lamp.

Long press this button for 3~5 seconds to turn on / turn off Child lock function. This function allows you to lock or unlock the control panel.



Timer button: Press this button, the purifier can be timed to operate for 0-12 hours, stopping automatically when the selected operating time has elapsed.



Auto button: press this button the appliance will adjust the fan speed according to the air quality. The poorer the air quality the faster the fan speed, the better the air quality becomes , the slower the fan speed becomes.



Sleep mode/Wifi button:

Soft press to turn on Sleep mode. The indicator will flash for 10s before all lights turn off. Press any button to turn off Sleep mode.

Long press this button for 3~5s to activate Wi-fi function. The icon will blink rapidly and start to make a beeping sound. The unit can now be connected to your phone via the app.

NOTE: Device can be simultaneously controlled by Remote control.

Fan speed indicator

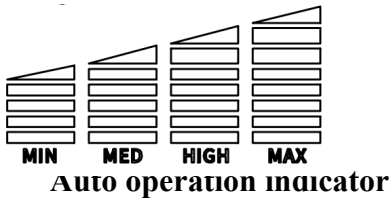

UV indicator



Child Lock indicator



Wi-fi operation



Blink Rapidly: Wi-Fi disconnect.

Blink Slowly: Wi-Fi connect with Router but disconnect with Server

Continuous Light: Wi-Fi connect with Router and Server

Air quality indicator

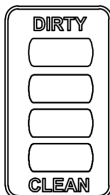

Heavily Polluted	(PM2.5: > 150)	RED
Lightly Polluted	(PM2.5: 100-149.9)	ORANGE
Moderate	(PM2.5: 50-99.9)	YELLOW
Good	(PM2.5: 0-49.9)	BLUE

▲ How to connect

1. Make sure your phone is connecting to your WIFI (Not your phone data) during you add the device to your APP.

2. Make sure the WIFI ICON on the air purifier display is flicking.

If not, just press and hold the WIFI button for 5 seconds to active the WIFI connection.

Step 1: Download and register your 'Tuya Smart' account

Both IOS and Android system are available

Step 2: Add your air purifier to your APP

There two options to add your air purifier to your APP

Option 1: Your smart phone Bluetooth is on.

When you add the air purifier, the device will appear by itself, you just need to touch "Go to add" and select the device. Enter the password of your WIFI which your phone is connected.

Option 2: Your smart phone Bluetooth is off

Touch "add device" and chose Small home appliance---Air purifier
Enter the password of your WIFI which your phone is connected.

Step 3: Control the device by APP

The device you add will show in your Tuya Smart APP. You can control the air purifier by your phone from anywhere, just make sure your phone can use the internet, and the air purifier is connected to your WIFI.

If your air purifier moves to a new house, or you change to a new WIFI connection, you need to re-connect the device as above

▲ Sleep mode warning

-When you press “SLEEP” button, the sleep mode indicator will blink for 10 seconds, then all LED lights will turn off. The appliance will keep operating in current settings. To change settings in Sleep mode, touch any button to turn the LED lights on again. After making changes, sleep mode indicator will blink again for 10s before LED lights turn off again.

▲ Filter change indicator

-HEPA with antiviral filter and Activated Carbon filter change: After operating 4320 hours, the “replace filter” light will turn on (Red), indicating you need to replace the HEPA with antiviral filter and Activated Carbon filter. After replacing the filters, press the reset button, situated on the side of the appliance (shown in diagram below) using one end of a paperclip to reset the indicator light.

Note: The HEPA with antiviral filter and the activated carbon filter have a similar lifetime, therefore they have to be replaced at the same time.

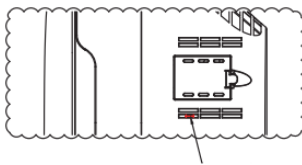

Reset button

Filter replacement

▲ Pre-filter maintenance

-The pre-filter can be washed with water once removed from the unit. Make sure it's properly dry before placing it back into the appliance.

-Do not use sharp objects to clean the pre-filter to avoid causing any damage.

▲ HEPA with antiviral filter and Activated Carbon filter maintenance and replacement

-Every three months, remove the HEPA with antiviral filter and Activated Carbon filters from the appliance, place in direct sunlight to remove any moisture. Use a vacuum cleaner with the brush attachment or simply use a soft brush to clean the dust off the filter. This

will help extend the life of the filter and maintain the HEPA with antiviral filter performance.

-The HEPA with antiviral filter and Activated Carbon filter are NOT washable.

Maintenance caution

▲ Product cleaning

-Ensure you unplug the appliance before cleaning it.

-Do not place the appliance into water or spray/pour water directly onto the appliance.

-Do not use any abrasive, corrosive or flammable detergent to clean the appliance, as this may cause discolouring and/or damage.

-Use a soft cloth with regular detergent to clean the appliance, and make sure the appliance is dry after cleaning.

-Regularly clean the inside and surface, to prevent dust build up.

-Regularly clean the air inlet and air outlet.

-Regularly clean the dust sensor with a cotton swab to protect its sensitiveness.

▲ Dust sensor cleaning

Clean the dust sensor every month for optimal functioning of the appliance. Clean it more frequently if you use the appliance in a dusty environment.

1. Clean the dust sensor inlet and outlet with a soft brush.

2. Open the dust sensor cover.

3. Clean the dust sensor, the dust inlet and the dust outlet with a lightly moistened cotton swab.

4. Dry them with a dry cotton swab.

5. Reattach the air quality sensor cover.

Note: Do not use any corrosive or flammable detergent to clean the appliance, as this may cause damage.

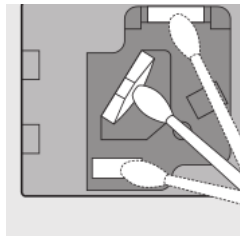
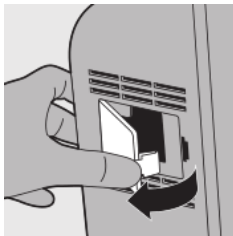
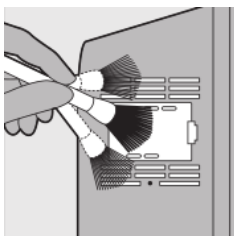

▲ When appliance is not in use for a long period of time

-If appliance is not going to be used for a long period of time, please package and store well to protect the appliance.

-When using the appliance again after a long period of no use or storage, please follow these steps before use:

1. Clean the pre-filter and make sure it's dry.
2. Use soft cloth to clean the HEPA with antiviral filter and Activated Carbon filter, and make sure it's dry.
3. Use a soft cloth to clean the air inlet and air outlet.

▲ Caution

Correct use and regular maintenance will ensure the appliance operates well and will extend the life of the appliance. Non-professionals should not disassemble the appliance to avoid injury caused by electric shock and to avoid causing any damage to the appliance.

Warranty: 2 years as from the date of purchase

FOR ANY WARRANTY CLAIMS, PLEASE CONTACT US DIRECTLY.

SOLENCO SOUTH AFRICA

086 138 8878

INFO@SOLENCOSA.CO.ZA

Label for recording the filter replacement date

ENTER THE INSTALLATION DATE OF THE NEW FILTER

Day

Month

Year

Place this label inside the unit.