

What's in the box:

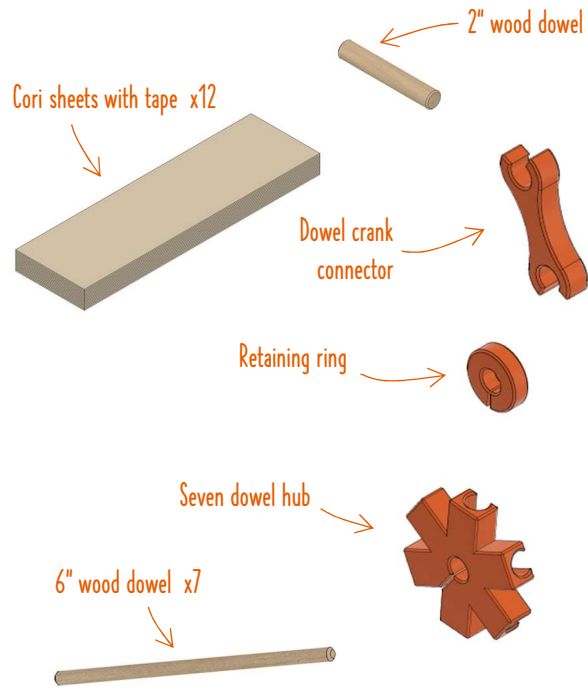

What's not in the box:

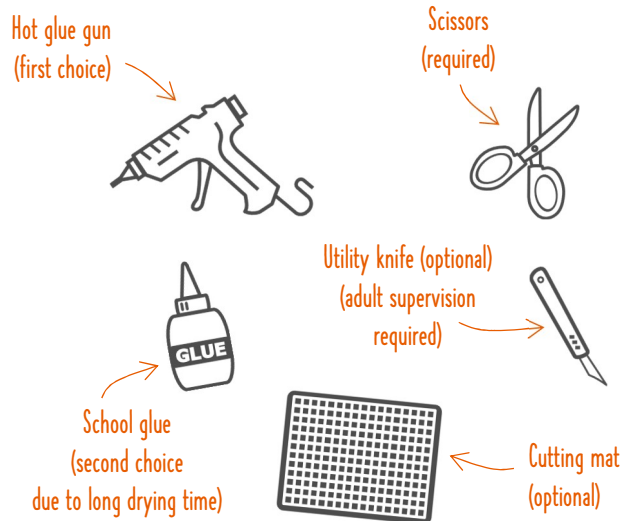

STEP 1: Sketch what you are about to create

Think about how you may want to customize the windmill you are about to create. What shape will you make? How many blades will your design have? What color may you paint it? What other materials can you incorporate? By making a plan, you are more likely to succeed.

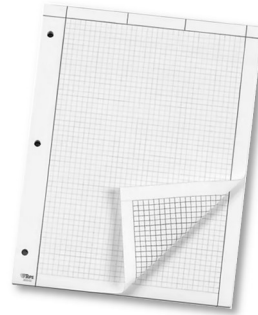

STEP 2: Prepare the tower

Use the Cori shipping box for this project. Use a wood dowel to remove the two knockout holes closest to one end of the box. On the box's closing tab, cut along the dotted line. The holes should now be exposed. Glue the box closed to complete the windmill tower.

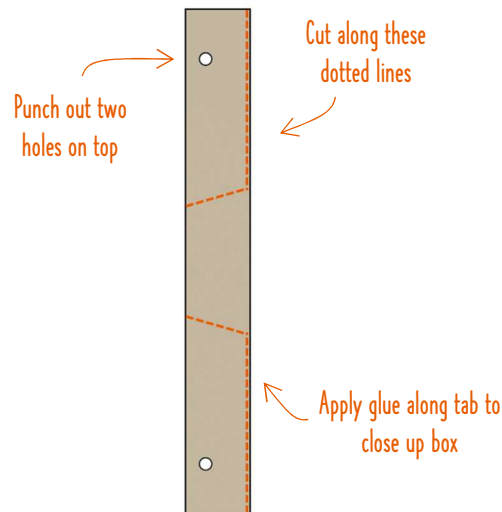

STEP 3: Construct the base

Use at least two Cori beams to support the windmill tower. More beams may be added for a stronger structure.

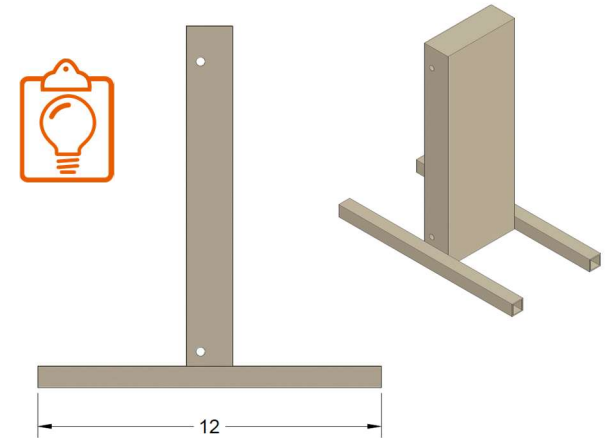

STEP 4: Install the shaft

Slide the retaining ring and the seven dowel hub onto a 6" dowel and slide the assembly into the hole in the box. The shaft should spin freely.

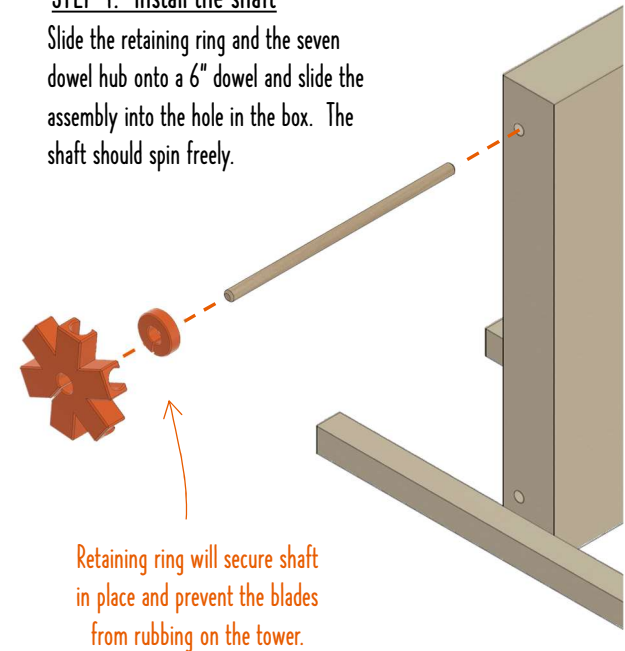

STEP 5: Install the crank

Slide the dowel crank connector onto the shaft from step 4. Complete the crank by installing the 2" dowel as a handle.

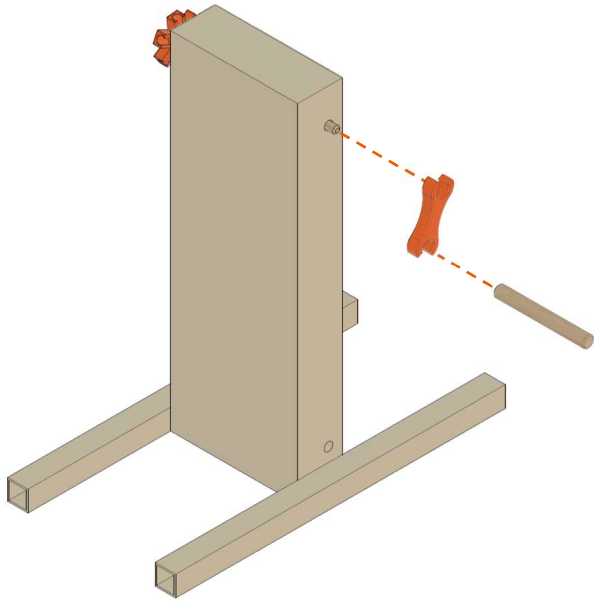

STEP 6: Install blade arms

Use 6" wood dowels for arms to hold the blades. Six or three blades are most commonly used for windmills.

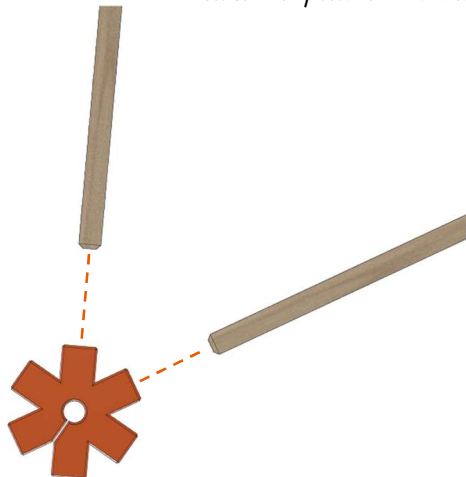

STEP 7: Install blades

Use the included templates to cut out blades from the leftover Cori sheets, or use other materials that you have available. The blade design choice will have a great impact on your windmill's performance.

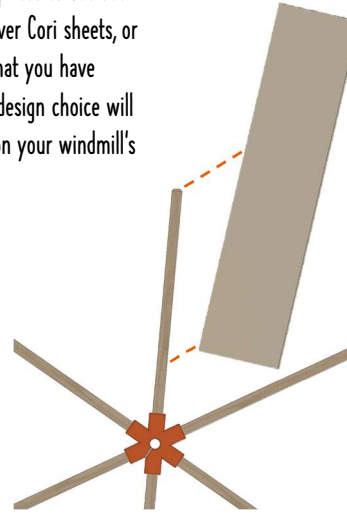

STEP 8: Complete the windmill

Now is the time to make it uniquely yours by adding paint, stickers, and any other material that you have. What wind sources can you find in your house to test your creation? Unleash your creativity!

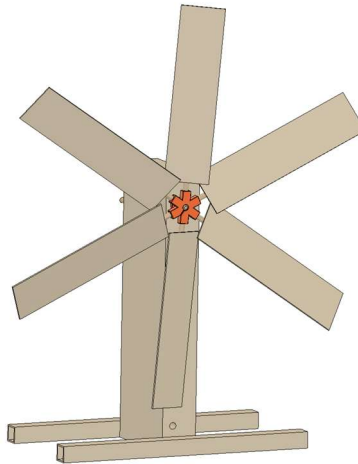

CORI support is here to help. Contact us at support@coricreate.com if you have any questions or comments.

Share your designs using our hashtag #CoriCreate. Follow us on Facebook, Instagram and Twitter.



Windmill

Instructions

Unleashing creativity

Empower the innovator in any maker while applying real practical STEM skills. The Cori Windmill kit is the perfect project to seed curiosity, build grit, improve spatial skills, and sharpen problem solving abilities.

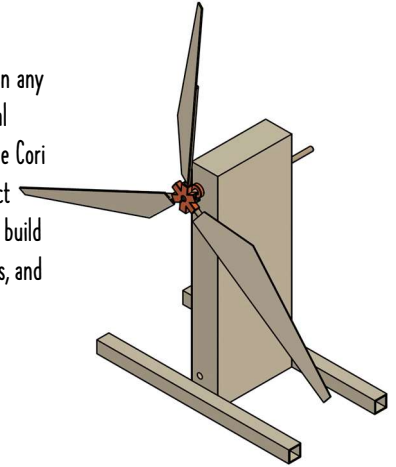

Get a coach

At Cori, we believe in the value of having a coach or a mentor. Every time you see a coach's pad icon in the instructions, it is a good time to check in with your chosen coach.



Coach's pad

Measure twice, cut once

You will construct this model from the ground up. Careful measurements, cutting, and gluing are required to complete this build. While detailed step-by-step instructions are provided, we highly encourage you to improvise and modify as you please. You may even choose to incorporate other materials along the way. But most importantly, have fun!



1-2 hours



Grit required



Ages 8+
(5+ with adult)