

## **STANDARD PROCEDURE - FRONT LAMP AIMING**

### **VEHICLE PREPARATION FOR LAMP ALIGNMENT**

1. Check for and correct any burnt out bulbs.
2. Repair or replace any ineffective, worn or damaged body or suspension components that could hinder proper lamp alignment.
3. Verify proper tire inflation pressures.
4. Remove any accumulations of mud, snow or ice from the vehicle underbody and clean the front lamp lenses.
5. Verify that there is no load in the vehicle (cargo or passengers), except for the driver.
6. The fuel tank should be FULL. Add 2.94 kilograms (6.5 pounds) of weight over the fuel tank for each estimated gallon of missing fuel.
7. Verify correct vehicle suspension height.

# LAMP ALIGNMENT SCREEN PREPARATION

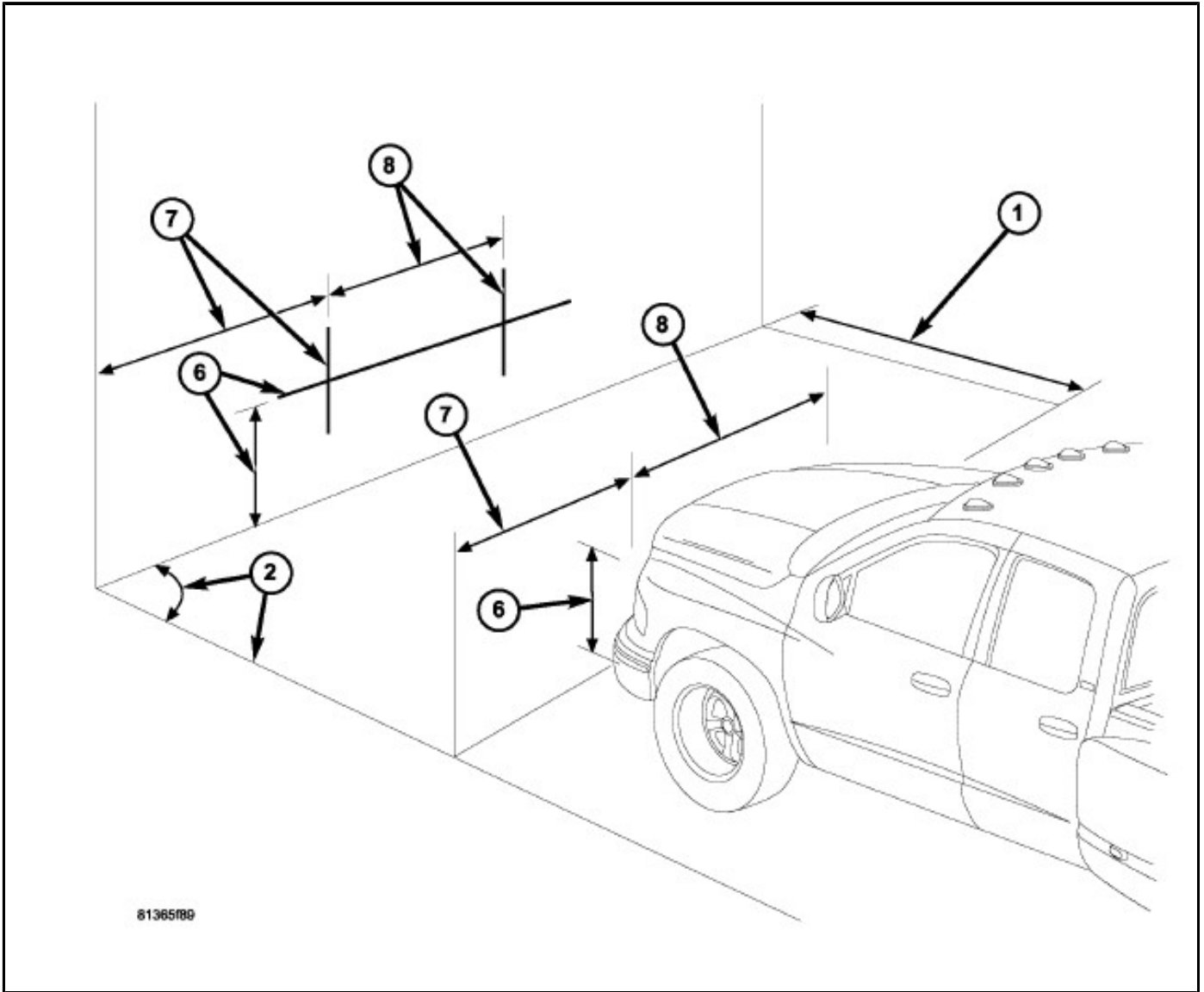

The procedure that follows will prepare a suitable front lamp alignment screen.

## HEADLAMP ALIGNMENT

**NOTE:**

Due to the linear nature of the headlamp cutoff, a properly aimed low beam headlamp will project the top edge of the high intensity pattern 2.5 centimeters (1 inch) below the headlamp horizontal reference line on the alignment screen. No horizontal (right/left) adjustment is required for this headlamp beam pattern. The high beam pattern will be correct when the low beams are properly aimed.

1. The vertical adjustment screw for each headlamp is accessible through a hole located in a raised rectangular formation (2), with a raised arrow pointing to it. These features are stamped into the sheet metal of each front fender (1) ledge near the front of the vehicle.

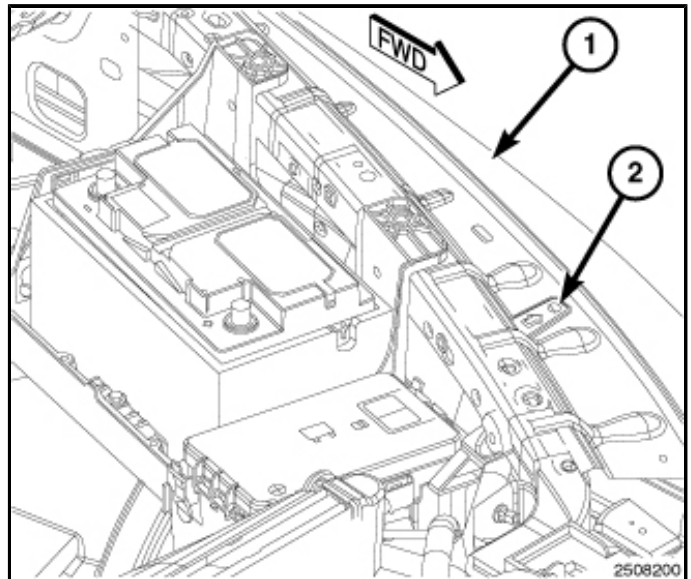

2. Turn the headlamps ON and select the LOW beams.
3. Rotate the headlamp vertical adjustment screw (2) on the back of each front lamp unit (1) to adjust the beam height as required. The images below depicts proper call outs for this step.

## FOG LAMP ALIGNMENT

**NOTE:** A properly aimed front fog lamp will project a pattern on the alignment screen 10 centimeters (4 inches) below the fog lamp centerline and straight ahead of the lamp.

1. Turn the fog lamps ON.
2. Rotate the thumbwheel screw (1) located behind the bumper on the back of each fog lamp unit to adjust the beam height as required.

