

## 2013 Wrangler – Seat Removal Warning

- WARNING:** To avoid serious or fatal injury on vehicles equipped with the Supplemental Restraint System (SRS), never attempt to repair the electrically conductive circuits or wiring components related to the SRS for which there is no MOPAR wiring repair kit. It is important to use ONLY the recommended splicing kit and procedure. For applicable and available MOPAR wiring repair kits, please visit the MOPAR Connector Web Site at the following address on the internet: (<http://dto.vftis.com/mopar/disclaimer.asp>). Inappropriate repairs can compromise the conductivity and current carrying capacity of those critical electrical circuits, which may cause SRS components not to deploy when required, or to deploy when not required. Only minor cuts or abrasions of wire and terminal insulation where the conductive material has not been damaged, or connector insulators where the integrity of the latching and locking mechanisms have not been compromised may be repaired using appropriate methods.
- WARNING:** To avoid serious or fatal injury during and following any seat belt or child restraint anchor service, carefully inspect all seat belts, buckles, mounting hardware, retractors, tether straps, and anchors for proper installation, operation, or damage. Replace any belt that is cut, frayed, or torn. Straighten any belt that is twisted. Tighten any loose fasteners. Replace any belt that has a damaged or ineffective buckle or retractor. Replace any belt that has a bent or damaged latch plate or anchor plate. Replace any child restraint anchor or the unit to which the anchor is integral that has been bent or damaged. Never attempt to repair a seat belt or child restraint component. Always replace damaged or ineffective seat belt and child restraint components with the correct, new and unused replacement parts listed in the Chrysler Mopar® Parts Catalog. Failure to follow these instructions may result in possible serious or fatal injury.
- WARNING:** To avoid serious or fatal injury on vehicles equipped with seat airbags, disable the Supplemental Restraint System (SRS) before attempting any Occupant Restraint Controller (ORC) diagnosis or service. The ORC contains a rollover sensor, which enables the system to deploy the seat airbags in the event of a vehicle rollover event. If an ORC is accidentally rolled during service while still connected to battery power, the seat airbags will deploy. Disconnect and isolate the battery negative (ground) cable, then wait two minutes for the system capacitor to discharge before performing further diagnosis or service. This is the only sure way to disable the SRS. Failure to take the proper precautions could result in accidental airbag deployment.
- WARNING:** To avoid serious or fatal injury on vehicles equipped with airbags, disable the Supplemental Restraint System (SRS) before attempting any steering wheel, steering column, airbag, seat belt tensioner, impact sensor or instrument panel component diagnosis or service. Disconnect and isolate the battery negative (ground) cable, then wait two minutes for the system capacitor to discharge before performing further diagnosis or service. This is the only sure way to disable the SRS. Failure to take the proper precautions could result in accidental airbag deployment.
- WARNING:** To avoid potential physical injury or damage to sensitive electronic circuits and systems, always disconnect and isolate the battery negative (ground) cable and the positive cable, then ground the positive cable to discharge the Occupant Restraint Controller (ORC) capacitor before performing any welding operations on the vehicle. Failure to take the proper precautions could result in accidental airbag deployment, possible damage to the Supplemental Restraint System (SRS) circuits and components, and possible damage to other electronic circuits and components. Whenever a welding process is being performed within 12 inches (30 centimeters) of an electronic module or wiring harness, then that module or harness should be relocated out of the way, or disconnected. Always protect against component or

vehicle damage from weld spatter by using weld blankets and screens.

- WARNING:** To avoid serious or fatal injury, do not attempt to dismantle an airbag unit or tamper with its inflator. Do not puncture, incinerate or bring into contact with electricity. Do not store at temperatures exceeding 93° C (200° F). An airbag inflator unit may contain sodium azide and potassium nitrate. These materials are poisonous and extremely flammable. Contact with acid, water, or heavy metals may produce harmful and irritating gases (sodium hydroxide is formed in the presence of moisture) or combustible compounds. An airbag inflator unit may also contain a gas canister pressurized to over 17.24 kPa (2500 psi). Failure to follow these instructions may result in possible serious or fatal injury.
- WARNING:** To avoid serious or fatal injury when handling a seat belt tensioner retractor. Exercise proper care to keep fingers out from under the retractor cover and away from the seat belt webbing where it exits from the retractor cover. Failure to follow these instructions may result in possible serious or fatal injury.
- WARNING:** To avoid serious or fatal injury, replace all Supplemental Restraint System (SRS) components only with parts specified in the Chrysler Mopar® Parts Catalog. Substitute parts may appear interchangeable, but internal differences may result in inferior occupant protection.
- WARNING:** To avoid serious or fatal injury, the fasteners, screws, and bolts originally used for the Supplemental Restraint System (SRS) components must never be replaced with any substitutes. These fasteners have special coatings and are specifically designed for the SRS. Anytime a new fastener is needed, replace it with the correct fasteners provided in the service package or specified in the Chrysler Mopar® Parts Catalog.
- WARNING:** To avoid serious or fatal injury when a steering column has an airbag unit attached, never place the column on the floor or any other surface with the steering wheel or airbag unit face down. Failure to follow these instructions may result in possible serious or fatal injury.

# 2013 Wrangler Front Seat Removal

Before proceeding with the following repair procedure, review all warnings and cautions.

**WARNING:** The Seat Weight Sensor is a sensitive, calibrated unit and must be handled carefully. Do not drop or handle roughly. If dropped or damaged, replace with another sensor. Failure to follow these instructions may result in personal injury or death.

**WARNING:** The front passenger seat must be handled carefully as well. When removing the seat, be careful when setting on floor not to drop. If dropped, the sensor may be inoperative. Failure to follow these instructions may result in personal injury or death.

**WARNING:** When the seat is on the floor, no one should sit in the front passenger seat. This uneven force may damage the sensing ability of the seat weight sensors. If sat on and damaged, the sensor may be inoperative. Failure to follow these instructions may result in personal injury or death.

**NOTE:** If equipped with a traveling seat belt anchor.

1. Adjust the front seat (1) to its most forward position for easiest access to the front seat belt (3) lower anchor and the B-pillar trim.
2. Disconnect and isolate the battery negative cable. Wait two minutes for the system capacitor to discharge before further service.
3. Remove the screw (2) that secures the lower anchor to the outboard side of the front seat cushion frame.



819d0723

4. Remove the four seat bolts (2).
5. Tip the seat back and disconnect the electrical connectors (3).
6. Remove the seat.

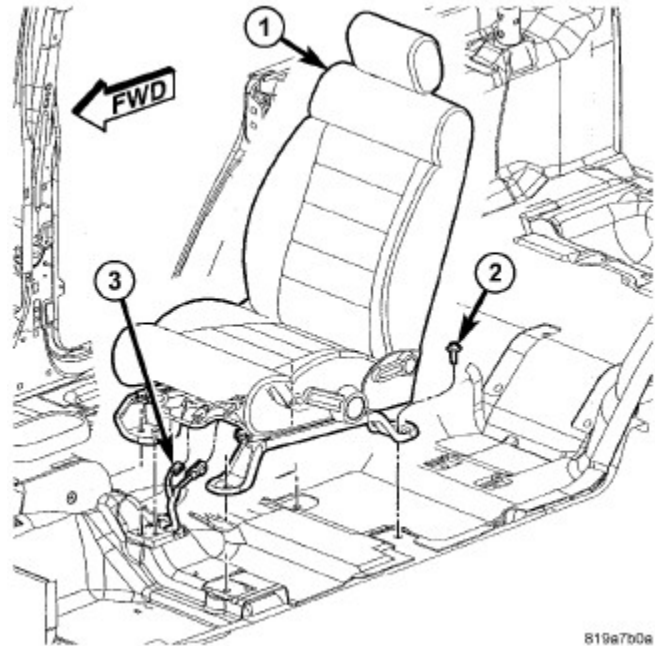

819a7b0a

## 2013 Wrangler Front Seat Back Cover Removal

1. Remove the front seat.
2. Remove the seat recliner easy entry levers, if equipped.
3. Position aside the seat back cover and remove the seat back assembly bolts.
4. If equipped, disconnect the electrical connectors and remove the seat back.

5. Push in the buttons on both headrest sleeves, pull the headrest up and remove.

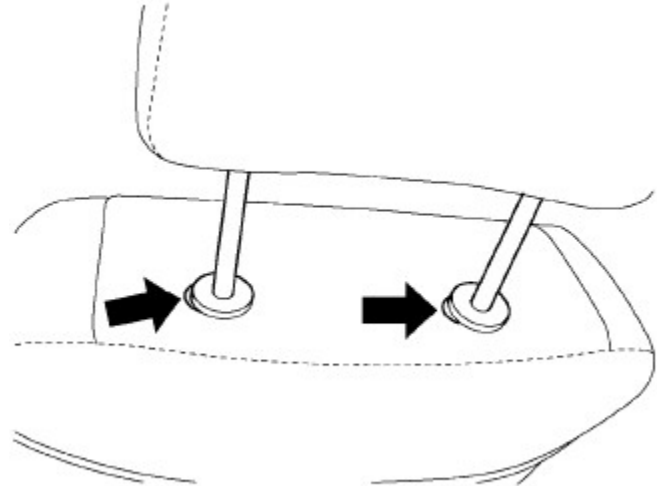

812cdd43

6. Separate the J-straps (1 AND 2; figure below) and pull cover up over frame.
7. Unzip the cover zippers.
8. On vehicles equipped with seat air bags, remove the air bag, (Refer to 10 - Restraints/AIR BAG, Seat - Removal).

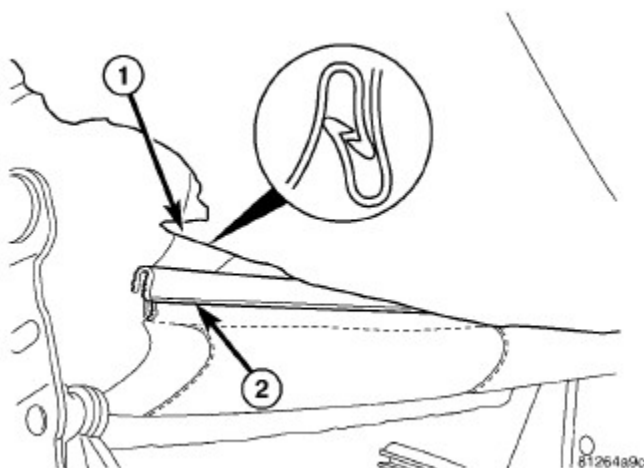

81264a9c

9. Cut off the hog rings (2) attaching the cover (3) to the cushion (1).

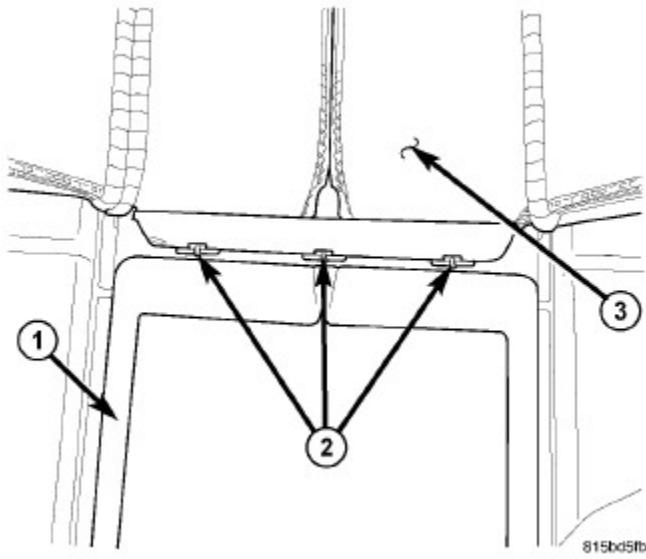

10. Squeeze the locking tab (3) and remove the headrest sleeves (1) and remove the cover.

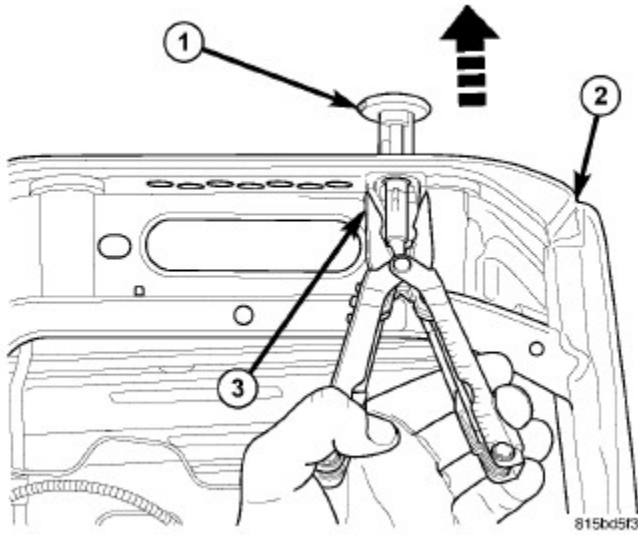

## **2013 Wrangler Front Seat Cushion Cover Removal**

1. Before proceeding with the following repair procedure, review all warnings and cautions.
2. Remove the front seat.
3. Remove the lift handle, if equipped.
4. Separate the J-straps from the seat cushion frame and remove the seat cushion and cover.
5. Remove the hog rings and separate the cover from the cushion.

# 2013 Wrangler Front Seat Side Airbag Removal

**WARNING:** To avoid serious or fatal injury on vehicles equipped with airbags, disable the Supplemental Restraint System (SRS) before attempting any steering wheel, steering column, airbag, seat belt tensioner, impact sensor or instrument panel component diagnosis or service. Disconnect and isolate the battery negative (ground) cable, then wait two minutes for the system capacitor to discharge before performing further diagnosis or service. This is the only sure way to disable the SRS. Failure to take the proper precautions could result in accidental airbag deployment.

**WARNING:** To avoid serious or fatal injury when removing a deployed airbag, rubber gloves, eye protection, and a long-sleeved shirt should be worn. There may be deposits on the airbag unit and other interior surfaces. In large doses, these deposits may cause irritation to the skin and eyes.

1. Position the front seat to its most forward position for easiest access to the front seat back.
2. Disconnect and isolate the battery negative cable. Wait two minutes for the system capacitor to discharge before further service.
3. Fold the seat back rearward for easiest access to the J-hook retainers at the base of the seat back trim cover.
4. Disengage the J-hook retainers that secure the front and rear lower edges of the seat back trim cover to each other at the base of the seat back.
5. Fold the seat back forward for easiest access to the back of the seat back trim cover.
6. Remove the recliner handle and, on the passenger side only, the easy entry handle from the outboard side of the seat.
7. Pull up the front and rear lower edges of the seat back trim cover far enough to access the seat airbag unit on the outboard side of the seat back frame.

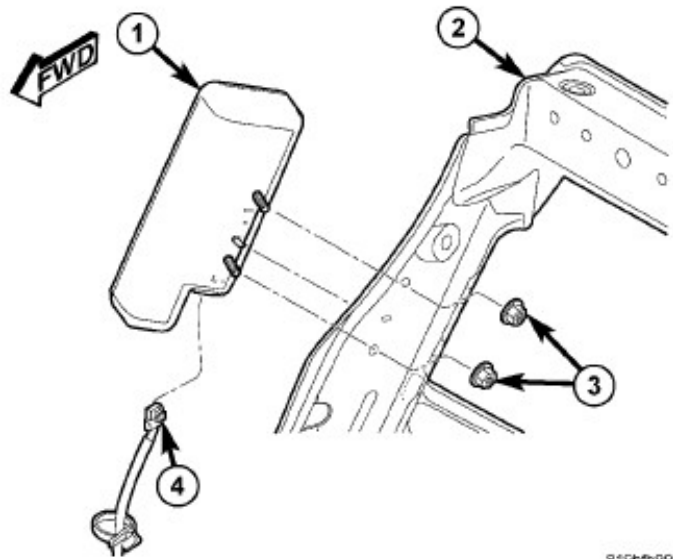

815b099

**CAUTION:** Do not pull on the seat airbag jumper wire harness (4) or pry on the connector insulator to disengage the connector from the seat airbag (1) inflator connector receptacle. Improper removal of this jumper wire and its connector insulator can result in damage to the airbag circuits or the connector insulator.

8. Reach between the seat back trim cover and the foam pad on the outboard side of the seat back frame to access and disconnect the seat airbag jumper wire harness connector from the seat airbag inflator. Squeeze the black latch tabs on each side of the connector insulator, then pull the



insulator straight out from the airbag inflator initiator to disconnect it from the connector receptacle.

**CAUTION:** During removal of the seat airbag, be certain not to tear or damage the sewn nylon pouch integral to the inside of the seat back trim cover that contains the seat airbag. If the nylon pouch or the trim cover are torn or damaged, the entire front seat back trim cover must be replaced with a new unit.

9. Remove the two nuts (3) from the inboard side of the outboard seat back frame that secure the seat airbag to the side of the seat back.
10. Pull the seat airbag outward from the seat back far enough to disengage the airbag mounting studs from the seat back frame.
11. Disengage the seat airbag from the sewn pouch on the inside of the seat back trim cover and remove the airbag from the seat back.

# 2013 Wrangler Front Seat Installation

**WARNING:** The Seat Weight Sensor is a sensitive, calibrated unit and must be handled carefully. Do not drop or handle roughly. If dropped or damaged, replace with another sensor. Failure to follow these instructions may result in personal injury or death.

**WARNING:** The front passenger seat must be handled carefully as well. When removing the seat, be careful when setting on floor not to drop. If dropped, the sensor may be inoperative. Failure to follow these instructions may result in personal injury or death.

**WARNING:** When the seat is on the floor, no one should sit in the front passenger seat. This uneven force may damage the sensing ability of the seat weight sensors. If sat on and damaged, the sensor may be inoperative. Failure to follow these instructions may result in personal injury or death.

1. Position the seat into the vehicle and connect the electrical connectors (3), if equipped.
2. Install the bolts (2).
  - a. Adjust the seat rearward.
  - b. Tighten the front inboard bolt to **75 N·m (55 ft. lbs.)**.
  - c. Tighten the front outboard bolt to **75 N·m (55 ft. lbs.)**.
  - d. Adjust the seat forward.
  - e. Tighten the rear inboard bolt to **75 N·m (55 ft. lbs.)**.
  - f. Tighten the rear outboard bolt to **75 N·m (55 ft. lbs.)**.

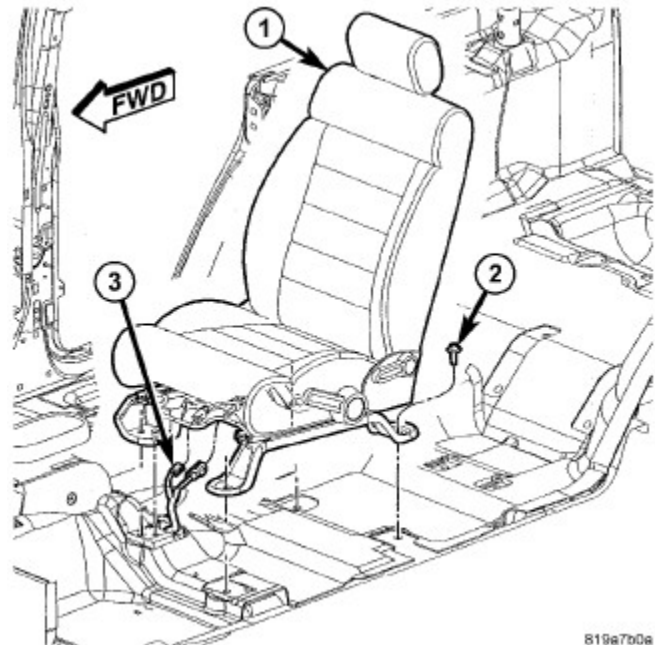

819a7b0e

**NOTE:** If equipped with a traveling seat belt anchor.

3. Position the seat belt (3) lower anchor to the mounting hole on the outboard side of the front seat (1) cushion frame. Be certain that the seat belt webbing between the turning loop and the lower anchor is not twisted.
4. Install and tighten the screw (2) that secures the lower anchor to the seat. Tighten the screw to **40 N-m (30 ft. lbs.)**.
5. Do not reconnect the battery negative cable at this time. The supplemental restraint system verification test procedure should be performed following service of any supplemental restraint system component.



# 2013 Wrangler Rear Seat Removal

## Two Door

1. Remove the rear subwoofer.
2. Lift the seat back release lever and fold seat back forward and release the rear latches (2).
3. Slowly flip the entire seat (1) forward.
4. Press down on release bar on each side to release the front latches (3), and pull seat out and away from lower bracket (4).
5. Remove seat from the vehicle.



## Four Door

1. Remove the four front leg bolts (1).
2. Remove the front rear bracket bolts (2).
3. Fold the seat backs (3) into the down position.



4. Remove the center bracket bolt (3).
5. Remove the outer bracket nuts (2) and remove the seat assembly through the tail gate.

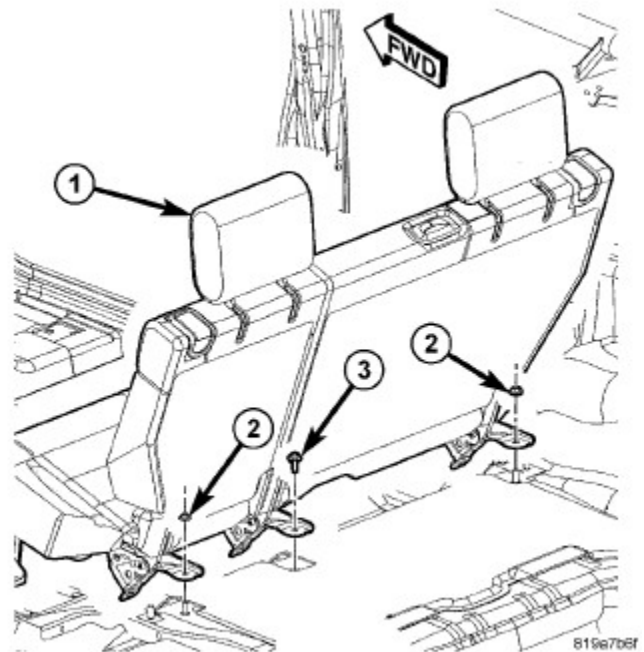

# 2013 Wrangler 4-Door Rear Headrest Removal/Installation

## Removal

1. Release the seat back and fold forward far enough to release the headrest.
2. Using a small flat bladed tool or equivalent, release the headrest by pressing the tool into the slots (1) on the trim caps.

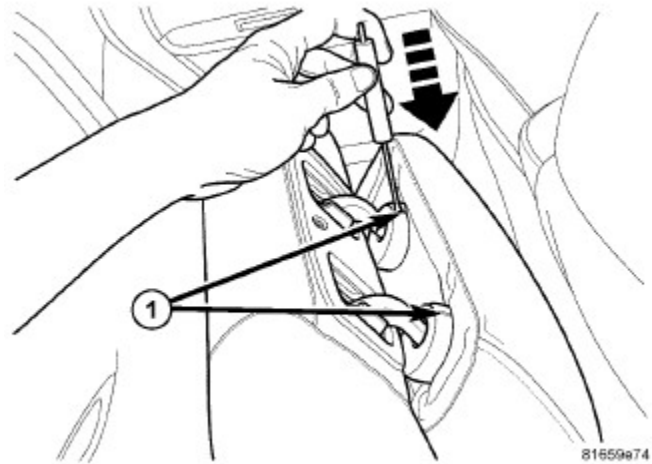

3. Remove the headrest (1) from the headrest bracket and hinge (2).

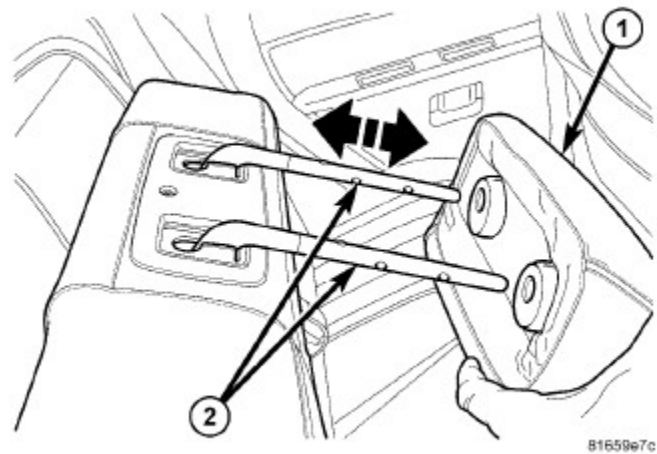

## Installation

1. Position the headrest (1) onto the bracket and hinge assembly (2) and seat the headrest fully.

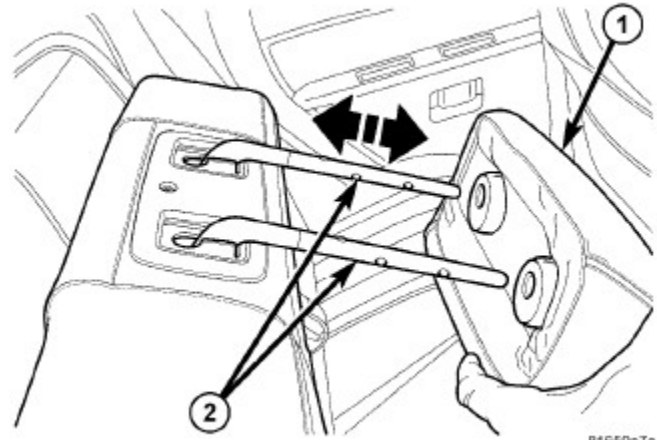

# 2013 Wrangler Rear Back Cover Removal

1. Remove the rear seat.
2. Remove the headrest.

## Two Door

1. Remove the back frame to cushion bolts and separate the seat back assembly.
2. Separate the J-straps and unzip the cover.

3. Squeeze the locking tab (3) and remove the headrest sleeves (1).
4. Remove the seat cushion from the seat back frame.
5. Remove the hog rings and separate the cover from the cushion.

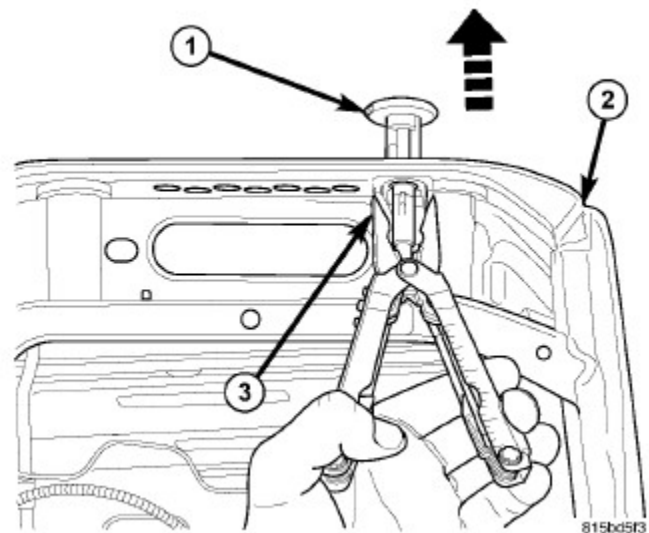

## Four Door

1. Separate the seat halves.
2. Remove the seat handle bezel.
3. Remove the screws and remove the release handle.
4. Remove the seat cushion pivot bolts and remove the seat cushion from the seat back assembly.
5. Remove the inner and outer latch covers.
6. Remove the seat belt bezel.
7. Separate the J-straps and unzip the cover.
8. Remove the seat cushion from the seat back frame.
9. Remove the hog rings and separate the cover from the cushion.



# 2013 Wrangler Rear Seat Cushion Cover Removal

1. Remove the rear seat.

## Two Door

1. Remove the seat back frame to seat cushion assembly bolts and separate the seat back assembly.
2. Separate the J-straps and remove the cover and cushion assembly.
3. Remove the hog rings and separate the cushion and cover.

## Four Door

1. Separate the rear seat sections.
2. Remove the seat cushion pivot bolts and separate the cushion from the back assembly.
3. Release the J-straps and separate the cushion assembly from the frame.
4. Remove the hog rings and separate the cover from the cushion.

# 2013 Wrangler Rear Seat Installation

## Two Door

1. Position the seat assembly into the vehicle and lock the rear of the front latches (3) into rear loop of the lower brackets (4).
2. Lift the seat upright and lock the front of the front latches (3) into the front loop of the lower brackets (4).
3. Position the seat assembly down and secure the rear latches (2).
4. Lift the seat back (1) into the upright position to lock the rear latches (2).



## Four Door

1. Position the seat assembly into the vehicle and over the rear studs.
2. Install the nuts (2) and tighten to **85 N·m (63 ft. lbs.)**.
3. Install the bolt (3) and tighten to **75 N·m (55 ft. lbs.)**.

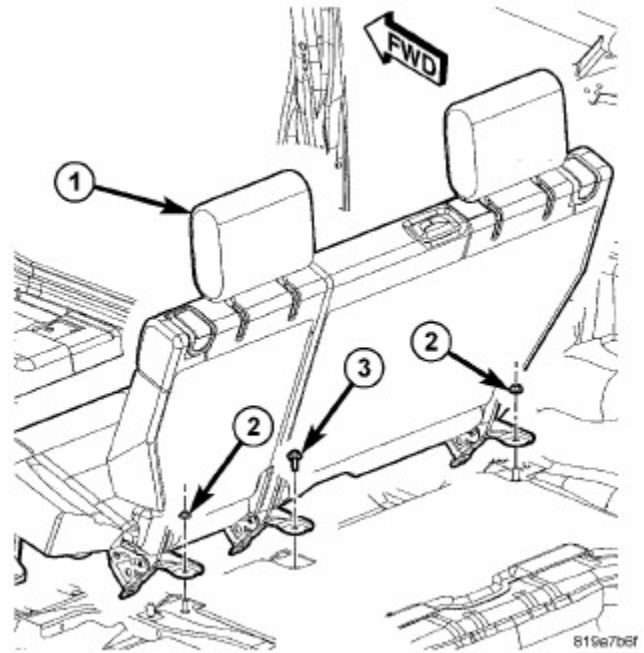

4. Install the rear bracket front screws (2) and tighten to **75 N·m (55 ft. lbs.)**.
5. Install the front bracket screws (1) and tighten to **75 N·m (55 ft. lbs.)**.
6. Install the center belt buckle (4) and make sure the tab is lined up with the slot in the plate.
7. Install the buckle bolt and tighten to **75 N·m (55 ft. lbs.)**.

