



iPod, iPhone and iPad are registered trademarks of Apple Inc.

This material is not legally approved for use in any advertising. It is intended for use by dealership employees only and is not to be disseminated to, or reviewed by, consumers. Information contained herein is designed to be as comprehensive and factual as possible. General Motors reserves the right, however, to make changes at any time, without notice, in materials, equipment, specifications, models and availability.

Copyright 2015 General Motors. All Rights Reserved. No portion of this work may be reproduced, rebroadcast or redistributed, in whole or in part, without the express written permission of General Motors.

CLICK ON ANY ITEM
BELOW TO GO DIRECTLY
TO THAT PAGE

SIERRA/YUKON/
CANYON

Key Messages, Availability
By Model & Overview of
Standard Features 3

OnStar 4G LTE Wi-Fi . 3

Text Message Alerts . 3

Siri Eyes Free 4

Base Radio 5

4.2" IntelliLink Radio . . 7

8" IntelliLink Radio . . .12

Highlights 13

Orientation
to Controls17

Interacting with
IntelliLink 18

Radio and
USB Media 20

Favorites21

Bluetooth
Devices 23

Customizing
the System 25

8" IntelliLink Radio
with Navigation 27

TERRAIN

New Features 31

OnStar 4G LTE Wi-Fi . . 31

Text Message Alerts . . .31

Siri Eyes Free 32

ACADIA

New Features 33

Text Message Alerts . . 33

TuneSelect 34



A LETTER FROM YOUR INTELLILINK MARKETING TEAM

GMC's Professional Grade trucks get an amped-up IntelliLink for the 2015 Model Year with features that include:

- Siri Eyes Free to enable iPhone users to access more of their phone's features through the radio
- Text Message Alerts, a hands-free method of receiving text messages in your vehicle

Introducing OnStar 4G LTE Wi-Fi Service¹

To complement IntelliLink's advanced infotainment system, we're pleased to offer OnStar 4G LTE Wi-Fi service that makes select GMC vehicles a rolling Wi-Fi hotspot. The hotspot is powered by your vehicle, so when your vehicle is running, your hotspot is active.

- The 4G connection is stronger because of a more powerful antenna. And up to seven Wi-Fi devices can be connected at once, so when you're chauffeuring your family or driving carpool, everyone can use OnStar 4G LTE Wi-Fi.

Best of luck selling the new features of IntelliLink and the new OnStar 4G LTE Wi-Fi service in the most capable GMCs yet!

Your IntelliLink Marketing Team

¹ See onstar.com for a detailed instruction guide, vehicle availability, details, and system limitations. Services and apps vary by make, model, year, carrier, availability and conditions. 4G LTE service is available in select markets. 4G LTE performance is based on industry averages and vehicle systems design. Some services require a data plan.

2015 RADIOS FEATURING INTELLILINK (SIERRA/YUKON/CANYON)

TABLE OF CONTENTS

SIERRA/YUKON¹/CANYON

TERRAIN

ACADIA

NEW FEATURE: ONSTAR 4G LTE WI-FI SERVICE

ONSTAR 4G LTE WI-FI² MAKES YOUR VEHICLE A ROLLING HOTSPOT (I04, I05, I06)

Your vehicle can be a rolling mobile hub with great signal quality and bandwidth for up to seven devices. OnStar with 4G LTE service allows everyone in your vehicle to enjoy his or her own content. A 3-month/3GB, whichever comes first, 4G LTE trial is included when the OnStar complimentary service is activated (OnStar's Basic Plan is included for five years). Click the "Fast Facts" icon below for more information. Press the OnStar Voice Command Button on the mirror or overhead console or, if available, select the "OnStar" icon on the radio home screen. Wait for the prompt and the beep and say, "Wi-Fi Settings." The screen will display the name and password for your Wi-Fi hotspot. Go to Settings on the device you want to connect and find the name of your vehicle's 4G LTE Wi-Fi connection. Select the hotspot and input the password. Then, connect. Press the blue OnStar button and speak to an Advisor to change your 4G LTE Wi-Fi name and/or password, or manage your settings in your RemoteLink mobile app.



Video: OnStar 4G LTE Wi-Fi



NEW FEATURES: INTELLILINK TEXT MESSAGE ALERTS (I04, I05, I06)

If your vehicle is paired with a Bluetooth device that supports Text Message Alerts, the system:

- **Can display incoming text messages**
- **Can play incoming text messages** over the audio system
- **Can respond to incoming texts with preset messages**
- **Requires a compatible smartphone** with Bluetooth profile (M.A.P.) **and applicable text messaging features**

For more information about varying capabilities, go to gmttotalconnect.com. For example, iPhones require unique setup requirements and offer limited Text Message Alert capabilities.

¹ Only on Yukon 2015 interim.

² See onstar.com for a detailed instruction guide, vehicle availability, details, and system limitations. Services and apps vary by make, model, year, carrier, availability, and conditions. 4G LTE service is available in select markets. 4G LTE performance is based on industry averages and vehicle systems design. Some services require a data plan.

How To Use Text Messaging

- Press "**Message**" button on Home Page
- When messages are retrieved, "**Text Message**" **inbox displays**
- Select message for viewing (**only available when vehicle is not moving**)
- Select "**Reply**" to reply and select desired message from display of preset messages, then select "Send" (this function is not available for iPhones) **incoming text messages**
- Pop-up screen displays: Select "Listen," "View," "Dismiss" or "Call". Turn off display alerts from the "Settings" button

Setting up Text Messaging during Phone Pairing

- **Android and BlackBerry** give you a pop-up right after you pair, asking whether you want to allow access to your messages
- **For iPhone**, you have to go into Settings, then Bluetooth, select your vehicle and turn on notifications

Notes for iPhone

Text messaging functionality with compatible iPhones is limited to Apple restrictions on what the radio can access, e.g., text messages received prior to entering the vehicle will not be displayed, and you cannot reply to a text message.

"Show Notifications" must be enabled on the phone to allow the radio to access messaging; to enable "Show Notifications," after pairing and connecting to the radio:

- On the phone, select "Settings," then "Bluetooth," then "Properties" (either device-friendly name such as "Sierra" or "Radio"), then turn "show Notifications" on
- Restart vehicle for connection to take hold
- Once set, it is retained for future connections

Visit gmttotalconnect.com for vehicle and smartphone compatibility.



Video: Text Message Alerts

2015 RADIOS FEATURING INTELLILINK (SIERRA/YUKON¹/CANYON)

TABLE OF CONTENTS

SIERRA/YUKON¹/CANYON

TERRAIN

ACADIA

NEW FEATURES: INTELLILINK

Video: Siri Eyes Free



SIRI EYES FREE FOR IPHONE USERS

Siri Eyes Free gives compatible iPhone users **hands-free access to some of their phone's features**, like the calendar and text messaging.

Siri Eyes Free allows users to direct Siri to perform a number of tasks while they safely keep their **eyes on the road and their hands on the wheel**. The Eyes Free mode enables users to interact with their iPhone using nothing more than their voice.

How to Use Siri Eyes Free

Owners simply **connect their iPhone with the radio via Bluetooth**, pair with the system, and **use the Push-to-Talk (PTT) button on the steering wheel** to begin and end sessions with Siri in Eyes Free mode.

Press and hold the PTT button long enough until Siri speaks; pressing and holding the PTT button for too short a period of time will engage the onboard voice recognition system and bypass Siri. Siri can:

- **Make voice-activated, hands-free calls** to contacts on their iPhone
- **Play songs in the iTunes library** and even switch music sources automatically from AM/ FM/XM radio to iPod mode
- **Listen to, compose and send an iMessage** or text message to a phone number or anyone in saved contacts
- **Access calendar** and add appointments
- **Answer simple questions** such as game scores or the dates of national holidays; while in eyes free mode, Siri will not provide answers to complex questions that require displaying a web page

¹ Only on Yukon 2015 interim.

4.2" COLOR RADIO

TABLE OF CONTENTS

SIERRA/YUKON¹/CANYON

TERRAIN

ACADIA

BASE RADIO

4.2" RADIO

8" RADIO

8" RADIO W/ NAV

4.2" COLOR RADIO (103) – SIERRA & CANYON ONLY

- 4.2" Diagonal Color Non-touch screen
- Non-connected
- 3.5" Diagonal Monochrome DIC



BASE RADIO PROVIDES RIGHT MIX OF FEATURES

The Base radio provides just the right mix of features for customers purchasing the base truck.

Standard features include:

- AM/FM radio bands
- 25 favorites for AM/FM
- USB port
- Auxiliary jack
- SD card slot
- Rear camera support
- Bluetooth for Phone

¹ Only on Yukon 2015 interim.

4.2" COLOR RADIO

TABLE OF CONTENTS

SIERRA/YUKON¹/CANYON

TERRAIN

ACADIA

BASE RADIO

4.2" RADIO

8" RADIO

8" RADIO W/ NAV

ORIENTATION TO CONTROLS

- 1 Home Page** – with three icons
- 2 Favorite Pages** – press to scroll down through the favorite pages
- 3 Favorites/Softkeys** – press to select favorite stations, press and hold to save favorite stations or press to select a screen button when displayed
- 4 Favorite Pages** – press to scroll up through the favorite pages
- 5 Power/Volume Knob** – press to turn the audio on; press and hold to turn it off; when on, press to mute the system; press again to unmute
- 6 Radio** – press to change the audio source between AM or FM
- 7 Seek** – press to seek radio stations; press to seek the beginning of the current or previous track or press and hold to quickly reverse through a track; release the button to return to playing speed
- 8 Seek** – press to seek radio stations; press to seek the next track or press and hold to fast forward through a track; release the button to return to playing speed
- 9 Home Page Button** – press to go to the Home Page from any point in the system
- 10 Menu/Select Knob** – press to access the menu for the current audio source; press to select the highlighted menu option; turn to scroll through a list; turn to manually select a station
- 11 Media** – press to change the audio source between USB, SD card and Aux
- 12 Tone** – press to open the “Tone Settings Menu”
- 13 Back** – press to return to the previous screen in a menu



HOW TO SAVE FAVORITES

- Select a radio band with the “Radio” button
- Select/tune into a station with the “Menu” knob
- Press one of the five “Favorite/Softkeys” to save the station as a Favorite
- The “Favorite/Softkey” selected displays the station name in the Favorite button

¹ Only on Yukon 2015 interim.

4.2" COLOR RADIO WITH INTELLILINK

TABLE OF CONTENTS

SIERRA/YUKON¹/CANYON

TERRAIN

ACADIA

BASE RADIO

4.2" RADIO

8" RADIO

8" RADIO W/ NAV

4.2" COLOR RADIO WITH INTELLILINK (104)–SIERRA & CANYON ONLY

- 4.2" Diagonal Color Non-touch screen
- Connected
- 3.5" Diagonal Monochrome Driver Information Center (Sierra SLE Regular Cab includes 4.2" Diagonal Color DIC)



ENTRY-LEVEL INTELLILINK SYSTEM CONNECTS CUSTOMERS VIA BLUETOOTH

This IntelliLink radio provides just the right mix of features for customers seeking a **connected** infotainment system.

Standard IntelliLink features include:

- Connected radio: Bluetooth for Phone and Audio streaming
 - Pair up to 10 devices (one active at a time)
 - Download phone book and view/select contacts on screen and via voice recognition system
 - Pandora (native app)
- SiriusXM Audio (with subscription after trial period)
- 25 favorites for AM, FM, XM and media (song, artist, album, genre)
- OnStar (6 months of Directions & Connections Plan)
- Natural language voice recognition
- Gracenote displays album art
- Rear camera support
- USB ports (2)
- Auxiliary jack
- SD card slot
- Text Message Alerts
- Standard OnStar 4G LTE Wi-Fi (3 month/3GB trial–whichever comes first)

SLE Regular Cab features include:

- 4.2" Diagonal Color Driver Information Center
- Steering wheel controls for the display in the DIC and to initiate voice controls
- Phone, audio and OnStar Turn-by-Turn Navigation display on the screen in the DIC

¹ Only on Yukon 2015 interim.

4.2" COLOR RADIO WITH INTELLILINK

TABLE OF CONTENTS

SIERRA/YUKON¹/CANYON

TERRAIN

ACADIA

BASE RADIO

4.2" RADIO

8" RADIO

8" RADIO W/ NAV

ORIENTATION TO CONTROLS



1 Home Page – multiple icons showing four at a time*

2 Favorite Pages – press to scroll down through the favorite pages

3 Favorites/Softkeys – press to select favorite stations, press and hold to save favorite stations or press to select a screen button when displayed

4 Favorite Pages – press to scroll up through the favorite pages

5 Power/Volume Knob – press to turn the audio on; press and hold to turn it off; when on, press to mute the system; press again to unmute

6 Radio – press to change the audio source

7 Seek – press to seek radio stations; press to seek the beginning of the current or previous track or press and hold to quickly reverse through a track; release the button to return to playing speed

8 Seek – press to seek radio stations; press to seek the next track or press and hold to fast forward through a track; release the button to return to playing speed

9 Home Page Button – press to go to the Home Page from any point in the system

10 Menu/Select Knob – press to access the menu for the current audio source; press to select the highlighted menu option; turn to scroll through a list; turn to manually select a station

11 Media – press to change the audio source between USB, SD card, Aux and Bluetooth audio

12 Eject – press to eject the CD/MP3 disc*

13 Back – press to return to the previous screen in a menu

* Box is to note difference from Base 4.2" Color Radio.

¹ Only on Yukon 2015 interim.

4.2" COLOR RADIO WITH INTELLILINK

TABLE OF CONTENTS

SIERRA/YUKON¹/CANYON

TERRAIN

ACADIA

BASE RADIO

4.2" RADIO

8" RADIO

8" RADIO W/ NAV



BLUETOOTH DEVICES

PAIR UP TO 10 DEVICES ONLY ONE ACTIVE AT A TIME

Pairing using faceplate controls:

- Ensure **"Bluetooth"** feature of smartphone is on and devices are discoverable
- Select **"Phone"** icon with **"Menu"** knob
- Select **"Manage Phones"** with **"Menu"** knob
- Select **"Pair"** with **"Favorite/Softkey"** (the button just below **"Pair"**)
- Follow directions on the screen to begin pairing the device
- If PINs match, follow directions on the phone to complete the pairing process
- Screen confirms successful pairing process
- Phone may ask system permission to access phone book; if so, select **"Always permit access"**

As an alternative to pairing with the faceplate buttons, you can initiate pairing through voice recognition by using the **"Favorite/Softkey"** button just below the voice recognition icon. Once pressing the voice recognition key, say one of the following commands and follow the system prompts to complete the pairing process:

- **"Pair phone"**
- **"Pair"**
- **"Bluetooth"**

Video: Pair a Bluetooth Device



SWITCHING CONNECTED PHONES

- To connect to a different phone that's been paired to the system:
 - Select the **"Phone"** icon with **"Menu"** knob
 - Use the **"Menu"** knob to select **"Manage Phones"**
 - Use the **"Menu"** knob to highlight the phone to be connected
 - Press the **"Favorites/Softkey"** button just below the **"Connect"** button on the screen to connect to the highlighted device

¹ Only on Yukon 2015 interim.

4.2" COLOR RADIO WITH INTELLILINK

TABLE OF CONTENTS

SIERRA/YUKON¹/CANYON

TERRAIN

ACADIA

BASE RADIO

4.2" RADIO

8" RADIO

8" RADIO W/ NAV



BLUETOOTH DEVICES

MAKE PHONE CALLS IN ONE OF FOUR WAYS

- Select **“Phone”** icon with **“Menu”** knob
- With the **“Menu”** knob, select from:

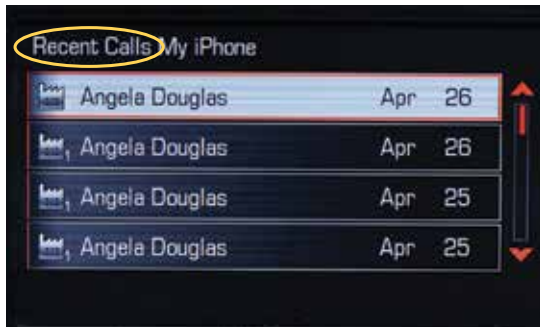

- **“Recent Calls”** (to select a number recently called)

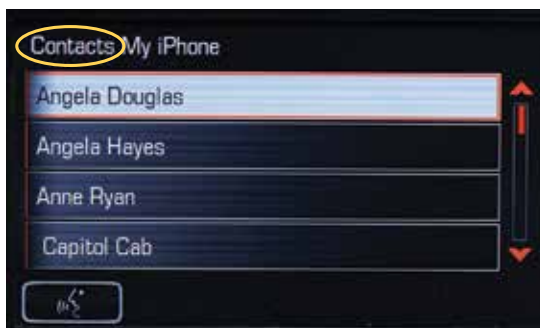

- **“Contacts”** (to select a number from the contact list loaded from a paired phone)



- **“Keypad”** (to dial the number directly by inputting it)

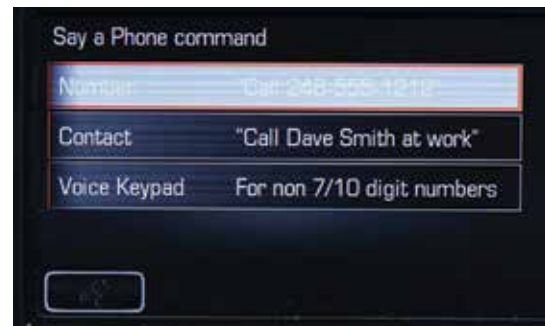

- **“Voice”** (to make calls hands-free using the voice recognition system, follow the prompts)

RECEIVE OR REJECT A CALL

Receiving phone calls is a simple process of pressing **“Answer”** or **“Ignore”** with the **“Favorites/Softkey”** buttons

Video: Make and Receive Phone Calls



¹ Only on Yukon 2015 interim.

4.2" COLOR RADIO WITH INTELLILINK

TABLE OF CONTENTS

SIERRA/YUKON¹/CANYON

TERRAIN

ACADIA

BASE RADIO

4.2" RADIO

8" RADIO

8" RADIO W/ NAV

SLE REGULAR CAB

SIERRA SLE REGULAR CAB OFFERS SELECT ADDITIONAL FEATURES

Additions to this version of the radio, compared to the version with the 3.5" monochrome DIC, are minor.

They include:

- 4.2" Color DIC
- Steering wheel controls for the display in the DIC and to initiate voice controls
- Phone, audio and OnStar Turn-by-Turn Navigation display on the screen in the DIC



HOW TO USE STEERING WHEEL CONTROLS



- 1 Push-to-Talk button (PTT)** – press to initiate and interact with the voice recognition system
- 2 Phone/Mute button** – press to reject an incoming call or end a current call; press to mute or unmute the infotainment system when not on a call
- 3 Previous Menu** – press to go to the previous menu option (press to access the DIC menu)
- 4 Next Menu** – press to go to the next menu option
- 5 Previous Selection** – press to go to the previous selection
- 6 Next Selection** – press to go to the next selection
- 7 Select** – Press to select a highlighted menu option

¹ Only on Yukon 2015 interim.

8" COLOR TOUCH RADIO WITH INTELLILINK

TABLE OF CONTENTS

SIERRA/YUKON¹/CANYON

TERRAIN

ACADIA

BASE RADIO

4.2" RADIO

8" RADIO

8" RADIO W/ NAV

8" INTELLILINK RADIO HIGHLIGHTS

**MAKE INTELLILINK YOUR OWN
WITH MORE WAYS TO CUSTOMIZE**



Choose the information you want to see in the **Driver Information Center** display and change what you see at any time using the **5-way controller on the steering wheel**.



Drag three to five of your most frequently used home screen icons into the app tray for easy access from any screen.



Favorite stations? Contacts? Destinations?² Songs? **Save up to 60 as favorites.**

¹ Only on Yukon 2015 interim.

² Requires optional IntelliLink with Navigation.

³ Requires Pandora account and connected Bluetooth device with Pandora app. Data rates apply.



PHONE, MEDIA AND STREAMING AUDIO ALL CONNECT THROUGH INTELLILINK

Take Control of Bluetooth Devices with IntelliLink

Pair up to **10 Bluetooth devices**. And with certain phones, **see a picture of the incoming caller**.

iPhones have full functionality with IntelliLink when connected via a USB cable. When **paired with IntelliLink via Bluetooth, you can make and receive calls on your iPhone**, see your phone book and control your iPhone through the radio. You can also stream audio and play Pandora², but to control media or streaming audio through IntelliLink, you must tether any Apple device.

Updated Radio and Media Functions

IntelliLink gives you a host of features that make playing music easier:

- MyMedia aggregates the music on multiple USB-connected devices. IntelliLink has multiple USB ports
- Pandora³ has been integrated into the system for one-click play
- iTunes tagging is offered for SiriusXM Radio
- You can Time Shift—record and play back—25 minutes of live radio

8" COLOR TOUCH RADIO WITH INTELLILINK

TABLE OF CONTENTS

SIERRA/YUKON¹/CANYON

TERRAIN

ACADIA

BASE RADIO

4.2" RADIO

8" RADIO

8" RADIO W/ NAV

8" INTELLILINK RADIO HIGHLIGHTS

NATURAL VOICE OR FAMILIAR GESTURES PUT YOU IN CONTROL

Gestures

IntelliLink's touch screen is easy to navigate, because you can use gestures to control radio features.



Natural Language Voice Recognition

Natural language voice recognition allows you to **use everyday language to tell IntelliLink what you want to do.** You don't have to use specific keywords.

Natural voice **commands work for connected Bluetooth devices, contacts** listed in your connected phone's phone book, connected USB devices and the radio.

For example:

- "I want to call John Westin at work"
- "Take me home²"
- "I want to listen to the blues"
- "Play the White Album"
- "Play 'Born in the USA'"

¹ Only on Yukon 2015 interim.

² Requires optional IntelliLink with Navigation.

8" COLOR TOUCH RADIO WITH INTELLILINK

TABLE OF CONTENTS

SIERRA/YUKON¹/CANYON

TERRAIN

ACADIA

BASE RADIO

4.2" RADIO

8" RADIO

8" RADIO W/ NAV

HOME PAGE



1 Temperature

2 Time

3 Audio – brings up active source page

4 Phone – brings up phone menu page

5 Nav – brings up access to main navigation menu, destination entries and map views; also links to OnStar Turn-by-Turn Directions. **The “Nav” icon is included on every 8” radio even if not equipped with Navigation.*** With available Navigation, the icon brings up Nav menu; without available Navigation, the Nav icon brings up compass or OnStar Turn-by-Turn Directions

6 Settings – brings up list of available submenus: set time and date, language, valet mode, radio Settings, vehicle Settings, Bluetooth, voice, display, rear camera², return to factory Settings and software information

7 Pandora³ – brings up active Pandora page

8 Weather – access daily and extended forecasts with a subscription to SiriusXM Travel Link

9 Text Message Alerts – a hands-free method of receiving text messages

10 OnStar – brings up OnStar menu including 4G LTE Wi-Fi Settings: new GMC vehicles come with six months of OnStar Directions & Connections; Turn-by-Turn Directions integrate with “Nav” icon

11 Page indicator – indicates how many home pages are accessible

12 Interaction selector – brings up favorites

*Nav icon on all 8" radios.

¹ Only on Yukon 2015 interim.

² If vehicle is so equipped.

³ Requires Pandora account and connected Bluetooth device with Pandora app. Data rates apply.

BACK

15

NEXT

8" COLOR TOUCH RADIO WITH INTELLILINK

TABLE OF CONTENTS

SIERRA/YUKON¹/CANYON

TERRAIN

ACADIA

BASE RADIO

4.2" RADIO

8" RADIO

8" RADIO W/ NAV



AUDIO PAGE

Video: Audio Page Overview



1 App tray – holds three to five of your most frequently used icons for access from any page; app tray comes from factory with three apps which may be substituted with other icons using the press and drag gestures

2 Browse – brings up list of available stations or music selections for that audio source

3 Source Indicator – shows source currently playing

4 Voice – push to bring up on-screen guide to voice commands and activate voice commands

5 Time Shift controls – allows recording and playback of live radio

6 Menu – brings up list of options available for that audio source

7 Favorites – To access favorites, drag the bar up from the bottom of the screen. Then swipe left, right or up from the list to reveal several more lines of favorites

¹ Only on Yukon 2015 interim.

8" COLOR TOUCH RADIO WITH INTELLILINK

TABLE OF CONTENTS

SIERRA/YUKON¹/CANYON

TERRAIN

ACADIA

BASE RADIO

4.2" RADIO

8" RADIO

8" RADIO W/ NAV

ORIENTATION TO CONTROLS



THE FACEPLATE

- 1 On/Off Volume knob**
- 2 Radio button** – press to cycle through available radio bands, e.g., AM, FM, SiriusXM
- 3 Seek forward and backward**
- 4 Home** – goes to Home Page
- 5 Scroll/Select Menu knob**
- 6 Media button** – press to cycle through available media, e.g., USB, CD, Bluetooth
- 7 CD eject button**
- 8 Back** – goes to previous page
- 9 CD slot**



FAVORITES AND VOLUME CONTROLS LOCATED BEHIND THE STEERING WHEEL

- 1 Favorites** – when on a radio source, press to select the next or previous Favorite; when on a media source, press to select the next or previous track
- 2 Volume** – press to increase or decrease the volume

STEERING WHEEL CONTROLS



- 1 Push-To-Talk**
 - Initiates voice recognition
 - Answers incoming call
- 2 Mute/Hang Up/Ignore Call**

5-WAY CONTROLLER FOR DIC DISPLAY

- 3 Arrow Left** – Press to **bring up menu** with display options as shown above
 - Info
 - Audio
 - Phone
 - Navigation
 - Settings
- 4 Check mark** – press to **select a menu item**
- 5 Arrow Right** – press to **bring up submenus**
- 6 Arrow Up/Down** – press to **scroll through menus and submenus**

Video: Customize the DIC Display



¹ Only on Yukon 2015 interim.

8" COLOR TOUCH RADIO WITH INTELLILINK

TABLE OF CONTENTS

SIERRA/YUKON¹/CANYON

TERRAIN

ACADIA

BASE RADIO

4.2" RADIO

8" RADIO

8" RADIO W/ NAV

INTERACTING WITH INTELLILINK

Video: Customize the Home Page and App Tray



CUSTOMIZE THE HOME PAGE

Touching and holding an icon on the Home Page puts the page into edit mode, signified by the brackets around the icons. Then, you can:

- Drag the icons to a new position on the page
- Drag the icons to the right edge of the page and hold until they move to the next page
- Drag items into the app tray
- Drag items out of the app tray

To exit edit mode, press the **“Home”** button.

USE GESTURES ON THE TOUCH SCREEN

To make it easier and faster to navigate through IntelliLink's screens, IntelliLink recognizes many gestures that will be familiar to users.

Gestures

- **Press** to select an icon or option, activate an application or change the location within a map¹
- **Press and hold** to start another gesture, move or delete an application
- **Drag** to move an application on the Home Page or to pan a map². To drag an item, you must first press and hold it, then you can drag it up, down, right or left to the new location

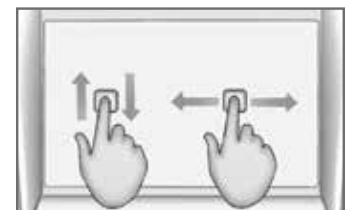

- **Swipe or fling** through a list to reveal more favorites, to pan a map quickly¹ or to change page views. To fling or swipe through a list, for example, place your finger on the screen then move it up or down rapidly



- To enhance touch screen operation:

- **Start on Home Page**
- **Press “Settings”**
- **Press “Display”**
- **Press “Calibrate”**
- Then follow the instructions on the screen

¹ Only on Yukon 2015 interim.

² Requires optional IntelliLink with Navigation.

8" COLOR TOUCH RADIO WITH INTELLILINK

TABLE OF CONTENTS

SIERRA/YUKON¹/CANYON

TERRAIN

ACADIA

BASE RADIO

4.2" RADIO

8" RADIO

8" RADIO W/ NAV

INTERACTING WITH INTELLILINK

Video: Natural Language Voice Recognition



NATURAL LANGUAGE VOICE RECOGNITION

- Press the **“Push-to-Talk”** button on steering wheel one time to **initiate voice recognition** or press the **“Voice”** button on the touch screen
 - Listen for system response and beep
 - Then speak
 - Pressing the **“Voice”** button on the touch screen brings up some **suggested voice commands**, as does pressing the **“Push-to-Talk,”** waiting for the beep and saying, **“Help”**
 - Gracenote enables **natural voice commands** for music
 - You may ask IntelliLink to play music from USB-connected media by song title, album title, artist name or music genre
 - Natural language voice recognition allows you to speak normally to the system, without memorizing commands
 - **Voice commands cannot be used with Pandora**
 - Voice commands are only available in English
- For example:
- “I want to call John Westin at work”
 - “Take me home²”
 - “I want to listen to the blues”
 - “Play the White Album”
 - “Play Born in the USA”

¹ Only on Yukon 2015 interim.

² Requires optional IntelliLink with Navigation.

8" COLOR TOUCH RADIO WITH INTELLILINK

TABLE OF CONTENTS

SIERRA/YUKON¹/CANYON

TERRAIN

ACADIA

BASE RADIO

4.2" RADIO

8" RADIO

8" RADIO W/ NAV

RADIO AND USB MEDIA



TIME SHIFT LIVE RADIO

- To initiate, press the **“Pause”** button at the bottom of the screen—this **pauses live radio** and **indicates the time of day that you started recording the station**
- Press **“Play”** button to **listen to the recorded station**
- Press **“Rewind”** or **“Forward”** buttons to **reverse or advance playback** positions of recorded station
- Press and **HOLD “Forward”** button to **fast forward to the end** of the recording and return to the live broadcast of the station
- **If you change radio bands or stations, the “buffer” resets** and begins recording the new station automatically

Video: Play USB-Connected Media



USE MYMEDIA

MyMedia **aggregates the audio files from multiple USB devices** into one library for access to all the media without changing from device to device. To use MyMedia:

- Press the **“Media”** button on the faceplate until **“MyMedia”** appears where you would see album art
- Press the **“MyMedia”** icon on the touch screen to see the aggregated menu

When multiple USB devices are connected at the same time, IntelliLink will not display album art.

¹ Only on Yukon 2015 interim.

8" COLOR TOUCH RADIO WITH INTELLILINK

TABLE OF CONTENTS

SIERRA/YUKON¹/CANYON

TERRAIN

ACADIA

BASE RADIO

4.2" RADIO

8" RADIO

8" RADIO W/ NAV

FAVORITES – SAVE AND PLAY

Video: Favorites



SAVE UP TO 60 FAVORITES

- Select the **"Settings"** icon on Home Page, then choose **"Radio"** and **"Number of Favorites"**
 - Select **"Auto"** or number of favorites you want available



- Return to **Home Page**
- Select **"Audio"**
- **Tune a radio station** you want to save as a Favorite
- To save station, **press and hold an available Favorites space** until you hear a beep
- Use the same method to save destinations, songs, albums, artists, genres and contacts

¹ Only on Yukon 2015 interim.

PLAY FAVORITES

- To see a **partial list of Favorites**, press the arrow on the bottom right of the screen



- Then swipe the list sideward to see more; then touch the station you want to play



- To see a **full list of Favorites**, swipe upward from the partial list, then touch the station you want to play
- Use the **Favorites paddle** at the back of the steering wheel on the left side to cycle through Favorites; when you stop, the station plays



8" COLOR TOUCH RADIO WITH INTELLILINK

TABLE OF CONTENTS

SIERRA/YUKON¹/CANYON

TERRAIN

ACADIA

BASE RADIO

4.2" RADIO

8" RADIO

8" RADIO W/ NAV

FAVORITES – CUSTOMIZE



“MANAGE” OR CUSTOMIZE FAVORITES

- Select the **“Settings”** icon on Home Page, then choose **“Radio”** and **“Manage Favorites”**
- To **re-order Favorites**, press and hold a Favorite, then drag it to a new location
- To **delete a Favorite**, select it and press **“Delete”**
- To **rename a Favorite**, select it, press **“Rename”** and enter new name on keypad



- Touch **“Exit”** to leave **“Manage Favorites”** screen and **save changes**

¹ Only on Yukon 2015 interim.

8" COLOR TOUCH RADIO WITH INTELLILINK

TABLE OF CONTENTS

SIERRA/YUKON¹/CANYON

TERRAIN

ACADIA

BASE RADIO

4.2" RADIO

8" RADIO

8" RADIO W/ NAV



BLUETOOTH DEVICES

Video: Pair a Bluetooth Device



PAIR UP TO 10 DEVICES ONLY ONE ACTIVE AT A TIME

Pair a Device

- Start with vehicle in **"Park,"** then **initiate pairing by one of two ways:**
 - Press the **"Phone" icon,** select **"Phones"** then, select **"Pair new device"**
 - Press the **"Push-to-Talk"** button on steering wheel, wait for system response and beep, then say **"Bluetooth"** or **"Pair Phone"**
- **PIN** appears
- **Start the pairing process** on phone
- Locate **"GMC IntelliLink"** on phone and match or enter PIN (depending on phone)
- The screen replies **"Device name has been successfully paired"**
- The phone may ask permission to allow system to access phone book. If a message requesting permission appears on your phone, simply confirm the request

LIST/CHANGE CONNECTED PHONE

- Press the **"Phone" icon**
- Select **"Phones"**
- Change **check mark** to phone you want connected
- You may pair up to 10 phones but only use one at a time

SWITCH TO HANDSET OR HANDS-FREE MODE

- Press the **"Phone" icon** during call to display **"Call View"**
- Press **"Handset"** to switch to handset mode

¹ Only on Yukon 2015 interim.

8" COLOR TOUCH RADIO WITH INTELLILINK

TABLE OF CONTENTS

SIERRA/YUKON¹/CANYON

TERRAIN

ACADIA

BASE RADIO

4.2" RADIO

8" RADIO

8" RADIO W/ NAV

BLUETOOTH DEVICES

Video: Make and Receive Phone Calls



Video: Play Pandora



RECEIVE OR REJECT CALL

- Receive call
 - Press the “Push-to-Talk” button on steering wheel
 - Press “Answer” on touch screen
- Reject call
 - Press the “End Call/Mute” button on steering wheel
 - Press “Ignore” on touch screen

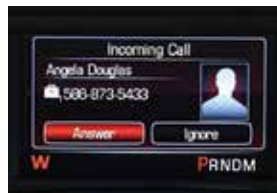

MAKE CALL OR END CALL

- Using **contacts** from touch screen
 - Press the “Phone” icon on touch screen
 - Select “Contacts”
 - Select name to call
- Using **contacts** with voice commands
 - Press “Push-to-Talk”
 - After system response and beep, say “call” and name of contact
- Using **recent contacts** from touch screen
 - Press the “Phone” icon on screen
 - Select “Recent”
 - Use the “View” button on top right of list to select between “Missed,” “Recent” and “Sent” calls
- **End a call**
 - Press the “End Call” button on steering wheel or
 - Press “End Call” on the touch screen

STREAM PANDORA

- **Set up an account** at Pandora.com and **download app** to mobile device
- **Connect** iPhone/iPad via USB and other devices via Bluetooth—**data rates apply**
- **System displays last tuned station** while displaying “Launching Pandora Radio Station” (launch time may take a few moments)
- **Use on-screen controls** to skip track or vote “Thumbs up” or “Thumbs down” (**voice commands do not work with Pandora**)
- The Pandora “Menu” gives you additional options
 - Bookmark artist – sends bookmark to Pandora account
 - Bookmark song – sends bookmark to Pandora account



¹ Only on Yukon 2015 interim.

8" COLOR TOUCH RADIO WITH INTELLILINK

TABLE OF CONTENTS

SIERRA/YUKON¹/CANYON

TERRAIN

ACADIA

BASE RADIO

4.2" RADIO

8" RADIO

8" RADIO W/ NAV



USING SETTINGS TO CUSTOMIZE THE SYSTEM



Video: Use Radio Settings



TIME AND DATE

- Set **time/auto set** (syncs clock automatically)
- Set **date/auto set** (syncs date automatically)
- **Clock display** – turns display on and off

LANGUAGE

- English
- French Canadian
- Spanish

VALET MODE (IF EQUIPPED)

- **Locks** infotainment system, steering wheel controls, steering column (if equipped with tilt/telescoping wheel) and vehicle storage locations
 - Enter 4-digit code on keypad
 - Press **“Enter”** to go to confirmation screen
 - Re-enter 4-digit code
 - Press **“Lock”** to lock the system
 - Enter 4-digit code again to unlock the system
 - Press the **“Back”** button on screen or faceplate to return to previous menu



RADIO SETTINGS

- **Manage Favorites**
 - Delete, reorganize and re-name them
- **Number of Favorites Shown**
 - Choose how many favorites are available
- **Audible Touch Feedback**
 - An on/off function for feedback you hear when you touch the screen
- **Auto Volume**
 - Adjusts automatic volume compensation for road noise—off, low, medium-low, medium, medium-high, high
- **Maximum Start-up Volume**
 - Sets maximum volume at vehicle start-up
- **Audible Cue Volume**
 - Sets volume of system cues at vehicle start-up



¹ Only on Yukon 2015 interim.

8" COLOR TOUCH RADIO WITH INTELLILINK

TABLE OF CONTENTS

SIERRA/YUKON¹/CANYON

TERRAIN

ACADIA

BASE RADIO

4.2" RADIO

8" RADIO

8" RADIO W/ NAV

USING SETTINGS TO CUSTOMIZE THE SYSTEM



VEHICLE SETTINGS

- **Climate and Air Quality**
 - Auto functions for max fan speed and front and rear defog
- **Collision/Detection Systems**
 - On/Off for Side Blind Zone Alert and Rear Cross Traffic Alert (if equipped)
- **Comfort and Convenience**
 - Chime volume
- **Lighting**
 - Turn vehicle locator lights on or off
 - Set timing for exit lighting for 30, 60 or 120 seconds
- **Power Door Locks**
 - Unlocked door/anti lockout
 - When "On," this function keeps driver door from locking when the door is open
 - If "Off," Delayed Door Lock Menu becomes available
 - Auto door unlock
 - Allows selection of which doors automatically unlock when vehicle is shifted into "Park"

- Delayed door lock
 - When "On," this feature delays the locking of doors
 - To override the delay, press the power door lock switch on the door and select "Off" or "On"
- **Remote Lock/Unlock/Start**
 - Remote unlock light feature
 - Remote lock feature
 - Remote start auto heat seats (if equipped)

BLUETOOTH SETTINGS

- **Pair New Device**
 - An alternative location to initiate pairing
- **Device Management**
 - Shows list of paired devices
 - Allows you to switch to another paired device
- **Ringtones**
 - Choose how Bluetooth-connected phone sounds when it rings in vehicle
- **Voice Mail Numbers**
 - Displays number to call to check voice mail for connected device

VOICE SETTINGS

- **Prompt Length**
 - Set for short, abbreviated system prompts
 - Set for long, explanatory system prompts
- **Auto Feedback Speed**
 - Short, medium or long

REAR CAMERA

- **Guidance Lines**
 - On or Off
- **Rear Cross Traffic Alert** (if equipped)
 - On or Off
- **Rear Park Assist Symbols** (if equipped)
 - On or Off

RETURN TO FACTORY SETTINGS

- **Restore vehicle Settings**
- **Clear all private data** (clears paired Bluetooth devices)
- **Restore radio Settings**

¹ Only on Yukon 2015 interim.

8" COLOR TOUCH RADIO WITH INTELLILINK & NAVIGATION

TABLE OF CONTENTS

SIERRA/YUKON¹/CANYON

TERRAIN

ACADIA

BASE RADIO

4.2" RADIO

8" RADIO

8" RADIO W/ NAV



8" COLOR TOUCH RADIO WITH INTELLILINK AND NAVIGATION (106)



Available Navigation highlights:

- Multiple methods to enter a destination
- Multiple map views including 3-D for most major US cities and attractions
- SiriusXM Travel Link with subscription
- SiriusXM NavTraffic with subscription to monitor traffic conditions, re-routing to avoid closures and delays

¹ Only on Yukon 2015 interim.

8" COLOR TOUCH RADIO WITH INTELLILINK & NAVIGATION

TABLE OF CONTENTS

SIERRA/YUKON¹/CANYON

TERRAIN

ACADIA

BASE RADIO

4.2" RADIO

8" RADIO

8" RADIO W/ NAV

HOW TO USE NAVIGATION

Video: Enter a Destination



To use the **"Address" method**, enter the letters and the numbers on the alphanumeric keypad until all lines of the entry are complete or conduct a search by beginning to enter an address, an intersection, a highway or a freeway entrance ramp.



ENTER A DESTINATION

IntelliLink features multiple ways to enter a destination. First **press the "Navigation" icon**, then the **"Destination" icon on the map**. From there you can choose five methods:

- Voice Recognition
- Address
- Recent Destinations
- Contacts
- Places of Interest



Use the **"Places of Interest" method** to drill down to categories to begin a search of these destinations.

Press "Go" on the touch screen to begin route guidance.

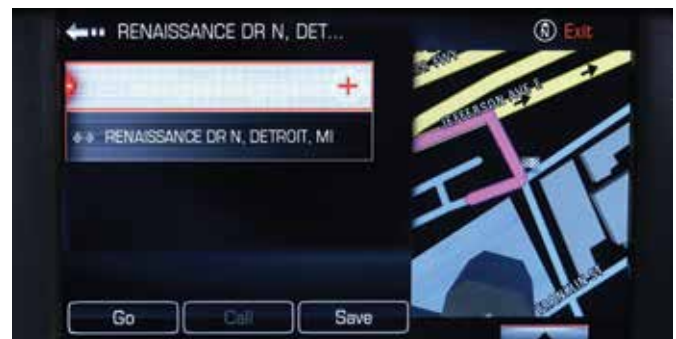

¹ Only on Yukon 2015 interim.

8" COLOR TOUCH RADIO WITH INTELLILINK & NAVIGATION

TABLE OF CONTENTS

SIERRA/YUKON¹/CANYON

TERRAIN

ACADIA

BASE RADIO

4.2" RADIO

8" RADIO

8" RADIO W/ NAV

HOW TO USE NAVIGATION

Video: Use Guidance and Maps



MAP GUIDANCE

When under route guidance, “ETA,” or **estimated time of arrival**, is displayed on the right side of the map view. Press the “ETA” information area to toggle between key destination information that includes:

- Estimated arrival time
- **Trip duration**
- **Driving distance**

Press the “**Turn List**” information area to display all the turns in the guided route.

TURN ON SEVERE WEATHER ALERT

This feature, which will send severe weather alerts to IntelliLink (within a 45-mile radius around the vehicle) is set to “off” from the factory. To turn it on:

- Select “**Weather**” on the Home Page
- Select “**Menu**,” then turn Advisories on as shown



To **suspend current route guidance**, press the “**Menu**” button and the “**Cancel Route**” option.

¹ Only on Yukon 2015 interim.

8" COLOR TOUCH RADIO WITH INTELLILINK & NAVIGATION

TABLE OF CONTENTS

SIERRA/YUKON¹/CANYON

TERRAIN

ACADIA

BASE RADIO

4.2" RADIO

8" RADIO

8" RADIO W/ NAV

HOW TO USE NAVIGATION



USE NATURAL LANGUAGE VOICE RECOGNITION FOR NAVIGATION

Natural language voice recognition allows you to **tell IntelliLink where you want to go** in everyday language.

To use voice recognition from the steering wheel controls, press the "Push-to-Talk" button, listen for the system response and the beep, then speak one of the commands—**"Destination Address,"** or **"Destination Places of Interest,"** or **"Destination Contact"**—to begin a dialogue with the system.

Then, speak to the system using natural language:

- Address: "I want to go to 300 Renaissance Center"
- POI: "Find a gas station"
- Contact: "Take me to Peter Mitchell's house"

ADDITIONAL FEATURES WITH A SUBSCRIPTION TO SIRIUSXM TRAVEL LINK

- **Weather icon:** With a subscription to **SiriusXM Travel Link**, access to daily and extended forecasts



- **SiriusXM Travel Link** also gives you access to fuel prices and movie listings integrated into Places of Interest categories/destination method



ONSTAR TURN-BY-TURN NAVIGATION

An OnStar subscriber has the ability to connect to the OnStar system and ask an OnStar Advisor to download a destination into the system. OnStar will send address information and location coordinates of the destination into IntelliLink's navigation system.

¹ Only on Yukon 2015 interim.

INTELLILINK – TERRAIN

TABLE OF CONTENTS

SIERRA/YUKON/CANYON

TERRAIN

ACADIA

NEW FEATURES HELP KEEP CUSTOMERS CONNECTED

ONSTAR 4G LTE WI-FI¹ MAKES YOUR VEHICLE A ROLLING HOTSPOT

Your vehicle can be a rolling mobile hub with great signal quality and bandwidth for up to seven devices. OnStar with 4G LTE service allows everyone in your vehicle to enjoy his or her own content. A three-month/3GB, whichever comes first, trial is included when the OnStar complimentary service is activated (OnStar's Basic Plan is included for five years). Click on the "Fast Facts" icon below for more information. Press the OnStar Voice Command Button on the mirror or overhead console or, if available, select the "OnStar" icon on the radio home screen. Wait for the prompt and the beep and say, "Wi-Fi Settings." The screen will display the name and password for your Wi-Fi hotspot. Go to Settings on the device you want to connect and find the name of your vehicle's 4G LTE Wi-Fi connection. Select the hotspot and input the password. Then, connect. Press the blue OnStar button and speak to an Advisor to change your 4G LTE Wi-Fi name and/or password, or manage your settings in your RemoteLink mobile app.



Video: OnStar 4G LTE Wi-Fi



INTELLILINK OFFERS TEXT MESSAGE ALERTS

If your Terrain with IntelliLink is paired with a Bluetooth device that supports Text Message Alerts, the system:

- **Can display incoming text messages**
- **Can play incoming text messages** over the audio system
- **Can respond to incoming texts with preset messages**
- **Requires a compatible smartphone** with Bluetooth profile (M.A.P.) **and applicable text messaging features.** For more information about varying capabilities, go to gmttotalconnect.com. For example, iPhones require unique setup requirements and offer limited Text Message Alert capabilities



Video: Text Message Alerts

HOW TO USE TEXT MESSAGING

- Press **"Message"** button on Home Page
- When messages are retrieved, **"Text Message" inbox displays**
- Select message for viewing (**only available when vehicle is not moving**)
- Select **"Reply"** to reply and select desired message from display of preset messages, then select "Send" (this function is not available for iPhones)
- **Incoming text messages**
 - Pop-up screen displays
 - Select "Listen," "View," "Dismiss" or "Call"
 - Turn off display alerts from the "Settings" button

SETTING UP TEXT MESSAGING DURING PHONE PAIRING

- **Android and BlackBerry** give you a pop-up right after you pair, asking whether you want to allow access to your messages
- **For iPhone** you have to go into Settings, then Bluetooth, select your vehicle and turn on notifications
- **Notes for iPhone**
 - Text messaging functionality with compatible iPhones is limited to Apple restrictions on what the radio can access, e.g., text messages received prior to entering the vehicle will not be displayed, and you cannot reply to a text message
 - "Show Notifications" must be enabled on the phone to allow the radio to access messaging; this can be enabled by the following steps (after pairing and connecting to the radio):
 - On the phone, select Settings, then Bluetooth, then properties (either device-friendly name such as "GMC Terrain" or "Radio"), then turn on "Show Notifications"
 - Restart vehicle for connection to take hold
 - Once set, it is retained for future connections
- **Visit gmttotalconnect.com for vehicle and smartphone compatibility**

INTELLILINK – TERRAIN

TABLE OF CONTENTS

SIERRA/YUKON/CANYON

TERRAIN

ACADIA

SIRI EYES FREE FOR IPHONE USERS

Siri Eyes Free gives **compatible iPhone users hands-free access to some of their phone's features**, like the **calendar** and **text messaging**.

Siri Eyes Free allows users to direct Siri to perform a number of tasks while they safely keep their eyes on the road and their hands on the wheel. To further minimize distraction, Siri takes hands-free functionality even further with an **Eyes Free mode** that enables users to **interact with their iPhone using nothing more than their voice** while keeping the device's screen from lighting up, one more potential distraction that Siri Eyes Free eliminates.

HOW TO USE SIRI EYES FREE

Owners simply **connect their iPhone** with the IntelliLink radio via Bluetooth, pair with the system, and use the Push-to-Talk (PTT) button on the steering wheel controls to begin and end sessions with Siri in Eyes Free mode. Press and hold the PTT button long enough until Siri speaks; pressing and holding the PTT button for too short a period of time will engage the onboard voice recognition system and bypass Siri. Siri can:

- Make voice-activated, **hands-free calls to contacts on their iPhone**
- **Play songs in the iTunes library** and even switch music sources automatically from AM/FM/XM radio to iPod mode
- **Listen to, compose and send an iMessage or text message** to a phone number or anyone in saved Contacts
- **Access calendar and add appointments**
- **Answer simple questions** such as game scores or the dates of national holidays; while in Eyes Free mode, Siri will not provide answers to complex questions that require displaying a web page



Video: Siri Eyes Free



INTELLILINK – ACADIA

TABLE OF CONTENTS

SIERRA/YUKON/CANYON

TERRAIN

ACADIA

FEATURES ADD VALUE FOR CUSTOMERS

Acadia customers enjoy their IntelliLink radios even more with the ability to receive text messages and **enhance the radio's personalization** with SiriusXM TuneSelect.

ACADIA GETS NEW HANDS-FREE FEATURE

Siri Eyes Free for iPhone Users

Siri Eyes Free gives compatible iPhone users **hands-free access to some of their phone's features**, like the calendar and text messaging.

Siri Eyes Free allows users to direct Siri to perform a number of tasks while they safely keep their **eyes on the road and their hands on the wheel**. The Eyes Free mode enables users to interact with their iPhone using nothing more than their voice. And it **keeps the device's screen from lighting up**, one more potential distraction that Siri Eyes Free eliminates.

How to Use Siri Eyes Free

Owners simply **connect their iPhone with the radio via Bluetooth**, pair with the system, and **use the Push-to-Talk (PTT) button on the steering wheel** to begin and end sessions with Siri in Eyes Free mode.

Press and hold the PTT button long enough until Siri speaks; pressing and holding the PTT button for too short a period of time will engage the onboard voice recognition system and bypass Siri. Siri can:

- **Make voice-activated, hands-free calls** to contacts on their iPhone
- **Play songs in the iTunes library** and even switch music sources automatically from AM/ FM/XM radio to iPod mode
- **Listen to, compose and send an iMessage** or text message to a phone number or anyone in saved contacts
- **Access calendar** and add appointments
- **Answer simple questions** such as game scores or the dates of national holidays; while in eyes free mode, Siri will not provide answers to complex questions that require displaying a web page

INTELLILINK OFFERS TEXT MESSAGE ALERTS

If your Acadia with IntelliLink is paired with a Bluetooth device that supports Text Message Alerts, the system:

- **Can display incoming text messages**
- **Can play incoming text messages** over the audio system
- **Can respond to incoming texts with preset messages**
- **Requires a compatible smartphone** with Bluetooth profile (M.A.P.) **and applicable text messaging features**. For more information about varying capabilities, go to gmttotalconnect.com. For example, iPhones require unique setup requirements and offer limited Text Message Alert capabilities

HOW TO USE TEXT MESSAGING

- Press **"Message"** button on Home Page
- When messages are retrieved, **"Text Message" inbox displays**
- **Select message for viewing** (only available when vehicle is not moving)
- Select **"Reply"** to reply and select desired message from display of preset messages, then select "Send" (this function is not available for iPhones)
- **Incoming text messages**
 - Pop-up screen displays
 - Select "Listen," "Play" or "View"
 - Turn off display alerts from the "Settings" button

Video: Text Messaging



INTELLILINK – ACADIA

TABLE OF CONTENTS

SIERRA/YUKON/CANYON

TERRAIN

ACADIA

FEATURES ADD VALUE FOR CUSTOMERS

SETTING UP TEXT MESSAGING DURING PHONE PAIRING

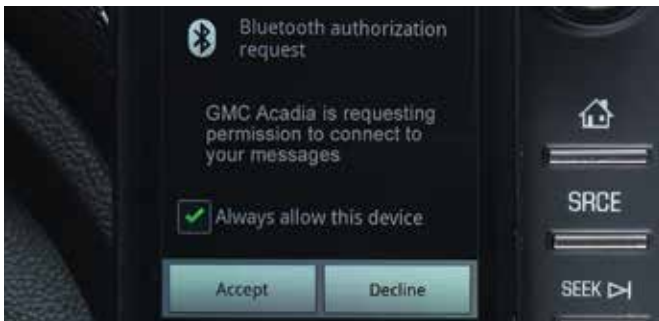

- **Android and BlackBerry** give you a pop-up right after you pair, asking whether you want to allow access to your messages



- **iPhone** you have to go into Settings, then Bluetooth, select your vehicle and turn on notifications

• Notes for iPhone

- Text messaging functionality with iPhones is limited to Apple restrictions on what the radio can access, e.g., text messages received prior to entering the vehicle will not be displayed, and you cannot reply to a text message
- “Show Notifications” must be enabled on the phone to allow the radio to access messaging; this can be enabled by the following steps (after pairing and connecting to the radio):
 - On the phone, select Settings, then Bluetooth, then properties (either device-friendly name such as “GMC Acadia” or “Radio”), then turn “Show Notifications”
 - Restart vehicle for connection to take hold
 - Once set, it is retained for future connections
- Visit gmttotalconnect.com for vehicle and smartphone compatibility

HEAR YOUR FAVORITE ARTISTS OR SONGS MORE OFTEN WITH TUNESELECT

IntelliLink Radios with Navigation equipped with SiriusXM, can be set to **alert you when a selected artist or song is playing on another XM Station.** To use:

- Select “**Menu**” when the specific song or artist is playing. Select TuneSelect and the following will display
 - Artist: Press to set an audio alert when the current artist is playing on a SiriusXM channel
 - Song: Press to set an audio alert when the current song is playing on a SiriusXM channel
- TuneSelect Manager: Press “Disable/Enable All Alerts” to enable or disable all alerts; a check mark next to the alert means it is turned on. Press an alert to turn it off; press “Delete” to delete an alert
- Audible Alert: This feature will give an audio alert when certain artists or songs are available on a specific station. Press to turn on or off