



Installation No.: 01POUCH V1,
01-11-2011

Patterns: SEE LIST ON LAST PAGE

Title: FRONT SIAB INSTALLATION NOTES

******CAUTION******

READ THESE INSTRUCTIONS IN FULL BEFORE BEGINNING ANY WORK ON THE VEHICLE

- A. DURING THE REMOVAL OF THE FACTORY CLOTH SEAT COVERS, PAY CAREFUL ATTENTION TO THE LOCATION, POSITION AND PLACEMENT OF ALL CABLES, CONNECTIONS, STRAPS AND OR ATTACHMENTS IN ORDER TO REPLICATE DURING THE INSTALLATION OF THE KATZKIN LEATHER INTERIOR.
- B. FAILURE TO FOLLOW INSTALLATION INSTRUCTIONS TO INCLUDE OEM SPECIFICATIONS FOR THE HANDLING OF THE VEHICLE'S COMPONENTS MAY RESULT IN A FAILURE OF THE VEHICLE'S SAFETY SYSTEMS. CONSULT THE VEHICLE MANUFACTURERS INSTRUCTIONS FOR DETAILS.
- C. IF YOU HAVE QUESTIONS PRIOR TO OR DURING THE INSTALLATION PROCESS, STOP AND IMMEDIATELY CALL KATZKIN'S TECHNICAL SUPPORT SPECIALIST (Doug Hinson 323.610.4540).
- D. BEFORE BEGINNING YOUR WORK ON THE VEHICLE, DISCONNECT THE NEGATIVE BATTERY TERMINAL TO ENSURE THERE IS NO POWER TO THE VEHICLE.
- E. WAIT FOR AT LEAST 10 MINUTES AFTER DISCONNECTING THE BATTERY CABLE TO AVOID ACCIDENTAL DEPLOYMENT OF THE VEHICLE SAFETY SYSTEM AND/OR RELATED WARNING LIGHTS
- F. IN ORDER TO AVOID DAMAGE, USE CARE WHEN HANDLING THE SEATS OR ANY OTHER VEHICLE COMPONENTS. DO NOT DROP OR DRAG SEATS.

******CAUTION******

BEFORE WORKING ON VEHICLE—MAKE SURE THE NEGATIVE BATTERY TERMINAL HAS BEEN DISCONNECTED FOR AT LEAST 10 MINUTES TO PREVENT ACCIDENTAL AIRBAG DEPLOYMENT

1. Remove the factory cloth front back cover from the seat back (see Diagram 1.1)

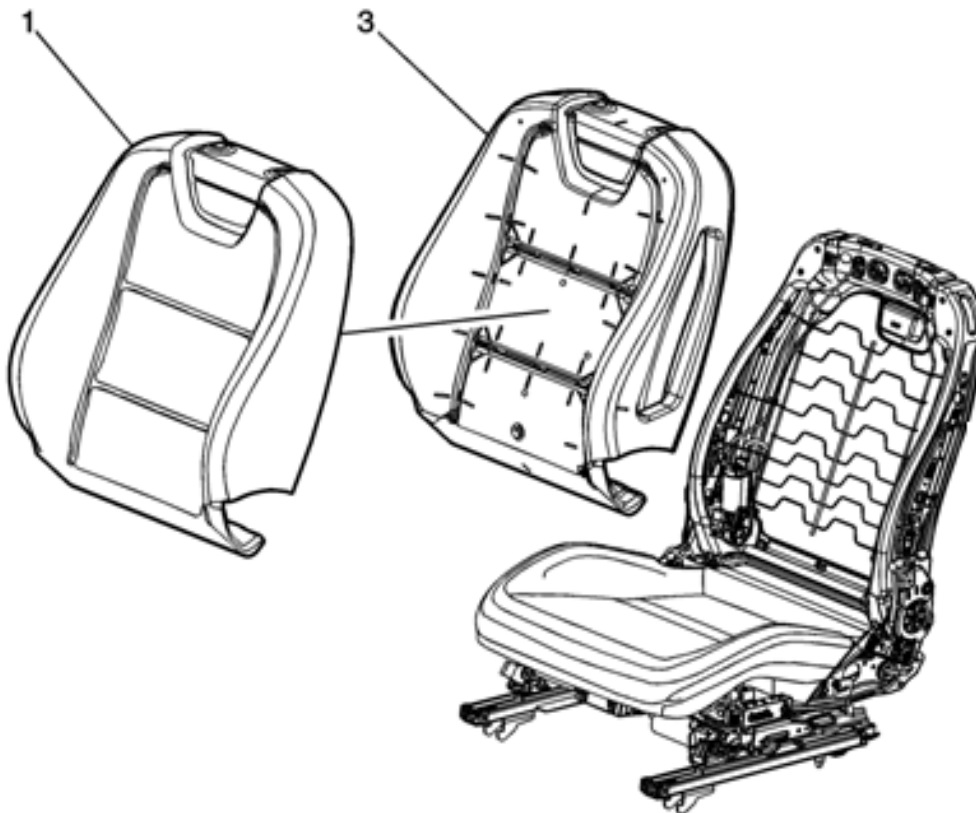
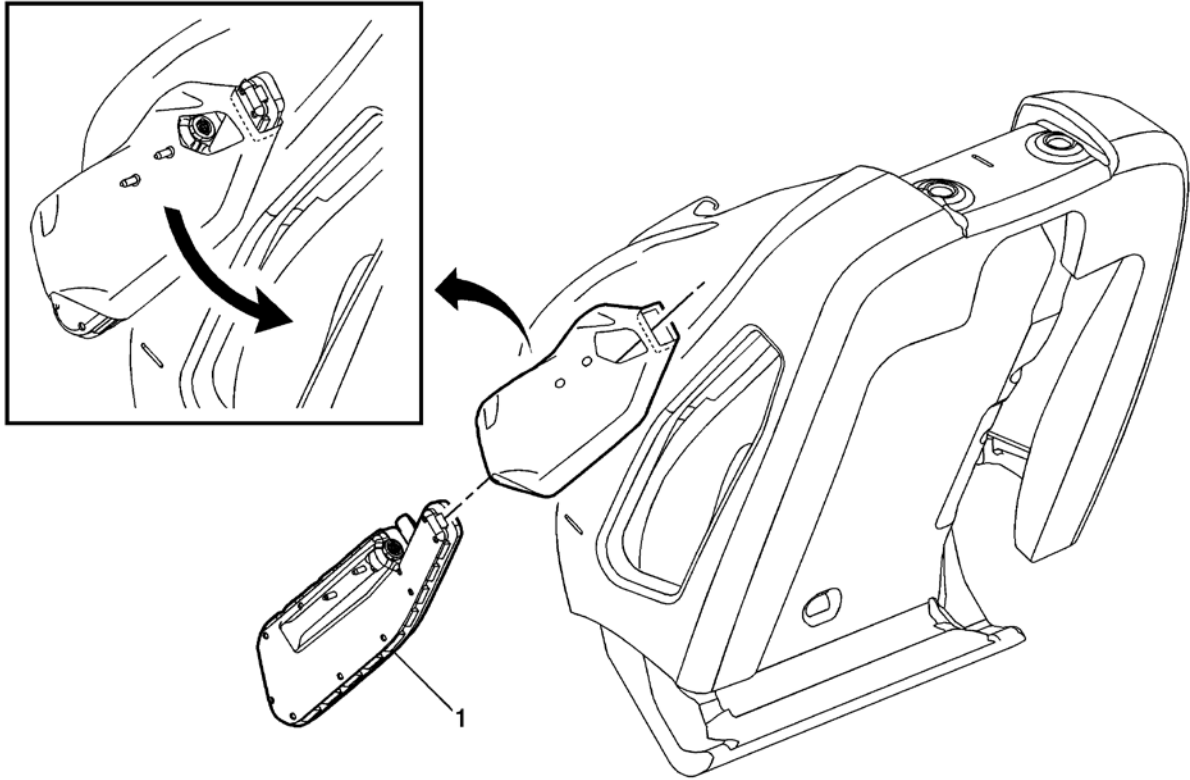

Diagram 1.1

2. Remove the module out of the pouch by removing the two nuts and sliding it out of the larger opening. Separate the cloth from the foam by removing the hog rings or clips.
3. You are now ready to install your new Katzkin Leather front back cover to the front separate type seat back pad with new hog rings. When installing the hog rings, take care to minimize wrinkles in order to achieve good fit and finish.



1. When installing the airbag module into the seat trim cover pouch, ensure there is no twisting of the pouch by fitting the module studs through the pouch holes for proper alignment and also make sure that the top of the module protrudes through the correct access hole. Call for technical support if you have any questions on this important step.

⚠ TORQUE NUT TO PROPER SPECS.



The 01Pouch guide is valid for the following Katzkin style numbers.

FNI40	ICH23A	J2JE70M	K2NI17	L2DO04
FNI40C	ICH23P	J2JE73	K2NI18	L2DO05
FNI40M	ICH51	J2JE73M	K2NI15	L2DO06
FNI40MC	ICH51F	J2NI41	K2NI19	L2DO07
FNI41	IDO70	J2NI41M	K2NI16	L2CH63
FNI41C	IDO71	J2NI43	K2DO04	L2GM63
FNI41M	IDO72	J2FO15	K2DO05	L2BU64
FNI41MC	IDO73	J2CR20	K2DO06	L2CH64
FNI42	IDO74	J2CH24P	K2DO07	L2GM64
FNI42C	IDO75	J2NI48	K2DO08	L2CH65
FNI43	IFO04	J2DO14	L2CH53	L2GM65
FNI43C	IFO05	J2DO12	K2NI37B	K2FO10R
GJE70M	INI01	K2NI37	K2DO13	L2DO37
GJE73	INI02	K2NI36	K2NI04	L2NI48
GJE73M	INI04	K2FO15	K2NI05	L2NI03
GJE74M	INI05	K2FO16	K2BM21	M2JE68
GNI32	J2BM24	K2FO17	K2BM23	M2JE68A
GNI55	J2BU63	K2FO18	K2CO41	M2JE69
GNI55P	J2BU64	K2FO19	K2DO04BK	M2JE69A
GNI56	J2CH24	K2HO70	K2DO06BK	M2CH44
GNI56P	J2CH51	K2HO72	K2DO04M	J2DO84
HBU63	J2CH63	J2BU47	K2DO02BK	L2FO09R
HBU64	J2CH64	K2NI55	L2NI41	L2DO05B
HCH63	J2GM63	K2NI56	L2NI41C	L2DO07B
HCH64	J2GM64	K2NI55P	L2DO38	M2NI35
HGM63	J2DO48	K2NI56P	L2DO39	ICH23T
HGM64	J2CR86	K2FO08	L2CH51	M2CH51
HHO70	J2DO70	K2FO09	L2CH52	M2CH52
HHO72	J2DO72	K2FO10	L2FO08	M2CH53
HNI44	J2DO86	K2FO11	L2FO09	L2BM26
IBU48	J2JE07	K2FO13	L2FO10	M2JE14
IBU49	J2JE08	K2NI01	L2FO11	M2JE15
ICH23	J2JE70	K2NI02	L2FO13	M2DO38
		K2FO04	L2NI30	L2DO08
		K2FO05	L2NI01	ICH23F
			L2NI02	N2BU64
				N2CH63



N2CH64
N2CH65
N2GM63
N2GM64
N2GM65
N2JE68
N2JE68A
K2NI95
N2FO10
N2FO10P
N2JE69
N2JE69A
N2CH06
N2GM06
N2NI03
N2NI18
N2CH45
N2NI17
L2DO04P
P2HO70
P2HO72
L2DO05P
P2NI44
N2FO17B
P2CH49
N2FO11U
N2FO01
N2FO12
P2NI18
P2NI60
N2FO11B
S2FO17
S2FO17B
S2FO18
S2FO11L
S2FO11LX
S2FO10L
S2HO72



B304A				
B31HA	M881D	N12GA	F328P	M838A
B31HA	N107A	N12GB	J217P	M838K
B31HB	N107B	F328A	C23EC	M847B
B31HB	N10HB	F328B	M813D	M847A
B39HA	N174A	N127A	C23EA	C244B
B39HA	N174B	N127B	F338A	M847C
B39HB	N174E	F32RA	F338B	M847D
B39HB	N174F	F32RB	F338P	J24HA
C201A	N182A	M828A	N13DA	D343A
C20EA	N18GA	M828B	N13DF	M881C
C21EA	N18GB	M828C	D338C	C25HF
C21HA	N19EA	M828D	D338F	C25HG
C21HB	N19EF	M828J	M836C	C25HH
C29HA	NI71B	D328A	D338B	G15HF
C29HB				G15HG
C31EB	NI71F	D328B	D338G	
D306A	J217A	D328C	N13HA	G15HH
D306B	J281D	D328F	N13HB	M843A
D306C	C211B	C23EB	M833A	M843B
D314B	F31SB	D327C	C23HF	M843C
D316A	C311A	N128A	C23HG	C24EA
D316C	N113A	M828E	C23HH	M857C
D316D				M857D
D317A	D317A	D328D	F338C	
D319A	D317B	D328E	F338D	J217R
F30RA	N12DA	N134A	G13HF	H26RG
F30RB				
F318A	F32SA			
F318B	F32SB	N134F	G13HG	
H29HA	H22HA	D333A	G13HH	
H29HB	H22HB	J231D	G13 HF	