



ROLLING TABLE ASSEMBLY INSTRUCTIONS



Box Contents

- (1) Table
- (2) All Terrain Wheels
- (2) Axle Bolts & Nuts

Care & Use

Clean using mild detergent and soft cloth.

Table weight capacity: 500lbs

Chair rack: 60lbs

Lower accessory rack: 15lbs

FIRST TIME ASSEMBLY & SETTING UP TABLE

Step 1



Open table and lay upside down on clean flat surface.

To assemble wheels rotate wheel bracket up to vertical 90° angle and remove nut from axle bolt.

Step 2

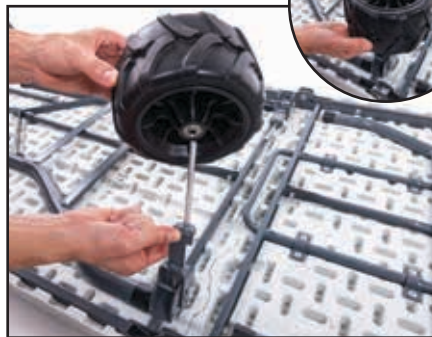

Slide wheel onto axle bolt. Secure the wheel to bolt with nut using 1/2" wrench. Tighten nut slowly while ensuring wheel still spins freely. Loosen nut slightly if too tight to spin freely.

Step 3



Rotate bracket and wheel fully outward. Lift up table slightly off the ground to engage bracket safety notch. Repeat Steps 1-3 for the other wheel.

Step 4

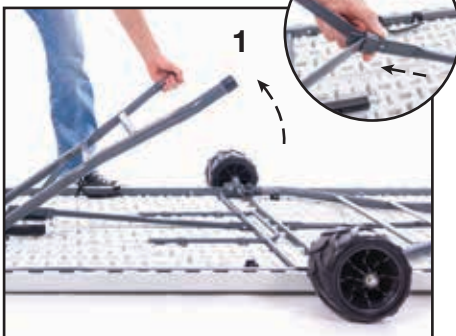

1. **Lift** table legs and rotate up until fully extended and upright.
2. **Slide** lock ring all the way up to secure legs in opened position.

Step 5



Push locking latch all the way up to a vertical position to lock the table in the opened position to prevent folding.

Step 6

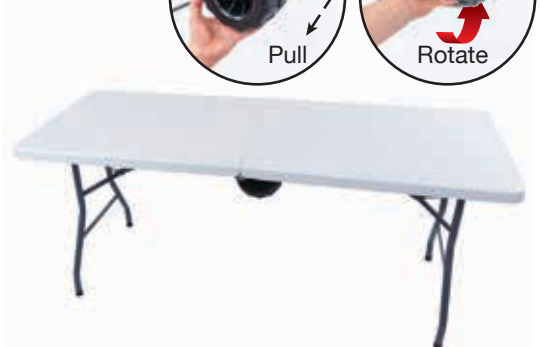

Carefully turn table upright on level surface. To conceal wheels:

1. **Pull** wheels outward to disengage bracket from safety notch.
2. **Rotate** wheels inward until inner safety notch engages holding the wheels securely in place.



ROLLING TABLE FOLDING INSTRUCTIONS

Step 1

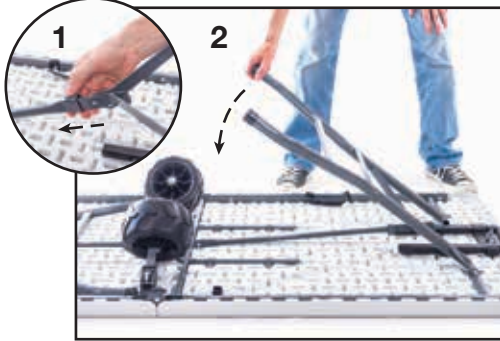

Carefully turn table upside down on flat surface.

1. Slide lock ring down to unlock legs.
2. Push legs down and secure in corresponding retaining clips.

Step 2

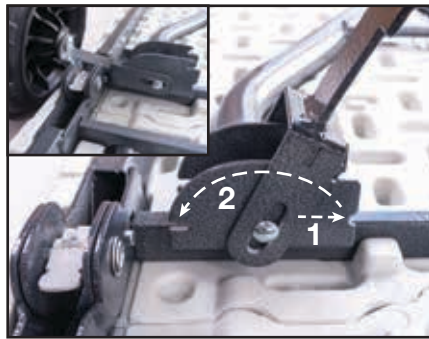

To deploy wheels pull out and rotate:

1. **Pull** wheel directly toward center of table to disengage from safety notch.
2. **Rotate** all the way to outside of table. Allow spring to draw the wheel into the outer safety notch to secure.

Step 3



Push down tab as shown above to release folding lock and enable table to be folded.

Step 4



Fold table by lifting both ends and bringing them together.

Step 5

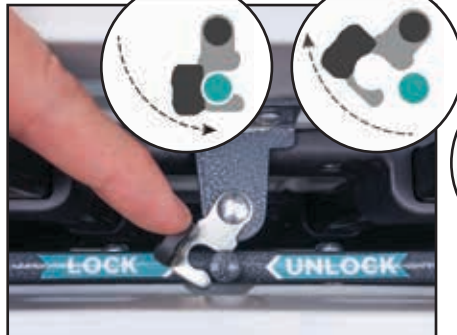

Once folded, secure in folded position by engaging the lock. You may need to pull up slightly on the black handle and/or gray chair rack to reach the lock.

Step 6



Push button and pull up on black handle to pull the table. Pull metal bar up then extend outward to carry chairs.

Step 7

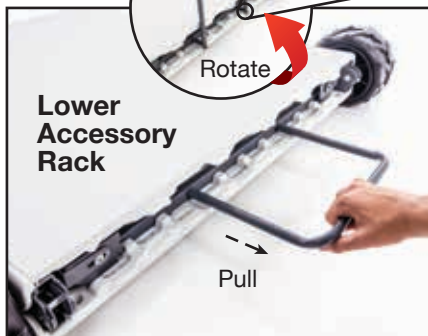

To deploy lower rack, lay table down on clean flat surface.

1. **Pull** lower accessory rack straight out all the way.
2. **Rotate** up.
3. **Push down** to lock out.

To transform back to table mode simply reverse steps.

Enjoy!

