

Pitching Pad Pro Installation

Thank you for purchasing the Pitching Pad Pro. To ensure safe operation please read the product use/installation instructions and review them with anyone who will be using the Pitching Pad Pro.

- Target is intended for use when attached to nets with provided bungee cords
- Do not use this target if it is attached to a hard surface
- Beware of balls rebounding off target
- Do not stand beside or behind target when it is in use
- Target should be stored out of direct sunlight and weather elements

The Pitching Pad Pro is designed to be attached to nets, screens, or batting tunnels that provide support to the target and will absorb the energy of the thrown ball to decrease the likelihood of the ball rebounding. This target is not designed to be used on chain link fences or hard surfaces; care should be taken that there are no hard surfaces such as pipes or supports behind or beside the target that could cause a ball to rebound toward the user or others.

Included with the Pitching Pad Pro are bungees that provide a flexible means for attaching to shock absorbing structures. These elastic cords provide a simple and quick installation method while maintaining the flexibility required for the target's extended use. The use of non-flexible cord, rope, or other mechanical means such as wire ties or snap hooks can lead to premature failure of the Pitching Pad Pro.

Stretching and removing bungee cords requires strength and proper balance. DO NOT let go of bungee cords when under tension; an eye injury or other types of bodily injury could occur. ALWAYS wear safety glasses and proper protective clothing.

1. Thread the looped end of the bungee cord through grommet from front of Pitching Pad Pro to back, pull ball end through looped end.*
2. Hold one cord from bungee halfway between ball end and contact location in one hand and the ball end in the other hand.*
3. Feed ball end under hooped end where contact location is, not letting go of the halfway point with hand.
4. Pull ball end through all the way and grab with opposite hand.*
5. Take ball end and feed through held bungee cord, now a loop.*
6. Once ball end is through all the way, pull both ends of the bungee, tightening the bungee cord. Note it is not necessary to overtighten as this will cause difficulty removing bungee cord later.*

*Images below correspond to written steps above

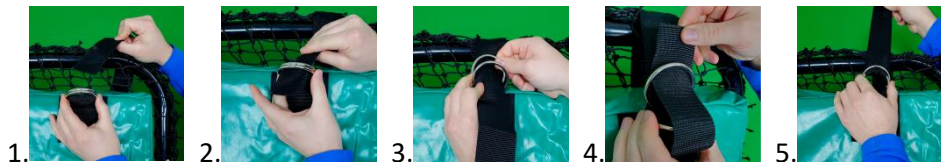

CAUTION: Over stretching bungees will cause the grommets to fail.

The Pitching Pad Pro is meant to be weather resistant, not weather proof. It should be removed after every session and stored in an area that protects against the outside elements.

Disclaimer: This product should be used under the supervision of knowledgeable adults. Oates Specialties LLC will not be responsible for accidents, injuries or damage to property or persons caused by the use or misuse of this product.