

07 YAMAHA R1 LTD Fender Eliminator Kit.

- Remove:** Front seat (2 Allen bolts under corners), Rear seat, and tool pouch. Set all safely aside.
- Remove:** Rear Fender (4 bolts in storage area, unplug signals, and lic light wires).
- Remove:** Plastic rivets shown in *FIG (A&B).
- Relocate:** Large black computer board, and small red relay, to side of bike.
- Drill:** Hole # 1, 1/4" hole at location shown in FIG (C). *NOTE* make sure path is clear of wiring etc.
- Assemble:** Kit as shown in FIG(D) (Lic Plate not shown).
- Mount:** Kit by removing Allen bolts FIG(C) and inserting kit between rear peg mounts and subframe. Re-insert Allen bolts to secure.
- Drill:** Hole # 2, 1/4" hole up through subframe. Using the empty obround hole in the kit as a template. *NOTE* make sure path is clear of wiring etc.
- Adhere:** Lic light to kit w/ wires running up through previously drilled hole #2.
- Route:** Signal wires up through hole #1.
- Cut:** 8" of wire off stock signals and Lic light.
- Plug-in:** Turn signal wires and connect to supplied lighting with supplied butt connectors. (Check for proper function).
- Replace:** Electrical box, and computer (Secure w/ stock rivets).
- Insert:** 4 - 6x25 Allen Bolts up through stock fender location w/ washer and nuts on top.
- Replace:** Tool pouch, rear seat, and front seat.

PARTS LIST

- | | |
|-----------------------|----------------------|
| 1 - Main / Lic pan | 4 - 6x10 Allen Bolts |
| 1 - Turn signal Brac. | 4 - 6x25 Allen Bolts |
| 1- Pair FM V Signals | 8 - washers |
| 1 - Lic light | 8 - nuts |
| 2 - Butt Connectors | |

1Y1008LTD

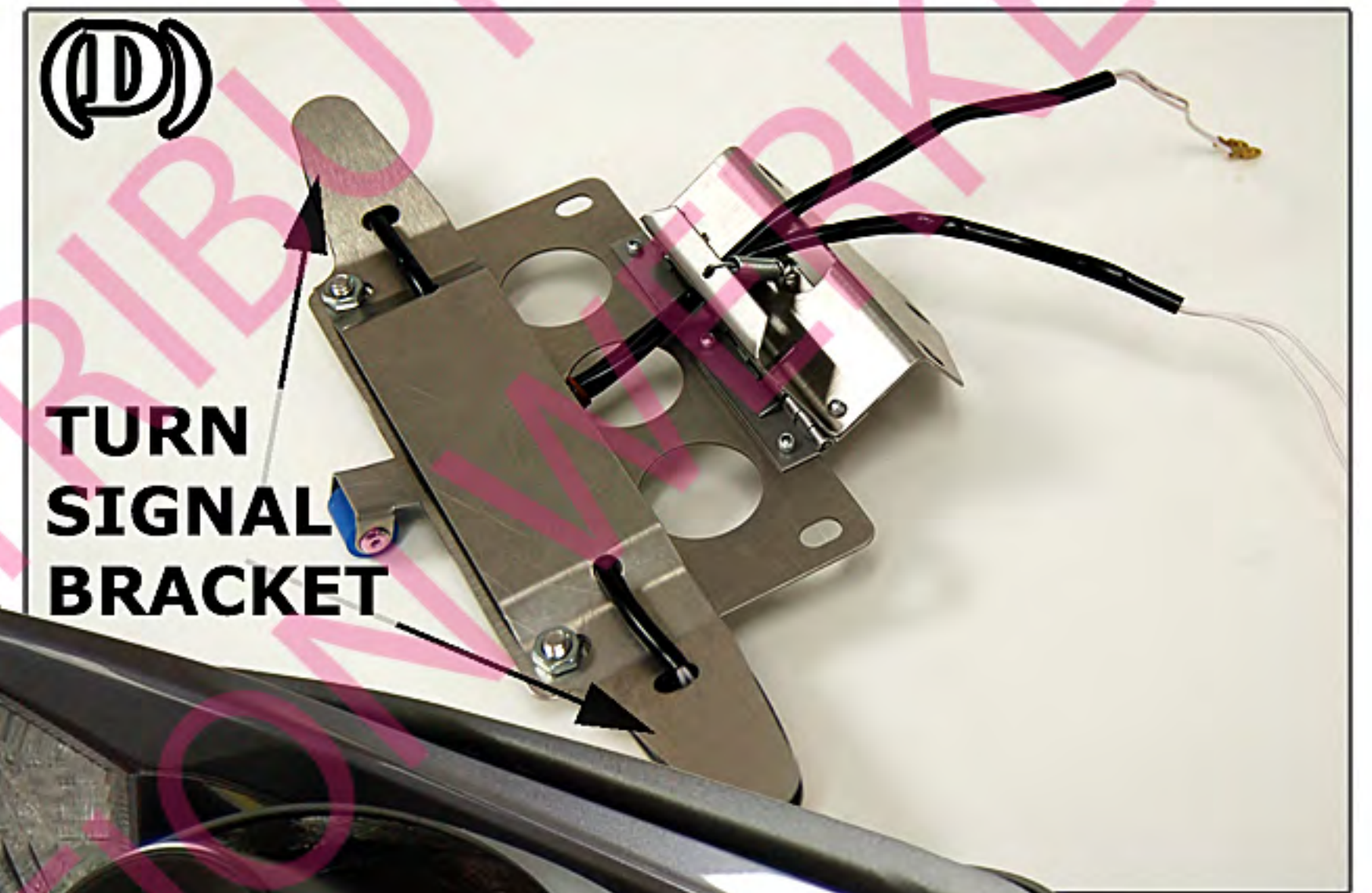
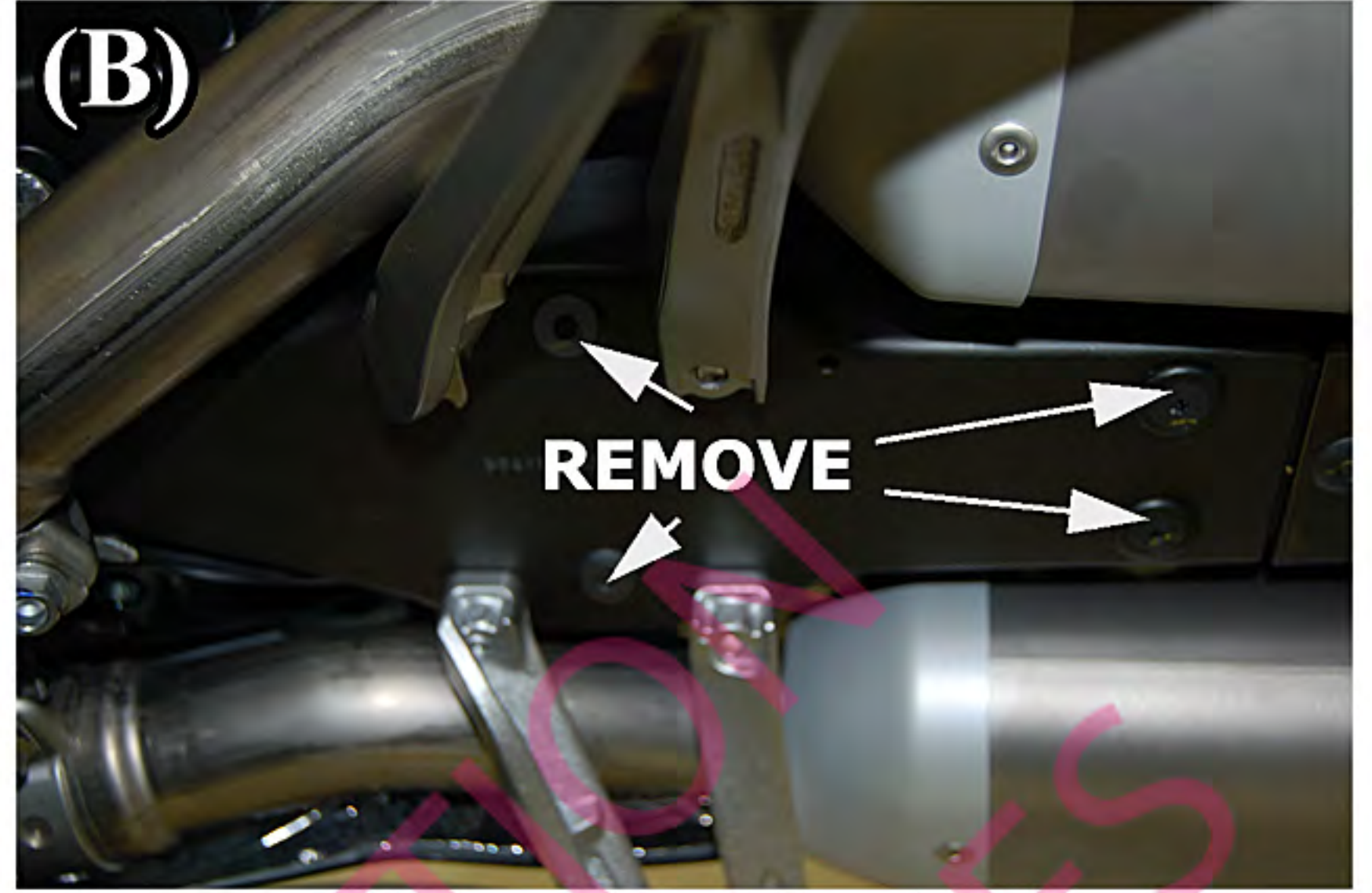
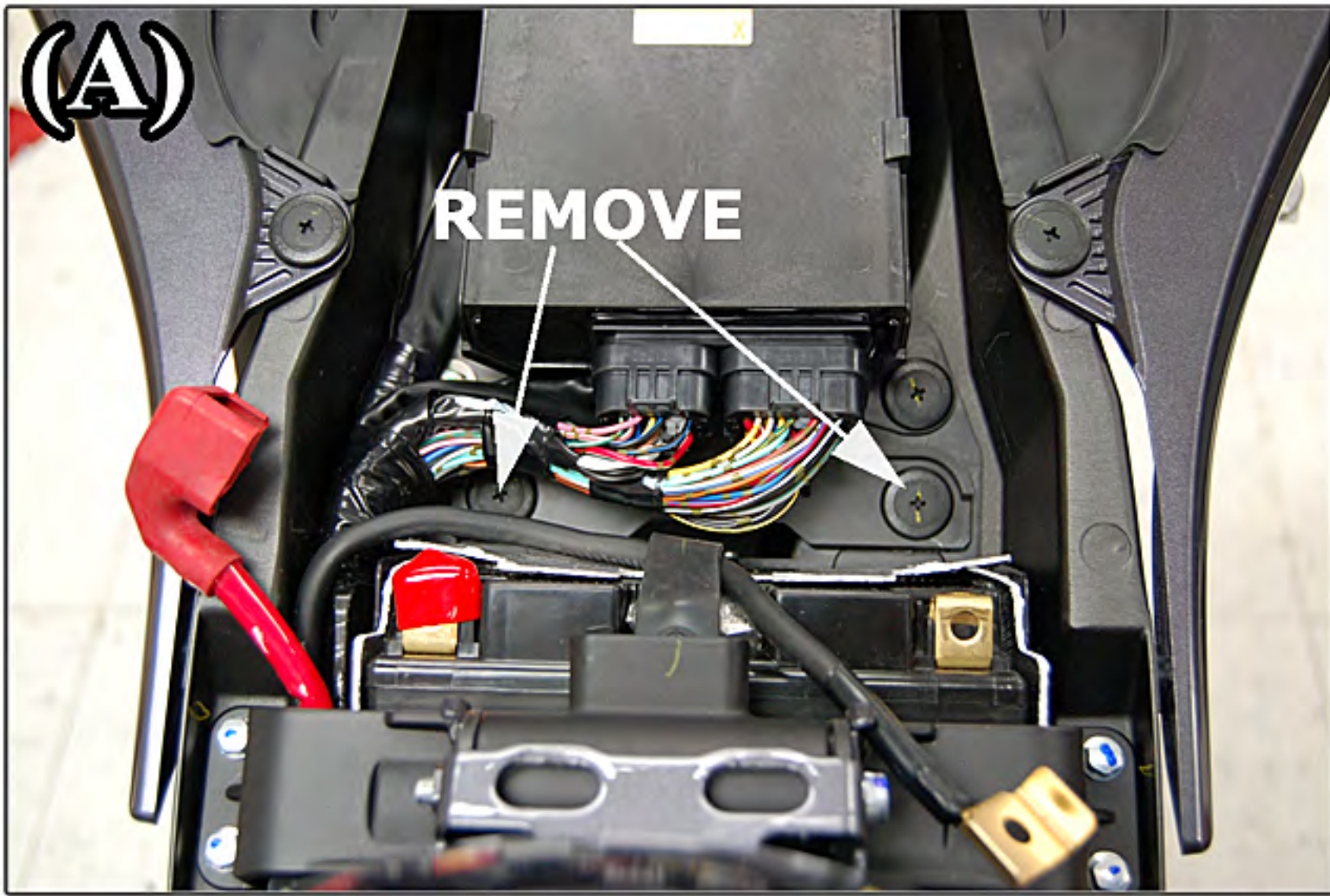

07 YAMAHA YZF1000 R1 LTD Fender Eliminator

LIC LIGHT

TURN
SIGNALS