

08 DUCATI MONSTER 696 Fender Eliminator

<<<<<< IT IS RECOMMENDED THAT THIS PRODUCT BE INSTALLED BY A QUALIFIED TECHNICIAN >>>>>>

REMOVE: Seat.

UNBOLT: Rear fender (4 allen bolts under points shown) FIG*(A) and unplug wire next to subframe.

REMOVE: Cover from back of fender (3 allen bolts) FIG*(B) and disconnect seat latch cable.

REMOVE: Turn signals and tail light from rear fender.

REMOVE: Lock from fender FIG*(C) *note* you may have to tap nut with a screw driver if no access for wrench.

EXCHANGE: Seat latch bolts for longer 6x30mm FIG*(D) *note* keep latch aligned by referring to marks on mounting plate.

MOUNT: Tail light to Tail Light Mount and Backing Plate FIG*(E).

CUT: Bullet connectors from License light and replace with Spade Connectors supplied FIG*(F).

ADHERE: License Light to bottom of Tail Light Mount FIG*(G).

MOUNT: Lock to Belly Pan FIG*(H) use spacer between Belly Pan and cable bracket.

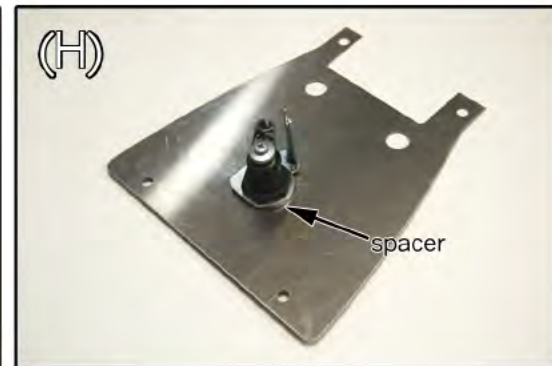
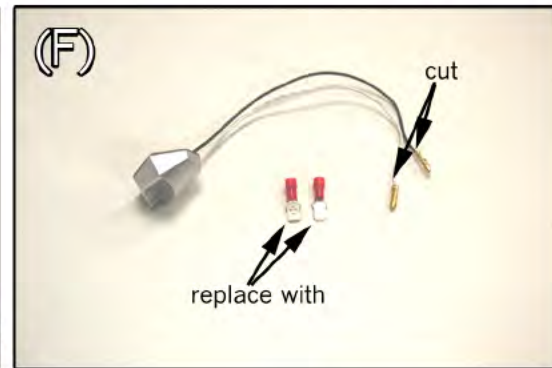
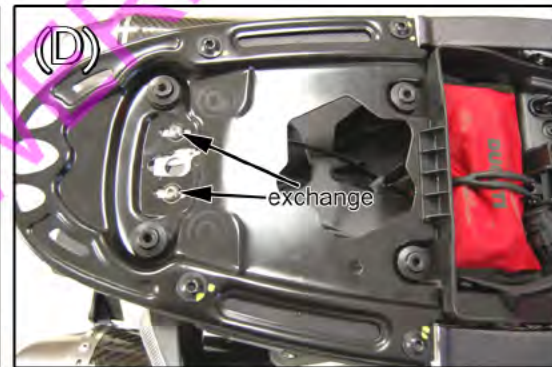
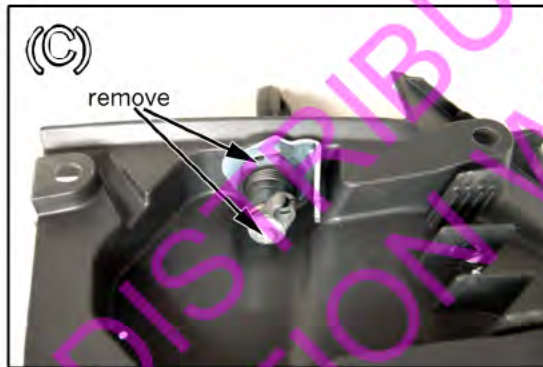
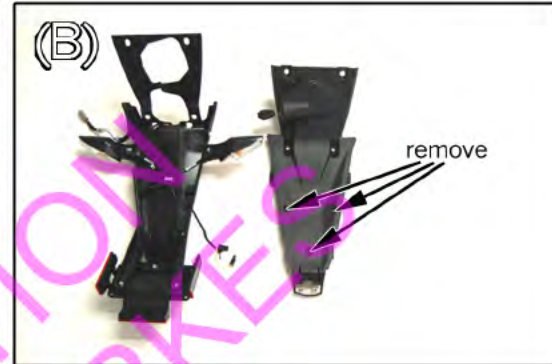
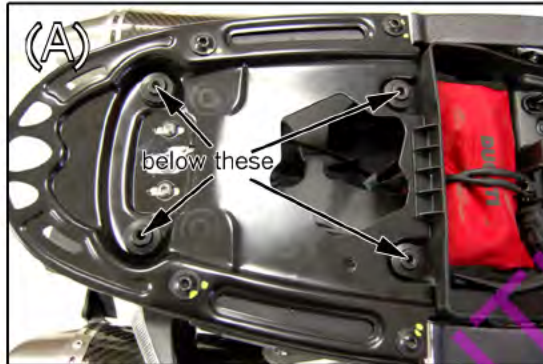

The purchaser releases Competition Werkes inc from all liabilities pertaining to the installation and use of purchased parts. Purchaser recognizes that any alteration and/or modifications to the vehicle may increase the risk of injury or accident, and may also render the vehicle illegal for use on public roads.

08 DUCATI MONSTER 696 Fender Eliminator

Choose Plate Location!!!!!!



Rear Mounted Plate with Signals.

- MOUNT:** Belly Pan (4- 6x16 Allen bolts with Spacers above) FIG*(I). Connect seat latch cable.
- PLACE:** Lip of License Pan over Tail Light Mount and secure to seat latch bolts using supplied 6m nuts. *note* wire harness and license light also need to be plugged in.
- MOUNT:** License plate using 2- 6x10 Allen Bolts in lower holes
- MOUNT:** Turn signals to Signal Brackets FIG*(J) use stock backing tabs.
- ROUTE:** Signal wires up through grommets and plug in.
- MOUNT:** Signal Brackets to License Pan in upper holes using 6x12 Allen Bolts.
- CHECK:** Lighting.
- REPLACE:** Seat.

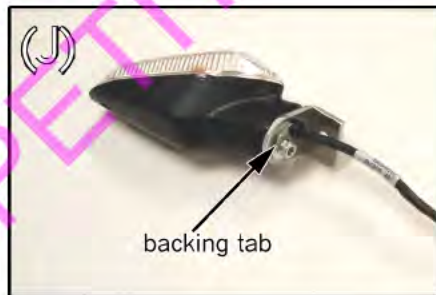
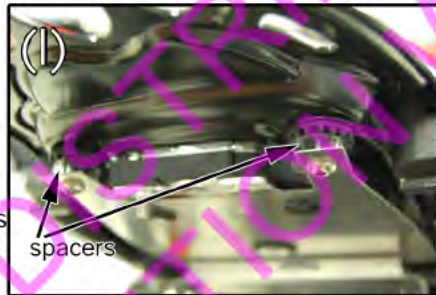

Forward Mounted Plate without Signals.

- MOUNT:** Belly Pan (2- 6x16 allen bolts in rear holes with spacers above) FIG*(J). Connect seat latch cable.
- PLACE:** Spacers above forward holes.
- MOUNT:** License Pan using 2- 6x16 allen bolts through forward holes.
- SECURE:** License plate using Pan Screws.
- SWAP:** Rubber grommets for plugs.
- MOUNT:** Tail Light Mount to seat latch bolts with 6m nuts. *note* wire harness and License Light also need to be plugged in.
- CHECK:** Lighting.
- REPLACE:** Seat.

PARTS LIST:

1- Belly Pan	1- License Pan	1- Tail Light Mount
1- Backing Plate	1- License Light	2- Signal Brackets
1- Lock Spacer	4- Plastic Spacers	2- Plugs
2- Med. Grommets	2- 6x30 Allen Bolts	4- 6x16 Allen Bolts
6- 6m Nuts	2- 6x12 Allen Bolts	2- 6x10 Allen Bolts
6- Washers	2- Spade Connectors	



The purchaser releases Competition Werkes inc from all liabilities pertaining to the installation and use of purchased parts. Purchaser recognizes that any alteration and/or modifications to the vehicle may increase the risk of injury or accident, and may also render the vehicle illegal for use on public roads.