

## INSTRUCTIONS

# WRLS

wireless dropper post

## SWITCH COMPONENTS

### BATTERY INSTALLATION

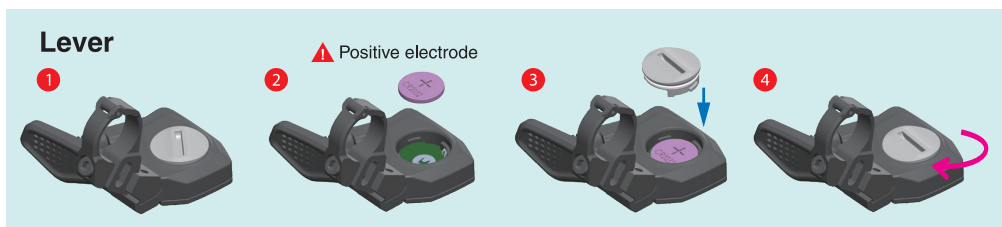
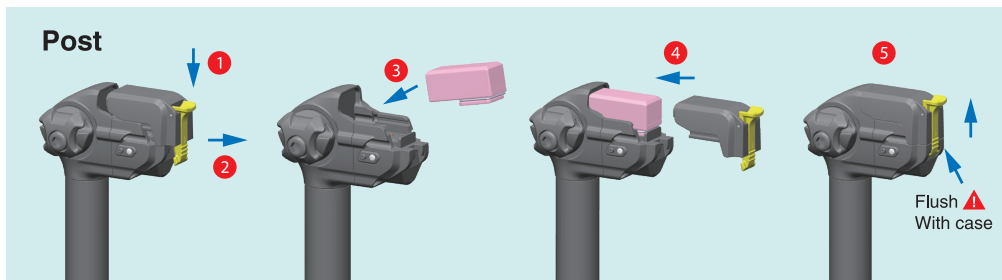

### SADDLE INSTALLATION

1. Unscrew front bolt with 4mm allen key.
2. Unscrew side bolt with 5mm allen key.

3. Install saddle and fix position.
4. Tighten side bolt to 15 Nm.
5. Tighten front bolt to 4-5 Nm.



### POST INSTALLATION

1. Make sure the post diameter fit in with your bike frame.
2. Install the post according or above the minimum insert line.

3. Tighten the seat clamp max 6 Nm.
4. Install the remote lever on handlebar and tighten the bolt with 4mm allen key to 4 Nm.



### PAIRING

Lever and post should automatically connected once you put in the battery. If not please follow the pairing procedures below:

1. Press pairing button on the post for 30 seconds until red light flashes 5 times. Press thumb lever for direct operation, check if LED flashes green light.

2. If still no connection (green and red flashes), press the pairing button on the lever for 30 seconds until red light flashes 5 times.

Sleep mode: Post and lever will enter sleep mode in 30 seconds of still condition. To reactivate please press the thumb lever, move the post.

## OPERATIONS

1. Make sure there is connection from lever to post, LED indicator on both lever and post shall flashes green.
2. Unlike mechanical dropper post, electronic dropper post activation relies on the pressing of button at lever which is either open or close and nothing in between. Before riding, please get use to the lever press travel and referring to the motor sound to make sure how it activate the post.

3. In normal operation, use the post as how you operate a mechanical dropper post;
  - 3.1. To push down the post: Unweight the post - Press the lever and push down the post with body weight - Release the lever to lock the post.
  - 3.2. To rebound post: Unweight the post - Press the lever - Release the lever at the position where you want the post to rebound and lock.

## ADJUSTING PRESSURE

1. Unthread bottom ring.
2. Release valve cap.
3. Pressurize to 230-280 psi.
4. Close back valve cap and bottom ring.

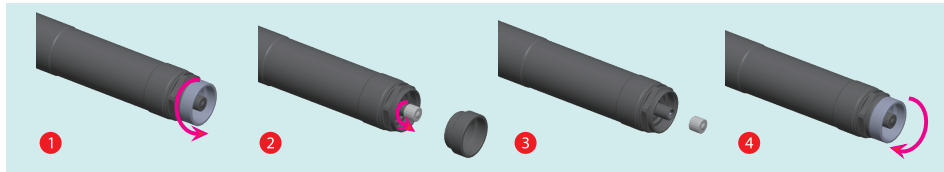

## LIGHT INDICATORS



Operation range		
LED LIGHTS	GREEN FLASHES	RED FLASHES
<b>Post</b>	3000~7000 times	500 times
<b>Lever</b>	10000~20000 times	500 times

Above operation range is based on fully charged battery condition and continuous operations, lithium batteries' performance or life may be deteriorated during time of usage.

In order to prolong the lifetime of the battery, please remove the battery from the post in the event of transportation.

## CHARGER DOCK

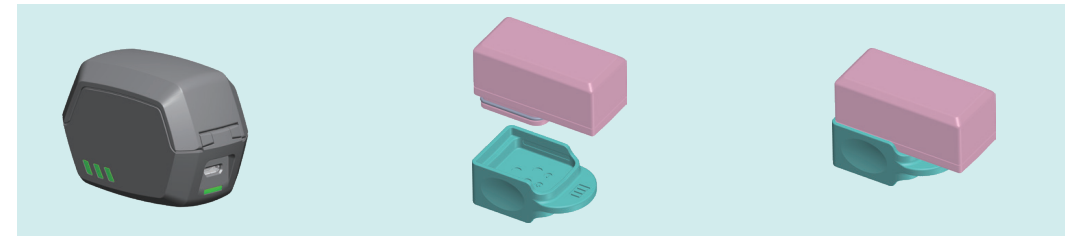

Charger indicators light up one by one as charging in process, the time required to fully charge the battery is around 90 minutes. Please remove the battery from charger dock when fully charged and install battery cover for storage.

## TROUBLE SHOOTINGS

	POST	LEVER	LED INDICATOR	CONNECTION
<b>BATTERY</b>	Installed	Not installed	Seatpost LED: green and red flash	Not yet connected
	Not Installed	Installed	Lever LED: green and red flash	Not yet connected
	Installed	Installed	Both LEDs flash green 3 times and stop	Connected
	Installed	Installed	Green and red flash on both LEDs	Not yet connected Please refer to Pairing buttons paragraphs

## CAUTIONS

1. When not used and in case of storage, please always remove the lithium battery from post and isolate with battery cover. Keep at room temperature.
2. When disposing of battery, isolate terminals by using tape and dispose according with applicable federal state and local regulations.
3. Please avoid high pressure water jet used directly to the electrical part of the post, make sure battery is installed when washing the post and terminals are free from water after each wash.
4. Check battery level before each ride, recharge or replace battery when red LED flashes.
5. Never leave the battery unattended while charging. If the battery becomes hot, smokes, swells, or gives off an odor during charging, terminate charging immediately.