

The cover features a dark blue background with a faint, light blue grid pattern. A bright blue lens flare effect is positioned on the left side, extending horizontally across the middle. The text is centered in the lower half of the image.

**N U B E O**  
INSTRUCTION MANUAL  
BEDIENUNGSANLEITUNG

A photograph of the Skylab satellite in space. The satellite has a central white circular hub with four large, rectangular solar panel arrays extending outwards in a cross shape. The solar panels are covered in a grid of small solar cells. To the right of the central hub, there is a cylindrical component with a white band and a yellowish-orange covering. The background is the Earth's surface, showing blue oceans and white clouds. The word "SKYLAB" is overlaid in white, bold, sans-serif capital letters on the left side of the image. There are four black crosshair markers on the image: one in the top-left, one in the top-right, one in the bottom-left, and one in the bottom-right.

SKYLAB

## **AUTOMATIC WATCHES**

This timepiece is equipped with a self-winding Mechanical Automatic movement.

It does not need a battery. It is powered by the motions of the user's own wrist during the wear of the watch automatically. You may also choose to wind the watch manually.

Before wearing your watch, make sure to wind it clockwise with 10 rotations of the crown.

For good measure gently move the watch side to side around 30 times to see the seconds hand run at its normal speed.

Please make sure to remember that during a period when you are not wearing the watch, the power reserve of movement will wear down and you will have to re-wind the watch again before wearing.

## PLEASE READ THE FOLLOWING BEFORE UNSCREWING THE CROWN

### SCREW-DOWN CROWN

This watch is equipped with a screw down crown. Do not pull the crown unless it is unscrewed first.

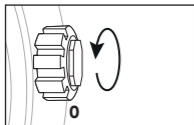

**TO UNSCREW:** Turn the crown anti-clockwise until it turns freely without tension. Gently pull the crown out to the other desired positions for watch setting (see specific operating instructions on the following pages).

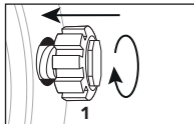

**TO SCREW:** Push the crown all the way in (towards the watch) then begin to turn clockwise until it is securely screwed down.

Note: Failure to securely screw down the crown after setting the watch may affect its water resistance.

## AUTOMATIC 3 HANDS

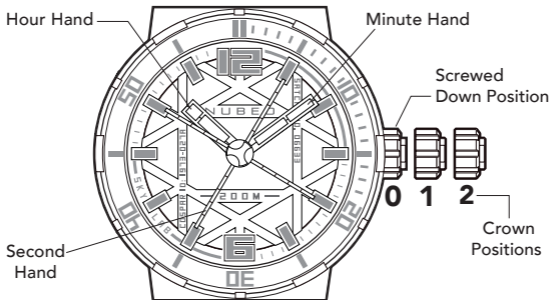

As your watch has a screw down crown feature, release the watch from the screw-down position before setting.

## TIME SETTING

1. Pull the crown out to position 2 , its maximum extension. The second hand will stop moving.
2. Turn the crown either clockwise or anti-clockwise until the watch hands are positioned at the desired time.
3. When the desired time is reached push the crown back to position 1 and screw down.

## HOW TO USE A DEPLOYMENT CLASP

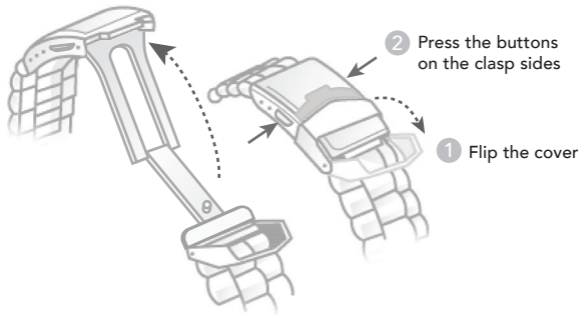

## HOW TO RESIZE METAL BRACELET

On the inside of the bracelet, you will see some small arrows engraved on removeable links.

1.

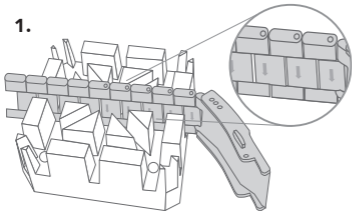

2.

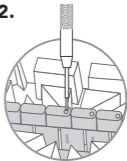



3.

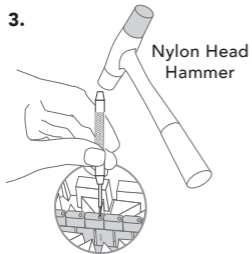

4.

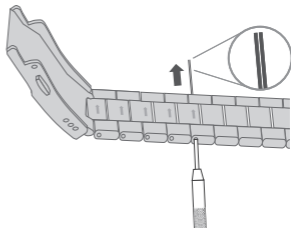

5.

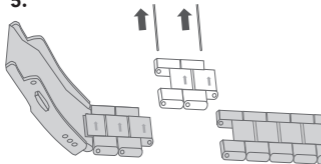

6.

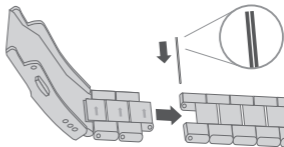

7.

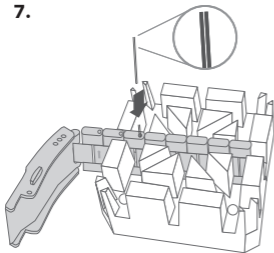

8.

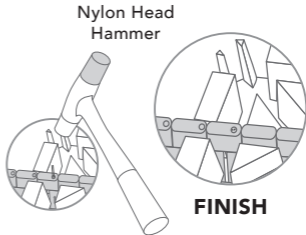

5.

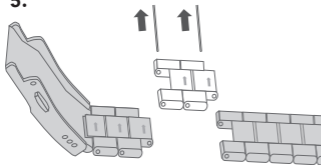

6.

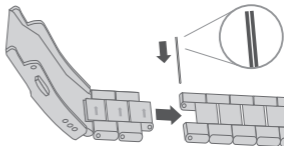

7.

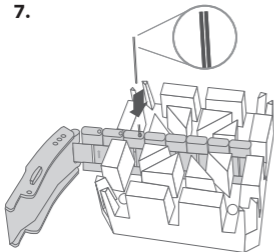

8.

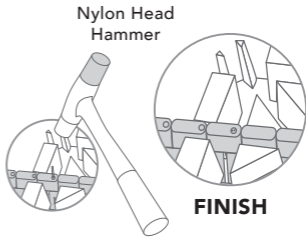

9.

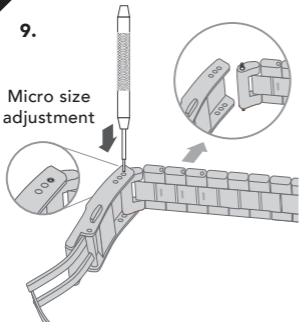
Micro size  
adjustment

10.

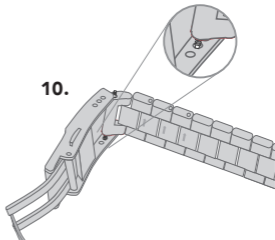

11.

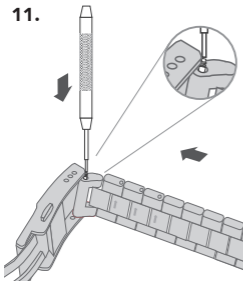

12.

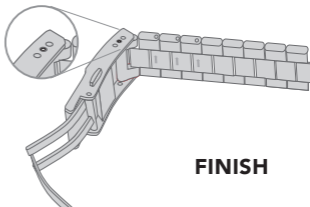
**FINISH**

## **WATER RESISTANT**

All Nubeo timepieces are designed with a minimum water resistance rating of 5 ATM (50m). The water-resistance of a timepiece protects the movement from dust, moisture, and risk of damage to the movement should it be immersed in water.

Please see chart for guidelines for the recommended exposure of various water ratings.

It is important not to attempt to adjust the position of the crown while the timepiece is in contact with water. Water can enter the case causing damage to the movement.

For timepiece with screw-down crowns, it is important to ensure the crown is in the proper position and completely locked before contact with water.

For timepieces with chronograph functions, do not engage the chronograph under water, as water may leak in the case and cause damage to the movement.



## USE PRECAUTIONS - RESISTANCE TO WATER

All Nubeo timepiece are designed to withstand use as indicated on the following chart. **Always make sure the crown is screwed-down completely before use.**

WATER RESISTANCE CHART	30M/ 3ATM	50M/ 5ATM	100M/ 10ATM	150M/ 15ATM	200M/ 20ATM	300M/ 30ATM	500M/ 50ATM	1000M/ 100ATM
SPLASH/ SHOWERING	☑	☑	☑	☑	☑	☑	☑	☑
SWIMMING/ BATHING	☒	☑	☑	☑	☑	☑	☑	☑
SWIMMING/ SNORKELING/ WATER SPORTS	☒	☒	☑	☑	☑	☑	☑	☑
FREE DIVING	☒	☒	☒	☑	☑	☑	☑	☑
SCUBA DIVING	☒	☒	☒	☒	☒	☑	☑	☑
PROFESSIONAL DEEP SEA DIVING	☒	☒	☒	☒	☒	☒	☑	☑

## CARE AND PRECAUTIONS

Each Nubeo timepiece is designed and manufactured to exceed the highest of standards. In order to ensure optimal performance and longevity from your timepiece, please review the simple guidelines for care and precautions of your new Nubeo timepiece.

### CARE

Your timepiece should be cleaned with a soft cloth and water only. Your timepiece should be rinsed clean and dried with a soft cloth after any saltwater use. In order to maintain the 'new look' of metal bracelets, we recommend periodic cleanings of the bracelet. Dip a soft brush in warm soapy water and gently rub bracelet clean. We advise having your timepiece serviced every 18-24 months to ensure long use and trouble-free operation.

## **GENERAL INSTRUCTIONS FOR MECHANICAL AND AUTOMATIC WATCHES**

When manually winding a watch always turn the crown in a clockwise direction.

Do not force the crown when you feel the spring become tense toward the end of the winding process.

Daily winding is recommended even if you believe that your watch has enough power, its always a good idea to give your mechanical watch a quick wind before wearing it for the day.

Automatic watches can also be manually wound by turning the crown clockwise in position 1. It is recommended that if your watch has completely run out of power you manually wind it (with about 10 turns) before wearing.

Try to avoid exposing your watch to strong magnetic sources (for example, smartphones, loudspeakers) as these may have an adverse effect on the movement.

## **TWO (2) YEAR INTERNATIONAL WARRANTY**

Your Nubeo watch is warranted for a period two (2) years from the original date of purchase under the terms and conditions of the warranty. The Nubeo warranty covers materials and manufacturing defects. A copy of the receipt or dealer stamp in the warranty booklet is required for proof of purchase.

During the warranty period the watch movement, hands and dial are the only components covered under this warranty. A covered component will be repaired or the watch will be replaced free of repair charges, if it proves to be defective in material or workmanship under normal use.

## **NOT COVERED BY WARRANTY**

- Damage to lens or strap.
- Normal wear and tear.
- Malfunction and deterioration from accident, negligence or tampering.
- Water damage resulting from improper usage.
- The content of the warranty has been altered.
- There is no presentation of the warranty.

This warranty is void if the watch has been damaged by accident, negligence of persons other than authorized Nubeo sales or services agents, unauthorized service, or other factors not due to defects in materials or workmanship.

## REQUESTING WARRANTY AND OTHER WATCH REPAIR

Should you require work under warranty, please send in your watch, a copy of your sales receipt and/or the warranty booklet with dealer stamp and a description of the problem to the authorized international watch service center closest to you.

For service work that is not covered under this warranty, the service center may perform the services you request for a charge dependent on watch style and type of work requested. These charges are subject to change.

For repairs of your Nubeo watch, we recommend that you contact an authorized Nubeo dealer or the authorized international watch service center closest to you.

For details, please refer to our website at:  
**WWW.NUBEOWATCHES.COM**



[NUBEOWATCHES.COM](http://NUBEOWATCHES.COM)

VOL.1.35 EN/DE