



WORX RACING FUEL PRESSURE REGULATOR

PART # - WR04025

MODELS: Yamaha 1.8

INSTALLATION INSTRUCTIONS

NOTE:

IMPORTANT: READ ALL INSTRUCTIONS BEFORE PROCEEDING WITH INSTALLATION

1. Completely drain fuel from tank.
2. Remove electrical plug from top of fuel sender. Then remove fuel hose from top of fuel sender. Wrap in a cloth before removing as hose is pressurised and will have fuel in it. (Pic 1) (We recommend wearing suitable eye protection when removing any fuel components.)
3. Remove 9 nuts hold fuel sender in tank. (Pic 2) Then remove stainless support ring.
4. Remove pump by tilting slightly towards the front of the ski. **You will need to SLOWLY rotate the pump to remove it being extremely careful not to damage fuel level sender and float.**
5. Place fuel pump on bench. Check that all 3 rubber caps are on the bottom of the fuel sender unit and none have fallen off into the tank.
6. Using a flat blade screw driver remove the black top clip that holds in the OEM fuel reg. (Pic 3 & 4) You will need to do this thru the opening under the fuel level sensor. Once the clip is removed slide the OEM sender up out of the locator and remove from the hose. 2 flat blade screwdrivers works best to remove this.
7. Replace with new WORX Racing WR04025 fuel pressure regulator. Be careful not to damage the OEM hose. (Pic 5) Fit back into position and secure with clip.
8. Reinstall fuel sender into tank. Take care fitting to not damage fuel lever sensor.
9. Refit stainless ring and 9 brass nyloc nuts (Pic 6)
10. Refit electrical plugs and fuel hose. Be sure to secure fuel line with retaining clip.

Thank you for purchasing **Worx Racing components** products. We firmly believe that **Worx Racing Components** products are among the finest watercraft parts available. A great deal of time and effort has gone into the design and development of this product to ensure that it will perform to the highest standard and that installation is a relatively straight forward and simple procedure. If you have any questions or comments on the performance and/or installation of our products please contact us at the numbers listed on page one or through your local **Worx** dealer.

10B 354 Brisbane Rd Arundel QLD 4214 Phone: +61 7 5563 1031

www.worx.com.au / info@worx.com.au

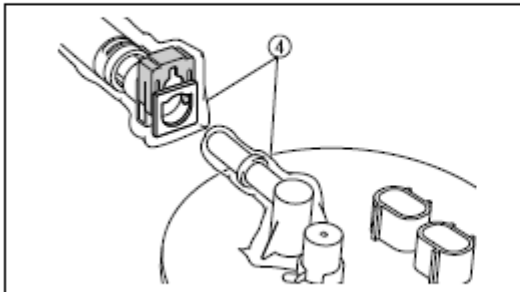
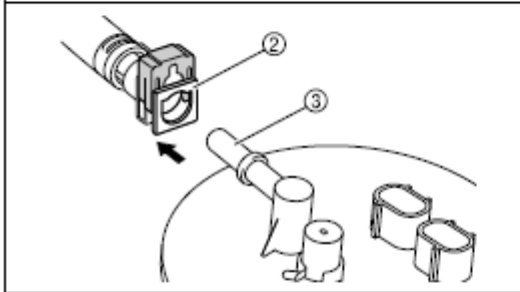
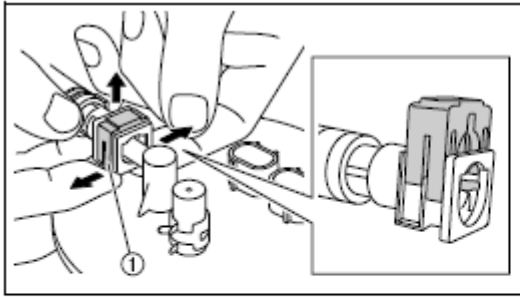

(PIC 1)

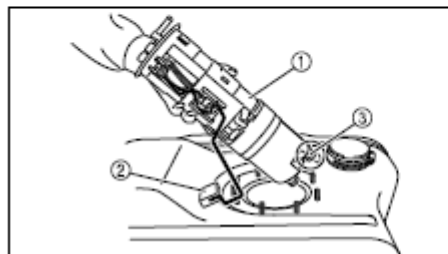
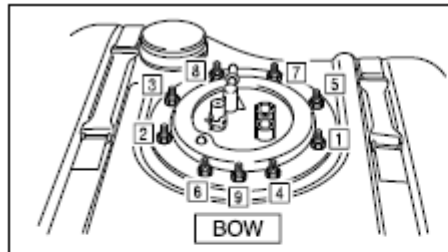

(PIC 2)

Fuel hose disconnection

⚠ WARNING

- Before checking the fuel system, remove the battery and then remove the fuel tank filler cap to reduce any pressure inside the fuel tank.
- Always reduce the fuel pressure in the fuel line before servicing the line or the fuel pipe. If the fuel pressure is not released, pressurized fuel could spray out.

1. Disconnect:

- Quick connector

Disconnecting steps:

1. Wrap the quick connector with a cloth.
2. Spread apart the ends of the locking slider ① with your fingers as shown, and then pull up on the slider.

NOTE:

If the quick connector is removed suddenly, pressurized fuel could spray out. To gradually release the fuel pressure, be sure to remove the quick connector slowly.

3. Disconnect the quick connector ② from the fuel pipe ③ directly.
4. Cover the quick connector and fuel pipe with a plastic bag ④ to protect them from dirt.

Fuel pump module removal

1. Remove:

- Nuts
- Retainer

NOTE:

Loosen the nuts in the sequence shown.

2. Remove:

- Fuel pump module assembly ①

NOTE:

- Remove the fuel pump module assembly ① at an angle so that the float ② does not catch on the fuel tank.
- Be careful that the rubber cap ③ does not come off when removing the fuel pump module assembly ①.

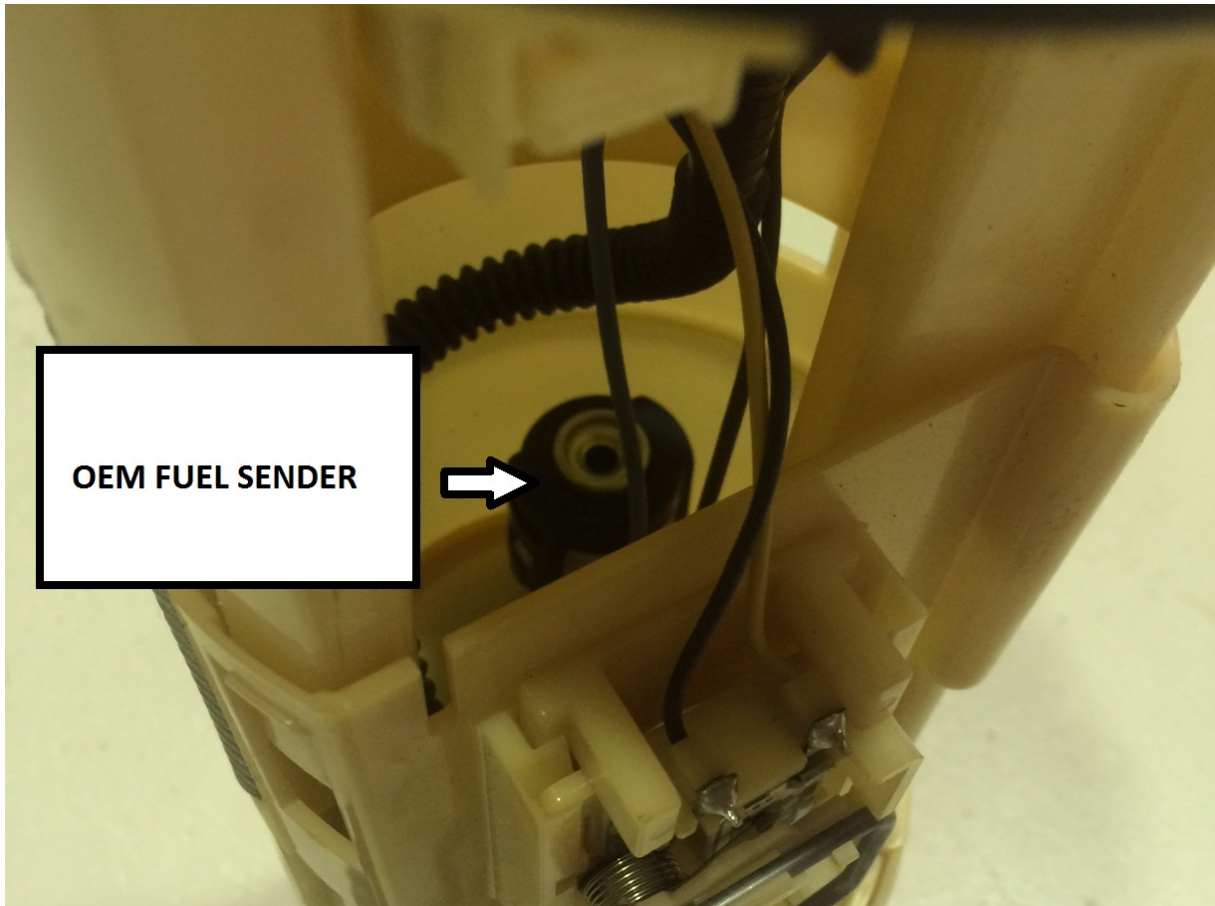

(PIC 3)

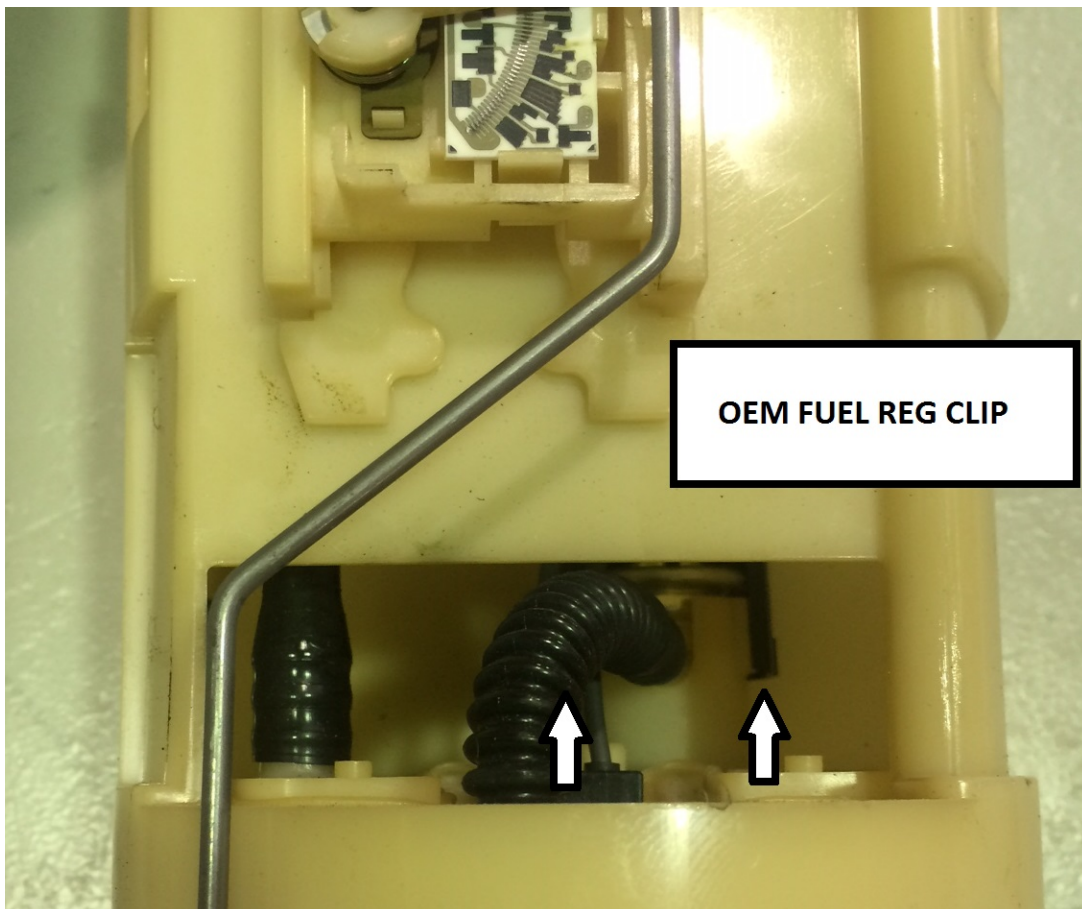

(PIC 4)

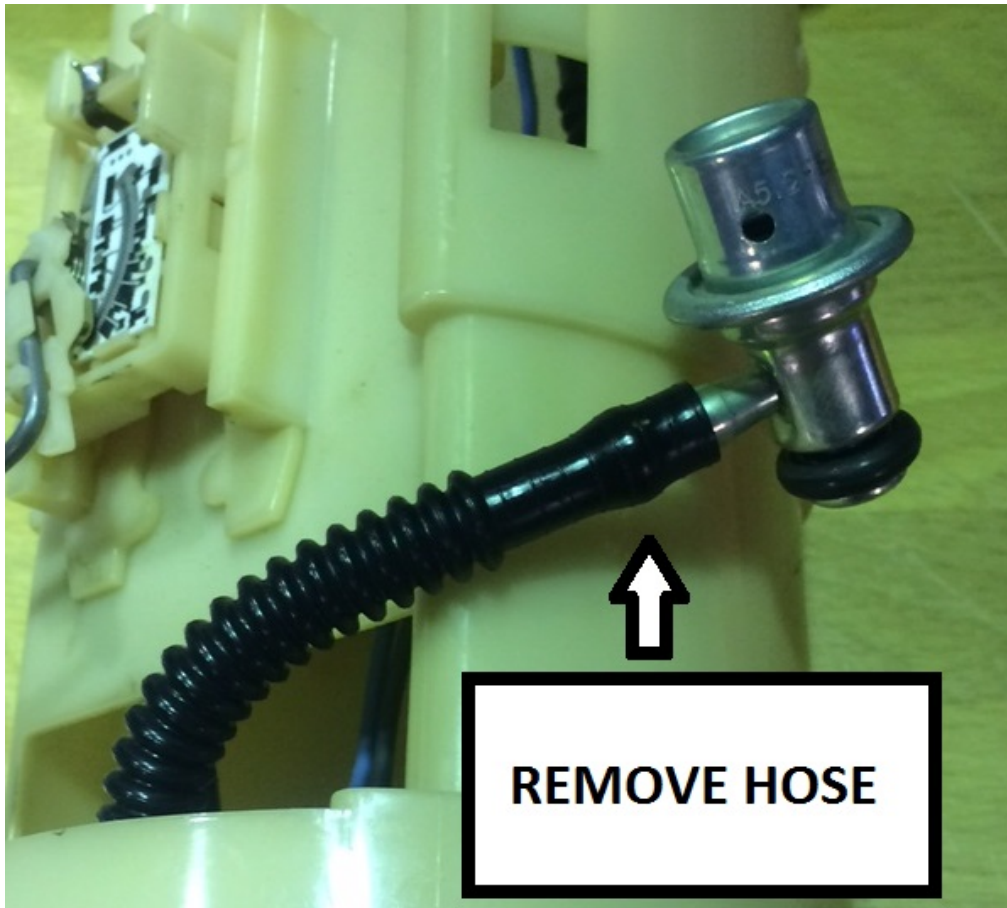

(PIC 5)

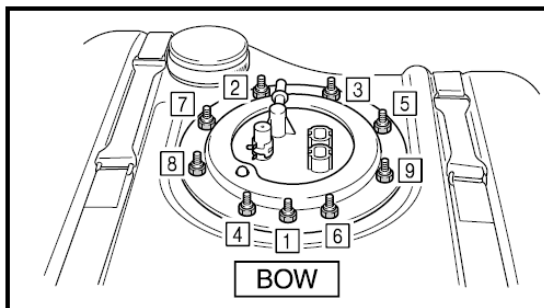

(PIC 6)

Fuel pump module installation

1. Install:

- Fuel pump module assembly

NOTE:

Tighten the nuts to the specified torques in the sequence shown.



Fuel pump module nut:

1st:

3 N·m (0.3 kgf·m, 2.2 ft·lb)

2nd:

6 N·m (0.6 kgf·m, 4.4 ft·lb)