

Ring Light  
Installation Manual

1. Accessories Included.

Please note: Some items included in this manual are for illustration purposes only and may be available to purchase separately. This ring light set includes only the following: (1) Tripod stand, (2) Orange filter set, (3) White filter set, (4) Ring light head, (5) Bluetooth remote, (6) Flexible gooseneck, (7) Ball head adapter, (8) Smartphone Holder.

2. Safety Notes

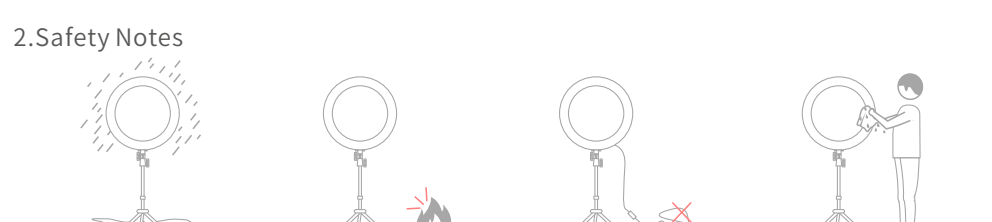

- ⚠ Please do not use in a humid environment.
- ⚠ Please do not use the light in a flammable or explosive environment in case of safety hazard.
- ⚠ Please put the cables away in case of tripping hazard.
- ⚠ Please do not use chemicals or liquids to clean the LED light.

Contents

English ----- 1  
 Deutsch ----- 4  
 日本語 ----- 7  
 Español ----- 10  
 Français ----- 13  
 Italiano ----- 16  
 Dutsch ----- 19  
 中文 ----- 22

3. Installation Guide  
Installation of Light Stand

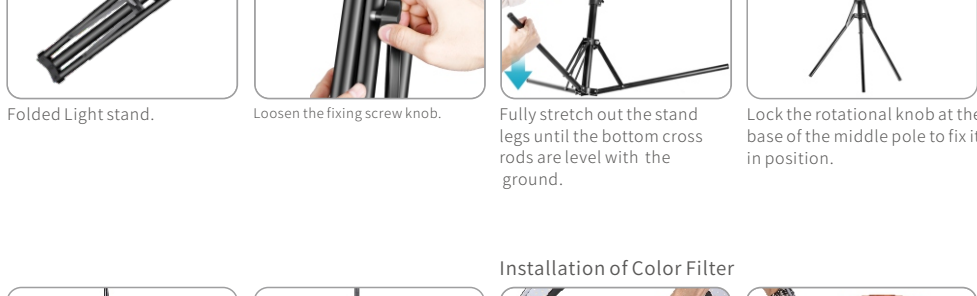

Installation of Smartphone

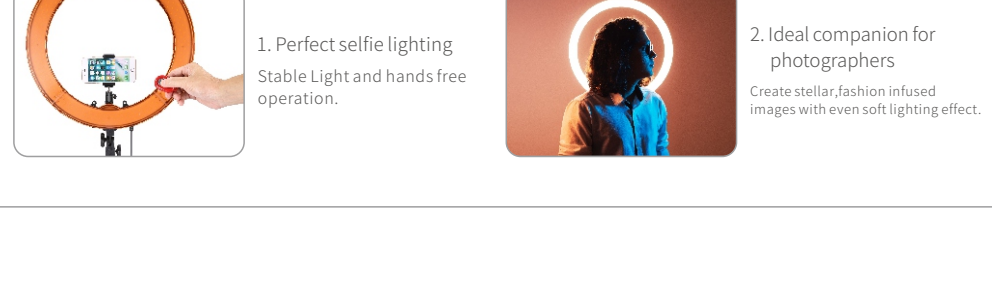
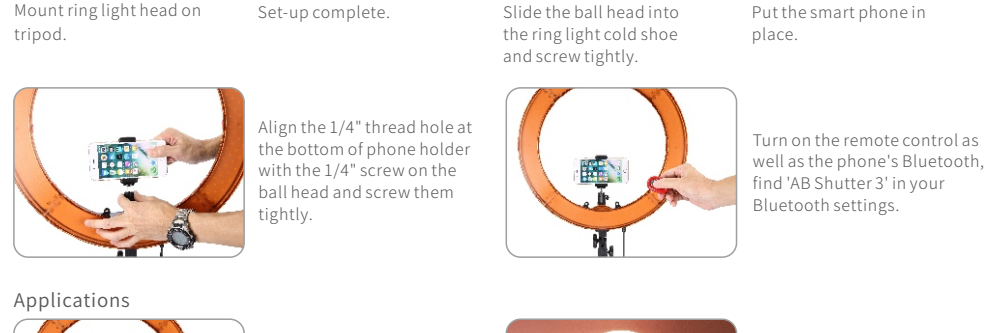

1. Zubehör ist enthalten.

Bitte beachten Sie: Einige in diesem Handbuch enthaltene Artikel dienen nur zu Illustrationszwecken und können möglicherweise separat erworben werden. Dieses Ringlicht enthält nur Folgendes: (1) Stativständer, (2) Orangefarbene Filter, (3) Weißfilterset, (4) Ringlichtkopf, (5) Bluetooth-Fernbedienung, (6) Flexibles Weiches Rohr, (7) Kugelkopfaufsatz, (8) Smartphone-Halterung.

2. Vorsichtshinweis

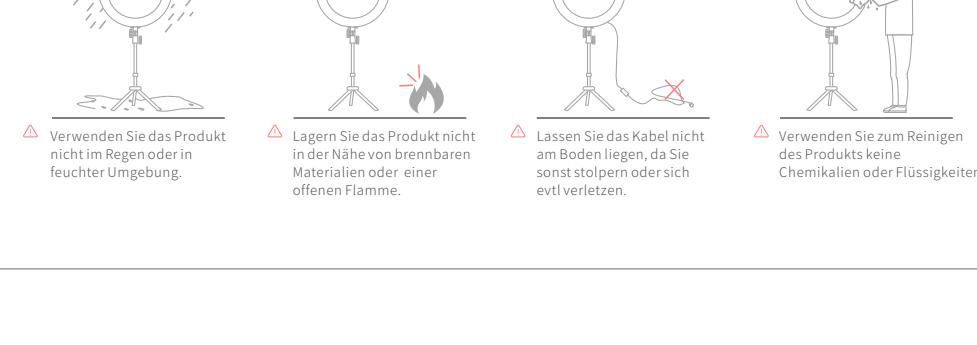

3. Installation

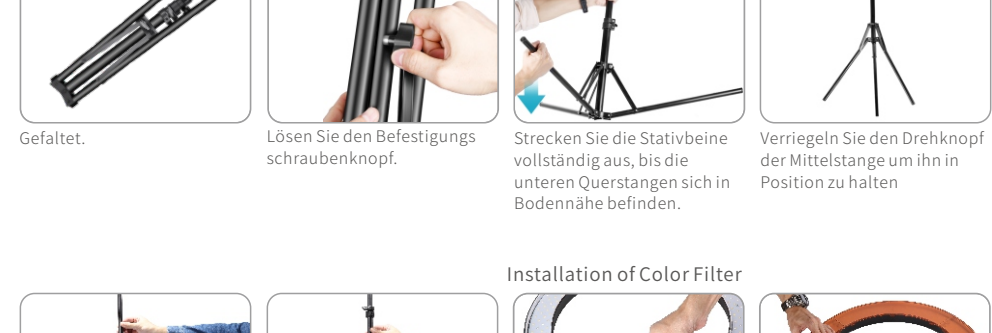

Installation des Handys

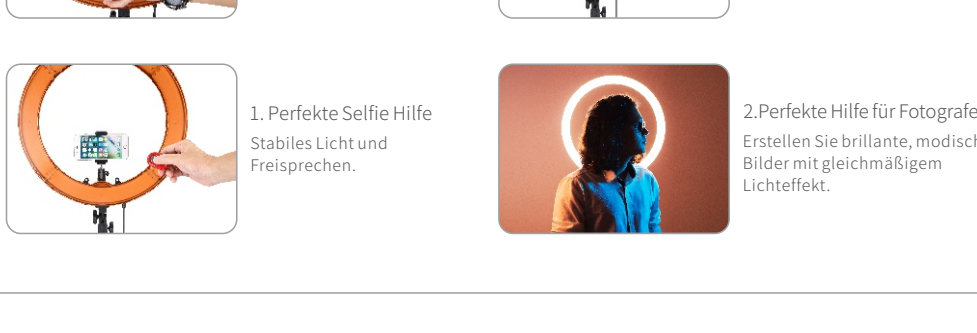

1. 付属されたアクセサリー:

注意: 本マニュアルに記載されている一部のアクセサリーは、説明のみを目的としており、付属されない場合があります。このリングライトセットには、次のものが含まれます: (1) 三脚スタンド、(2) オレンジフィルター、(3) ホワイトフィルターセット、(4) リングライトヘッド、(5) ブลู투스リモートコントロール、(6) フレキシブルな柔らかいチューブ、(7) スマートフォンホルダー。

2. 安全上のご注意



3. インストールガイド



スマートフォンの取り付け

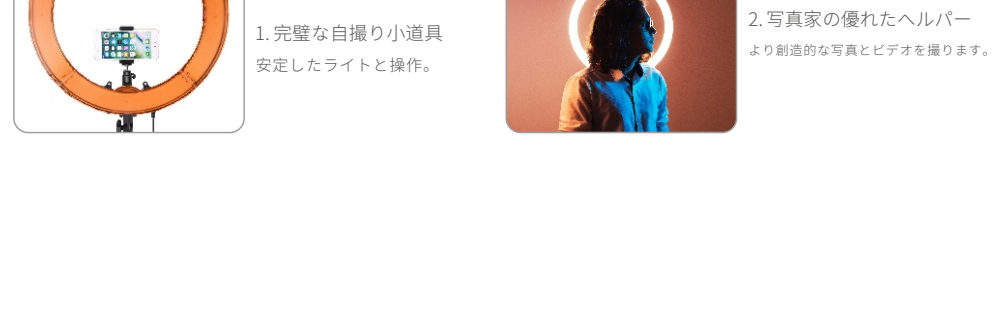

1. Accesorios incluidos.

Tenga en cuenta que algunos artículos incluidos en este manual son solo para fines ilustrativos y pueden estar disponibles para su compra por separado. Este juego de anillo de luz incluye solo lo siguiente: (1) Soporte de trípode, (2) Juego de filtro naranja, (3) Juego de filtro blanco, (4) Cabeza de anillo de luz, (5) Control remoto Bluetooth, (6) Cuello de cisne flexible, (7) Adaptador de cabeza esférica, (8) Soporte para smartphone.

2. Notas de seguridad



3. Guía de instalación



Instalación del Smartphone

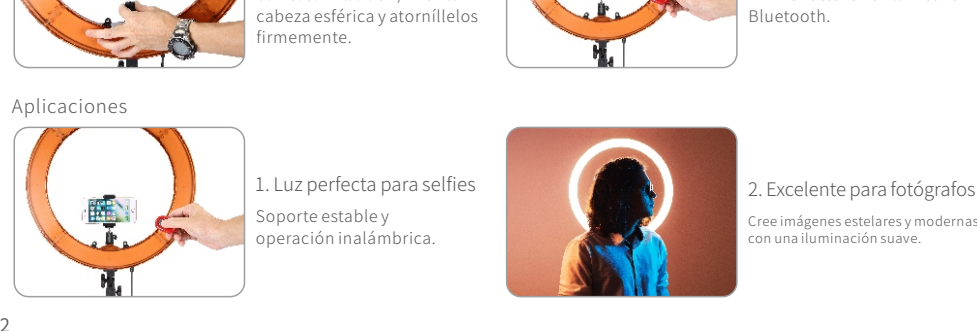
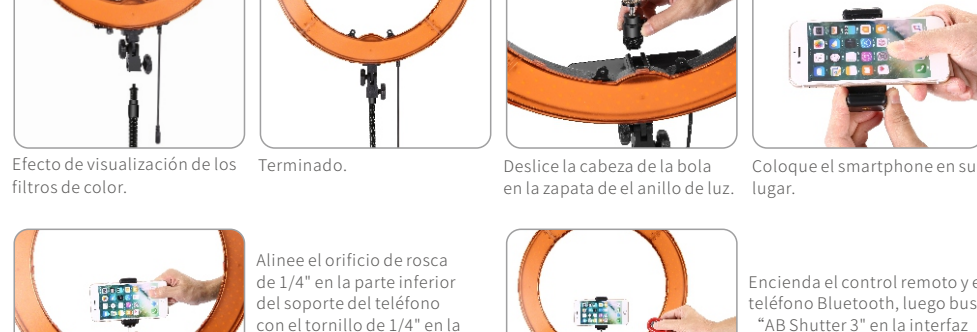

1. Accessoires inclus

Remarque: Certains articles inclus dans ce manuel sont uniquement destinés à l'illustration et sont disponibles séparément. L'anneau lumineux comprend que les accessoires suivants: (1) pied d'éclairage, (2) jeu de filtres orange, (3) jeu de filtres blancs, (4) tête d'anneau lumineux, (5) télécommande Bluetooth, (6) cou de cygne flexible, (7) rotule, (8) porte-Smartphone.

2. Consignes de sécurité

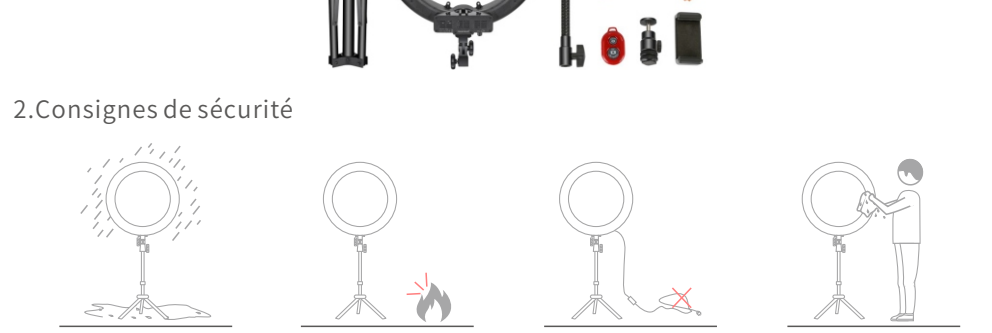

3. Guide d'Installation



Installation of Smartphone

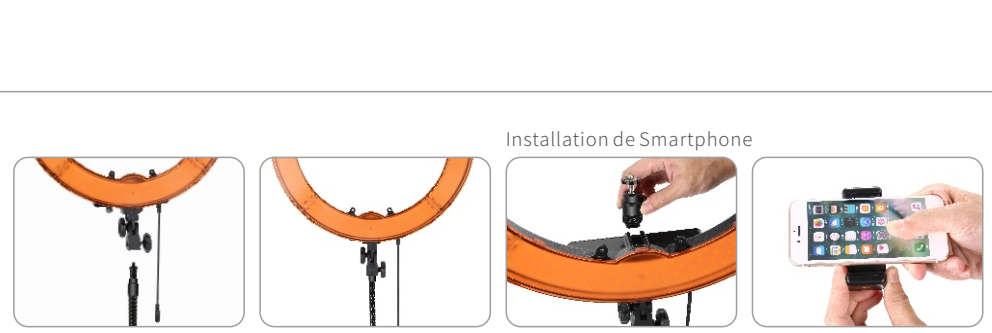

1. Accessori Includi

Nota Bene: Alcuni articoli inclusi in questo manuale sono solamente a scopo illustrativo e sono disponibili per essere acquistati separatamente. In questo set con luce anulare sono inclusi solamente i seguenti articoli: (1) Supporto Treppiedi, (2) Filtro Arancione, (3) Filtro Bianco, (4) Testa della Luce Anulare, (5) Telecomando Bluetooth, (6) Braccio Flessibile, (7) Adattatore per testa a sfera, (8) Supporto per telefono.

2. Note di sicurezza

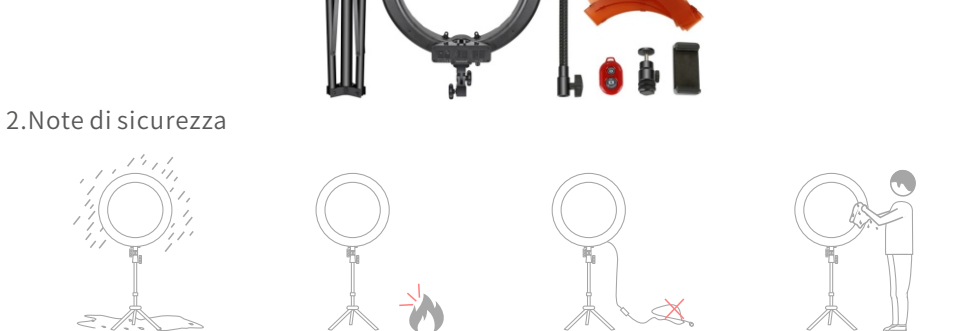

3. Guida d'installazione

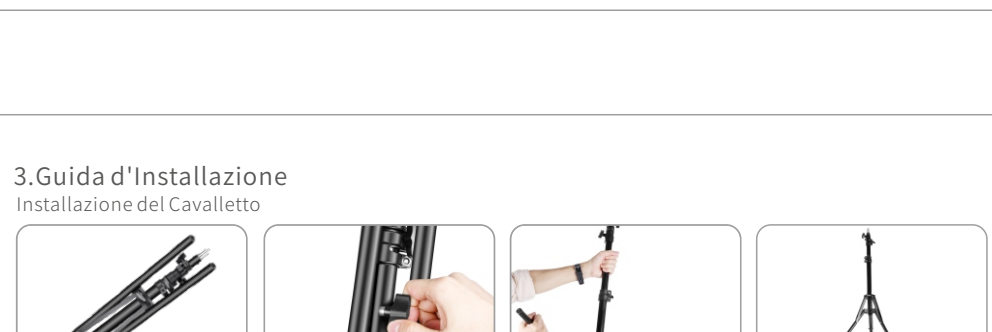

Installazione dello Smartphone

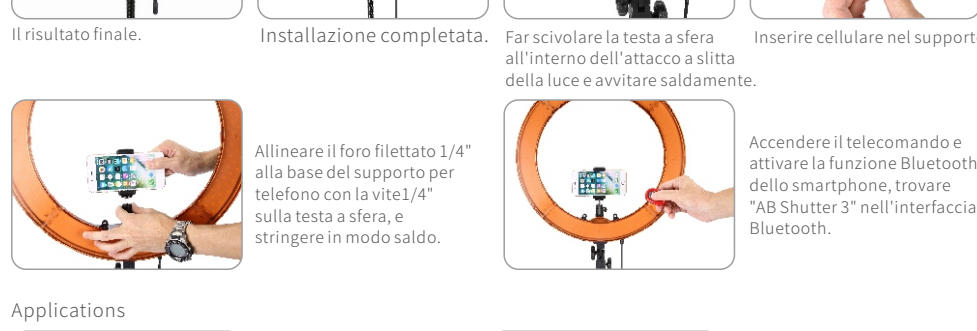
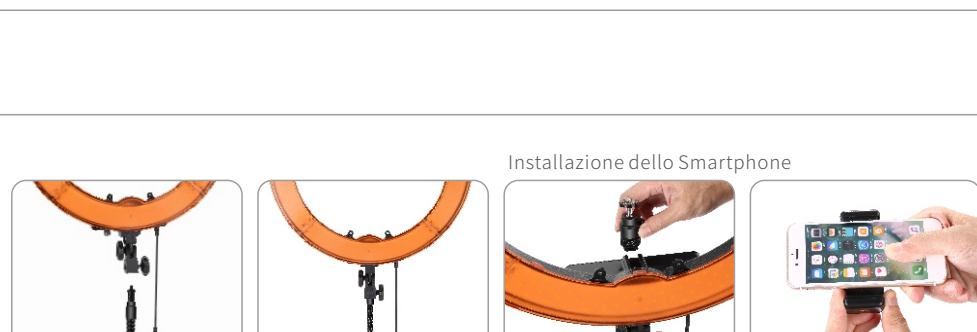

1. Toebehoren

Let op: sommige items in deze handleiding zijn uitsluitend bedoeld ter illustratie en zijn afzonderlijk verkrijgbaar. Deze ringlamp set bevat alleen het volgende: (1) Statief Standaard, (2) Oranje filterset, (3) Witte filterset, (4) Ringlamp Kop, (5) Bluetooth-afstandsbediening, (6) Flexibele slang, (7) Balhoofd Adapter, (8) Smartphone Houder.

2. Waarschuwingen



3. Handleiding

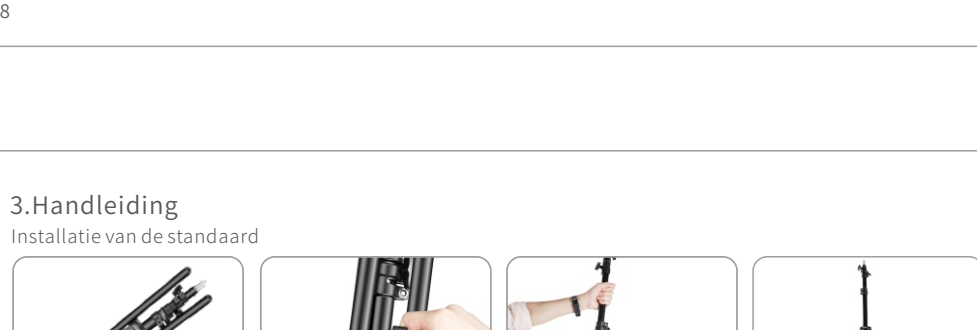

Montage van de smartphone

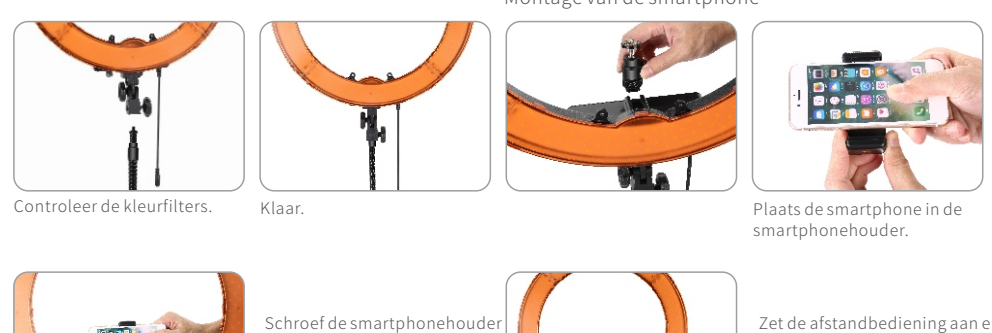

1. 配件

注意: 本手册中的某些物品仅用于说明操作目的单独使用。此环灯套装仅包括以下配件: (1) 三脚架支架, (2) 橙色滤光片, (3) 白色滤光片, (4) 白色滤光片, (5) 蓝牙遥控器, (6) 柔性软管, (7) 球形适配器, (8) 手机支架。

2. 注意安全



3. 安裝步驟

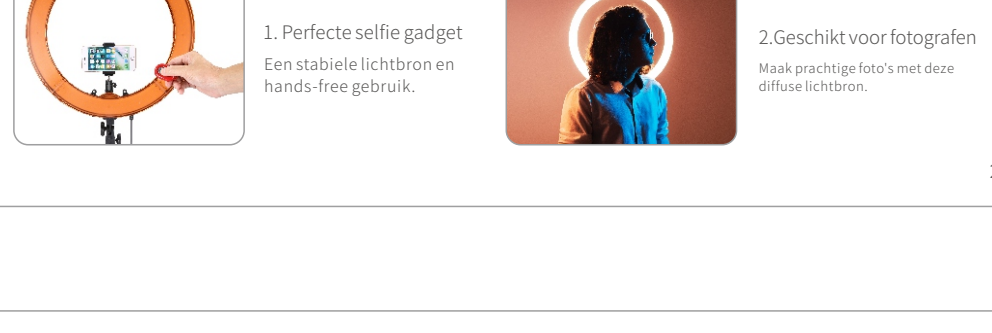

安裝手机



3. 安裝步驟

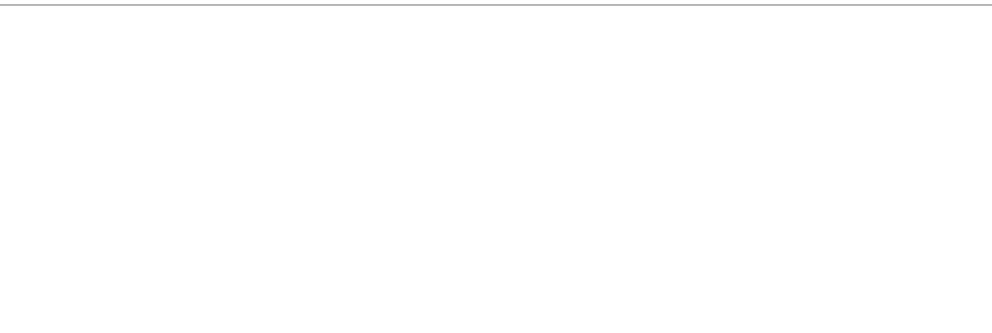

Official Home Page

Scan for tutorial video