

# SAMAR VL57532

WALL

PROJECT



## DESCRIPTION

The stunning blown glass shades of the Samar Collection make wonderfully versatile statement pieces or subtle lighting options. The three ombre finishes are gorgeous specimens available in various hanging options that help create a dynamic space through lighting and tone. Each glass finish has three fixture finishes that help create an exciting piece for a unique space in your home.



VL57532-BG/CP  
Brushed  
Gold/Copper

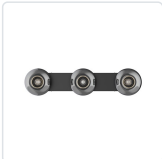

VL57532-BK/SM  
Black/Smoked



VL57532-CH/OP  
Chrome/Opal Glass

## SPECIFICATION DETAILS

<b>Fixture Dimensions</b>	W32-3/8" x H7-1/2" x E6"
<b>Lamp Type</b>	Incandescent, A15, Medium Base
<b>Wattage</b>	3 x 60W
<b>Voltage</b>	120V
<b>Glass Details</b>	Transition Copper Glass, Transition Smoked Glass or Transition Opal Glass
<b>Location</b>	Damp
<b>Bulbs Included</b>	No
<b>Illumination Direction</b>	Front
<b>Mounting Style</b>	All Orientation
<b>Canopy Dimensions</b>	L30 x H5-1/8" x E5/8"

\* For custom options, consult factory for details.

\* For warranty information, please visit [www.kuzcolighting.com/warranty](http://www.kuzcolighting.com/warranty)

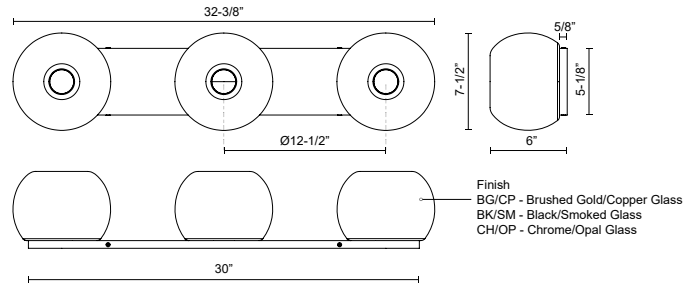

# KUZCO

19054 28TH AVENUE  
SURREY - BC V3Z 6M3  
CANADA

WWW.KUZCOLIGHTING.COM

## COMMENT

