

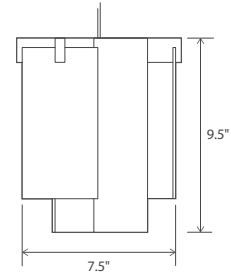

brushed aluminum

Salix
accent pendant



Dimensions: 7.5" x 7.5", 9.0"
 Materials: solid wood, polymer, aluminum
 Product weight: 3 lb
 Light source: integrated LED
 Light output: 915 Lumens (source), based on 2700K
 Light color*: 2700 K or 3500 K
 Color accuracy: 90+ CRI
 Power usage: 9 W
 Dimmable: 0-10 V dimming at 120-277 V AC
 TRIAC and ELV dimming at 120 V AC only
 Driver location: must be housed in J-box
 Driver dimensions: 3.3" x 1.6" x 1.0", included
 Brushed aluminum (CM-006) low-profile square canopy with white braided cord included
 Canopy dimensions: 4.5" x 4.5", 0.38"
 Must use included external LED driver (2.25" x 1.5" x 1")
 Accent pendants can be clustered by using multi-point round canopy or multi-point linear canopy
 See website for more canopy information
 6'-0" drop length, field adjustable
 Suitable for a sloped ceiling
 Wood grain will vary
 Specifications subject to change

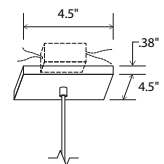

low-profile square canopy



MATERIAL & FINISH OPTIONS

Salix part # 06-120-

| | | | |
|---|----------|--|--|
| Wood Finish walnut (CM-001) | W | | |
| Metal Finish brushed aluminum (CM-012) | A | | |
| Lamping* 2700 K LED 3500 K LED | 27 35 | | |
| Driver 120 V AC input voltage TRIAC, ELV, or 0-10 V dimmable | P1 | | |



walnut (CM-001)



brushed aluminum (CM-012)

Includes: frosted polymer (CM-024)

* Available in 3000K, 4000K and other color temperatures upon request.

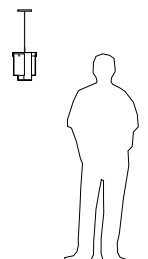

The Salix pendant's materials and proportions are in perfect harmony. The brushed aluminum set against the oiled walnut in this fixture still feels strikingly fresh and beautiful after years of production.

Nick Sheridan,
Designer

▲WARNING. California Proposition 65 Warning for California Consumers. This product can expose you to chemicals including wood dust and lead which are known to the State of California to cause cancer or birth defects or other reproductive harm. For more information go to www.P65Warnings.ca.gov