

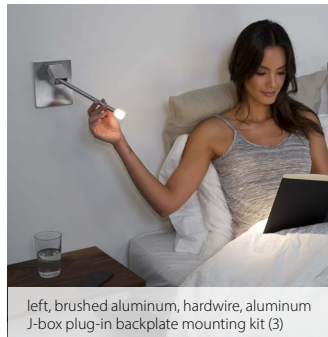

right model, brushed aluminum, direct mount



right model, white, mounting kit (3)



left, brushed aluminum, hardwire, aluminum J-box plug-in backplate mounting kit (3)

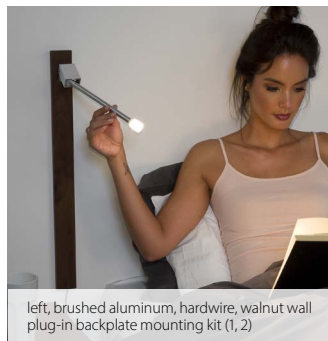

left, brushed aluminum, hardwire, walnut wall plug-in backplate mounting kit (1, 2)

The Libri is about function and ease: an extremely articulate directional task light in a discrete and sturdy form that is very intuitive to use.

Nick Sheridan,  
Designer

## Libri

bedside sconce reading light

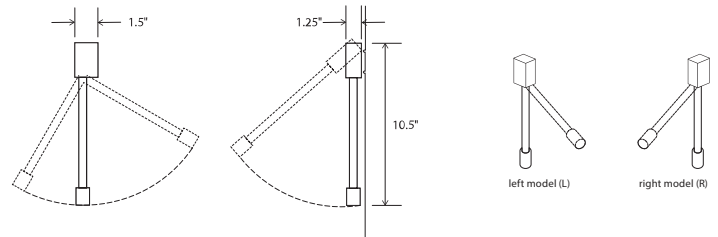

Dimensions: 10.5" x 1.5" x 1.2"  
 Materials: aluminum, polymer, optional solid wood mounting  
 Product weight: 1 lb  
 Light source: integrated LED  
 Light output: 160 Lumens (source)  
 Light color: 2700 K  
 Color accuracy: 90+ CRI  
 Power usage: 2 W  
 Automatic ON/OFF when arm is pulled away from wall  
 Hardwired and corded versions available  
 Hardwired model includes an external power supply (2.75" x 1.63" x 1.13")  
 Requires space in J-box for included power adapter  
 Alternate voltage/plug styles available  
 Specifications subject to change



### MATERIAL & FINISH OPTIONS

Libri part # 03-160-

#### Direction

left model  
right model

#### Finish

brushed aluminum (CM-006)  
white (CM-060)

#### Installation

corded (plug-in)  
hardwired\*

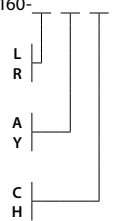

Alternate voltage / plug styles available

J-box centered behind fixture

\*Hardwired installation requires room in the J-box for the included external power adapter (2" x 1" x 1.25"). Typically mounting kit is used. See mounting options below.

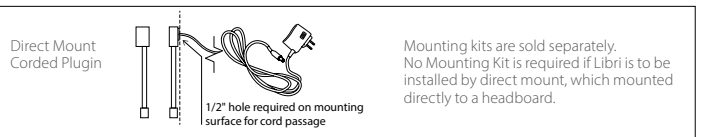

Mounting kits are sold separately. No Mounting Kit is required if Libri is to be installed by direct mount, which mounted directly to a headboard.

## Libri Mounting Kit

sconce backplate

### J-box Backplate: Mounting Kit (3)

J-box backplate is typically used when mounting to a J-box. Hardwired installation requires room in the J-box for the included external power adapter (2" x 1" x 1.25").

### Wall Mount Plug-in Backplate: Mounting Kit (1, 2)

Wall mount plug-in backplate is used when mounting directly to the wall and plugging into a wall outlet. The wall mount is an elongated rectangle that allows the cord to exit discreetly below the fixture.

### MOUNTING KIT OPTIONS

Libri part # 03-160-10

#### Direction

wall mount plug-in, left  
wall mount plug-in, right  
J-box backplate

#### Finish

brushed aluminum (CM-006)  
walnut (CM-001)  
white (CM-060)

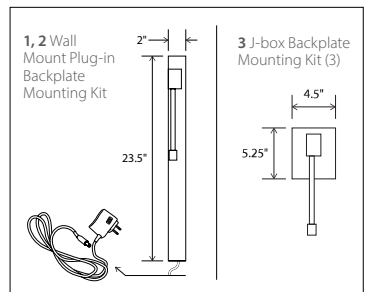
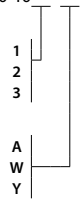

brushed aluminum(CM-006)



walnut (CM-001)