

Claudo
accent pendant

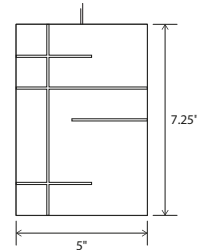

Dimensions: 5" x 5", 7.25"
 Materials: solid wood, polymer
 Product weight: 3 lb
 Light source: integrated LED
 Light output: 915 Lumens (source), based on 2700K
 Light color*: 2700 K or 3500 K
 Color accuracy: 90+ CRI
 Power usage: 9 W
 Dimmable: 0-10 V dimming at 120-277 V AC
 TRIAC and ELV dimming at 120 V AC only
 Driver location: must be housed in J-box
 Driver dimensions: 2" x 1.3" x 1", included
 Brushed aluminum (CM-006) low-profile square canopy with white braided cord included
 Must use included external LED driver (2.25" x 1.5" x 1")
 Canopy dimensions: 4.5" x 4.5", 0.38"
 Accent pendants can be clustered by using multi-point round canopy or multi-point linear canopy
 See website for more canopy information
 6'-0" drop length, field adjustable
 Suitable for a sloped ceiling
 Wood grain will vary
 Specifications subject to change

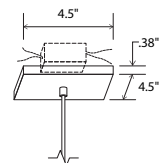

low-profile square canopy



walnut (CM-001)



dark stained walnut (CM-002)



MATERIAL & FINISH OPTIONS

Claudo part # 06-110-

Wood Body
 walnut (CM-001)
 dark stained walnut (CM-002)

Lamping*
 2700 K LED
 3500 K LED

Driver
 120 V AC input voltage
 TRIAC, ELV, or 0-10 V dimmable

Includes
 frosted polymer (CM-024)

Also available in a sconce version

*Available in 3000K, 4000K and other color temperatures upon request

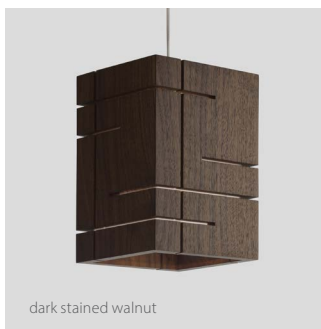
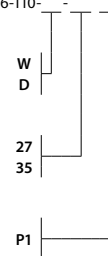

dark stained walnut



The Clauco showcases the beautiful natural walnut wood grain and sets it against the rigorous slits cut in each face as they wrap around the simple, clean shade form. A beautiful glow emanates from each slit, showing the striking rectilinear composition, in which all four sides are unique..

Nick Sheridan,
Designer

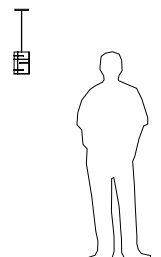

▲WARNING. California Proposition 65 Warning for California Consumers. This product can expose you to chemicals including wood dust and lead which are known to the State of California to cause cancer or birth defects or other reproductive harm. For more information go to www.P65Warnings.ca.gov