

The Arca is an experiment with density and mass. As one moves around the room, the fixture morphs from a commanding presence of solid walnut into a graceful bar of light surrounded by an elegant porous cage.

Nick Sheridan,
Designer

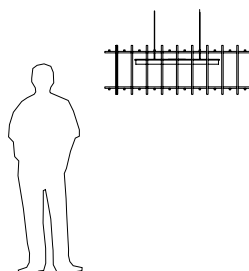

Arca linear pendant

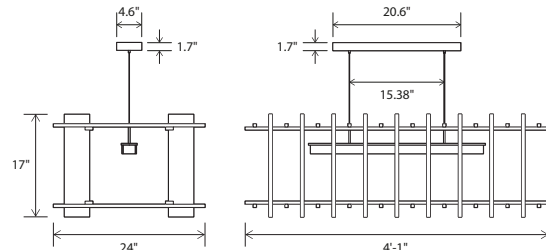

Dimensions: 4'1" x 24", 17"
 Materials: solid wood, aluminum, polymer
 Product weight: 20 lb
 Light source: integrated LED
 Light output: 1720 Lumens (source)
 Light color: 2700 K or 3500 K
 Color accuracy: 90+ CRI
 Power usage: 16 W
 Dimmable (see driver below)
 Linear canopy included
 Canopy dimensions: 20.6" x 4.6" x 1.7"
 Canopy color matches fixture's metal color
 Wood canopy covers are available:
 Walnut (CM-001) cover: part # 60-241-001W
 Dark Stained Walnut (CM-002) cover: part # 60-241-001D
 White Washed Oak (CM-095) cover: part # 60-241-001O
 See website for more canopy information
 6'-0" drop length, field adjustable
 Suitable for a sloped ceiling
 Wood grain will vary
 Specifications subject to change

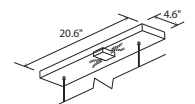

linear canopy, brushed aluminum



MATERIAL & FINISH OPTIONS

Arca part # 07-120-

Metal Finish

- brushed aluminum (CM-006)
- black anodized aluminum (CM-007)

Wood Body

- walnut (CM-001)
- dark stained walnut (CM-002)

Lamping*

- 2700 K LED
- 3500 K LED

Driver

- AC Input Voltage Range: 120-277 V
- 120 V input: TRIAC, ELV & 0-10 V dimmable
- 240 & 277 V input: only 0-10 V dimmable

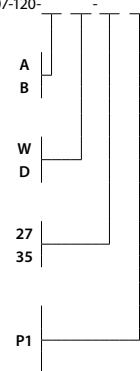

brushed aluminum (CM-006)



black anodized aluminum (CM-007)



walnut (CM-001)



dark stained walnut (CM-002)

Includes:

- white polymer shade (CM-052)
- frosted polymer diffuser (CM-024)

*Available in 3000K, 4000K and other color temperatures upon request