

# ASSEMBLY & INSTALLATION INSTRUCTIONS

356850 Polaris Semi-Flush

A673

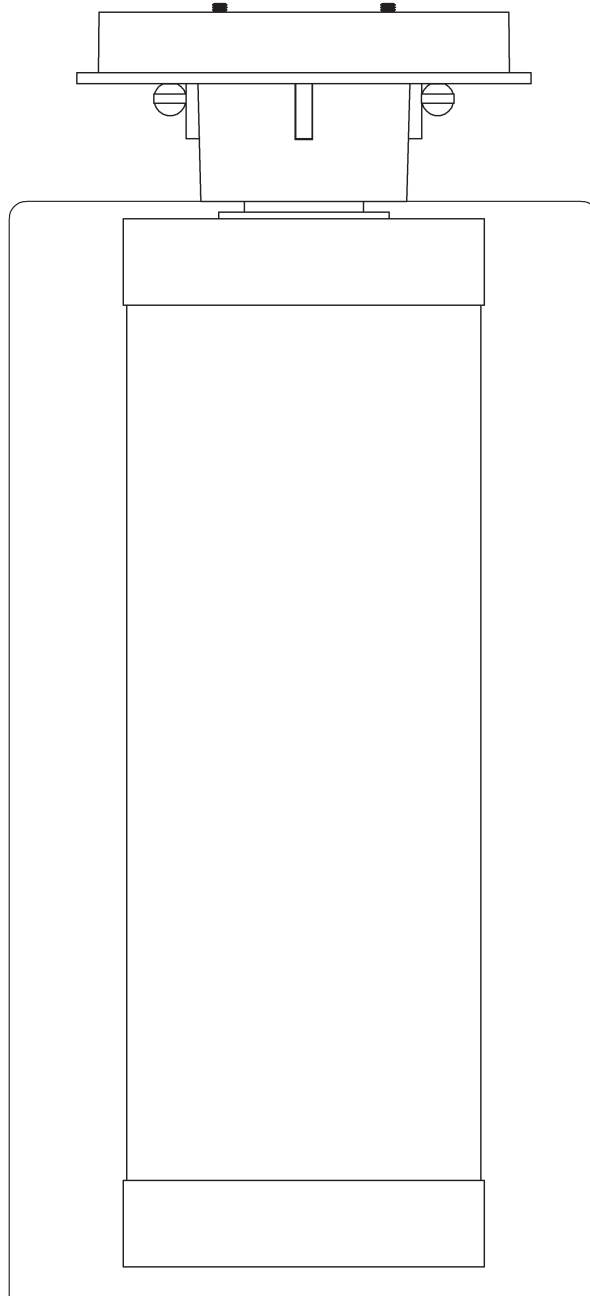

HUBBARDTON FORGE.

MODERN AMERICAN BLACKSMITHS | FINE, HAND CRAFTED LIGHTING  
CASTLETON, VERMONT USA | HUBBARDTONFORGE.COM

## Component Parts

- A Fixture**
- B 8-32 Screws (2)**
- C Ceiling Bracket**
- D Crossbar**
- E Ground Screw**
- F Studs (2)**
- G Knurled Ball (2)**
- H Glass**
- I Socket**
- J Retaining Ring**
- K Retaining Ring Tool**
- L Decorative Element**
- M White Washer**



# ASSEMBLY & INSTALLATION INSTRUCTIONS

A673

356850 Polaris Semi-Flush

**CAUTION: FAILURE TO INSTALL THIS FIXTURE PROPERLY MAY RESULT IN SERIOUS PERSONAL INJURY OR DEATH AND PROPERTY DAMAGE.** We recommend installation by a licensed electrician. This product must be installed in accordance with applicable installation code(s), by a person familiar with the construction and operation of the product and the hazards involved.\*

Caution: Do not exceed maximum wattage noted on fixture. Use only recommended bulbs with fixture.

## To Install Fixture (Figure 1)

**CAUTION: BE SURE POWER IS OFF AT THE MAIN BREAKER BOX PRIOR TO INSTALLATION.**

1. Carefully unpack the fixture (A) from the carton.
2. Locate two 8-32 screws (B) and studs (F) found in kit bag. Using two 8-32 screws (B) attach ceiling bracket (C) to crossbar (D) so that outer threaded holes in the ceiling bracket are aligned with outer oval slots in the crossbar. Thread studs (F) into crossbar
3. Using two machine screws (not provided) fasten crossbar (D) to the electric box using outer oval holes to orient fixture to desired hanging position.

Note: A new electric box comes with screws. When replacing an existing fixture, retain the screws for use with the new fixture.

4. While holding fixture (A) close to ceiling and using suitable wire connectors (not provided), connect fixture wires to supply wires (white to white or ribbed) and (black to black or smooth). Run a pigtail lead from crossbar ground screw (E) to the junction box and connect all ground wires (bare copper or green to bare copper or green) together.

**CAUTION: MAKE SURE WIRE CONNECTORS ARE TWISTED ON SECURELY AND NO BARE WIRE IS EXPOSED.**

5. Align holes in fixture (A) with studs on crossbar (D) and push fixture firmly to ceiling. Fasten with knurled balls (G).

**CAUTION: BE SURE NO WIRES ARE PINCHED BETWEEN THE FIXTURE (A) AND THE CEILING.**

6. Slide glass (H) over socket (I).
7. Slide white washer (M) over socket (I).
8. Place retaining ring (J) into retaining ring tool (K). Thread retaining ring (J) onto socket (I) and tighten against glass. Remove retaining ring tool (K).
9. Install bulb (not included).
10. Thread decorative element (L) on to socket (I) until it contacts the glass (H). Unthread the decorative element (L) just until it is aligned and square with the rest of the fixture (A).
11. Restore electricity at main breaker.

# ASSEMBLY & INSTALLATION INSTRUCTIONS

A673

356850 Polaris Semi-Flush

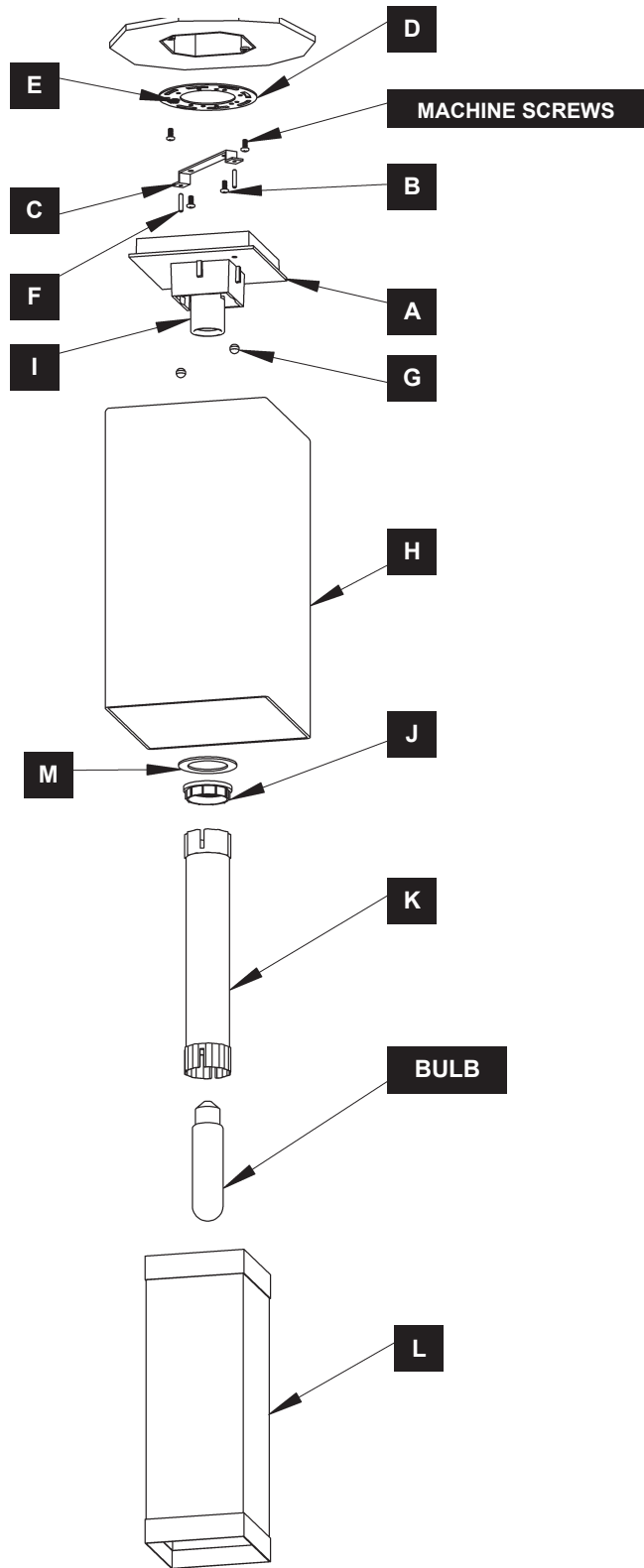

(Figure 1)

If you need further assistance, or find that you are missing any parts, please contact the dealer from which you purchased this product. We hope you enjoy your fixture!

*\* Hubbardton Forge will not be liable for injury or damage caused by improper installation, lamping or use of this fixture.*



HUBBARDTON FORGE.

MODERN AMERICAN BLACKSMITHS | FINE, HAND CRAFTED LIGHTING  
CASTLETON, VERMONT USA | HUBBARDTONFORGE.COM