

ASSEMBLY & INSTALLATION INSTRUCTIONS

C103

241100 Pulse LED Floor Lamp

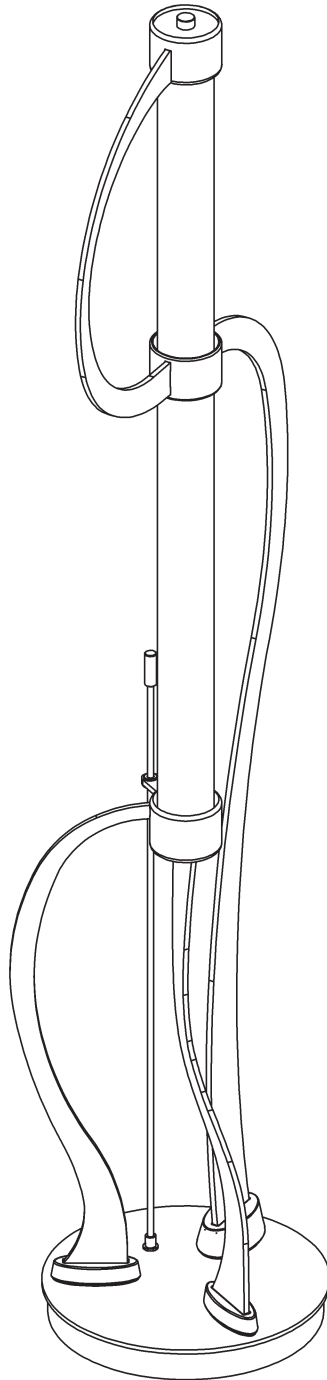

HUBBARDTON FORGE.

MODERN AMERICAN BLACKSMITHS | FINE, HAND CRAFTED LIGHTING
CASTLETON, VERMONT USA | HUBBARDTONFORGE.COM

Component Parts

A	Fixture
B	Dimmer Rod
C	Dimmer Knob
D	Thumb Screw
E	Top Plate
F	LED Glass Assembly
G	Endcap (2)
H	Stud (2)
I	Bottom Cup
J	Center Tube
K	O-Ring
L	Bracket
M	Standoff
N	Washer
O	Cover
P	Cap



241100 Pulse LED Floor Lamp

CAUTION: FAILURE TO INSTALL THIS FIXTURE PROPERLY MAY RESULT IN SERIOUS PERSONAL INJURY OR DEATH AND PROPERTY DAMAGE. We recommend installation by a licensed electrician. This product must be installed in accordance with applicable installation code(s), by a person familiar with the construction and operation of the product and the hazards involved.*

Caution: Do not exceed maximum wattage noted on fixture. Use only recommended bulbs with fixture.

Install Dimmer Rod (Figure 1)

1. Carefully unpack fixture (A) from carton.
2. Apply a drop of the supplied thread locking compound to the internal threads at the top of the dimmer knob (C).

NOTE: APPLICATION OF THE THREAD LOCKING COMPOUND IS NECESSARY TO PREVENT THE DIMMER ROD FROM LOOSENING. BE CERTAIN TO APPLY THE COMPOUND.

3. Slide dimmer rod (B) down through grommet in Support and thread into dimmer knob (C).

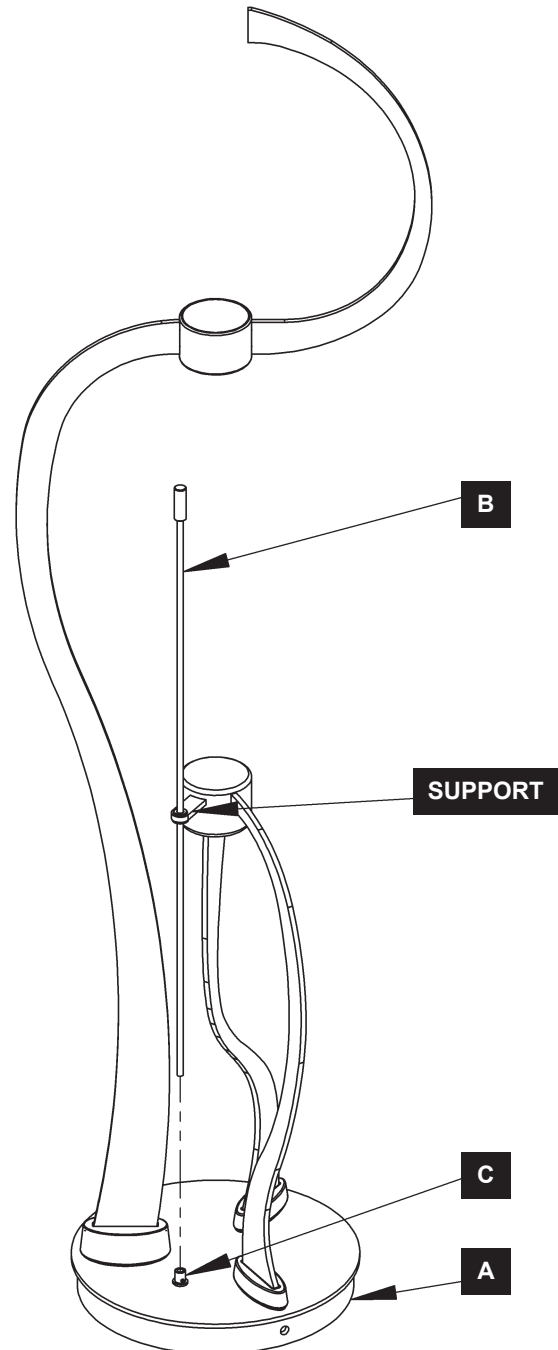

(Figure 1)

241100 Pulse LED Floor Lamp

Install LED Glass Assembly *(Figure 2)*

1. Carefully unpack LED glass assembly (F) and locate end with (+) label. (+) end will be at the top of the fixture.
2. Orient LED glass assembly (F) as shown in Figure 2.
3. Slide bottom endcap (G) through center tube (J) and down into bottom cup (I).
4. Align stud (H) with hole in bottom cup (I). Thread stud (H) completely into bottom cup (I) until snug.
5. O-ring (K) should be inside center tube (J).
6. Follow instructions on next page to complete assembly.

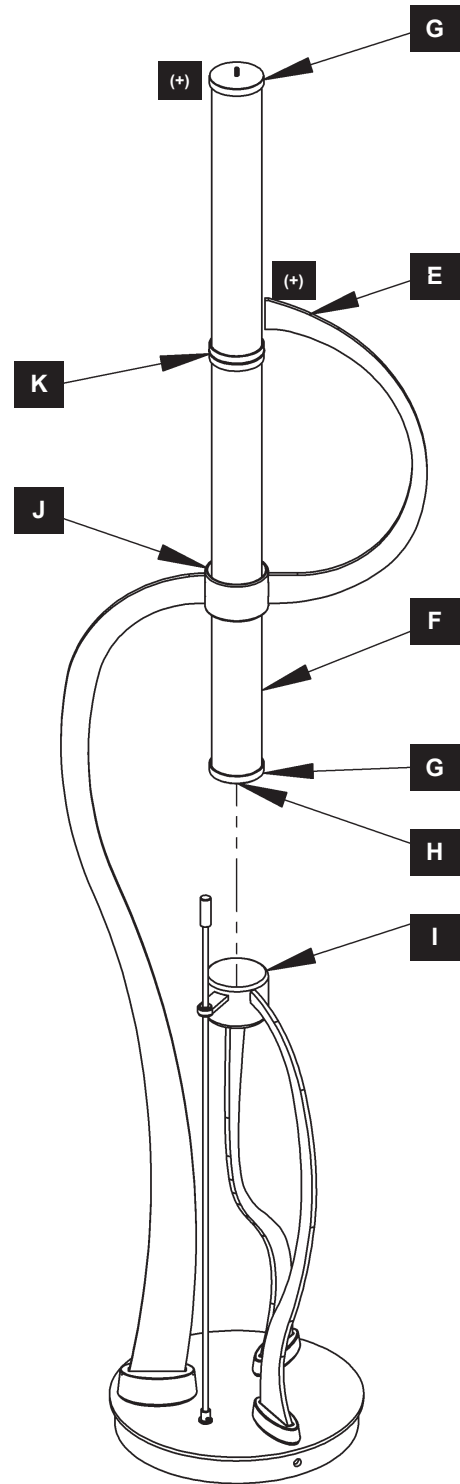

(Figure 2)

241100 Pulse LED Floor Lamp

Complete Assembly *(Figure 3)*

1. Place bracket (L) over stud (H) on endcap (G).
2. Bracket (L) should also contact top plate (E).
3. Thread standoff (M) onto stud (H) and tighten to secure bracket (L).
4. Install thumb screw (D) (found in kit bag), through bracket (L) and thread into top plate (E).

NOTE: Screw must be tight to create electrical connection.

5. Place washer (N) on top of standoff (M).
6. Install cover (O) over standoff (M) and top plate (E).
7. Thread cap (P) onto standoff (M) to secure.
8. Plug in power cord.

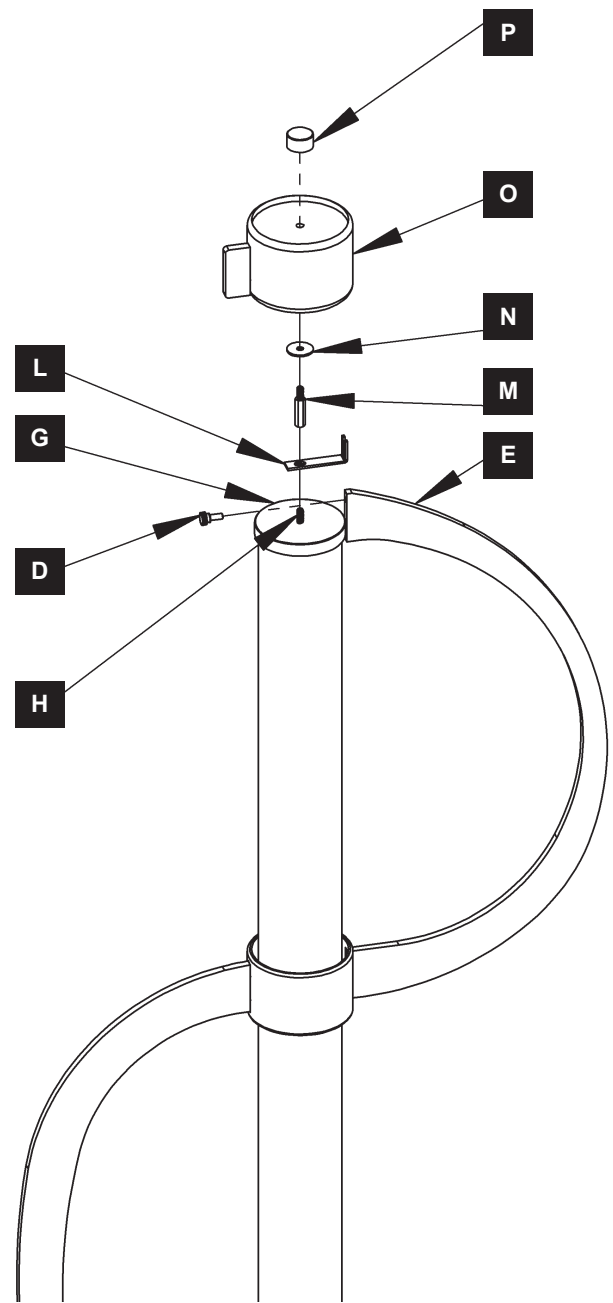

(Figure 3)

If you need further assistance, or find that you are missing any parts, please contact the dealer from which you purchased this product.
We hope you enjoy your fixture!

*** Hubbardton Forge will not be liable for injury or damage caused by improper installation, lamping or use of this fixture.**