

ASSEMBLY & INSTALLATION INSTRUCTIONS

A968

Cypress Kitchen Pendant - 181540

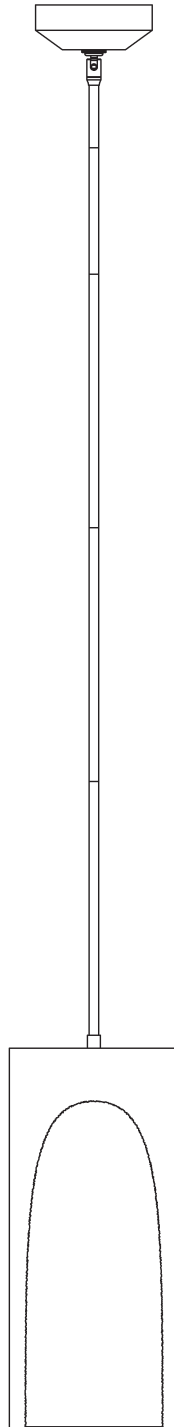

HUBBARDTON FORGE.

MODERN AMERICAN BLACKSMITHS | FINE, HAND CRAFTED LIGHTING
CASTLETON, VERMONT USA | HUBBARDTONFORGE.COM

Component Parts

- A Fixture**
- B Crossbar**
- C Driver**
- D Cupped Washer**
- E Ground Screw**
- F Fixture Bracket**
- G # 8 Screw (2)**
- H Swivel**
- I Canopy**
- J Canopy Ring**
- K Stem Nipple (4)**
- L 3" Fixture Pipe (1)**
- M 6" Fixture Pipe (1)**
- N 12" Fixture Pipe (3)**
- O Wire Connectors**
- P Glass**
- Q Flat Head Screw (4)**
- R Fixture Front**
- S Fixture Back**



ASSEMBLY & INSTALLATION INSTRUCTIONS

A968

Cypress Kitchen Pendant - 181540

CAUTION: FAILURE TO INSTALL THIS FIXTURE PROPERLY MAY RESULT IN SERIOUS PERSONAL INJURY OR DEATH AND PROPERTY DAMAGE. We recommend installation by a licensed electrician. This product must be installed in accordance with applicable installation code(s), by a person familiar with the construction and operation of the product and the hazards involved.*

Caution: Do not exceed maximum wattage noted on fixture. Use only recommended bulbs with fixture.

Install Fixture *(Figure 1 - on following page)*

1. Carefully unpack the fixture from the carton.
2. Using two machine screws (not provided), fasten the crossbar (B) & driver (C) to the electric box .

Note: A new electric box comes with screws. When replacing a fixture, retain the existing screws for use with the new fixture.

3. Using suitable wire connectors (not provided), connect driver wires (C) to supply wires (white to white supply, black to black supply). Run a pigtail from the crossbar (B) to the junction box using green ground screw (E) and cupped washer (D).

CAUTION: MAKE SURE WIRE CONNECTORS ARE TWISTED ON SECURELY AND NO BARE WIRE IS EXPOSED.

4. Locate fixture pipes (L,M,N), fixture (A), stem nipples (K) . Stem nipples (K) can be found in the kit bag.
5. Provided are multiple fixture pipes in three different lengths. Choose the combination that will achieve the overall height desired. Refer to the table below to determine the pipes required to reach the desired overall height. Once you have determined the components necessary, feed the wires that exit fixture (A) through the individual components and thread pipes and nipples together. Wires will slip easier through loose components than through pipes and nipples that are pre-assembled. Once wires are run, apply thread locking compound to all the connection points and assemble the pipes and nipples.

		Overall Height of Fixture																
		22.4	25.4	28.4	31.4	34.4	37.4	40.4	43.4	46.4	49.4	52.4	55.4	58.4	61.4	64.4	67.4	
# of Pipes Required	3" Pipe (J)		1		1		1			1			1			1		1
	6" Pipe (K)			1	1			1	1			1	1				1	1
	12" Pipe (L)					1	1	1	1	2	2	2	2	3	3	3	3	3

6. Carefully slide canopy ring (J) and canopy (I) over wires and fixture pipes (L,M,N) until they rest on fixture (A).
 7. Slip wires from the fixture (A) through assembled swivel (H) and fixture bracket (F)
 8. Using #8 screws (G), that are shipped in crossbar (B), fasten fixture bracket (F) to crossbar (B) taking caution not to pinch any wires.
 9. Using provided wire connectors (O); attach fixture wires to driver (C) DC output wires (grey to red and black to black).
- Note:** Wire connectors are shipped attached to driver output wires. Fixture wires must be stripped before inserted into provided wire connector.
10. Refer to instructions on next page to continue installation.

ASSEMBLY & INSTALLATION INSTRUCTIONS

A968

Cypress Kitchen Pendant - 181540

11. Hold canopy (I) close to ceiling and connect all ground wires (bare copper or green to bare copper or green). Push wires back into electric box.

CAUTION: MAKE SURE WIRE CONNECTORS ARE TWISTED ON SECURELY AND NO BARE WIRE IS EXPOSED.

12. Slide canopy (I) against ceiling, and secure with canopy ring (J).

CAUTION: BE SURE NO WIRES ARE PINCHED BETWEEN THE CANOPY AND THE CEILING.

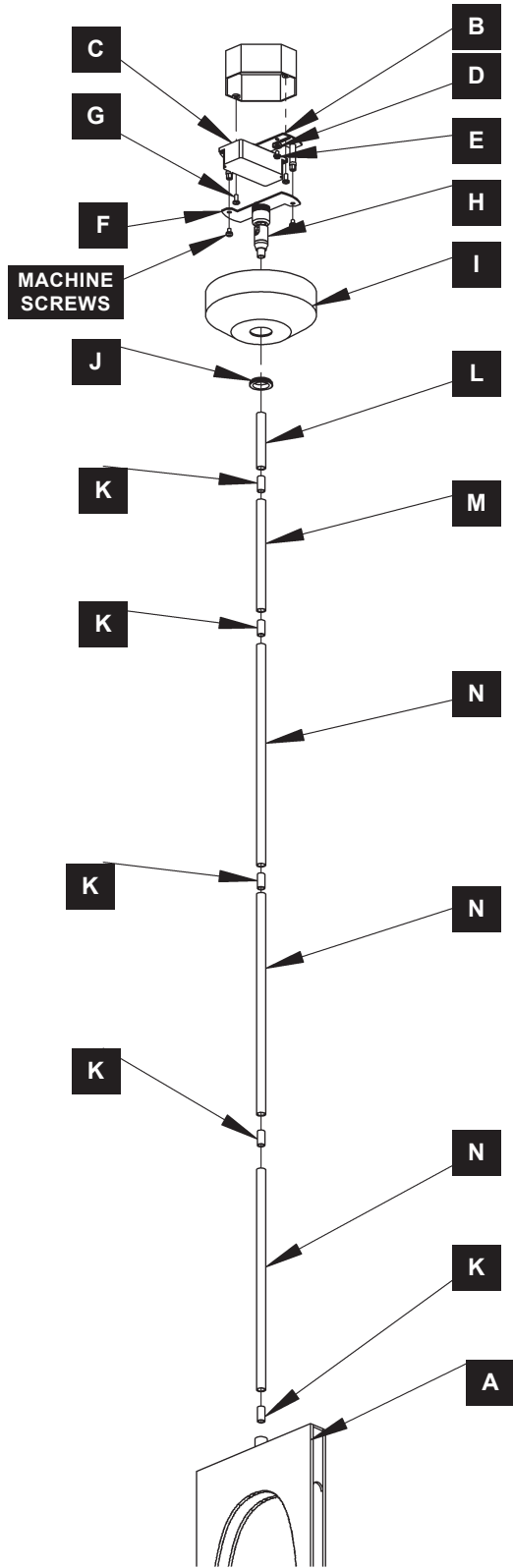

(Figure 1)

Cypress Kitchen Pendant - 181540

Install Glass (Figure 2)

1. Remove flat head screws (Q) from fixture front (R) and fixture back (S).
2. Separate two halves.
3. Place glass (P) into fixture back (S) and place fixture front (R) over the glass (P).
4. Re attach fixture halves together using flat head screws (Q).
5. Restore electricity at main breaker.

CAUTION: FIXTURE MAY BE ROTATED TO DESIRED POSITION. CARE SHOULD BE TAKEN TO NOT ROTATE FIXTURES COUNTER CLOCKWISE. ROTATING FIXTURES COUNTERCLOCKWISE TOO FAR WILL CAUSE THE STEM PIPES TO UNSCREW FROM EACH OTHER.

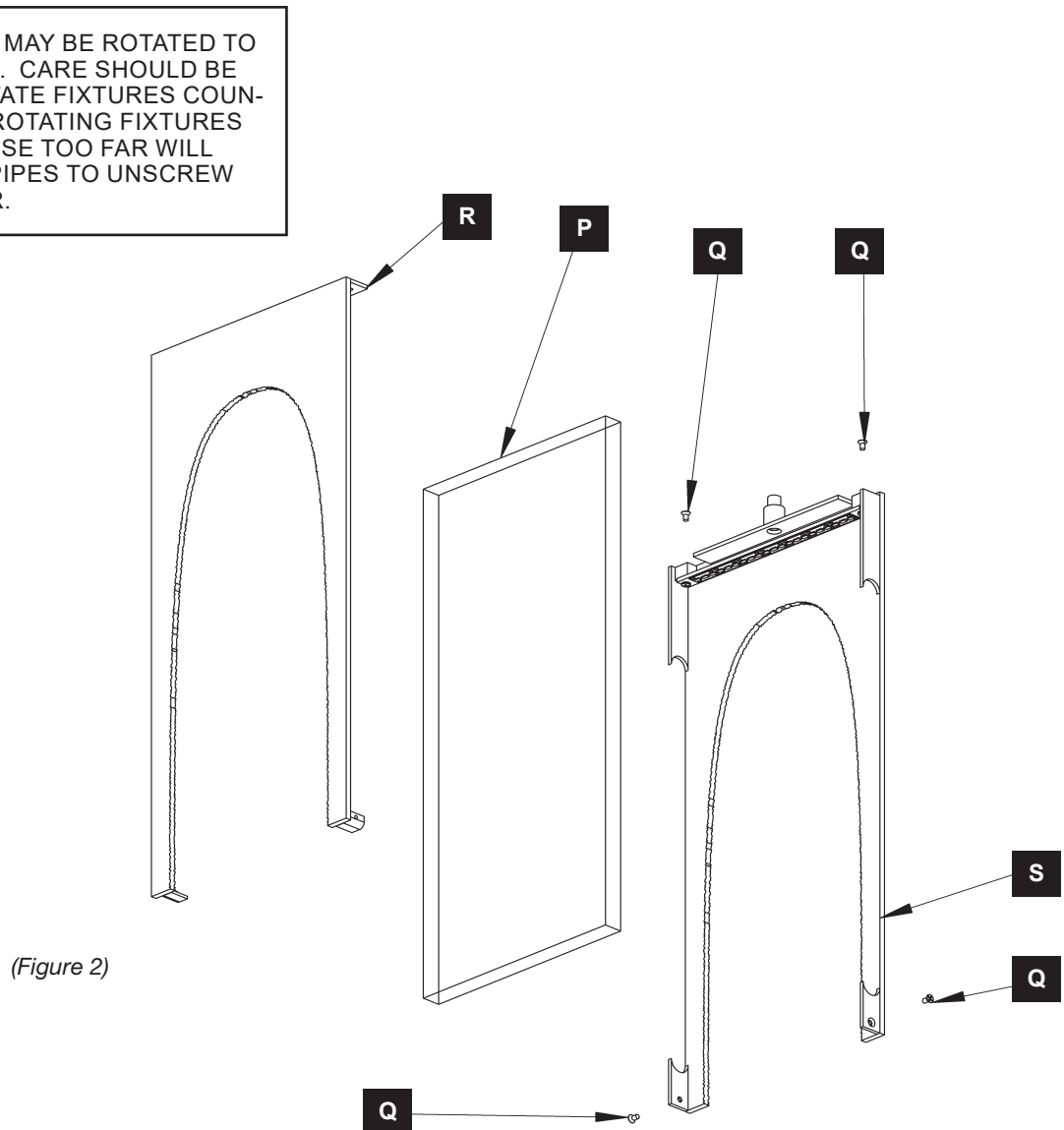

If you need further assistance, or find that you are missing any parts, please contact the dealer from which you purchased this product. We hope you enjoy your fixture!

*** Hubbardton Forge will not be liable for injury or damage caused by improper installation, lamping or use of this fixture.**