



## DMF DU6

MANUALLY OPENED FLAT ROOF WINDOW WITH TRIPLE DU6 GLAZING UNIT

### I. APPLICATION

Plastic window/skylight with the base intended for flat roofs.

Parameter	Value/Type	Marking
Roof angle	2° - 15°	
Roofing base type	membrane, roofing felt paper, green roofs, gravel roofs	-

### IV. TECHNICAL PARAMETERS

Parameter	Unit	Value	Harmonized standard
$U_w$	[W/m²K]	0,70	EN 14351-1:2006+A1:2010
$U_l$	[W/m²K]	0,67	
$\Psi$	[W/mK]	0,055	
$R_w$	[dB]	34 (-1;-4)	
Wind load resistance		Class C5/B5 Class C2/B5*	
Snow load resistance		6H-18-4H-18-44.2 6H-16-4H-18-55.2	
Resistance to fire		B-s2,d0	
Resistance to external fire		B <sub>roof</sub> (t1)	
Watertightness Unshielded (A)		E1200	
Impact resistance		Class 5 – 950 mm	
Load bearing capacity of safety devices		npd**	EN 1279-5 + A2:2010
Air permeability		Class 4	
$U_g$	[W/m²K]	0,5	
$\tau_v$	[%]	54	
g	[%]	43	
Glazing unit***		6 RH - Tg18Ar – 4HT – Tg18Ar - 44.2T 6 RH - Tg16Ar – 4HT – Tg18Ar - 55.2T	

\* for windows wider or longer than 140cm

\*\* no performance determined

\*\*\*depend on window size

### V. DECLARATION OF PERFORMANCE

Harmonized standard for the product	Marking	Declaration of Performance No.
EN 14351-1:2006 +A1:2010	CE	<b>R80/CPR/14351/xx*</b>

\* - declaration's release year, eg. R80/CPR/14351/16 released in 2016

### II. WINDOW SET ELEMENTS

NO.	Element	Quantity	Description
1.	Sash equipped with glazing unit, frame is base of the window	1	DU6 – passive glazing unit with external glass toughened wider around perimeter and safe internal glass laminated.  Multi-chamber PVC profile.
2.	Assembly set	1	
3.	Profiles mounting roofing	4	Profiles mechanically mounting roofing to the frame
4.	Screw servo-motor	1	Maximum sash tilt: 300mm <b>Note:</b> ZSD rod control for opening the window is not included in the window set and must be purchased separately.

### III. SIZES

There are available 11 standard sizes. It is possible to manufacture any size from the range given in the table below.

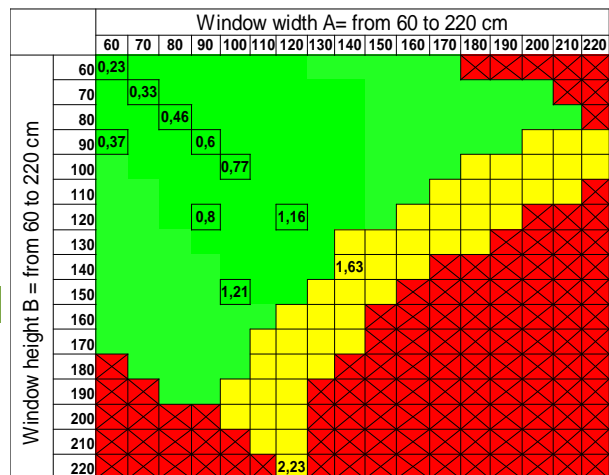

■ size possible to manufacture, one screw servomotor  
■ size possible to manufacture, two screw servomotors  
■ not possible to manufacture  
0,23 effective glazing area, standard size

## VI. ASSEMBLY INFORMATION

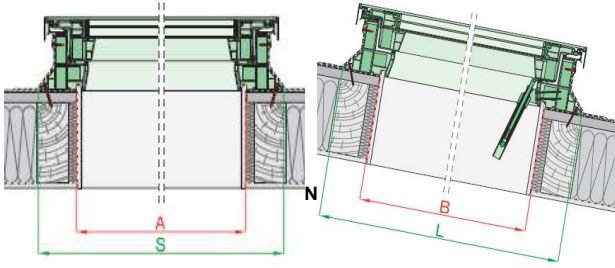

Window commercial size is an opening size in the roof (size A, B). Tolerance of the opening dimensions within +5 cm per side is possible.

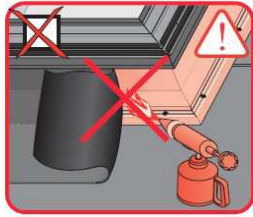
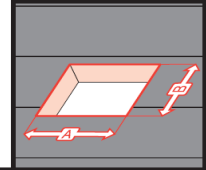

DMF	A	B
[cm]	[cm]	
60x60	60-65	60-65
60x90	60-65	90-95
70x70	70-75	70-75
80x80	80-85	80-85
90x90	90-95	90-95
90x120	90-95	120-125
100x100	100-105	100-105
120x120	120-125	120-125
140x140	140-145	140-145
100x150	100-105	150-155
120x220	120-125	220-225

## VII. DETAILED SIZES

Window size	Size symbol	Frame external size	Distance between lining grooves	Glazing size	Height
		S x L	p x q	j x k	h
[cm]		[mm]			
60 x 60	01K	820 x 820	558 x 558	476 x 476	191
60 x 90	02K	820 x 1120	558 x 858	476 x 776	191
70 x 70	03K	920 x 920	658 x 658	576 x 576	191
80 x 80	04K	1020 x 1020	758 x 758	676 x 676	191
90 x 90	05K	1120 x 1120	858 x 858	776 x 776	191
90 x 120	06K	1120 x 1420	858 x 1158	776 x 1076	191
100 x 100	07K	1220 x 1220	958 x 958	876 x 876	191
120 x 120	08K	1420 x 1420	1158 x 1158	1076 x 1076	191
140 x 140	09K	1620 x 1620	1358 x 1358	1276 x 1276	191
100 x 150	10K	1220 x 1720	958 x 1458	876 x 1376	191
120 x 220	11K	1420 x 2420	1158 x 2158	1076 x 2076	191

