

7 SERVICES

It is imperative that all services are in place prior to laying the Profloor Solo Deck 23 panels. Services cannot be accommodated between Profloor Solo Deck 23 and the sub-floor.

Where access is required to services below the sub-floor, the Profloor Solo Deck 23 panel is cut to suit. Profloor Support Strips are placed around the perimeter of the opening formed and around the hatch. The Profloor Support Strips are positioned to support the main floor panels and the hatch infill panel. See figure 8. A line of acoustic sealant should be caulked onto all the butt joints formed or alternatively, a proprietary support joint can be used.

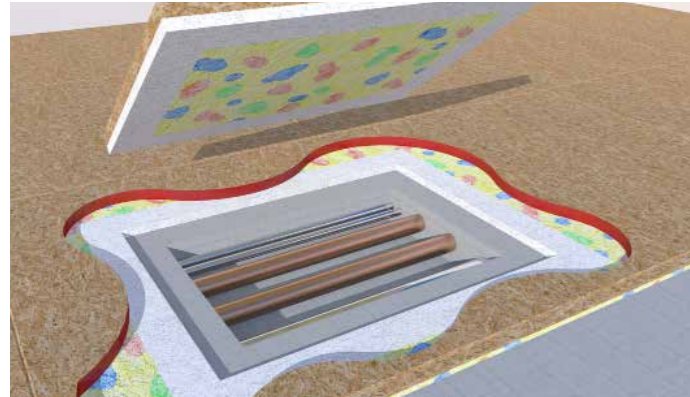

Fig. 8

8 SKIRTING BOARDS

Once the laying of the floor panels is completed, the Profloor Flanking Strip should be folded back onto the surface of the Profloor Solo Deck 23 panels, and weight applied to compress the system (the tradesman's weight is normally sufficient for this). The skirting boards can then be fixed in place to retain the flanking strip between the panel surface and the skirting (see fig 9). The excess flanking strip can then be trimmed off flush with the skirting.



Fig. 9

9 PROTECTION OF FLOORING

To prevent damage from following trades, it is recommended that the finished floor is covered with an appropriate protective layer, such as BSK building paper or polythene, immediately after installation.

Call our Technical Department

The A. Proctor Group has a dedicated Technical Department which can assist with installation details, view drawings for approval and give specialist advice on the correct use of the A. Proctor Group products.

For Technical Advice on installation details and product applications contact the A. Proctor Tecline:

Telephone
01250 872261

Facsimile
01250 872727

Email
contact@proctorgroup.com

For more information contact us:

+44 (0) 1250 872261
www.proctorgroup.com



BEWARE
Packs/Boards exceeds 15Kg

Products **MUST NOT** be stacked
Products must be kept dry **AT ALL TIMES**



Profloor Solo Deck 23

ACOUSTIC SOLUTIONS



CUST

QTY

LOT NO

1 BEFORE YOU START

Estimating Quantities/Required Materials:

- Profloor Solo Deck 23 Panels 2400x600x23 (1.44m²)
- 75x5mm Profloor Flanking Strip (10m Rolls)
- Profloor Adhesive (60lin.m/l Coverage)

Internal Walls

Internal walls and partitions, both load bearing and non-loadbearing, cannot be taken off the finished acoustic floor when using Profloor Deck Systems. All internal partitions should therefore be completed prior to the installation of the Profloor Solo Deck 23 system.

2 PERIMETER SUPPORT & FLANKING ISOLATION

Profloor Solo Deck 23 panels require flanking strip to be installed at all perimeters, this is essential for good acoustic performance. 75x5mm Flanking is recommended for use with Solo Deck 23 panels, supplied with or without double sided tape, and should be fixed to the wall surface prior to the installation of the Solo Deck 23 Panels. See fig. 1.



Fig. 1

3 INSTALLATION OF BOARDS

Commence laying Profloor Solo Deck 23 panels from the corner of the room furthest from the point of access (see step 2). Lay the boards along the full length of wall, with care taken to ensure the exposed edge is aligned to allow a straight joint for the next row of boards.

When laying adjacent rows, board joints should be staggered by a minimum of 400mm, with full uncut boards used wherever possible. Offcut lengths of board may be used at the edges of each row, provided they are not less than 200mm in length and the 400mm stagger is maintained. See fig. 2.



Fig. 2

4 EXPANSION OF FLOORING MATERIALS

Allow for the possible expansion of Profloor Solo Deck 23 panels by leaving a gap between the edge of the panels and the perimeter wall or other abutment. This gap should be 1mm per linear metre run of flooring panels, and should never be less than 10mm. For longer runs such as hallways, intermediate expansion gaps may be required. See fig. 3.

If required, wedges or packing pieces may be used to ensure this gap is maintained, however if used, these MUST be removed prior to the fixing of skirting boards.

The rate of expansion/contraction of the boards will depend on the moisture contents of the boards at time of installation, laying conditions and length of runs. Boards should be conditioned in the environment in which they will be used prior to installation, and it is advisable that installers familiarise themselves with the recommendations of BS8201: Code of Practice for flooring of timber, timber products and wood based panel products.

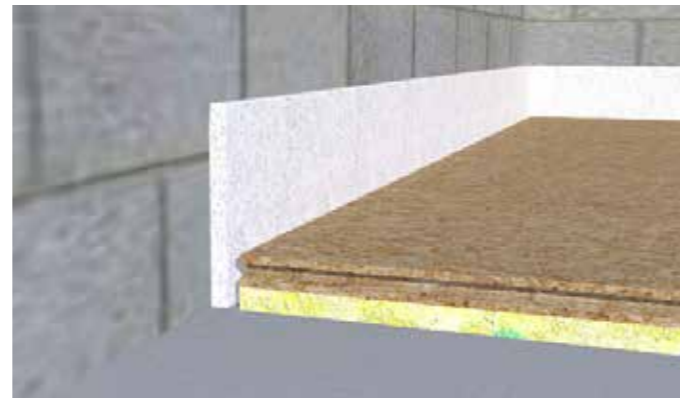

Fig. 3

5 FIXING OF PANELS

Mechanical fixings must not be used to secure Profloor Solo Deck 23 panels to the subfloor, as this will compromise the acoustic performance of the panels.

The tongue and groove edges of the panels should be jointed using a nominal 5mm bead of Profloor Adhesive applied in the groove (coverage approx. 60lin.m/litre). Any surplus adhesive should be immediately removed with a damp cloth. See fig. 4.

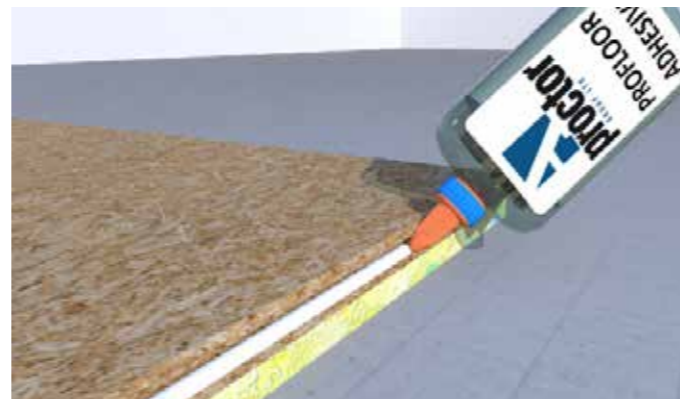

Fig. 4

6 DOORWAYS

It is important that the Profloor Solo Deck 23 panels do not contact any part of the wall structure, including doorframes and similar. Flanking/Support strip should be used at all perimeters to ensure this does not occur.

In a refurbishment situation where door facings are already in position, it may be simpler to cut 31mm off the bottom of the facings prior to installation. This will allow the Profloor Solo Deck 23 panel to slide underneath the existing facing. See fig. 5.

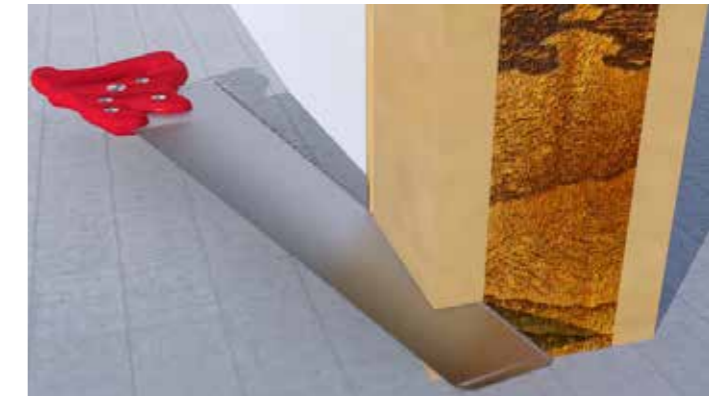

Fig. 5

Where Profloor Solo Deck 23 panels are butted together and no tongue & groove joint is present, for example at internal door thresholds, a run of Profloor Flanking/Support strip must be attached to the edge of each board. Mechanical fixings may be used through the closed cell foam to secure cut edges in doorway, however they should be kept to a minimum. See fig. 6 & 7.

Care must be taken at the design stage to ensure that fire stops are fitted to the same standard as that required for fire doors.

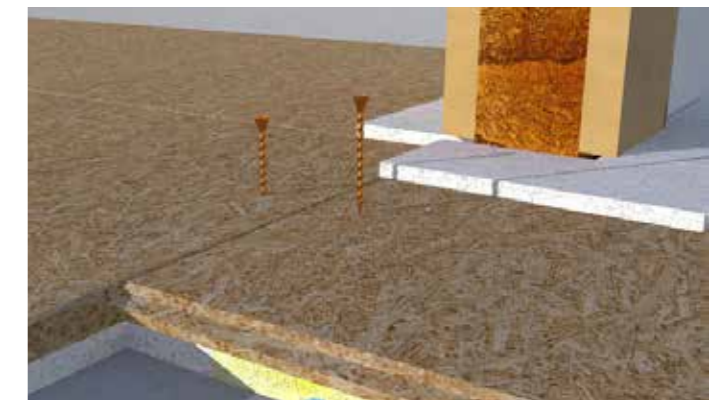

Fig. 6

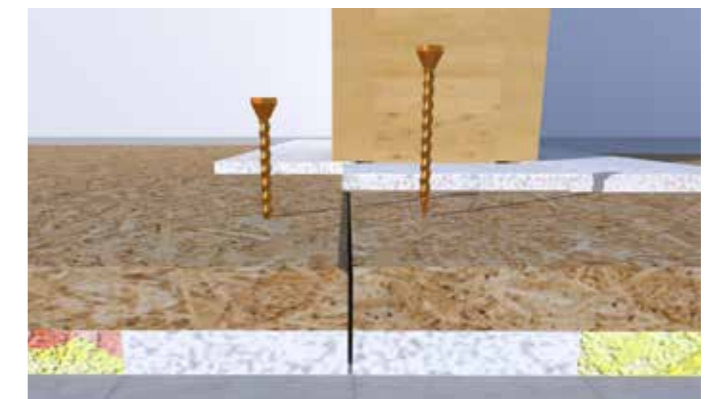

Fig. 7