



FOR WALLS

Eco-Cavity



Partial Fill Cavity Wall Insulation

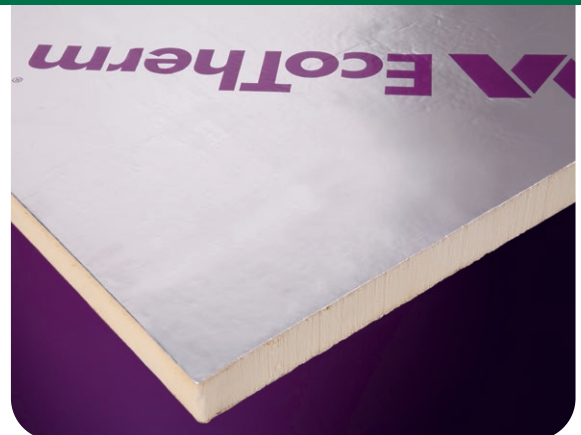

Fibre free rigid polyisocyanurate (PIR) insulation core with aluminium foil composite to both sides





Description

Eco-Cavity comprises a fibre free polyisocyanurate (PIR) insulation core faced with a low emissivity aluminium foil composite on both sides.

Application

Eco-Cavity is a high performance partial fill cavity wall insulation used within traditional masonry constructions. It can achieve high levels of thermal performance whilst maintaining a clear residual air gap, providing effective protection against driving rain, particularly in coastal and exposed locations. It is conveniently sized so that the boards co-ordinate with brick and block dimensions and to allow the insertion of wall ties into the construction at the appropriate spacing.



Product properties

DIMENSIONS

Eco-Cavity is available in the following standard sizes:

Width: 450 mm

Length: 1200 mm

Thickness: 40 mm - 100 mm

Weight: See Table 1 for board weights

STANDARDS AND APPROVALS

Eco-Cavity (in thicknesses of 25 to 100 mm), produced at the Pembridge (Herefordshire) and Selby (North Yorkshire) manufacturing facilities, is covered by BBA Agrément Certificate No 14/5157.



The NHBC accepts the use of EcoTherm Eco-Cavity in relation to relevant clauses in NHBC standards.

EcoTherm PIR Insulation is manufactured under a management system certified to ISO 9001: 2015 (Quality Management Systems. Requirements), ISO 14001: 2015 (Environmental Management Systems. Requirements), ISO 45001: 2018 (Occupational Health and Safety Management Systems. Requirements with guidance for use) and ISO 50001: 2018 (Energy Management Systems. Requirements with guidance for use).

All certificates are available for download from www.ecotherm.co.uk.

THERMAL PERFORMANCE

The low emissivity surface of the reflective foil can help improve U-values in certain constructions when reflecting into a cavity.

Eco-Cavity has a thermal conductivity (λ -value) of 0.022 W/mK. The thermal resistance (R-value) of Eco-Cavity varies with thickness (see Table 1).

EcoTherm PIR insulation λ and thermal resistance values stated in this datasheet are in accordance with BS EN 13165: 2012 + A2: 2016 (Thermal insulation products for buildings. Factory made rigid polyurethane foam (PU) products. Specification).

FIRE PERFORMANCE

There are potential restrictions placed upon this product which vary dependant on building type, height, construction and location in Great Britain. For guidance regarding the routes to compliance for meeting fire safety requirements please refer to the relevant Building Regulations/Standards for England, Wales and Scotland.

Under System 4 AVCP, Eco-Cavity has a Euroclass rating of F.

Further details on the fire performance may be obtained from EcoTherm Technical Services.

COMPRESSIVE STRENGTH

The compressive strength of Eco-Cavity typically exceeds 140 kPa when tested at 10% compression to BS EN 826: 2013 (Thermal insulating products for building applications. Determination of compressive behaviour).

DURABILITY

When correctly installed, Eco-Cavity can have an indefinite life. Its durability depends on the background/supporting structure and conditions of its use. It should not be used to isolate dampness or be used in continuously damp/humid conditions.

RESISTANCE TO SOLVENTS, FUNGI & RODENTS

Eco-Cavity resists attack from dilute alkalis and acids, mineral oil and petrol however it is not resistant to ketonic solvents. The insulation core and facings of Eco-Cavity resist attack from mould and microbial growth and do not provide any food value to vermin. Damaged boards should not be used.

The use of EcoTherm Eco-Liner (insulated plasterboard) on an internal wall should be considered to achieve improved target U-values in a wall construction. Alternatively EcoTherm Eco-Cavity Full Fill can be used solely to achieve a U-value as low as 0.13 W/mK.





Design considerations

ENVIRONMENTAL

An Environmental Product Declaration (EPD), certified to BS EN 15804:2012+A2:2019 (Sustainability of construction works. Environmental product declarations. Core rules for the product category of construction products), has been created for Eco-Cavity produced at the Basildon (Essex), Pembridge (Herefordshire) and Selby (North Yorkshire) manufacturing facilities. Please visit the Eco-Cavity web page at www.ecotherm.co.uk for more information.

The core of Eco-Cavity is manufactured with a blowing agent that is CFC/HCFC free and has zero Ozone Depletion Potential (ODP) and a low Global Warming Potential (GWP).

EcoTherm Insulation is manufactured under a management system certified to ISO 14001: 2015.

MOISTURE TOLERANCE

When the product is used in situations where it bridges the Damp Proof Course (DPC) in walls, dampness from the ground will not pass through to the inner leaf provided the cavity wall is detailed in accordance with Building Regulations/ Standards.

TYPICAL U-VALUES

Eco-Cavity achieves typical U-values as shown in Table 1.

Project specific U-value and Condensation Risk Analysis (CRA) calculations are available from EcoTherm Technical Services on request (see rear cover for details).

For instant U-value calculations 24/7 visit EcoTherm's online U-value calculator at www.ecotherm.co.uk

DESIGN STANDARDS

Wall ties should have a retaining clip/disc for securing the insulant to the masonry plane. Ideally they should be BBA/NSAI approved and conform to BS EN 845-1: 2013 + A1: 2016 (Specification for ancillary components of masonry. Wall ties, tension straps, hangers and brackets), BS EN 1996-1-1: 2005 + A1: 2012 (Eurocode 6. Design of masonry structures. General rules for reinforced and unreinforced masonry structures), BS EN 1996-2: 2006 (Eurocode 6. Design of masonry structures. Design considerations, selection of materials and execution of masonry), BS EN 1996-3: 2006 (Eurocode 6. Design of masonry structures. Simplified calculation methods for unreinforced masonry structures) and PD 6697: 2019 (Recommendations for the design of masonry structures to BS EN 1996-1-1 and BS EN 1996-2) should be consulted regarding the construction of insulated cavity walls.

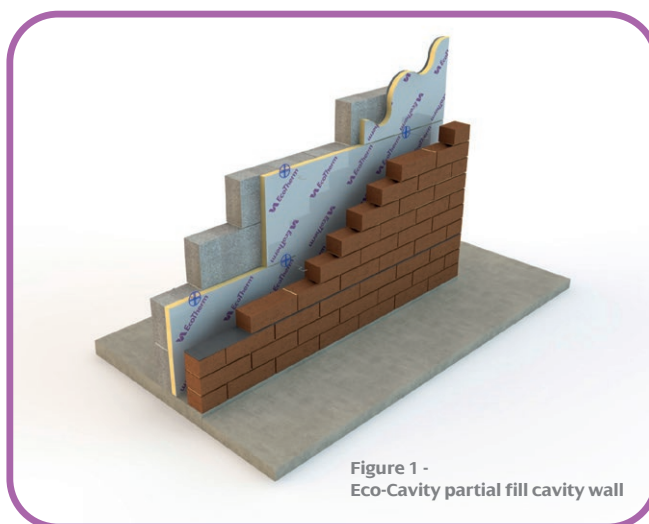

Figure 1 - Eco-Cavity partial fill cavity wall

Table 1 Typical weights, thermal resistances and U-values for Eco-Cavity

Thickness (mm)	Weight per board (kg)	Thermal resistance / R-value (m ² K/W)*	Typical U-value brick & dense block (W/m ² K)	Typical U-value brick & medium block (W/m ² K)	Typical U-value brick & light block (W/m ² K)	Typical U-value light block & dense block (W/m ² K)
40	0.9	1.81	0.32	0.31	0.29	0.27
50	1.1	2.27	0.28	0.27	0.25	0.24
60	1.2	2.72	0.25	0.24	0.23	0.21
65	1.3	2.95	0.24	0.23	0.22	0.20
70	1.4	3.18	0.22	0.22	0.21	0.19
75	1.5	3.40	0.21	0.21	0.20	0.19
80	1.6	3.63	0.20	0.20	0.19	0.18
90	1.7	4.09	0.19	0.18	0.17	0.17
100	1.9	4.54	0.17	0.17	0.16	0.15

Calculations are based on a 50 mm residual cavity. Adjustments for fixings to be included once fixing centres / type have been confirmed.

When calculating U-values to BS EN ISO 6946: 2017, the type of wall tie used may change the thickness of insulation required. For cavity widths ≤125 mm, calculations assume a stainless steel flexible tie with 2.5 ties per m² and a cross-sectional area of 12.50 mm². For cavity widths >125 mm, calculations assume a stainless steel flexible tie with 2.5 ties per m² and a cross-sectional area of 23.4 mm².

* This sum is rounded down to the nearest 0.01 m²K/W.

The calculations are based on the following block lambda:

Dense block 1.13W/mK | Medium block 0.51W/mK | Lightweight block 0.19W/mK

For alternative wall constructions/applications please contact EcoTherm Technical Services (see rear cover for details) to obtain a U-value calculation or head to www.ecotherm.co.uk to use EcoTherm's online U-value calculator.



FOR WALLS

Eco-Cavity

FOR FREE TECHNICAL ADVICE

Call: 01268 597 213

Email: technical@ecotherm.co.uk

INSTALLATION ESSENTIALS

- All boards should be fitted or butted together with vertical joints staggered.
- Excess mortar should be cleaned from the cavity face of the internal wall leaf before the installation of the each run of Eco-Cavity boards.
- EcoTherm Insulation recommend the use of insulated cavity closers at door and window openings.
- The boards can be cut to fit openings, (i.e. around windows, doors and airbricks). To ensure a continuous layer of insulation is maintained, it is essential to cut boards accurately and that cut pieces completely fill the spaces and are adequately secured.
- Where openings such as doors and windows are in close proximity, it is recommended that a continuous lintel and/or cavity tray is used. Individual lintels or cavity trays should have stop ends and be adequately drained.
- At gable walls Eco-Cavity should be continued no less than 200 mm beyond the top storey ceiling and a cavity tray installed to protect the top of the Eco-Cavity boards.
- Exposed areas of board should always be covered at the end of a day's work or in driving rain.

WALL TIES

- Seek advice from a wall tie manufacturer for the most suitable tie for the construction.
- Wall ties should include a retaining clip or disc to ensure insulation boards are held in place against the internal wall leaf. It is essential that all wall ties slope downwards towards the external wall leaf.
- Please note: when calculating U-values to BS EN ISO 6946: 2017 (Building components and building elements. Thermal resistance and thermal transmittance. Calculation methods), the type of wall tie used may change the thickness of insulation required.

For cavity widths ≤ 125 mm, calculations assume a stainless steel flexible tie with 2.5 ties per m^2 and a cross-sectional area of 12.50 mm^2 . For cavity widths >125 mm, calculations assume a stainless steel tie with a 2.5 ties per m^2 and a cross-sectional areas of 23.04 mm^2 .

INSTALLATION DETAILS

- For buildings up to 12 m high, a minimum clear cavity width of 25 mm free from all obstructions may be acceptable subject to exposure.
- A minimum clear cavity width of 50 mm free from all obstructions is recommended for all heights greater than 12 m high. The NHBC accepts the use of Eco-Cavity with 50 mm clear cavity, provided it is installed, used and maintained in accordance with the BBA certificate.
- Install the first row of wall ties at 600 mm horizontal centres (2 per board) at a minimum of one course of blockwork below the Damp Proof Course (DPC). Wall ties should not be placed directly on the DPC. The insulation boards should commence at least 150 mm below the DPC to provide edge insulation for the floor, but not be in contact with the ground.
- Construct the internal wall leaf up to 450 mm (2 block courses) and install wall ties at 900 mm horizontal centres.
- Install the first row of Eco-Cavity boards between the 2 rows of wall ties, and secure in place with a retaining clip/disc on each tie.
- Each board should be secured at a minimum of three points. Additional ties may also be required to satisfy the structural requirements of BS EN 845-1: 2013 + A1: 2016, BS EN 1996-1-1: 2005 + A1: 2012, BS EN 1996-2: 2006, BS EN 1996-3: 2006, PD 6697: 2019 and/or to ensure adequate retention of boards or cut pieces.
- Construct the external wall leaf to meet the top of the Eco-Cavity boards and repeat the process up to the required height (wall ties spaced at 450 mm vertical centres and 900 mm horizontal centres).



Sitework

HANDLING

- Do not drop boards
- To cut use a fine toothed saw
- Wear appropriate hand and eye protection
- Damaged boards should not be used

Cutting with power tools generates dust so should be kept to a minimum. Ideally all operations which produce dust should be carried out in well ventilated conditions; where possible a dust mask selected in accordance with BS EN 149: 2001 + A1: 2009 (Respiratory protective devices. Filtering half masks to protect against particles. Requirements, testing, marking) should be worn. Ensure accurate trimming to achieve close butt joints and continuity of insulation.

HEALTH & SAFETY

Eco-Cavity is chemically inert and safe to use. Product safety information is available to download from www.ecotherm.co.uk

STORAGE

Store boards in a flat, dry area off the ground away from mechanical and water damage and sources of ignition. If temporary outdoor storage cannot be avoided then they must be completely protected by use of an opaque polythene sheet or tarpaulin.

Boards that have been allowed to get wet should not be used.

EcoTherm Insulation (UK) Ltd

Harvey Road, Burnt Mills Ind. Est., Basildon, Essex, SS13 1QJ

tel: +44 (0) 1268 591155 fax: +44 (0) 1268 591852

www.ecotherm.co.uk email: info@ecotherm.co.uk

EcoTherm Insulation (UK) Ltd is registered in England No. 1873816

® EcoTherm is a Registered Trademark in the UK. All rights reserved.

To check that you have the latest version of this brochure please visit www.ecotherm.co.uk/downloads.

To access pre-existing product information or information relating to previously sold/discontinued products please email marketing@ecotherm.co.uk.