

12 MONTHS / 3,600 LITRES FILTER REPLACEMENT

For optimum performance, it is recommended to replace the filter once every 12 months / 3,600* litres of water from initial usage.

*Based on average ten (10) litres a day usage.

• It is strongly recommended to replace the filter according to its recommended usage for hygiene purposes & optimum performance.



STEP 01

An alarm will be triggered from the filter replacement timer when filters are due for replacement after twelve (12) months of usage. Press **OFF** button on the filter replacement timer once to stop the alarm.

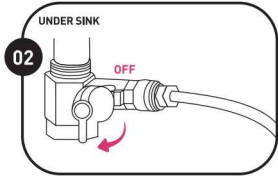

STEP 02

Proceed to switch OFF the main water supply.



STEP 03

Grab the individual filter cartridge and twist it in an anticlockwise direction to remove it one by one, starting from HydroPlus® or HydroPure™ Filter. Drain and dispose the exhausted filter.

• Fine particle of carbon dust may remain at the interior of the filter head cavity and this is normal.

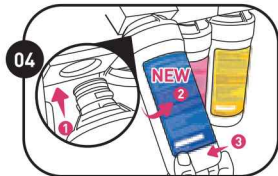

STEP 04

Insert the new individual filter cartridge into its respective filter head cavity and twist them in clockwise direction to tighten it snugly.

- Ensure both coloured labels on the filter cartridge and filter head connectors are matched.
- Ensure the individual filter cartridge is properly assembled and installed in position before usage.
- Microfiber cloth is available inside the filter replacement pack to dry any water spillage during filter replacement.

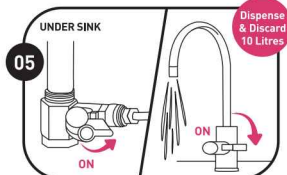

STEP 05

Switch ON main water supply and it is recommended to control the water inflow rate to be at about 2.5 Litres/min. For optimum water purification results, it is recommended to rinse through the brand-new filters before usage. Turn ON the drinking faucet to dispense and discard first ten (10) litres of water and check and feel for any visible leakage.

• For initial usage, fine particle of carbon dust may remain in water. This is normal and harmless.



STEP 06

Press and hold **OFF** button on the filter replacement timer for three (3) seconds to start filter timer. Proceed to paste the filter replacement timer at a visible and accessible area. The under sink drinking water filtration system is now ready for usage.

- An alarm will be trigger when filter is due for replacement.
- In the event filter replacement timer master reset is required, please press and hold **OFF** button for eight (8) seconds.

• All Information is accurate at the point of print. novita reserves all rights to update the information without prior notice.