

User Manual

- 1.- Introduction
- 2.- Charge your wireless card reader.
- 3.- Install App of wireless card reader into your ipad/iphone/ipod Touch/Android phone.
- 4.- Open/close your wireless card reader.
- 5.- Connect your wireless card reader to ipad/iphone/ipod Touch/Android phone.
- 6.- Wireless card reader use instruction
- 7.- Set the SSID and code of wireless card reader
- 8.- Download files from wireless card reader
- 9.- Upload file to wireless card reader
- 10.- Preview file in wireless card reader
- 11.- Factory reset
- 12.- Open files in other App in the way of "Open in"

1.0- Introduction

<Items attached in package>

- One wireless card reader (host)
- One USB charging line
- One User Manual

<Factory set>

SSID: WiFi Storage*****

Code: 88888888

Note: Factory has set a separated SSID for each wireless card reader and you can also reset SSID and code (please refer to Item 7)

Device

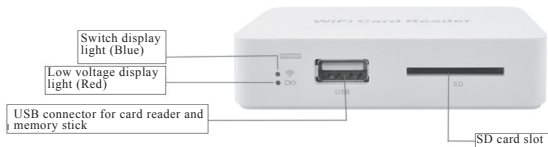
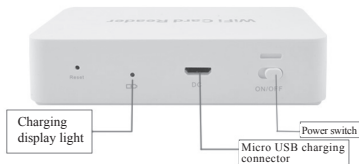

Device specification

Device size: length83MM*width50MM*thickness19.5MM

Capacity: 1,200mAh

Charging current: 800mAh

Input voltage: 5V

Transfer speed: 150Mbps

Transfer distance: 30M

Micro power supply connector

2.0- Charge Wireless Card Reader

Charge your wireless card reader for 4 hours before first time use and 2 hours for later use in the condition of close.

Connect wireless card reader to computer USB connector or USB charge refer to following picture



The display shows red light when charging. It shows blue light when it is in full charge. When the low power shows red light, it means the wireless card reader is in low power and need charging immediately.

3.0-Install App of Wireless Card Reader into Your Ipad/Iphone/Ipod Touch/Android Phone

Please search “Wi-Fi media reader” in Apple App Store and install it into ipad/iphone/ipod Touch



WiFi media reader

4.0- Open/Close Wireless Card Reader

Switch display light

Keep lighting	Open WIFI
Fast flashing	In the data transmission
Normal flashing	WIFI is ready, ipad/iphone/ipod Touch has been connected
Slow flashing	WIFI is ready, ipad/iphone/ipod Touch has not been connected
Close	Close or low power

5.0- Connect Your Wireless Card Reader to Ipad/Iphone/Ipod Touch/Android Phone



Open setting. Start your wireless card reader and please wait for 30 second when indicator turns blue now the wireless card reader is opening. Wireless card reader is ready when indicator turns normal flashing. Open your WIFI in iphone/ipad and input code: 88888888 in your wireless card reader SSID

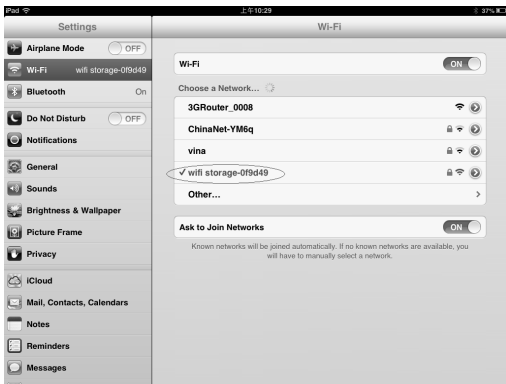

6.0- Wireless Card Reader Instruction

Wireless card reader App will not be updated regularly therefore using method may have a few changes.

1.Interface

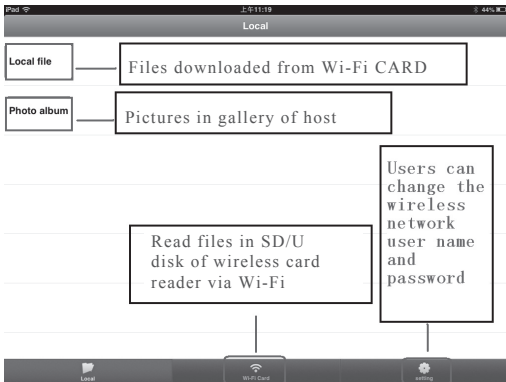

2. Preview

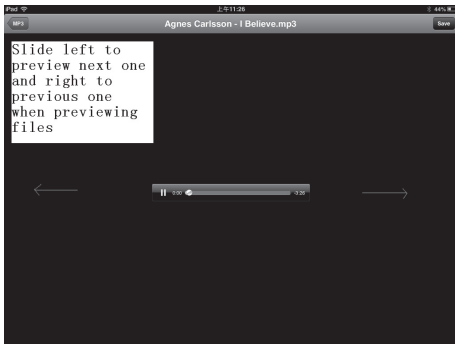

3. Download

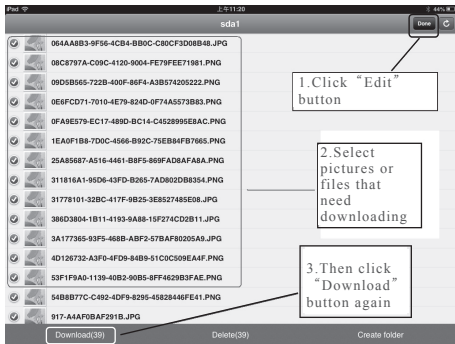

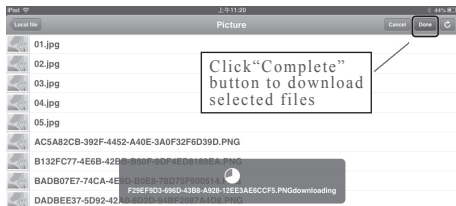
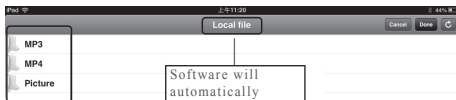

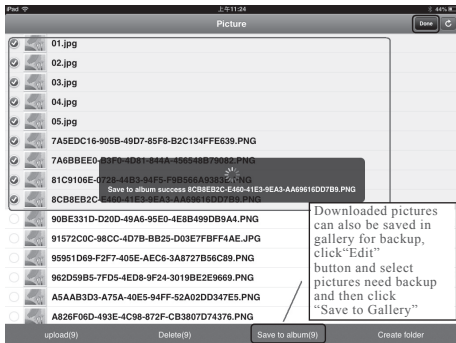
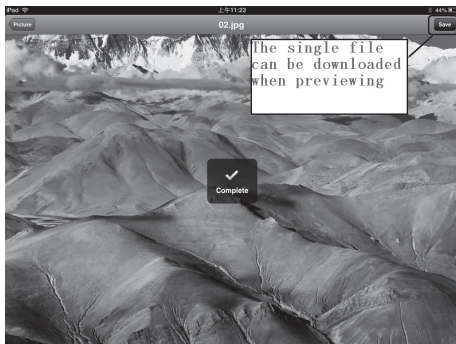

4.Upload

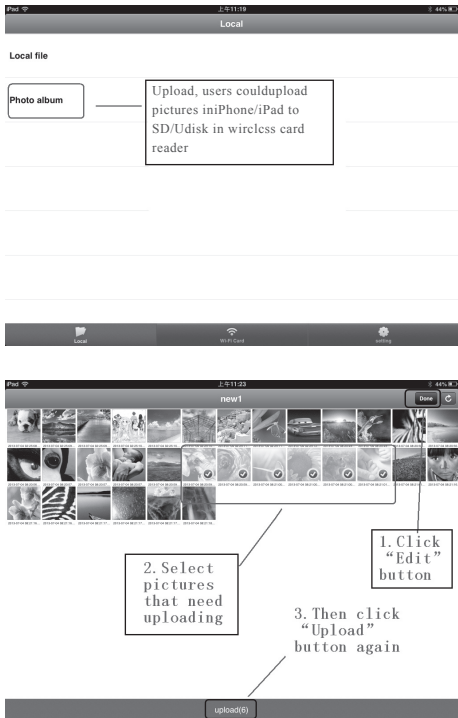

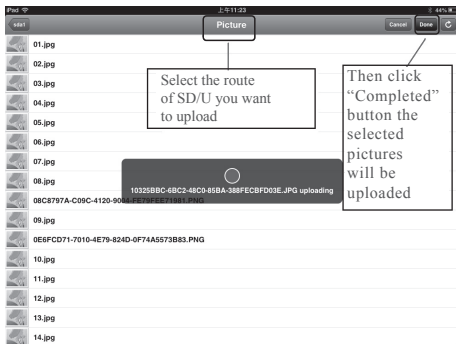

5.Set SSID and Code of Wireless Card Reader



Wireless Security Setting

SSID:

New Password:

Re-confirm password:

Users can customize the name and password of network. Restart the hardware after setting.



6. "Open in" Pattern

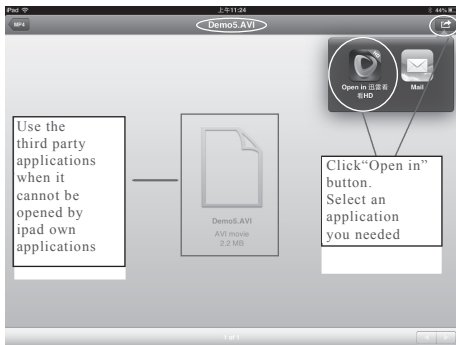

Restore Factory Reset

Users need to use needle to press the “Reset” button and wait for 30 seconds when the power is on if factory reset is needed. If the reset is succeeded, the power indicator will be on 8 seconds and then slow flashing.