

# How to Create PlanetBox Custom Magnets

## Custom Magnet Tips:

### Acceptable Images:

We suggest trying to use pictures you have taken with your camera or phone, family photos, and your child's artwork.

---

### Rotating Images:

After uploading an image, you can rotate the image with the icon on the popup.

---

### Image Size:

Images must be no larger than 4096 pixels on a side, due to memory constraints of web browsers.

---

The images you use to create your custom magnets must be your own, and not infringe on any intellectual or proprietary rights. Your images must not be profane, abusive, vulgar or otherwise objectionable.

### Warning:

We are only allowed to print images that you have ownership to – nothing that is trademarked or copyrighted. PlanetBox does not have the rights to reproduce trademarked names or images. We review each magnet set and we are not able to print trademarked material as it is illegal. If we find that the images you have chosen contain illegal material, we will have to cancel your order.

# Step 1: Select your lunchbox

Click on the Lunchbox you would like to create magnets for

PLANETBOX®

Lunchboxes Accessories Kits PlanetBox

CUSTOM MAGNETS

Choose your PlanetBox to begin:

Create Rover Magnets

Create Launch Magnets

Create Shuttle Magnets

Already created a design?

ENTER CODE

QTY - 1 + Add to Cart

+ Video

+ Details

+ Care and Use

+ Reviews

ROVER LAUNCH SHUTTLE BPA FREE CERTIFIED NON-TOXIC 1 YEAR WARRANTY

A pop up will appear for you to create your custom magnets

MAGNET COLOR

Text Photo Done

PLANETBOX®

Please Note: The PlanetBox logo and little planets are already printed on the blank magnets

## Step 2: Select a Background Color

Click **Magnet Color** to select a background color for your magnets.

Click on the color you would like.

If you want a darker color, Click and Slide the arrow down to make the color darker.

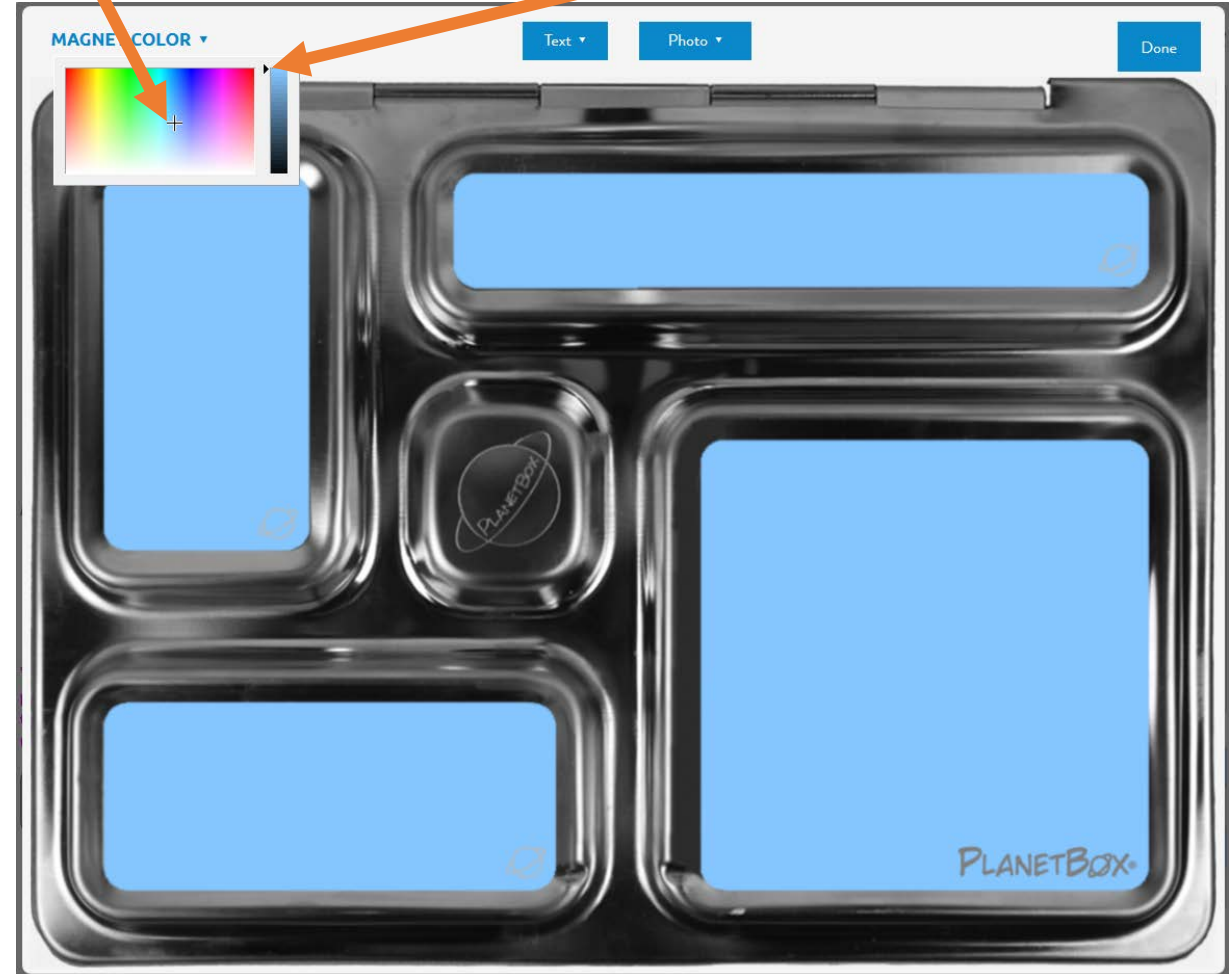
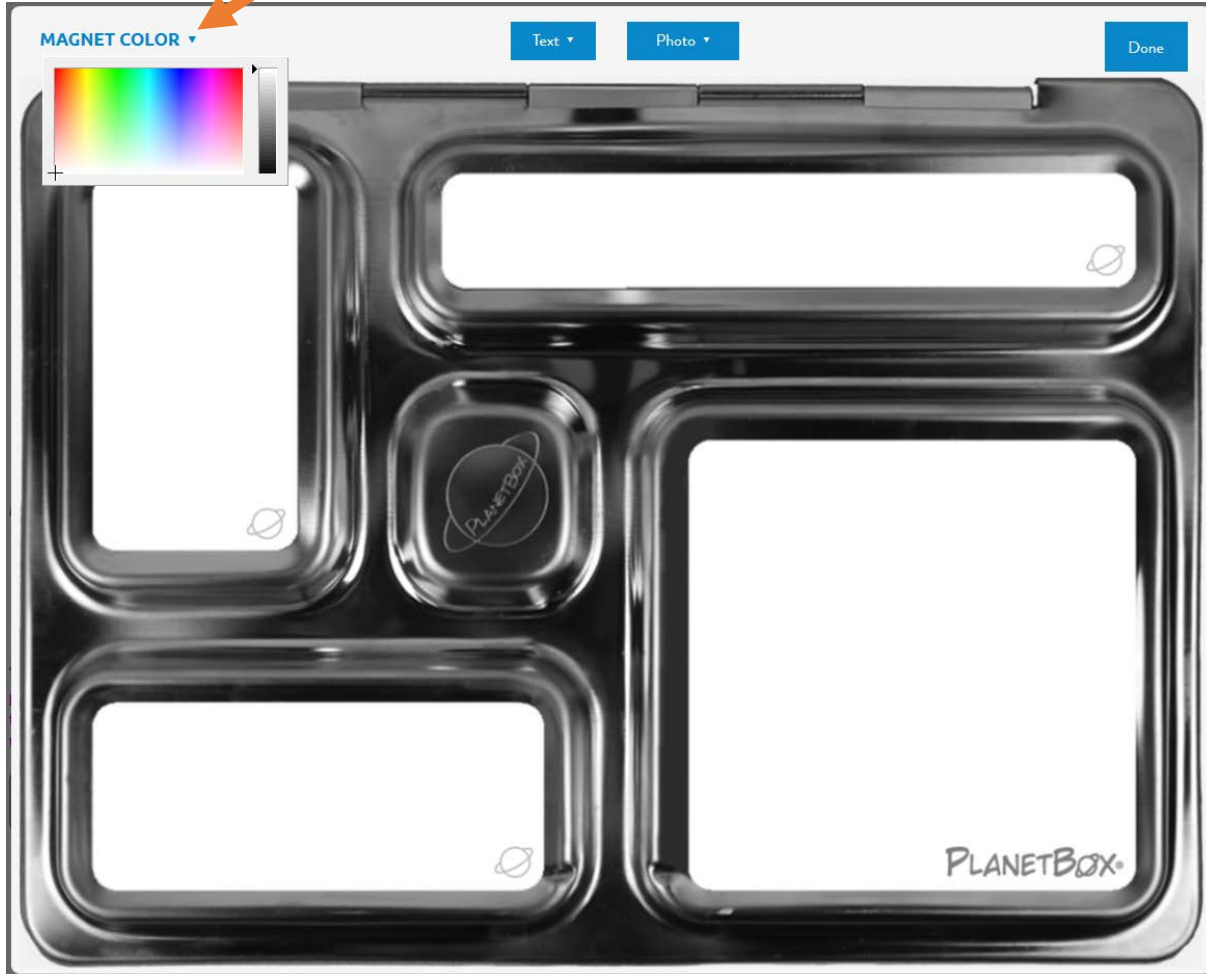

Click on a magnet when you are done choosing a color.

# Step 3: Add Text

Click **Text** to type in your desired text.  
Click **Add** when you are finished.

Click and drag the blue flashing arrows to move your text to the desired location.

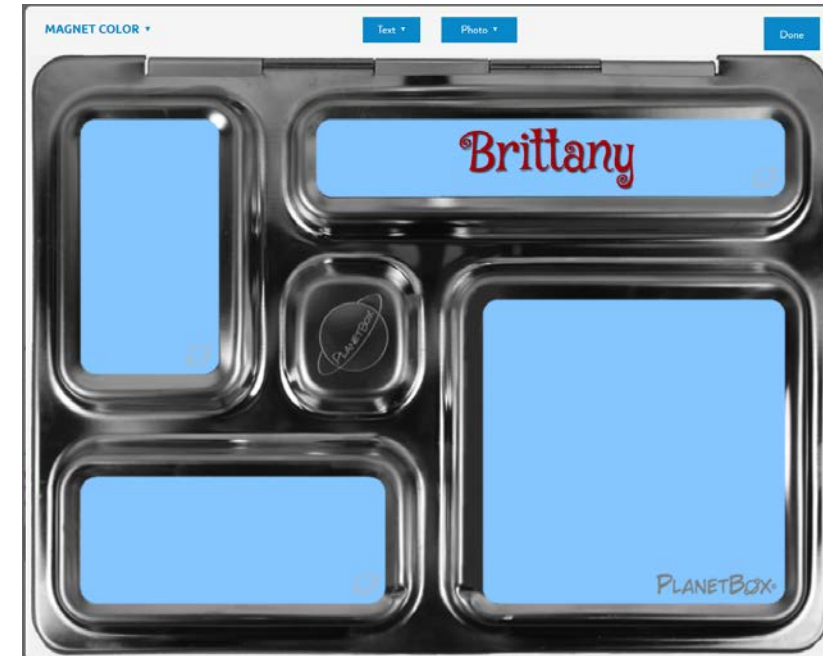
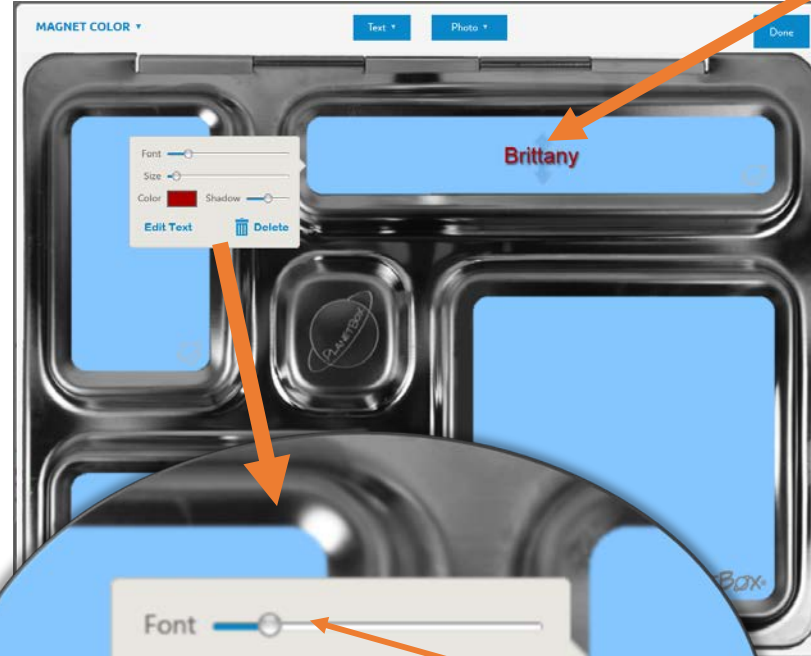
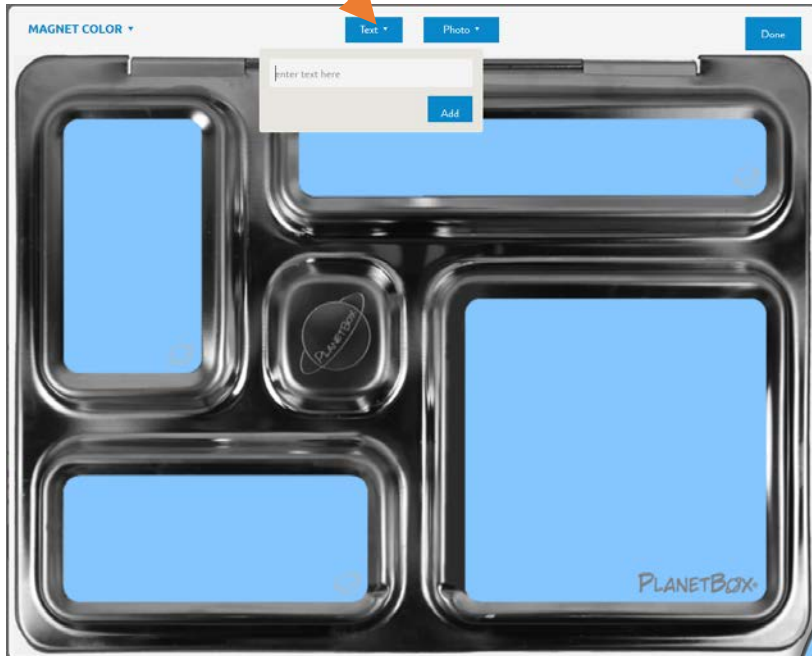

Click on the box of color to change the text color.

Use the sliders to change the text Font, Size and Shadow

Click away from the text when you are done editing it.

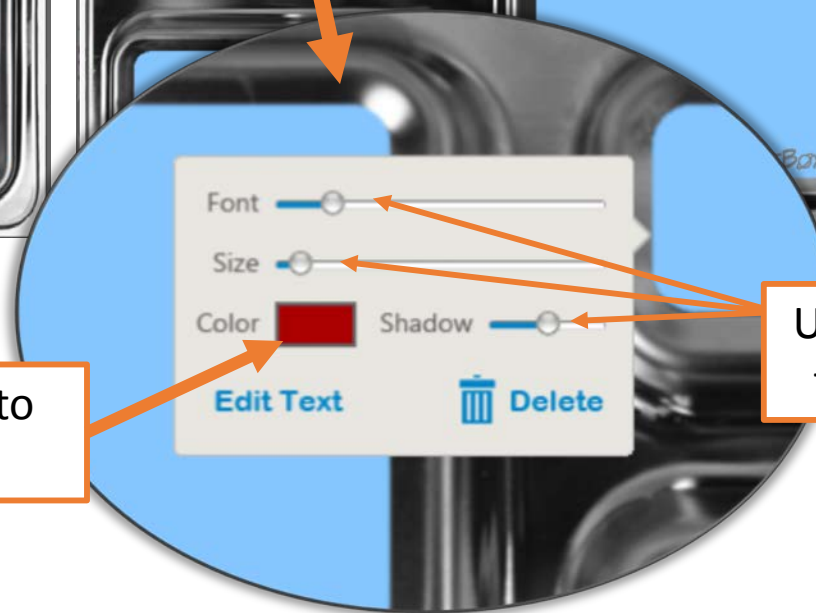

# Step 4: Add Pictures

Click **Photo**.  
Drag and Drop photos OR click  
**Choose Photo...**

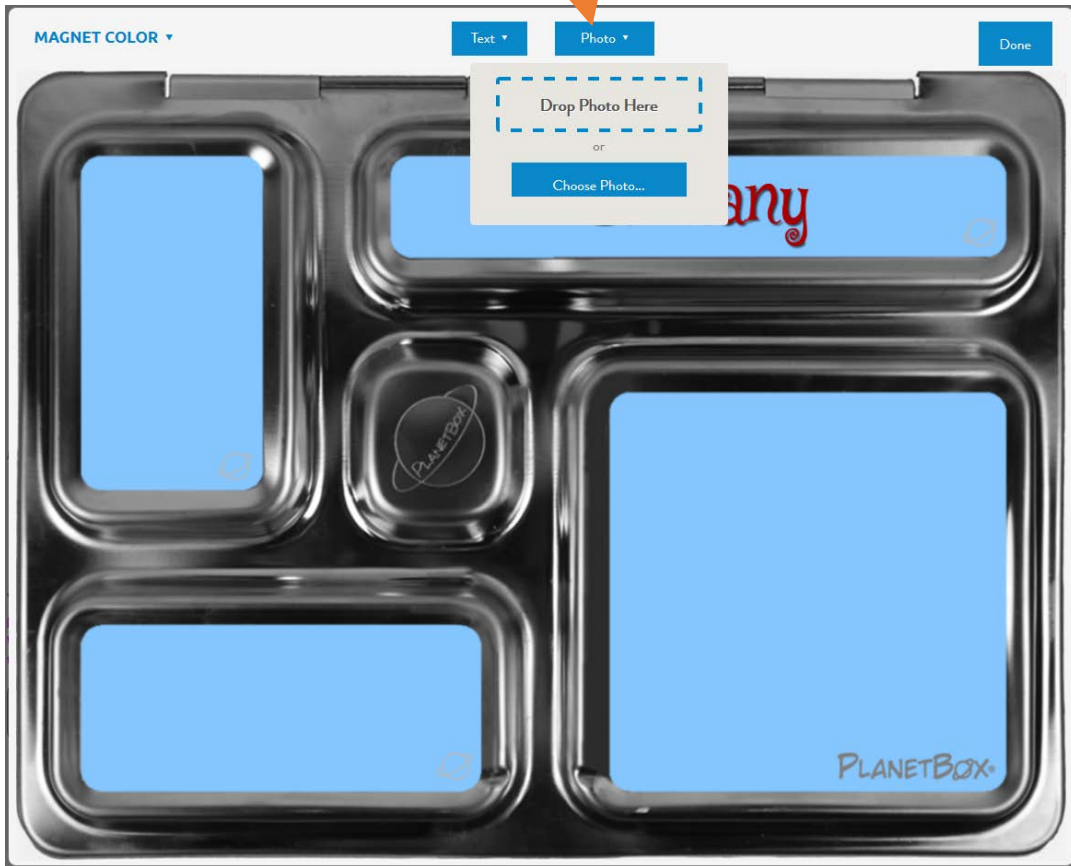

If you click **Choose Photo...** then a pop-up will appear. Locate your images on your computer, Select one and then click Open.



# How to Move Pictures to a Different Magnet

To move the picture to a different magnet  
Click and Drag the blue flashing arrows.

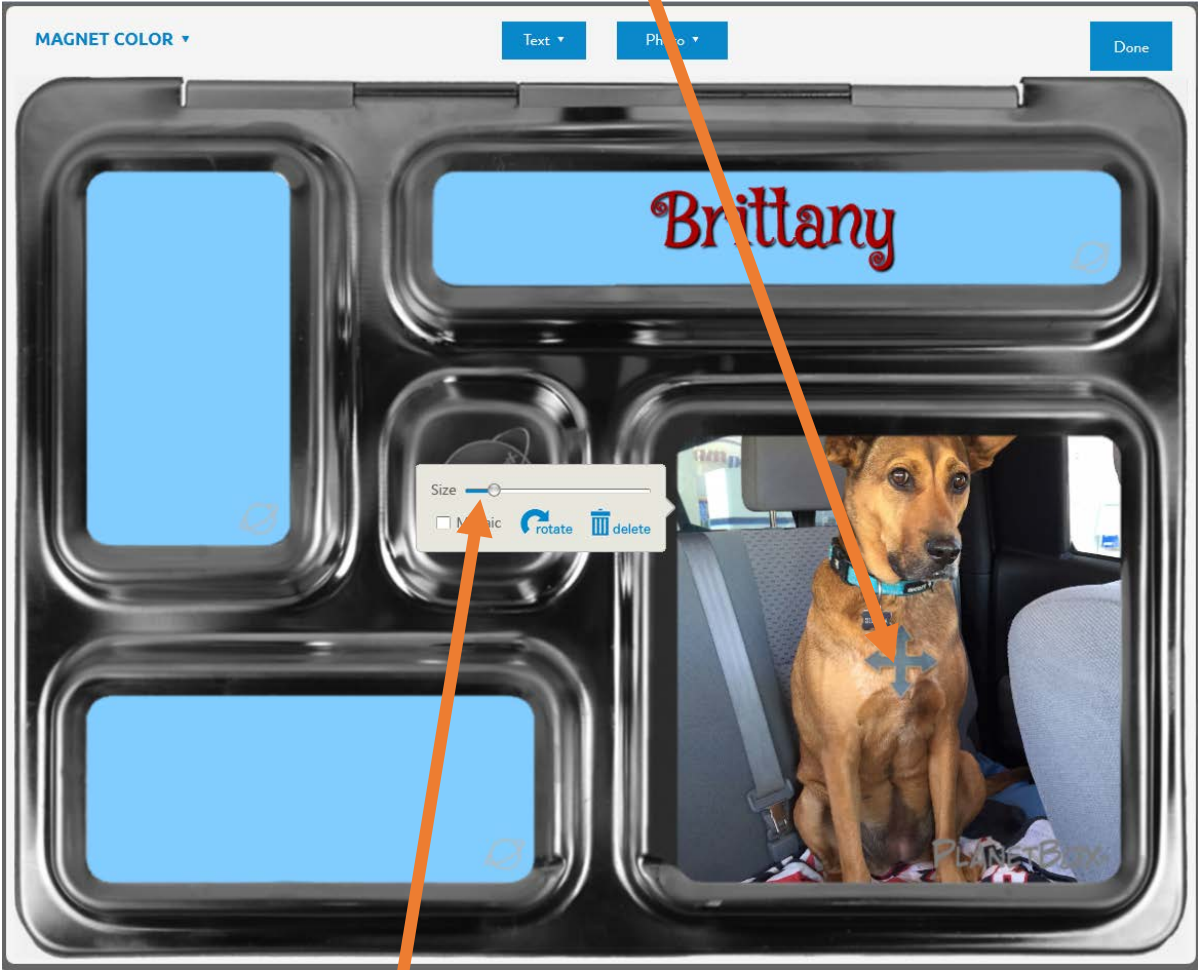

Use the Size slider to change the size of the image if desired.

# Adding More Images

Follow the previous steps to add another image.  
The uploaded picture will automatically go to the bottom magnet.

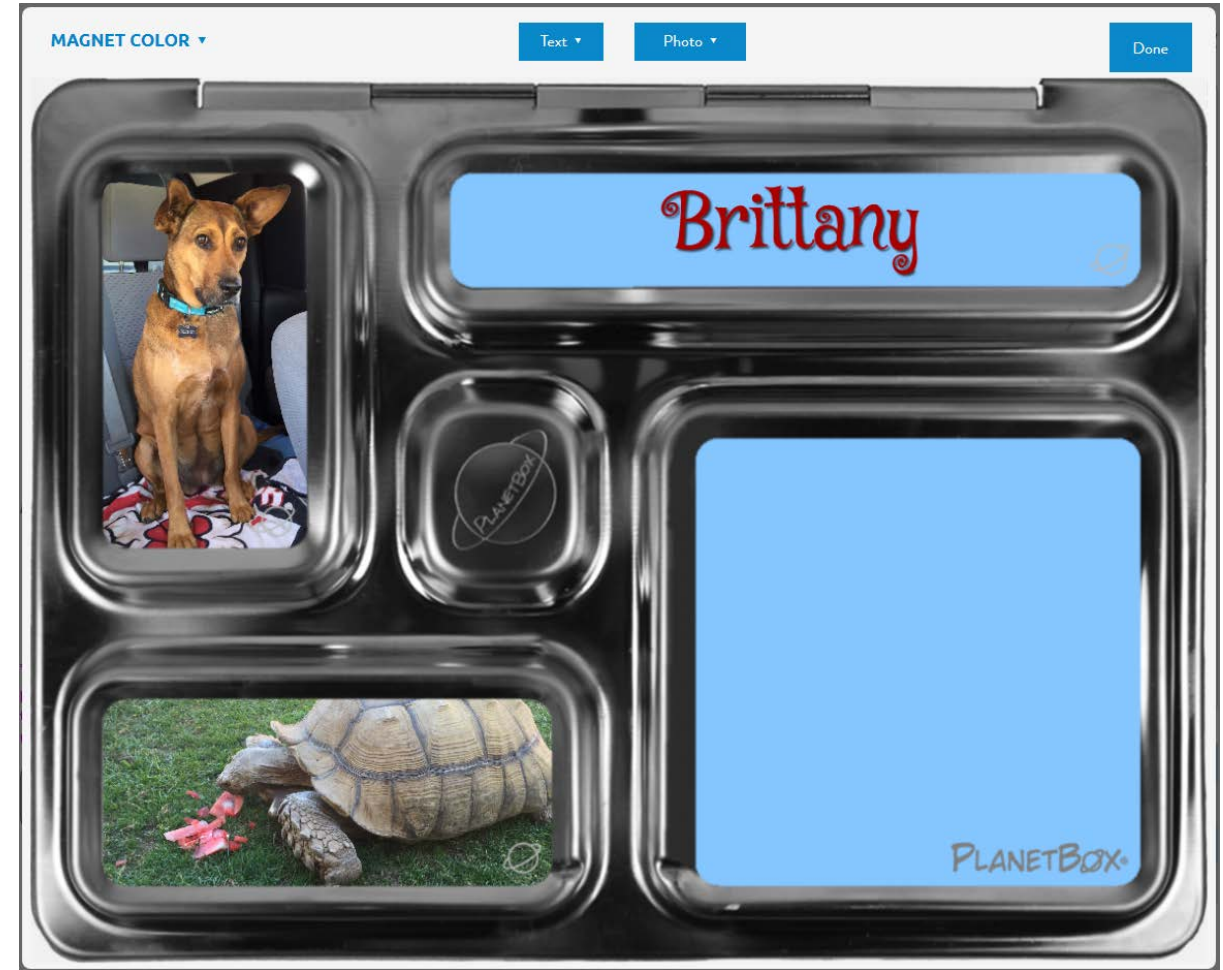
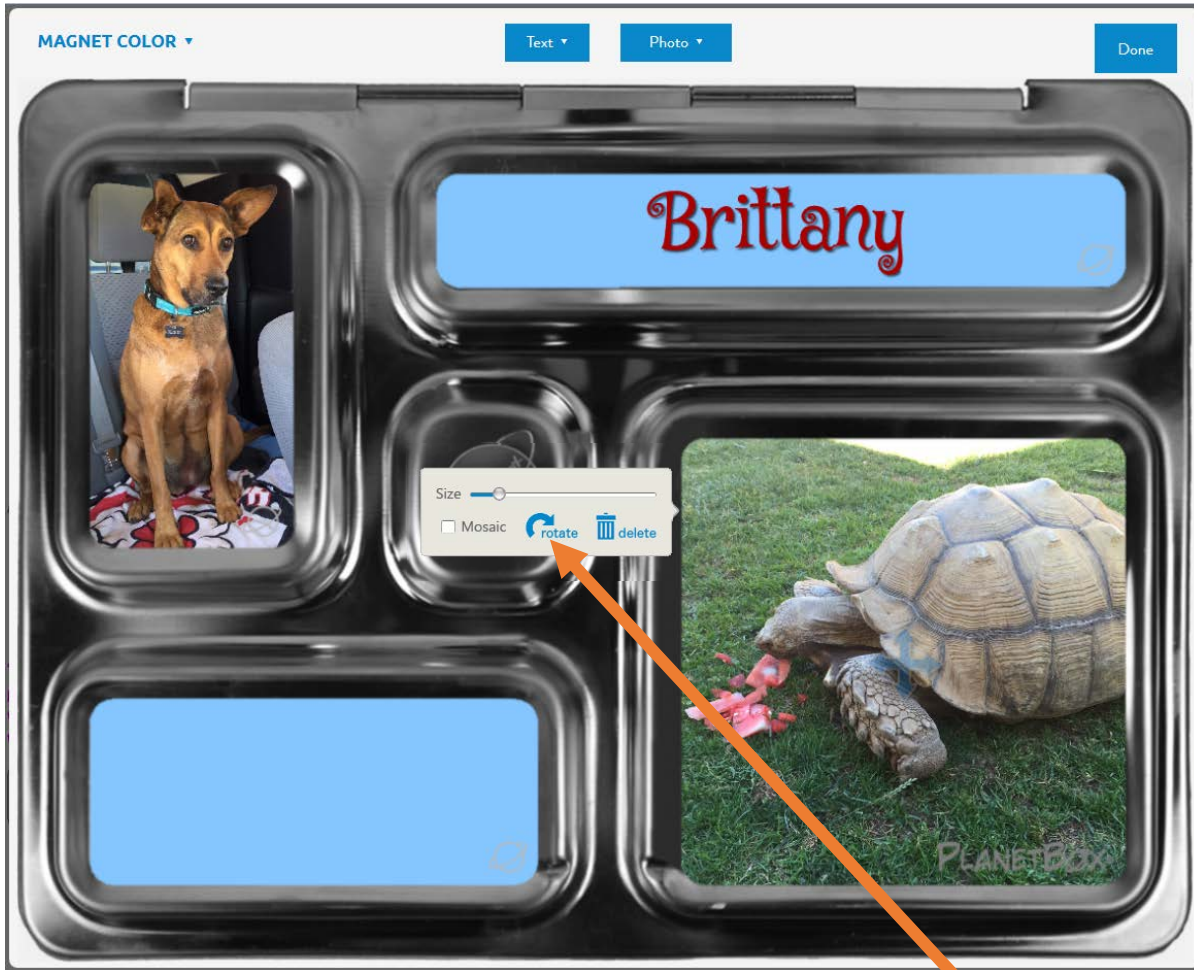

If your images comes in sideways, click the rotate button until  
the image is in the correct orientation.



# Making One Picture Cover All Magnets

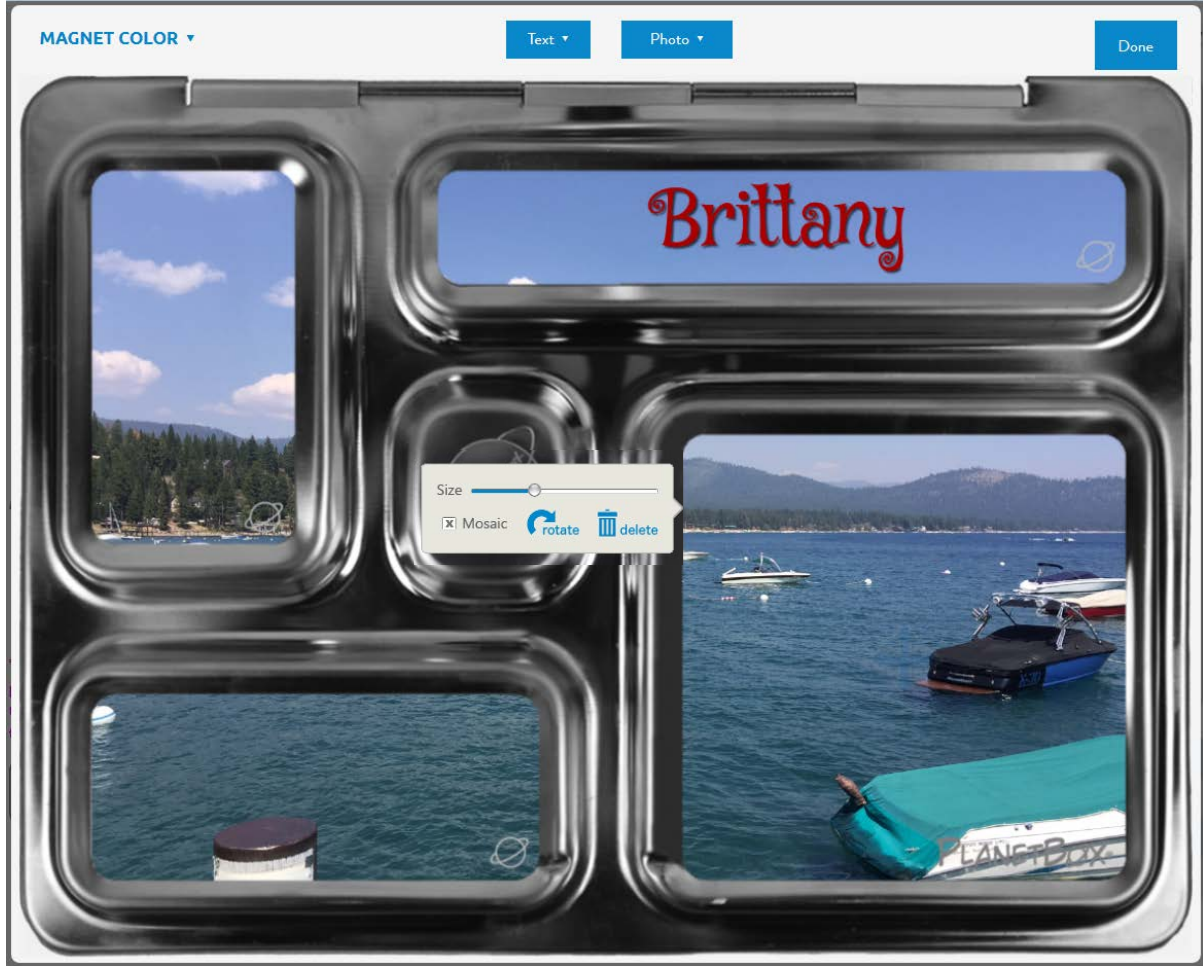
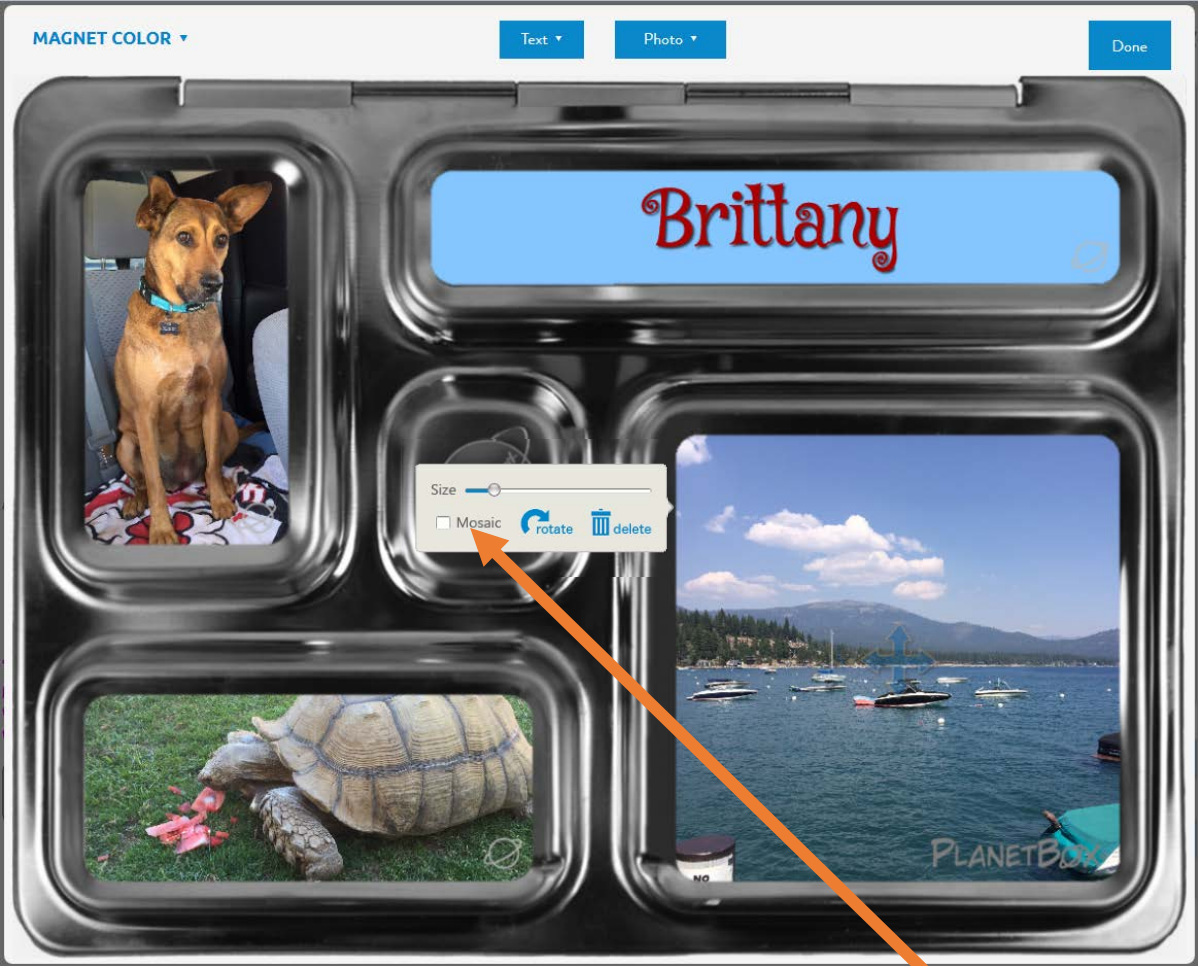

When an image is selected (and the blue arrows are flashing), Click on Mosaic. This makes the image cover all of the magnets as shown on the above right.

## Step 5: Finishing Your Design

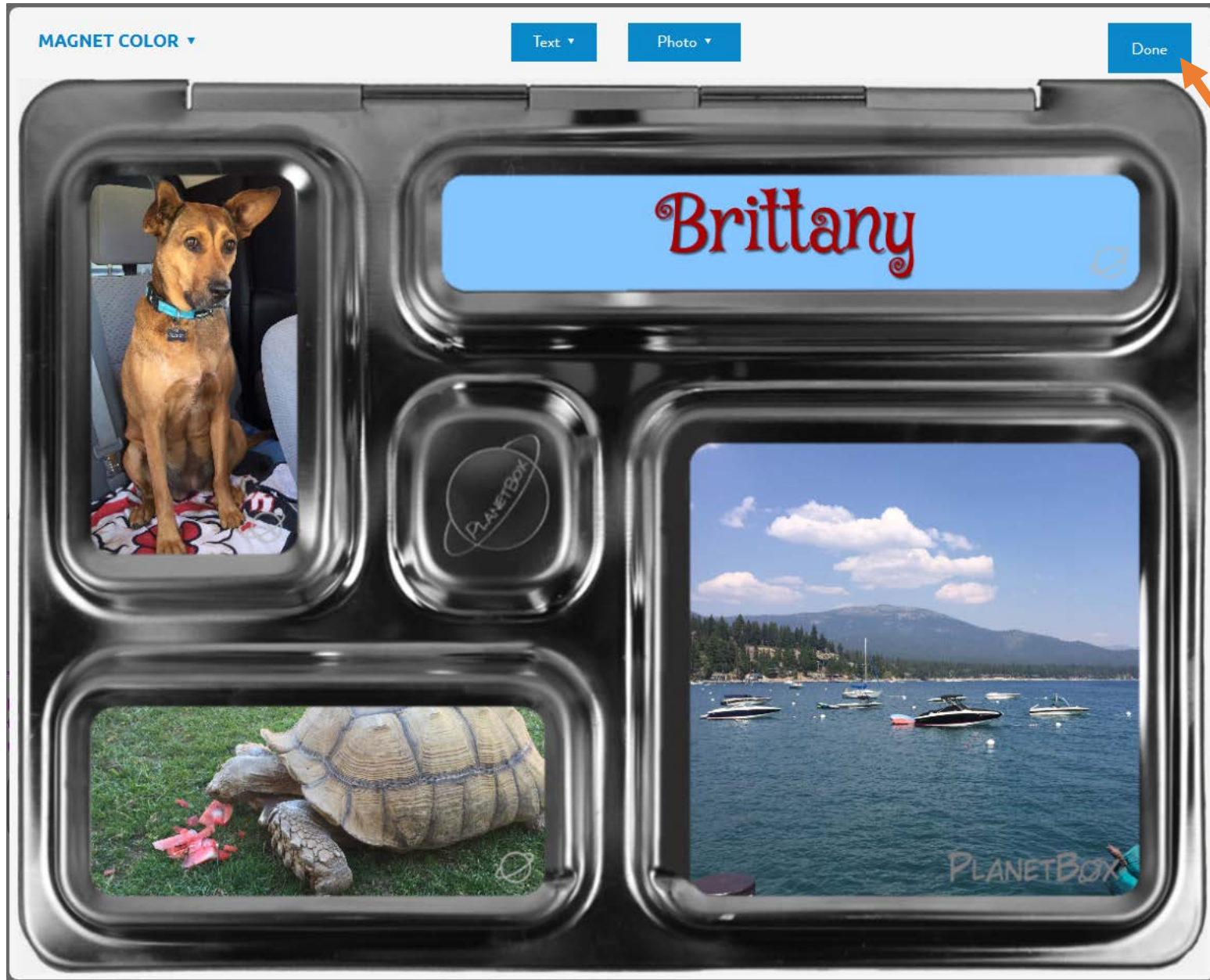

When you have finished your design,  
Click **Done**

Make sure there are no spelling or  
design errors. You will not be able to  
edit your design once you click Done.

# Step 6: Agreeing to the Terms and Conditions

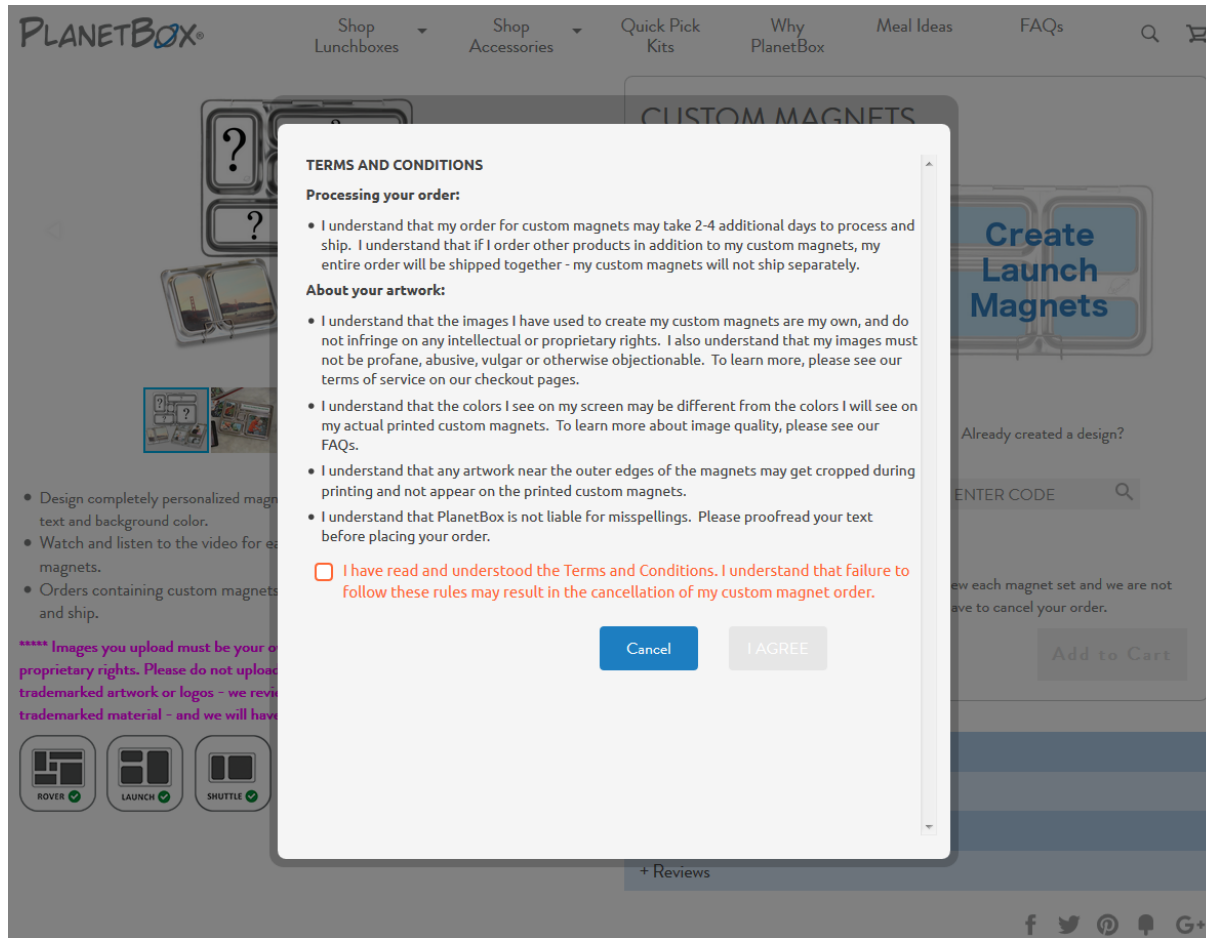

A pop-up will appear that lists a short version of the Terms and Conditions.

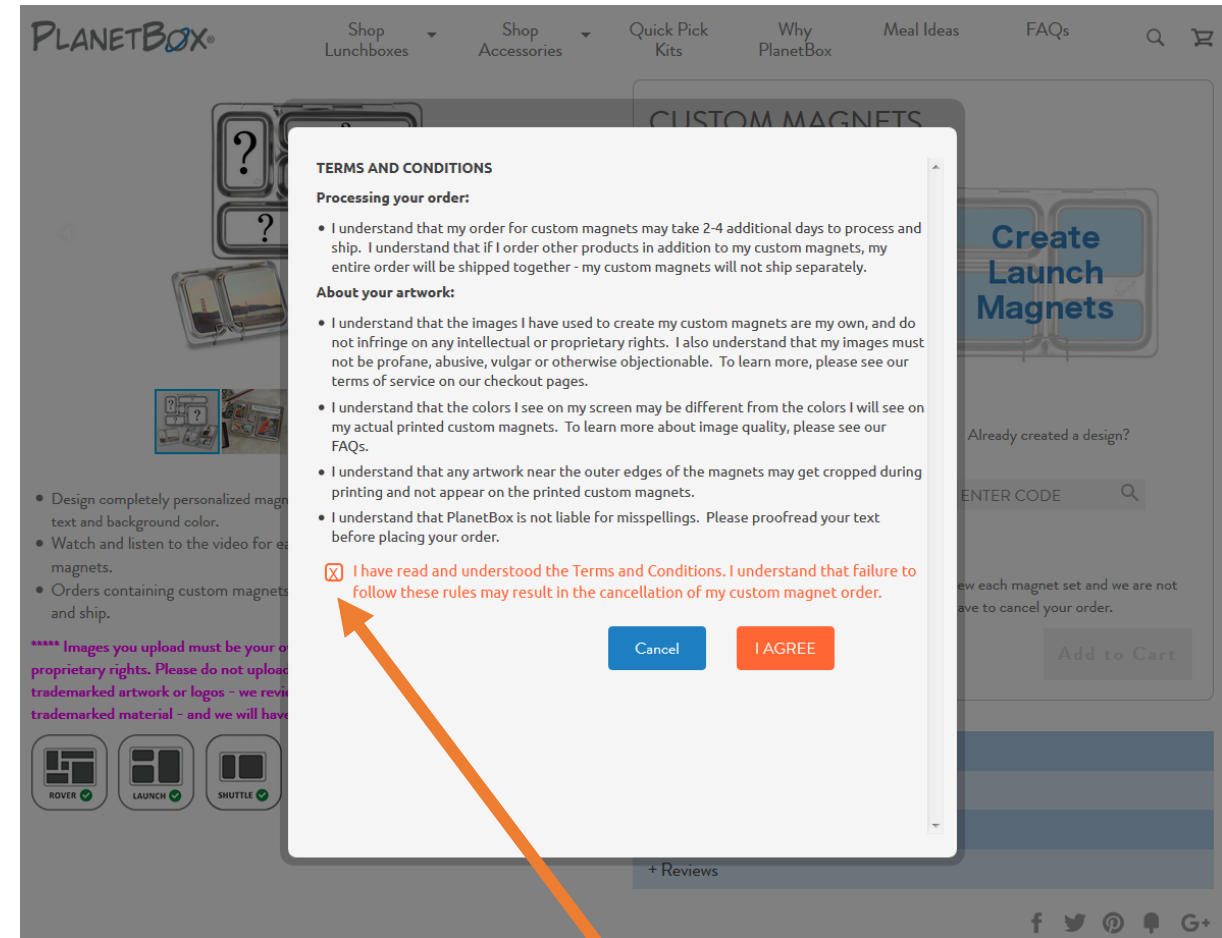

After you have read the Terms and Conditions, click on the checkbox. You can now click the **I AGREE** button.

# Step 7: Adding Your Magnets to Your Cart

PLANETBOX® Shop Lunchboxes Shop Accessories Quick Pick Kits Why PlanetBox Meal Ideas FAQs

## CUSTOM MAGNETS

Rover Design: DZTPRR [Start Over](#)

Please do not upload trademarked logos - we review each magnet set and we are not able to print trademarked material - and we will have to cancel your order.

QTY - 1 + \$8.95 [Add to Cart](#)

- + Video
- + Details
- + Care and Use
- + Reviews

f t p G+

If you want to order your magnets at a later time, just remember your Design Code. You can “lookup” your design later and purchase your magnets.

Don't forget to add your newly designed magnets to your cart!

- Watch the video for easy to follow instructions on designing your magnets.
- Orders containing custom magnets can take an additional 2-4 days to process and ship.

\*\*\*\*\* Images you upload must be your own, and not infringe on any intellectual or proprietary rights. Please do not upload any images that are not yours, such as trademarked artwork or logos - we review each magnet set and we are not able to print trademarked material - and we will have to cancel your order.

