

R-297

Auxiliary Double Blower Heater

TRUCK SLEEPERS

The R-297 is a powerful, three-speed floor-mounted heater for cabs used in demanding environments.

R-297 SPECIFICATIONS

BTUS	Heating - 28,000 BTU/Hr	
AIR FLOW	300 CFM (510 m ³ /h)	
WEIGHT	9.8 lbs. (4 kg)	
CURRENT DRAW	6A @ 27V 12A @ 13.5V	
UNITS	R-297-0P	12 VDC
	R-297-0-24P	24 VDC

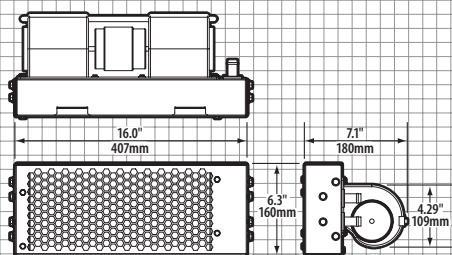

R-297

R-2020

Auxiliary Heater-Defrost and Oil Cooler

MARINE • INDUSTRIAL • CONSTRUCTION

R-2020 SPECIFICATIONS

BTUS	Heat -17,800 BTU/Hr @ 100°F (kw 5.21 @ 37.8°C) with water for heat source (BTU's per hour with oil for heat source lower)
AIR FLOW	165 CFM (280 m ³ /h)
WEIGHT	10.7 lbs. (4.85 kg)
MOTOR	One 12 VDC or one 24 VDC single speed
CURRENT DRAW	6 amps @ 13.6 VDC, 3 amps @ 27.2 VDC
UNITS	R-2020-0P (12 VDC), R-2020-0-24P (24 VDC)

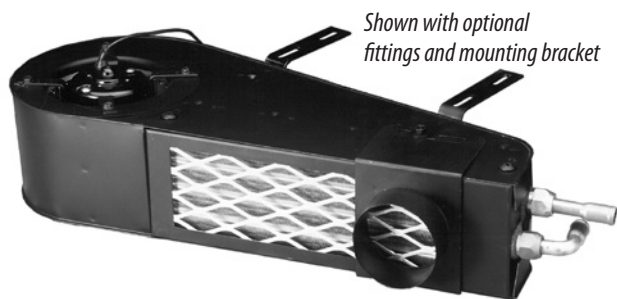

Shown with optional fittings and mounting bracket

OPTIONS:

2 1/2" Defrost Adapter

72R3601

3" Defrost Adapter

72R3603

Swivel Fittings

70R7600 (Straight 5/8" hose)

70R7650 (90° 5/8" hose)

Hoses

78R0100 (Heater, 5/8" 50ft)

78R0250 (Defrost, 2 1/2" 9ft)

78R0300 (Defrost, 3" 9ft)

Switches

71R0050 (Toggle, ON-OFF)

71R1210 (Rotary, 3-speed)

Mounting Bracket

RD-1-0419-0P

Control Panel

71R5817 Heater control - Single speed motor switch with manual water valve control

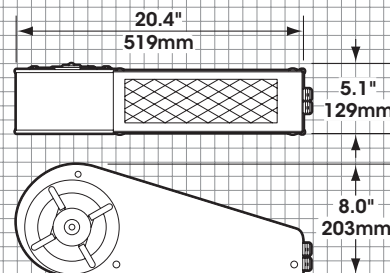

HEATER ONLY