

## USER MANUAL

**ZOOZ™**  
bright ideas

4-IN-1 SENSOR VER. 2.0  
ZSE40

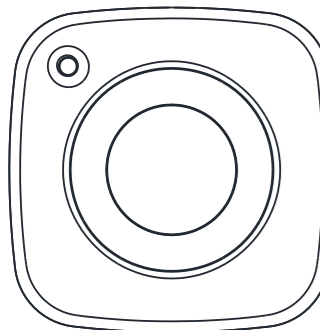

www.getzooz.com



## FEATURES

- ▶ 4 smart sensors in 1 compact device
- ▶ 7 levels of motion sensitivity
- ▶ 4 modes for motion / temperature LED indicator notifications
- ▶ Built-in tamper protection
- ▶ Low battery alerts
- ▶ Z-Wave Plus with improved 500 chip for faster and safer wireless communication
- ▶ AES signal encryption (security-enabled controller required for best performance)

## SPECIFICATIONS

- ▶ Model Number: ZSE40
- ▶ Z-Wave Signal Frequency: 908.42 MHz
- ▶ Power: 1 CR123A battery
- ▶ Range: Up to 100 feet line of sight
- ▶ Operating Temperature: 5-104° F
- ▶ Installation and Use: Indoor only

## Z-WAVE CONTROL

1. Insert the battery.
2. Place the sensor near the location where it will be mounted.



**ADD DEVICE** to your hub

Initiate inclusion (pairing) in the app (or web interface).

Finalize inclusion at the sensor.

**CLICK Z-WAVE BUTTON TWICE QUICKLY**

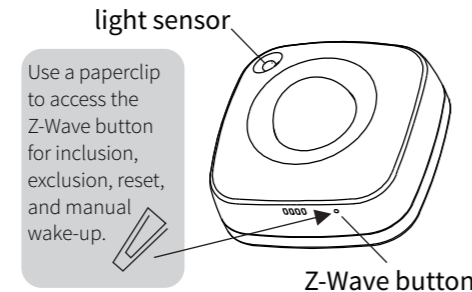

The LED indicator will blink (blue or orange) to signal communication and then turn off to confirm inclusion.

## TROUBLESHOOTING

### The sensor won't add to your system?

#### Try this:

1. Initiate **EXCLUSION** and click the Z-Wave button on the sensor twice.
2. Make sure the battery **cover is closed** tightly when adding the sensor.
3. Click the Z-Wave button on the sensor **6-7 times quickly** when adding it.
4. Bring the sensor **closer** to your gateway controller (hub), it may be out of range.
5. Double-check if the **battery** is inserted correctly.

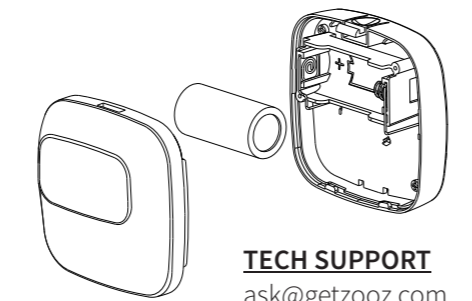

## REMOVE THE SENSOR FROM YOUR HUB

1. Bring the sensor within direct range of your Z-Wave gateway (hub).
2. Put the Z-Wave hub into exclusion mode (not sure how to do that? ask@getzooz.com).
3. Press and release the Z-Wave button with a paperclip twice quickly.
4. Your hub will confirm exclusion and the device will disappear from your controller's device list.

## FACTORY RESET

If your primary controller is missing or inoperable, you may need to reset the device to factory settings. To complete the reset process manually, **remove the back cover** to trigger tamper switch. **Press and release the Z-Wave button** using a paperclip **10 TIMES quickly** (within 10 seconds).

**NOTE: All previously recorded activity and custom settings will be erased from the device's memory.**

## WAKE-UP MODE

The sensor's wake-up interval is set to 12 hours by default to save battery life. You can change the wake-up interval using your controller's advanced settings if available. During wake-up, the sensor receives communication from the hub (setting updates or network information). Long wake-up interval will **not** affect how often the sensor reports motion and other values to your gateway controller.

## MANUAL WAKE-UP

Press and release the Z-Wave button **once** to wake the device up. The LED indicator will flash once (blue or orange). You may need to wake the sensor up manually IF:

1. It doesn't fully configure during set-up (values are not displayed or errors pop up in your hub's interface).
2. You change advanced settings for the sensor and want them to update.

## MOUNTING

### OPTION 1: MOUNTING BRACKET

Use the 2 screws included in the box to fix the mounting bracket to flat surface of your choice - at least 7 feet above the ground for best results. Once the bracket is securely installed, carefully slide the 4-in-1 sensor onto the bracket and position it by tilting it to either side, upwards, or downwards - just like in the images below.

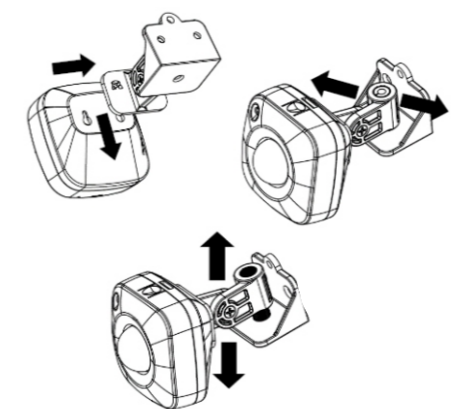

### OPTION 2: ADHESIVE TAPE

Use the supplied adhesive tape to fix the sensor to a CLEAN flat surface of your choice. Apply the tape as in the pictures below.

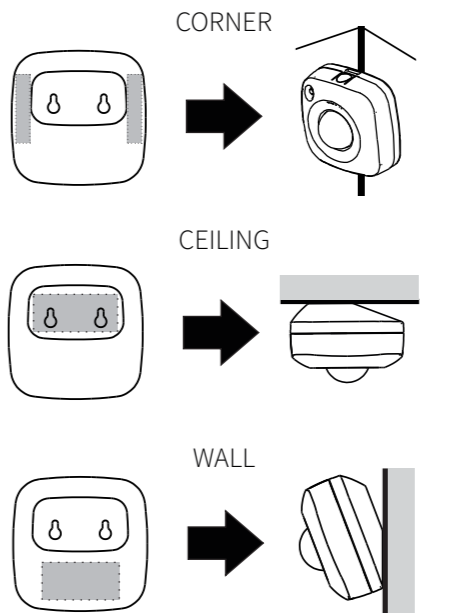

## ⚠ INDOOR ONLY!

This sensor may only be used and installed indoors. Outdoor installation will void its warranty.

For best results, mount the sensor within 30 feet from the door and around 7 feet from the ground. The 4-in-1 Sensor will detect motion up to 40 feet depending on mounting location and sensitivity settings.

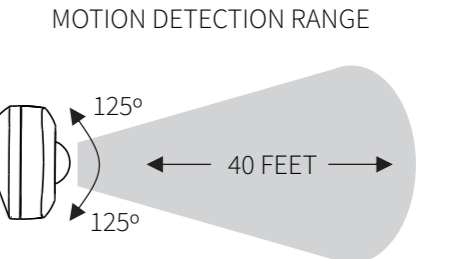

See Advanced Settings for ways to optimize and customize motion detection and activity reports.

## ⚠ WARNING

- ▶ This product should be installed indoors upon completion of any building renovations.
- ▶ Prior to installation, the device should be stored in a dry, dust-and-mold-proof place.
- ▶ Do not install the sensor in a place with direct sun exposure, high temperature, or humidity.
- ▶ Keep away from chemicals, water, and dust.
- ▶ Ensure the device is never close to any heat source or open flame to prevent fire.
- ▶ Ensure the device is connected to an electric power source that does not exceed the maximum load power.
- ▶ No part of the device may be replaced or repaired by the user, except for the battery.

## ADVANCED SETTINGS

Please refer to your controller's user guide for advanced programming instructions as they are a little different for every software.

**Not sure where to start? Let us know!**  
ask@getzooz.com

## ASSOCIATION

Associate your 4-in-1 with other Z-Wave devices for direct communication between them so your rules and automations can take place even if the hub is down.

The 4-in-1 sensor supports Group 1 with up to five devices for lifeline communication. To associate the sensor with other devices, simply put your Z-Wave controller in Association mode by sending the appropriate command and wake up the sensor by clicking the Z-Wave button with a paperclip once.

## CUSTOMIZE YOUR SENSOR

### Temperature Sensor

Parameter 1: Use this parameter to switch from Fahrenheit to Celsius scale.

Values: 0 – Celsius. 1 – Fahrenheit (default).

Size: 1 byte dec.

Parameter 2: Use it to set temperature change to be reported by the sensor.

Values: 1 - 50 (where 1 stands for 0.1 degree and 50 stands for 5 degrees). Default set to 1 degree (value 10). The sensor will report new temperature value to the controller whenever temperature goes 1 degree up or down.

Size: 1 byte dec.

### Humidity Sensor

Reports relative humidity.

Parameter 3: Use it to set humidity percentage change to be reported by the sensor.

Values: 1 - 50 where 1 stands for 1% and 50 stands for 50%. Default set to 10%.

Size: 1 byte dec.

### Light Sensor

Reports light level in percentage (1-100).

Parameter 4: Use it to choose light percentage change to be reported by the sensor.

Values: 5 - 50 where 5 stands for 5% and 50 stands for 50%. Default set to 10%.

Size: 1 byte dec.

### Motion Sensor

Parameter 5: Use it to set trigger interval - the time when motion is reported again after initial trigger.

Values: 15 - 60 where 15 stands for 15 seconds and 60 stands for 60 seconds. Default set to 15 seconds.

Size: 1 byte dec.

NOTE: Small interval will increase activity and decrease battery life.

Parameter 6: Use it to adjust PIR sensor sensitivity.

Values: 1 - 7, where 1 = very high sensitivity and 7 = very low sensitivity. Default set to 3.

Size: 1 byte dec.

### LED notifications

LED indicator will flash whenever you press the Z-Wave button to indicate temperature level and wake-up mode.

### How to read LED indicator colors?

Green = under 60°F

Blue = 60°-75°F

Yellow = 75°-83°F

Purple = 83°-97°F

**Red** = over 97°F / motion detected / tamper switch triggered

**Flashing red** = low battery

Parameter 7: Use it to choose between LED indicator modes.

**Mode 1** = LED indicator is turned off (no visual notifications).

**Mode 2** = temperature indicated with pulsing light. Motion indicated with flashing light.

**Mode 3** = temperature and motion indicated with flashing light. Flashes every 3 minutes for temperature.

**Mode 4** = no indication for temperature, motion indicated with flashing light.

Values: 1 - 4. Default set to 4.

Size: 1 byte dec.

**NOTE:** Mode 2 will increase activity and decrease battery life.

### Tamper Switch

Tamper switch is located to the left of the battery slot. It's activated whenever the sensor's cover is removed while the device is powered up. It will send an alarm notification as scheduled.

This device requires the following **command classes** to be supported and recognized by your Z-Wave controller:

COMMAND\_CLASS\_ASSOCIATION\_GRP\_INFO  
COMMAND\_CLASS\_ASSOCIATION\_V2  
COMMAND\_CLASS\_BATTERY  
COMMAND\_CLASS\_CONFIGURATION  
COMMAND\_CLASS\_DEVICE\_RESET\_LOCALLY  
COMMAND\_CLASS\_FIRMWARE\_UPDATE\_MD\_V2  
COMMAND\_CLASS\_MANUFACTURER\_SPECIFIC\_V2  
COMMAND\_CLASS\_NOTIFICATION\_V4  
COMMAND\_CLASS\_POWERLEVEL  
COMMAND\_CLASS\_SECURITY  
COMMAND\_CLASS\_SENSOR\_MULTILEVEL\_V7  
COMMAND\_CLASS\_VERSION\_V2  
COMMAND\_CLASS\_WAKE\_UP\_V2  
COMMAND\_CLASS\_ZWAVEPLUS\_INFO\_V2



This product can be included and operated in any Z-Wave network with other Z-Wave certified devices from other manufacturers and/or other applications. All non-battery operated nodes within the network will act as repeaters regardless of vendor to increase reliability of the network.

## WARRANTY

This Limited Warranty applies to physical goods, and only for physical goods, purchased from Zooz (the "Physical Goods").

### What does this limited warranty cover?

This Limited Warranty covers any defects in material or workmanship under normal use according to instructions from the User Manual during the Warranty Period. Warranty coverage applies to purchases made from authorized dealers only. See full list of Zooz distributors here:

getzooz.com/buy

During the Warranty Period, Zooz will repair or replace, at no charge, products or parts of a product that prove defective because of improper material or workmanship, under normal use and recommended maintenance. Zooz does not assume the cost of return shipping for warranty service.

### How long does the coverage last?

The Warranty Period for Physical Goods purchased from Zooz is 12 months from the date you purchased this product.

### What does this limited warranty not cover?

This Limited Warranty does not cover any problem that is caused by:

- ▶ conditions, malfunctions or damage not resulting from defects in material or workmanship
- ▶ improper handling or installation of the product

The warranty does not cover purchases from unauthorized dealers or second-hand sources. The warranty does not cover return shipping cost for warranty service.

### What do you have to do?

To obtain warranty service, please contact us to determine the problem and offer a quick solution for you:  
warranty@getzooz.com

You may also get in touch with the reseller of the product directly to return or replace the product within 30 days of purchase or within applicable reseller's returns period.

IN NO EVENT SHALL ZOOZ OR ITS SUBSIDIARIES AND AFFILIATES BE LIABLE FOR ANY INDIRECT, INCIDENTAL, PUNITIVE, SPECIAL, OR CONSEQUENTIAL DAMAGES, OR DAMAGES FOR LOSS OF PROFITS, REVENUE, OR USE INCURRED BY CUSTOMER OR ANY THIRD PARTY, WHETHER IN AN ACTION IN CONTRACT, OR OTHERWISE EVEN IF ADVISED OF THE POSSIBILITY OF SUCH DAMAGES. ZOOZ'S LIABILITY AND CUSTOMER'S EXCLUSIVE REMEDY FOR ANY CAUSE OF ACTION ARISING IN CONNECTION WITH THIS AGREEMENT OR THE SALE OR USE OF THE PRODUCTS, WHETHER BASED ON NEGLIGENCE, STRICT LIABILITY, BREACH OF WARRANTY, BREACH OF AGREEMENT, OR EQUITABLE PRINCIPLES, IS EXPRESSLY LIMITED TO, AT ZOOZ'S OPTION, REPLACEMENT OF, OR REPAYMENT OF THE PURCHASE PRICE FOR THAT PORTION OF PRODUCTS WITH RESPECT TO WHICH DAMAGES ARE CLAIMED. ALL CLAIMS OF ANY KIND ARISING IN CONNECTION WITH THIS AGREEMENT OR THE SALE OR USE OF PRODUCTS SHALL BE DEEMED WAIVED UNLESS MADE IN WRITING WITHIN THIRTY (30) DAYS FROM ZOOZ'S DELIVERY, OR THE DATE FIXED FOR DELIVERY IN THE EVENT OF NONDELIVERY.

FCC NOTE

THE MANUFACTURER IS NOT RESPONSIBLE FOR ANY RADIO OR TV INTERFERENCE CAUSED BY UNAUTHORIZED MODIFICATIONS TO THIS EQUIPMENT. SUCH MODIFICATIONS COULD VOID THE USER'S AUTHORITY TO OPERATE THE EQUIPMENT. STORE INDOORS WHEN NOT IN USE. SUITABLE FOR DRY LOCATIONS ONLY. DO NOT IMMERSE IN WATER. NOT FOR USE WHERE DIRECTLY EXPOSED TO WATER.

This device complies with Part 15 of the FCC Rules. Operation is subject to the following conditions:

1. This device may not cause harmful interference,
2. This device must accept any interference received, including interference that may cause undesired operation.

This equipment has been tested and found to comply with the limits for a Class B digital device, pursuant to part 15 of the FCC Rules.

These limits are designed to provide reasonable protection against harmful interference in a residential installation.

This equipment generates, uses and can radiate radio frequency energy and, if not installed and used according to instructions, may cause harmful interference to radio communications.

However, there is no guarantee that interference will not occur in any given installation.

If this equipment causes harmful interference to radio or television reception, the user may try to correct the interference by taking one or more of the following measures:

- Reorient or relocate receiving antenna
- Increase the separation between equipment and receiver
- Connect equipment into a separate outlet or circuit from receiver
- Consult the dealer or an experienced radio/TV technician for additional assistance

All brand names displayed are trademarks of their respective holders.

© Zooz 2017