

QUICK GUIDE

FOR THE ZOOZ TITAN BACKUP BATTERY

www.support.getzooz.com

STEP 1

Connect to the power cord on your Zooz Titan actuator.

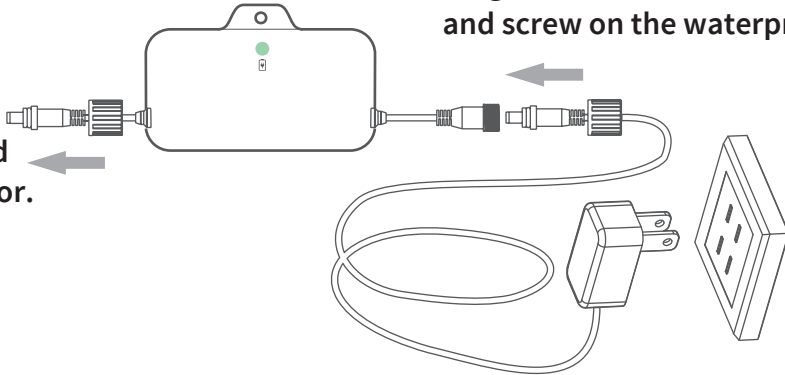

Plug in to the Titan power supply and screw on the waterproof cap

STEP 2

Follow the installation instructions for the Titan actuator to mount it securely before powering it up.

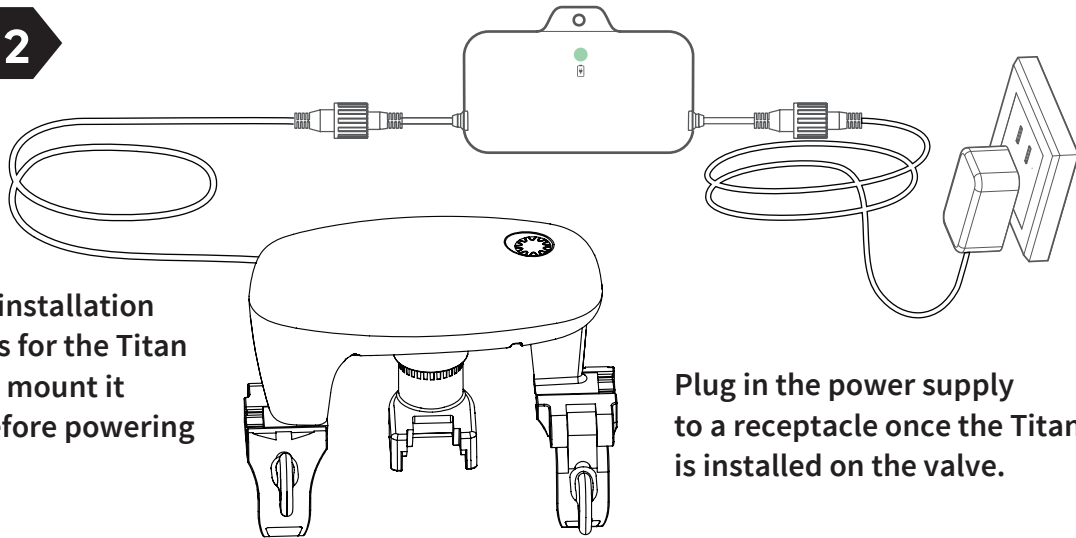

Plug in the power supply to a receptacle once the Titan is installed on the valve.



Scan the QR code for a link to detailed installation instructions.

IMPORTANT: If your Titan device is already added to the hub, you need to exclude and re-include it after adding the battery pack!

LED Indicator Guide

Solid blue: battery fully charged
Slow blink: battery charging
Flash: battery discharging



Two beeps: power restored
Three beeps: power lost