

# Tube Fittings Spec Sheet

— JIC Male/NPT Male

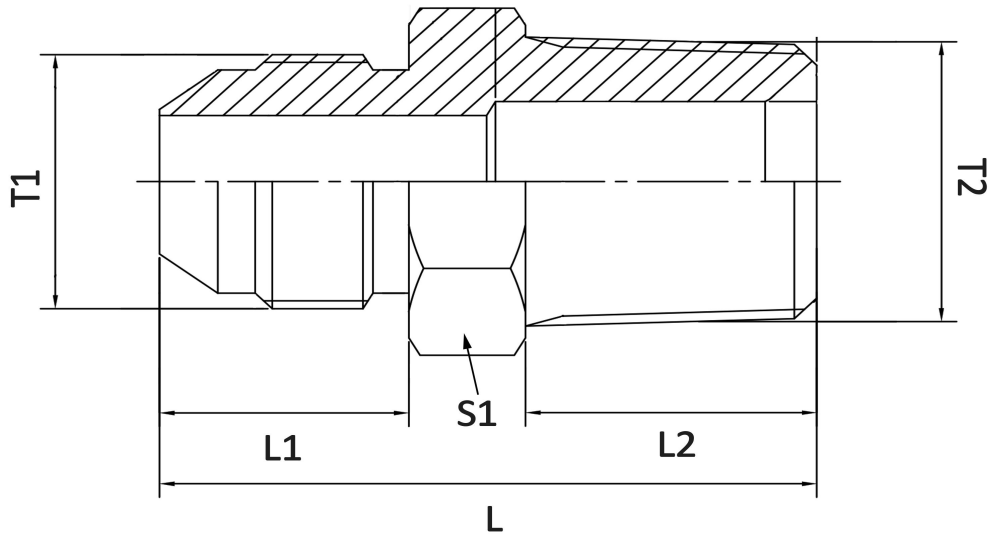

SKU	Tube O.D.		THREAD		DIMENSIONS(mm)				Weight (g/pc)	Working Pressure Mpa
	inch	mm	T1(UNF)	T2	L1	L2	L	S1		
EXA-CON-NPT0104-JIC0104	1/4"	6	7/16"-20	NPT1/4"-18	14.0	15.0	36.0	17	30	27.5
EXA-CON-NPT0308-MJIC0104	1/4"	6	7/16"-20	NPT3/8"-18	14.0	16.0	36.0	19	39	21.0
EXA-CON-NPT0102-JIC0104	1/4"	6	7/16"-20	NPT1/2"-14	14.0	19.5	43.0	22	74	27.5
EXA-CON-NPT0104-JIC0308	3/8"	10	9/16"-18	NPT1/4"-18	14.1	15.0	36.5	17	33	27.5
EXA-CON-NPT0308-JIC0308	3/8"	10	9/16"-18	NPT3/8"-18	14.1	16.0	36.5	19	41	21.0
EXA-CON-NPT0102-JIC0308	3/8"	10	9/16"-18	NPT1/2"-14	14.1	19.5	42.9	22	73	21.0
EXA-CON-NPT0104-JIC0102	1/2"	12	3/4"-16	NPT1/4"-18	16.7	15.0	39.0	22	56	27.5
EXA-CON-NPT0308-JIC0102	1/2"	12	3/4"-16	NPT3/8"-18	16.7	16.0	39.0	22	60	21.0
EXA-CON-NPT0102-JIC0102	1/2"	12	3/4"-16	NPT1/2"-14	16.7	19.5	44.0	24	80	21.0
EXA-CON-NPT0304-JIC0102	1/2"	12	3/4"-16	NPT3/4"-14	16.7	19.5	47.0	30	125	17.0
EXA-CON-NPT0102-JIC0304	3/4"	18-20	1 1/16"-12	NPT1/2"-14	21.9	19.5	52.3	30	142	21.0
EXA-CON-NPT0304-JIC0304	3/4"	18-20	1 1/16"-12	NPT3/4"-14	21.9	19.5	52.3	30	147	17.0
EXA-CON-NPT01-JIC01	1"	25	1 5/16"-12	NPT1"-11 1/2	23.1	25.5	58.5	36	242	14.0

Hardware Factory Store Inc.

1029 N Todd Ave. Azusa, CA 91702

TEL: 626.332.7744

E-MAIL: info@hfsusa.com

WEBSITE: <https://hardwarefactorystore.com/>

