

Tri-Clamp Filter Plate Spec Sheet

— Filter Plate - Mid Plate - 6mm Pore



Tri Clamp support spools have a rigid surface across the face of the spool, called a perforated plate. This perforated plate has 6mm holes and is aligned flush-centered in the spool creating a face for tri-clamp gaskets to rest against. When filtered sediment accumulates at the face of the screen gasket increasing pressure, the perforated plate holds the gasket in place and prevents any screen displacement.

The Filter Plate can be used simultaneously with ashless filter papers or any other filtration media like stainless steel ball bearings or steel wool to increase surface and filtration levels to remove fats, lipids, waxes, and other material during the extraction process.

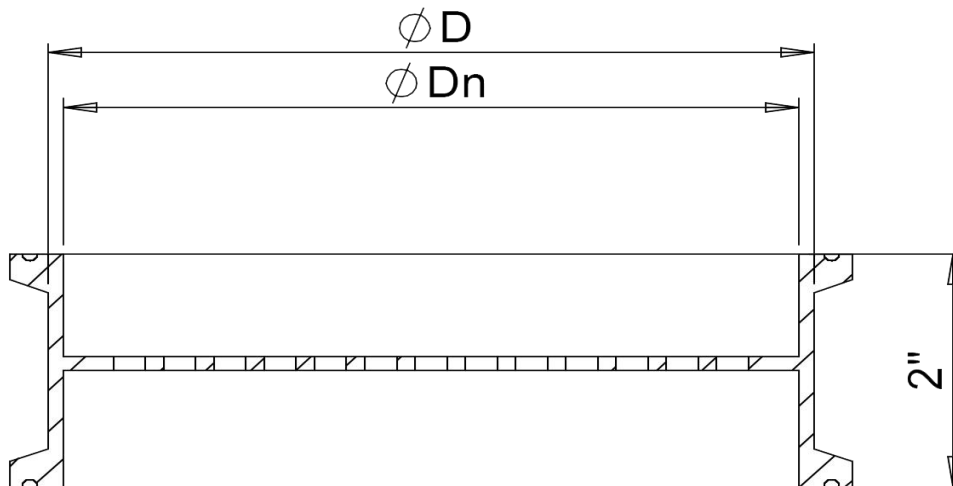

Material: SUS304

Working Pressure: 150PSI; Working Temp.: -58°F~392°F

SKU	Size	ϕD		ϕD_n		Pore Size
		mm	inch	mm	inch	
EXA-FILTER-1.5	1.5"	38.1	1.5	34.9	1.4	6mm
EXA-FILTER-2	2"	50.8	2	47.3	1.9	6mm
EXA-FILTER-3	3"	76.2	3	72.8	2.9	6mm
EXA-FILTER-4	4"	101.6	4	97.2	3.8	6mm
EXA-FILTER-6	6"	152.4	6	146	5.7	6mm
EXA-FILTER-8	8"	203.2	8	197	7.8	6mm
EXA-FILTER-10	10"	254	10	248.6	9.8	6mm
EXA-FILTER-12	12"	306	12	300.4	11.8	6mm

Hardware Factory Store Inc.

1029 N Todd Ave. Azusa, CA 91702

TEL: 626.332.7744

E-MAIL: info@hfsusa.com

WEBSITE: <https://hardwarefactorystore.com/>

