

Tandem Swing Arm Lamp

ASSEMBLY INSTRUCTIONS

THE SAFETY OF THIS FIXTURE IS ONLY GUARANTEED IF THE FOLLOWING INSTRUCTIONS HAVE BEEN OBSERVED.

KEEP ALL PACKAGING MATERIALS UNTIL YOU HAVE VERIFIED ALL COMPONENTS AND PARTS

1. Choose your preferred position on the wall. Level the mounting plate then use it as a template to mark the position of the holes. Drill 4 holes using a 3/16" drill bit then insert the 4 plugs (A)
2. Attach the plate to the wall by screwing the provided screws (AA) through the holes of the plate, into the drywall plugs.
3. Install the provided bulbs into lampshades. We recommend replacing the bulbs we recommend using a **GU10** bulb with a warm glow. Bulb wattage should not exceed 60W or the equivalent in LED. For indoor use only.

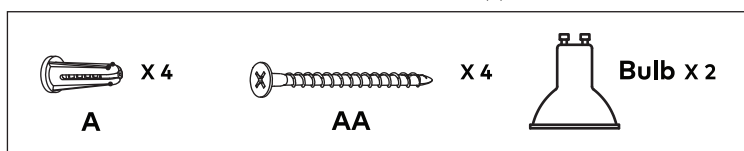
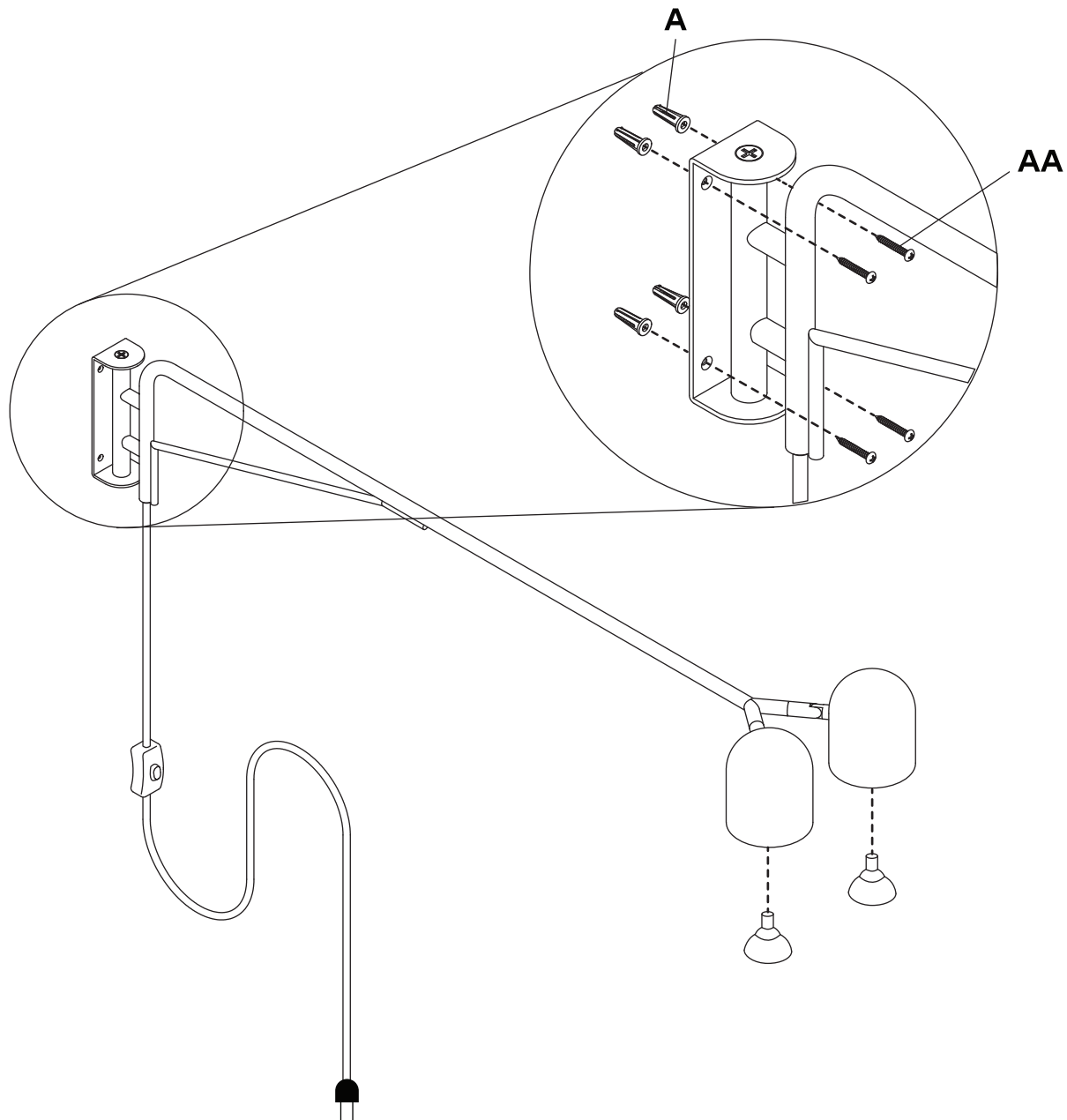

Modern
furniture
made
simple.