

MULTI-FUEL ADAPTER

MULTI-FUEL ADAPTER ASSEMBLY

1. Place the Multi-Fuel Adapter's seating surface into the head of the torch. Tighten the adapter using an adjustable wrench. **DO NOT OVERTIGHTEN.**

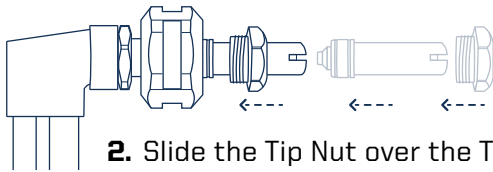
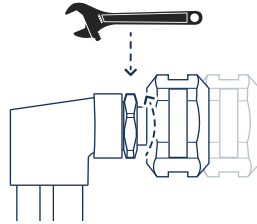

2. Slide the Tip Nut over the Tip (see Tip Selection Chart). Place the Tip's seating surface into the adapter.

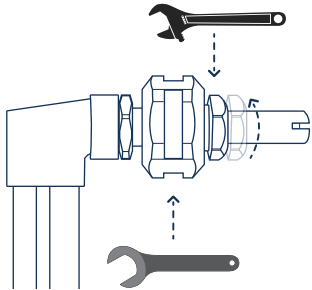

3. Use the Multi-Fuel Adapter Installation Wrench to hold the adapter and prevent it from spinning. Tighten the Tip Nut. **DO NOT OVERTIGHTEN.**

NOTE: High heat tips are designed to be used with the Multi-Fuel Adapter and heavy fuels. It is not necessary to use the Adapter when using light fuels such as gasoline, white gas or camping fuel. Standard tips are preferred when using light fuels.

MULTI-FUEL ADAPTOR LIGHT UP

1. **Pre-Heat Oxygen Knob** - Open precisely 1/2 turn.
 - If using tip size HH6 open 1/4 turn.

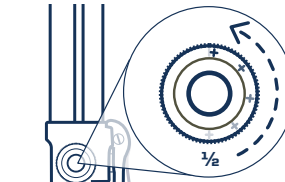

2. **High Pressure Oxygen Trigger** - Purge by fully depressing for 5 to 7 seconds.

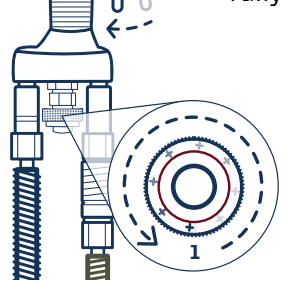

3. **Fuel Control Knob** - Open 3/4 to 1 full turn (see Fuel Guide).

LIGHTING THE TORCH -

- A. Tighten the thumb screw until the flint makes light contact with the carbide strip (The flint should move freely)
- B. Keep screw facing upward
- C. Hold at a 45° angle
- D. Apply pressure to the flint
- E. Strike down directly at the tip

WARM UP - After Ignition, rest the tip directly on the steel for 10 to 20 seconds (see Fuel Guide). This allows the pre-heat flame to fully heat the tip and Multi-Fuel Adapter. As the tip and Adapter heat up, the yellow and orange streaks in the flame will disappear. See the Fuel Chart for additional information regarding fuel settings and behaviors.

www.petrogen.com

E: torch@petrogen.com | P: 877-888-6724 | F: 719-596-4721

FUEL GUIDE

DIESEL

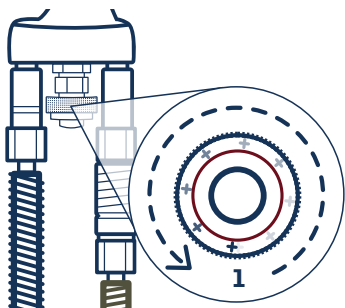

PREHEAT OXYGEN KNOB -
1/2 turn

HIGH PRESSURE OXYGEN -
Purge 5-8 seconds

FUEL CONTROL KNOB -
1 turn

WARM UP -
20 seconds

KEROSENE

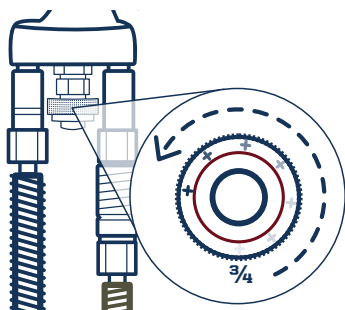

PREHEAT OXYGEN KNOB -
1/2 turn

HIGH PRESSURE OXYGEN -
Purge 3-5 seconds

FUEL CONTROL KNOB -
3/4 turn

WARM UP -
10 seconds

GASOLINE *

** It is not necessary to use the Multi-Fuel Adapter when using light fuels such as gasoline, white gas or camping fuel.*

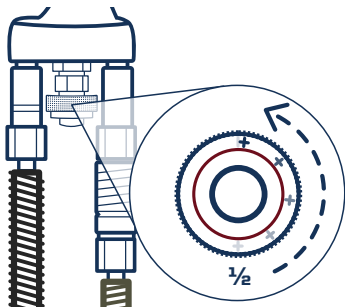

PREHEAT OXYGEN KNOB -
1/2 turn

HIGH PRESSURE OXYGEN -
Purge 3-5 seconds

FUEL CONTROL KNOB -
1/2 turn

WARM UP -
5 seconds