

product

designer

year

1 Essenza

Willem van Ast

1999

2a Standard

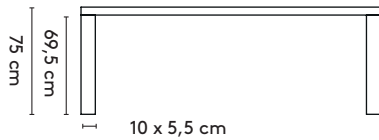
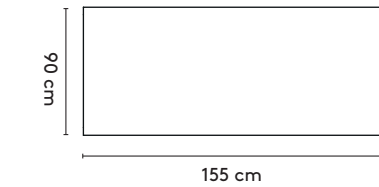

- 155 x 90 x 75 cm
- 190 x 90 x 75 cm
- 210 x 90 x 75 cm
- 240 x 90 x 75 cm
- 280 x 90 x 75 cm
- 210 x 105 x 75 cm
- 240 x 105 x 75 cm

2b Tailoring

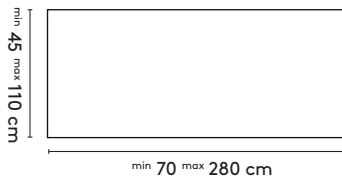

3 Materials

Top: oak or walnut (solid), oak smoked (solid)*
Legs: oak or walnut (solid), oak smoked (solid)*

Materialen

Blad: eiken of noten (massief), eiken gerookt (massief)*
 Poten: eiken of noten (massief, eiken gerookt (massief)*

Materialien

Platte: Eiche oder Nussbaum (Massiv), Eiche geräuchert (Massiv)*
 Beine: Eiche oder Nussbaum (Massiv), Eiche geräuchert (Massiv)*

4 Finishes

All Arco colors and finishes for the mentioned materials, sandblasting optional**

Afwerkingen

Alle Arco kleuren en (lak)afwerkingen voor de genoemde materialen, zandstralen mogelijk**

Ausführungen

Alle Arco Farben und Ausführungen für die genannten Materialien, sandstrahlen möglich**

5 Additional information

* Only with N-, P-finish or transparent oil
 ** Only 29, 30 or 39 with N- or P-finish
 *** Zipper sock in combination with CM06 or CM07 only
 Cable management including electrification optional

Aanvullende informatie

* Alleen met N-, P-lak of transparante olie
 ** Alleen 29, 30 of 39 met N- of P-lak
 *** Zipper sock uitsluitend met CM06 of CM07
 Cable management met elektrificatie mogelijk

Weitere Informationen

* Nur mit N-, P-Lack oder transparentes Öl
 ** Nur 29, 30 oder 39 mit N- oder P-Lack
 *** Zipper sock nur mit CM06 oder CM07
 Cable management mit Elektrifizierung möglich

6 Cable management

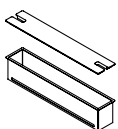

CM06/CM07
epoxy
30/50 cm



CM08/CM09
cable-net
small/large



CM12
cable sock
large



CM13***
zipper sock