

yardmax™  
rechargeable  
in-ground fence™  
receiver collar  
operating guide

Model Number  
PIG00-11116



protect. teach. love.™

PLEASE READ THIS ENTIRE GUIDE BEFORE BEGINNING



Thank you for choosing PetSafe® brand. You and your pet deserve a companionship that includes memorable moments and a shared understanding together. Our products and training tools promote a lifestyle of protection, teaching, and love — essentials that influence memories for a lifetime. If you have any questions about our products or training your pet, please visit our website at [www.petsafe.net](http://www.petsafe.net) or contact our Customer Care Center at 1-800-732-2677.

To get the most protection out of your warranty, please register your product within 30 days at [www.petsafe.net](http://www.petsafe.net). By registering and keeping your receipt, you will enjoy the product's full warranty and should you ever need to call the Customer Care Center, we will be able to help you faster. Most importantly, we will never give or sell your valuable information to anyone. Complete warranty information is available online at [www.petsafe.net](http://www.petsafe.net).

# Important Safety Information

## Explanation of Attention Words and Symbols used in this guide



This is the safety alert symbol. It is used to alert you to potential personal injury hazards. Obey all safety messages that follow this symbol to avoid possible injury or death.

### **⚠️ WARNING**

WARNING indicates a hazardous situation which, if not avoided, could result in death or serious injury.

### **⚠️ CAUTION**

CAUTION, used with the safety alert symbol, indicates a hazardous situation which, if not avoided, could result in minor or moderate injury.

### **CAUTION**

CAUTION, used without the safety alert symbol, indicates a hazardous situation which, if not avoided, could result in harm to your pet.

### **NOTICE**

NOTICE is used to address safe use practices not related to personal injury.

---

### **⚠️ WARNING**

- Not for use with aggressive dogs. Do not use this product if your dog is prone to aggressive behavior. Aggressive dogs can cause severe injury or death to their owners and others. If you are not sure that this product is right for your dog, please talk to your veterinarian or a certified trainer.

## CAUTION

This PetSafe® In-Ground Fence™ is not a solid barrier. This system is designed to act as a deterrent to remind dogs by Static Correction to remain in the boundary established. It is important that you reinforce training with your dog on a regular basis.

Proper fit of the collar is important. A collar worn for too long or made too tight on the dog's neck may cause skin damage. Ranging from redness to pressure ulcers; this condition is commonly known as bed sores.

- Avoid leaving the collar on the dog for more than 12 hours per day.
- When possible reposition the collar on the dog's neck every 1 to 2 hours.
- Check the fit to prevent excessive pressure; follow the instructions in this manual.
- Never connect a lead to the electronic collar; it will cause excessive pressure on the contacts.
- When using a separate collar for a lead, don't put pressure on the electronic collar.
- Wash the dog's neck area and the contacts of the collar weekly with a damp cloth.
- Examine the contact area daily for signs of a rash or a sore.
- If a rash or sore is found, discontinue use of the collar until the skin has healed.
- If the condition persists beyond 48 hours, see your veterinarian.
- For additional information on bed sores and pressure necrosis, please visit our website.

## CAUTION

These steps will help keep your pet protected and comfortable. Millions of dogs are comfortable while they wear stainless steel contacts. Some dogs are sensitive to contact pressure. You may find after some time that your dog is very tolerant of the collar. If so, you may relax some of these precautions. It is important to continue daily checks of the contact area. If redness or sores are found, discontinue use until the skin has fully healed.

You may need to trim the hair in the area of the Contact Points. Never shave the dog's neck; this may lead to a rash or infection.

- The Receiver Collar should not be on your dog when the system is tested. Your dog may receive an unintended correction.
- The Boundary Width of the system must be tested whenever an adjustment is made to the Pet Area to prevent unintended corrections to your dog.
- Do not change transmitter setting from Traditional mode (B) to YardMax™ mode (A) without verifying that the Receiver Collar will still contain your pet.
- If you use a collar and leash for training, be sure the extra collar does not put pressure on the contact points.
- Always remove your dog's Receiver Collar before performing any Fence Transmitter testing.
- If possible, DO NOT use an AC circuit protected with a Ground Fault Circuit Interrupter (GFCI) or Residual Current Device (RCD). In rare cases, nearby lightning strikes may cause the GFCI or RCD to trip. Without power your dog may be vulnerable to escape. You will have to reset the GFCI or RCD to restore power to the system.

## **NOTICE**

- Do not charge your Receiver Collar every night. Charging too often can reduce battery life. Charge your Receiver Collar when the Receiver Indicator Light blinks yellow; or when the light blinks red.
- To prevent an unintended correction, after the Boundary Flags have been placed, be sure to set the Static Correction on the Receiver Collar back to level 1 tone only.

# How the System Works

The YardMax™ Fence Transmitter sends a radio signal through a buried wire, marking the boundaries you wish to set for your dog. Your dog wears a Receiver Collar that detects the signal at the boundary. The Receiver Collar offers 5 levels of correction plus tone-only, adjustable to your dog's temperament. The Fence Transmitter operates in two modes: YardMax™ or Traditional.

In YardMax™ mode, the Receiver Collar issues a warning tone when your dog crosses the Boundary Wire. If your dog continues beyond the boundary, the Receiver Collar issues a correction to persuade your dog to return to the Pet Area. Even if your dog continues beyond the Static Correction Zone, the Receiver Collar continues correction giving your dog the perception of an endless boundary. The YardMax™ mode is ideal for small yards as it allows your dog use of up to 30% more of the Pet Area.

In Traditional Mode, the Receiver Collar issues a warning tone when your dog approaches the Boundary Wire entering the Warning Zone. If your dog continues further, he will receive a safe but startling Static Correction. While harmless, the correction will persuade him to stay in the Containment Area you've established.

The PetSafe® YardMax™ Rechargeable In-Ground® Fence™ has been proven safe, comfortable and effective for dogs over 5 pounds.



## YardMax™ Mode Boundary

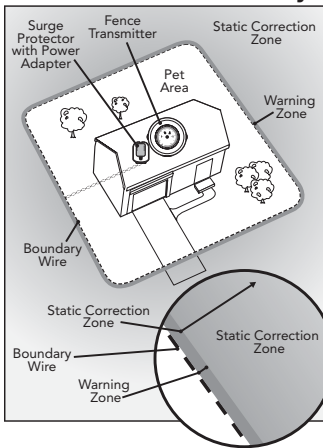

## Traditional Mode Boundary

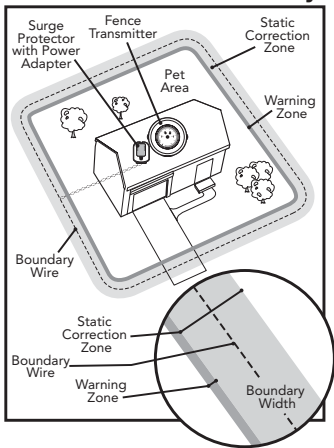

# Key Definitions

**Receiver Collar:** Detects the radio signal in the Boundary Wire issuing warning or correction as necessary.

**Receiver Collar Charger:** Charges the batteries inside the Receiver Collar.

**Pet Area:** Area within the boundary wire where your dog can roam freely.

**Warning Zone:** Outer edge of the Pet Area where the Receiver Collar warns your dog not to go into the Static Correction Zone.

**Static Correction Zone:** Area beyond the Warning Zone where your dog's Receiver Collar emits a correction, signaling him to return to the Pet Area.

**Boundary Width:** The area on each side of the boundary wire within range of the radio signal.

**Receiver Indicator Light:** Reflects the battery status and correction type.

**Contact Points:** Deliver the correction when your dog moves into the Static Correction Zone.

**Mode Button:** Turns Receiver ON/OFF and adjusts the level of Static Correction your pet receives in the Static Correction Zone.

## Receiver Collar

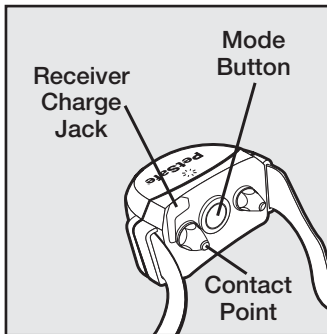
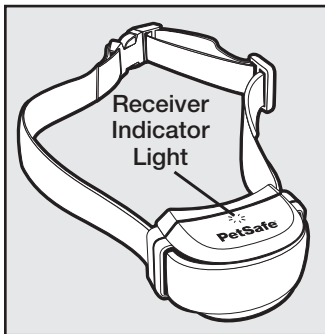

# Operating Guide

## Step

# 1

## Charge the Receiver Collar

1. Lift the rubber cover protecting the Receiver Charging Jack.
2. Connect the Receiver Collar Charger connector to the Receiver Charging Jack. *Note: The connector only fits one way, do not force it into the Charging Jack.*
3. Plug the Receiver Collar Charger into a standard AC wall outlet. The Receiver Collar light will glow red when the charger is properly seated and charging.
4. Charge the Receiver Collar for 2-3 hours. The light will turn green when charging is complete. A built in safety circuit prevents the Receiver Collar from overcharging.
5. After charging, replace the rubber cover to protect the Receiving Charging Jack.

*Each charge can last up to three months depending on frequency of use.*

## NOTICE

Do not charge your Receiver Collar every night. Frequent charging can have a negative effect on the battery. We recommend that the Receiver Collar be used until the Receiver Indicator Light blinks yellow or red.

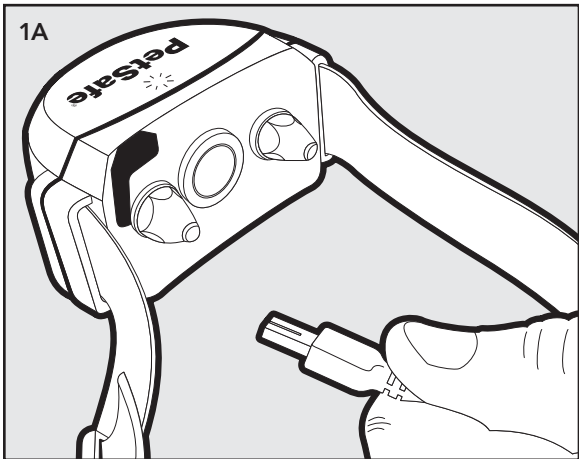

# Step 2

## Prepare the Receiver Collar

Your Receiver Collar comes with short Contact Points installed. Use the long Contact Points for dogs with long or thick hair. Tighten the Contact Points using the Contact Point Wrench (2A). Check the tightness weekly. The Receiver Collar is waterproof.

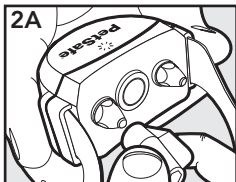

## To Turn On the Receiver Collar

Press and hold the Mode Button for 1 second (2B). The green or yellow or red Receiver Indicator Light will turn ON for 5 seconds (2B) to indicate battery status, followed by the red Receiver Indicator Light flashing the Static Correction Level.

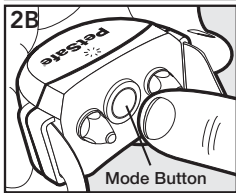

## To Turn off the Receiver Collar

Press and hold the Mode Button continuously for 5 seconds. The red Receiver Indicator Light will be ON during this time. The red Receiver Indicator Light will then turn OFF and all Receiver Indicator Lights will stay OFF indicating that the unit is turned OFF. To extend the time between charging the Receiver Collar, consider turning OFF the Receiver Collar when it is not in use.

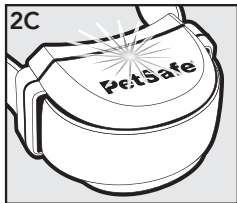

## Receiver Collar Status Indicators

The Receiver Collar Status Indicator Light along with the alarm tones are used to determine the operational mode, the battery status, and the correction type. Refer to the Receiver Collar Status Indicator Table on page 16 to understand the status lights and tones for the Receiver Collar. During normal operation, the Receiver Collar Indicator Light will flash every 4 seconds to indicate the battery status as shown in the table on page 16.

# Receiver Collar Status Indicator Table

Status Light	Alarm Tone	Condition
<b>While Plugged Into Receiver Charger</b>		
Solid Red	No Tone	Charge in progress
Solid Green	No Tone	Charge complete
No Light	No Tone	Charge failure, contact Customer Care Center
<b>After Removing From Charger Or Turning On Performs ReadyTest®</b>		
Off (1 second)	No Tone	Unit is performing ReadyTest®
Continuous Green or Yellow or Red (5 seconds)	No Tone	Battery Charge Indicator
Continuous Red	20 sec.	ReadyTest® failure; unit is not operational, contact Customer Care Center
<b>Static Correction Report Level</b>		
Flashing Red from 1 to 6 times	No Tone	Receiver Collar is reporting Static Correction level from 1 to 6



<b>PerfectFit™ Test</b>		
Flashing Yellow (every 1 second)	No Tone	Unit is in PerfectFit™ mode for 90 sec. after turning on
Flashing Green (every 1 second)	Chime; 5 consecutive chimes for confirmed fit	PerfectFit™ mode indicates collar is making true contact with dog's skin
<b>Receiver Activation Status</b>		
Fast Pulsating Green	Warning Tone	Warning tone
Fast Pulsating Red	Duration of the Correction	Static Correction being delivered (up to 10 sec.)
Continuous Green (10 seconds)	No Tone	Over Correction Protection; collar locked for 10 sec.
Slow Blinking Green (every 4 seconds)	No Tone	Collar battery charge 100% - 60%
Slow Blinking Yellow (every 4 seconds)	No Tone	Collar battery charge 60% - 20%
Slow Blinking Red (every 4 seconds)	No Tone	Collar battery charge 20% or less; charge immediately

## ReadyTest® Feature

ReadyTest® gives you added confidence that the Receiver Collar is working and ready to use. When you remove the Receiver Collar from the charger, or turn the Receiver Collar ON, the Receiver Collar will automatically go into self-test mode for approximately 8 seconds. The receiver's internal diagnostics will check that the battery charge is full and that all circuits are working correctly.

**Do not touch the Contact Points while the Receiver Collar is in test mode.** When the collar is removed from the charger, or turned on, the indicator light will go off for 1 second. The indicator light will come back on for five seconds to indicate the status of the battery (green, yellow or red). The ReadyTest™ is complete once you see the battery indicator status.

If the Receiver Collar beeps and the indicator light glows solid red for 20 seconds, the ReadyTest® has detected a problem. Turn the Receiver Collar on and repeat the test. If the Receiver Collar continues to fail the ReadyTest®, call the Customer Care Center.

## **PerfectFit™ Test for Collar Fit**

This test is an added feature to verify fit but is not required for the system to function. After the ReadyTest®, the Receiver Collar will go into PerfectFit™ test mode. This mode begins with a flashing yellow light. To use this feature, you must place the Receiver Collar on your dog within 90 seconds of disconnecting the charger from the Receiver Charging Jack or turning the Receiver Collar ON. The Receiver Collar will emit an alarm tone as the Contact Points touch your dog's skin. You will know you have the proper fit when the collar tones and flashes green 5 consecutive times. After 90 seconds, the Receiver Collar moves into normal operation mode.

## **Set the Static Correction Level**

The Static Correction levels increase in strength from 1 to 6. Refer to the table on page 20 to choose the Static Correction that best fits your dog. The Receiver Collar will emit a Warning Tone whenever your dog enters the Warning Zone, no matter what correction level is selected. If your dog continues into the Static Correction Zone, and the Receiver Collar is set to level 2 or above, your dog will receive a correction.

1. Press the Mode Button and release (**2B**) when the Receiver Indicator Light illuminates Red (**2C**).
2. The Receiver Indicator Light will emit a series of Red Flashes representing the Static Correction Level.
3. Increase the Static Correction Level by pressing and releasing the Mode Button within 5 seconds of the previous series of flashes.

## Static Correction Level Table

Indicator Light	Static Correction Level	Receiver Collar Function	Dog Temperment
1 flash	1	No Static Correction, Tone only	Initial Training Mode
2 flashes	2	Low Static Correction	Timid
3 flashes	3	Medium-Low Static Correction	Timid or Average
4 flashes	4	Medium Static Correction	Average Energy
5 flashes	5	Medium-High Static Correction	Average or High Energy
6 flashes	6	High Static Correction	High Energy

## **Anti-Linger Prevention**

The Anti-Linger Prevention feature keeps your dog from staying in the Warning Zone for long periods of time and draining the Receiver Collar rechargeable battery. Your dog will hear a two second warning tone when he reaches the Warning Zone. If your dog does not return to the Pet Area after two seconds, he will receive a continuous Static Correction until he returns to the Pet Area.

## Run Through Prevention

In YardMax™ mode when your dog crosses over the wire and passes the Warning Zone, Static Correction is activated at a variable distance dependent on the height of the dog and the height of the Receiver activation distance setting. For example, a dog 2.5 feet tall with activation height 1.5 feet above his neck would detect a warning tone distance of about 2.5 feet before Run-Through Prevention would occur.

In Traditional Mode, this system includes a unique “run-through” prevention so that your dog cannot escape the Pet Area without receiving an increased level of Static Correction. The Receiver Collar automatically increases the Static Correction when your dog continues more than 20% of the way through the Warning Zone.

For example, if the signal is detected 10 feet from the wire and your dog enters the Static Correction Zone, this feature is activated when he is approximately 8 feet from the Boundary Wire. Your dog will then receive a Static Correction that is at an increased level corresponding to the Static Correction level setting on the Receiver Collar.

## **Over Correction Protection**

YardMax™ mode: In the unlikely event that your pet “freezes” or continues beyond the boundary, the Static Correction duration continues for 15 seconds. The Receiver Collar locks out further Static Correction and the green light will remain on for 10 seconds. The Receiver Collar remains locked out until the pet re-enters the Pet Area.

Traditional Mode: In the unlikely event that your pet “freezes” in the Static Correction Zone, this feature limits the Static Correction duration to 15 seconds. While the Receiver Collar locks out further Static Correction, the green light will remain on for 10 seconds.

# Step 3

## Fit the Receiver Collar

**Important:** The proper fit and placement of your Receiver Collar is important for effective training. The Contact Points must have direct contact with your pet's skin on the underside of his neck. See important safety information on pages 5 to 7.

To assure a proper fit, please follow these steps:

1. Make sure the Receiver Collar is turned off.
2. Start with your dog standing comfortably (3A).
3. Place the Receiver Collar on your pet so that the "PetSafe®" logo is right side up and the receiver is directly under your dog's chin. Center the Contact Points underneath your dog's neck, touching the skin (3B).

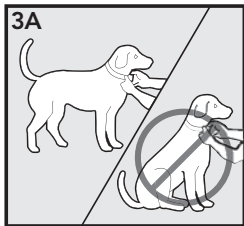

### CAUTION

You may need to trim the hair in the area of the Contact Points. Never shave the dog's neck; this may lead to a rash or infection.



4. Check the tightness of the Receiver Collar by inserting one finger between the end of a Contact Point and your pet's neck. The fit should be snug but not constricting.
5. Allow your dog to wear the collar for several minutes, then recheck the fit. Check the fit again as your dog becomes more comfortable with the Receiver Collar.
6. Once you are satisfied with the fit of the Receiver Collar then you may trim any excess collar strap as follows (3C).

- a. Mark the desired length of the Receiver Collar with a pen. Allow for growth if your pet is young or grows a thick winter coat.

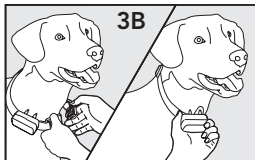

- b. Remove the Receiver Collar from your pet and cut off the excess.

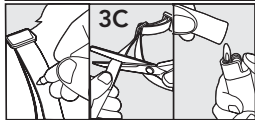

- c. Before placing the Receiver Collar back onto your pet, seal the edge of the cut collar by applying a flame along the frayed edge.

Replacement collar straps are available through the Customer Care Center.

## To Re-Thread the Collar

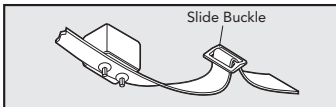

The slide buckle prevents the collar from becoming loose around your pet's neck.

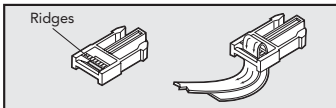

The ridges must be facing up; the collar will slip if it is not properly threaded.

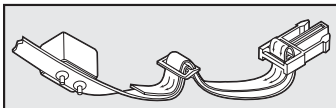

## Check the Fit using PerfectFit™ Test

1. To check the fit of the Receiver Collar using the PerfectFit™ test, connect the Receiver Charging Jack to the charger for 5 seconds.
2. Disconnect the charger and wait approximately 8 seconds for the collar to go through the ReadyTest®. Do not touch the Contact Points during the ReadyTest®.
3. Place the collar on your pet and adjust the tightness. The Receiver Collar will emit a tone as the Contact Points touch your dog's skin. You will know you have the proper fit when the collar chimes and flashes green 5 consecutive times.
4. After 90 seconds, the Receiver Collar moves into normal operation mode. If you do not hear the 5 consecutive chimes, tighten the collar and repeat the PerfectFit™ Test.

*If you are adding a new pet to your system, and they are taller than any other pet from the initial installation, it will be important to test the Transmitter setting with their Receiver Collar. Please refer to Step 8 in the YardMax™ Rechargeable In-Ground Fence Operating and Training Guide.*

# Taking Your Pet Out of the Pet Area

**Important:** Remove the Receiver Collar and leave it in the Pet Area.

Once your pet learns the Boundary Zone, he will be reluctant to cross it for walks or car rides.

**Option 1:** Replace the Receiver Collar with a regular collar. Put your pet in a car that is within the Pet Area and drive him out of the Pet Area.

**Option 2:** Replace the Receiver Collar with a regular collar and leash. Walk your pet out of the Pet Area while giving a command such as "OK" at a specific place of the Boundary Zone (the end of your driveway, sidewalk, etc.). Always leave the Pet Area with a leash at this place and your pet will associate leaving the Pet Area only on a leash, only at this place, and only with a person. You may initially need to convince your pet to leave the Pet Area with a food treat and lots of praise.



*Note: You may also carry your pet out of the Pet Area.*

# Working with PetSafe® Pawz Away® Pet Barriers

Your YardMax™ Receiver Collar also works with our Pawz Away® deterrence products to keep your pet away from areas inside or outside your home.

The Pawz Away® Mini Pet Barrier (part number PWF00-14040) transmits an elliptical radio signal adjustable up to 5 feet. Pinpoint off limit areas for pets indoors or outdoors with this discreet battery operated, waterproof barrier (4A).

The Pawz Away® Indoor Pet Barrier (part number ZND-1000) protects many areas inside your home and can teach your pet to stay off of furniture, away from trash or out of certain rooms. The small, battery operated Indoor Barrier fits discreetly inside your home and protects a circular area up to 12 feet in diameter (4B).

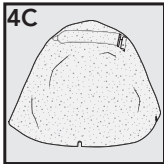
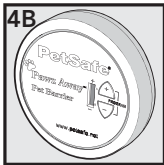
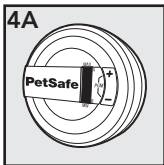

The Pawz Away® Outdoor Pet Barrier (part number RFA-378) teaches your pet to avoid areas in your landscape. The waterproof and battery operated Outdoor Barrier is disguised as a rock to blend into your landscape. It can wirelessly protect a circular area up to 16 feet in diameter or protect a custom shaped area using up to 150 feet of Boundary Wire **(4C)**.

The Pawz Away® Pet Barriers are easy to operate and you can use more than one to protect multiple areas. Purchase the Pawz Away® Pet Barriers by visiting our website at [www.petsafe.net](http://www.petsafe.net) or by calling the Customer Care Center.

## Additional Information

- The system should only be used with healthy pets. Contact your veterinarian if you have concerns about the medical condition of your pet (medication, pregnant, heart conditions, etc.).
- The PetSafe® YardMax™ Rechargeable In-Ground Fence™ is for residential use only.
- The Static Correction will get your pet's attention, but will not cause harm. It is designed to startle, not to punish.
- Remove the Receiver Collar from your pet when indoors for the comfort of your pet.
- Never leave the Receiver Collar on your pet for more than 12 consecutive hours.

# Troubleshooting

**Receiver Collar is not beeping or correcting.**

- Make sure the Receiver Collar is turned ON and the battery status lights are flashing every 4 seconds.
- Charge the Receiver Collar and go through the ReadyTest® and PerfectFit™ diagnostic tests.
- Check that the Fence Transmitter Power is turned ON and the transmitter status light is solid green. If not, refer to YardMax™ Rechargeable In-Ground Fence Operating Guide.

**The Receiver Collar is beeping, but the pet is not responding to the Static Correction.**

- Make sure Static Correction is set at 2 or higher.
- Test the Receiver Collar with the Test Light walking over the Boundary Wire.
- If the Test Light flashes, check the fit of the Receiver Collar using the PerfectFit feature.
- Trim your pet's fur where the Contact Points touch the neck or use the long Contact Points.
- Increase the Static Correction Level.
- Repeat training steps to reinforce training.



<p><b>In YardMax™ mode, the Receiver Collar corrects when the pet returns to the Pet Area.</b></p>	<ul style="list-style-type: none"> <li>• Check the YardMax Fence Mode (A/B) Switch is set to A.</li> <li>• Reverse the wires connected to the Fence Transmitter. Leave surge protector alone.</li> <li>• Re-test the boundary.</li> </ul>
<p><b>The Receiver Collar has to be held on top of the Boundary Wire to activate.</b></p>	<ul style="list-style-type: none"> <li>• Charge the Receiver Collar.</li> <li>• (Traditional Mode only) Adjust Boundary Width Dial clockwise to increase the distance from the Boundary Wire that the Receiver Collar activates. Recommended distance is 10 ft. from Boundary Wire.</li> <li>• If using a Double Loop, make sure Boundary Wires are separated by at least 5 feet.</li> <li>• If the Receiver Collar still has to be held on top of the Boundary Wire, refer to YardMax Rechargeable In-Ground Fence Operating Guide.</li> </ul>
<p><b>The Receiver Collar activates inside the house.</b></p>	<ul style="list-style-type: none"> <li>• Make sure the Boundary Wire is not running within 15 feet of the house. The signal can transmit through the walls of your house.</li> <li>• Make sure Boundary Wires are twisted from Boundary to the Fence Transmitter.</li> <li>• (Traditional Mode only) Turn the Boundary Width Dial to decrease the distance from the Boundary Wire that the Receiver Collar activates.</li> </ul>

**Receiver Collar is not charging.**

- Check that the charger is properly seated into the Receiver Collar Jack.
- If the Indicator Light on the Receiver Collar still does not glow red when connected to charger, there is a problem with the charger. If the Indicator Light glows red when placed on the charger but goes out after disconnecting the Receiver Collar without performing the ReadyTest® there is a problem with the Receiver Collar. Call the Customer Care Center.

**The Receiver Collar has injured my pet's neck.**

- Failing to follow the important safety information at the front of the Operating Guide has caused pressure ulcers. Some descriptions of advanced pressure ulcers describe the sores as looking like burns on the dog's neck. Be assured that electronic collars do not use enough energy to create electrical burns. The energy in an output pulse is only a few thousandths of a Joule; it is similar in nature to the static pulse that you may feel when getting out of your car. In some cases, pressure ulcers are described as chemical burns. The battery in your Receiver Collar is sealed, in addition, your collar's housing is also sealed. This redundant sealing makes it virtually impossible, without misuse or abuse, for your Receiver Collar battery to leak onto your pet's neck. Please review and follow the important safety information on pages 5-7, and the instructions in Step 3 under the heading "Fit the Receiver Collar" on pages 24-25.

# Test Light Instructions

1. Make sure the Receiver Collar battery is properly charged. Set the Correction Level to 2 or above.
2. Hold the Test Light Contacts to the Contact Points (5A).
3. Walk toward the Boundary Wire with Contact Points pointing up and holding the Receiver Collar at your pet's neck level (5B) until the Receiver Collar tones and the Test Light flashes (5C).

*Note: The Receiver Collar is waterproof, which can make the tone hard to hear.*

Save Test Light for future testing.

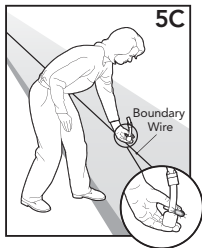
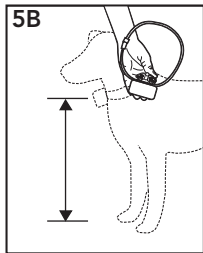
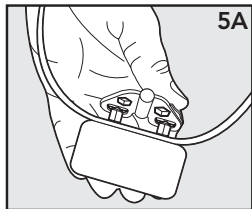

# Terms of Use and Limitation of Liability

## 1. Terms of Use

This Product is offered to you conditioned upon your acceptance without modification of the terms, conditions and notices contained herein. Usage of this Product implies acceptance of all such terms, conditions, and notices.

## 2. Proper Use

This Product is designed for use with pets where training is desired. The specific temperament of your pet may not work with this Product. We recommend that you not use this Product if your pet is less than 5 pounds or if your pet is aggressive. If you are unsure whether this is appropriate for your pet, please consult your veterinarian or certified trainer.

Proper use includes reviewing the entire Guide provided with your Product and any specific Caution statements.

### **3. No Unlawful or Prohibited Use**

This Product is designed for use with pets only. This pet training device is not intended to harm, injure or provoke. Using this Product in a way that is not intended could result in violation of Federal, State or local laws.

### **4. Limitation of Liability**

In no event shall Radio Systems Corporation® be liable for any direct, indirect, punitive, incidental, special or consequential damages, or any damages whatsoever arising out of or connected with the use or misuse of this Product. Buyer assumes all risks and liability from the use of this Product.

### **5. Modification of Terms & Conditions**

Radio Systems Corporation® reserves the right to change the terms, conditions and notices under which this Product is offered.

# Compliance

## FCC/Canada

This Class B digital apparatus complies with Canadian ICES-003. This equipment has been tested and found to comply with the limits for a Class B digital device, pursuant to Part 15 of the FCC Rules. These limits are designed to provide reasonable protection against harmful interference when the equipment is operated in a residential environment. This equipment generates, uses, and can radiate radio frequency energy and, if not installed and used in accordance with the instruction guide, may cause harmful interference to radio communications. However, there is no guarantee that interference will not occur in a practical installation. If this equipment causes harmful interference to radio or television reception, which can be determined by turning the equipment off and on, the user is encouraged to try to correct the interference by one or more of the following measures:

- Relocate the interfered receiving antenna.
- Increase the separation between the equipment and receiver.
- Connect the equipment into an outlet on a circuit different to that to which the receiver is connected.
- Contact the Customer Care Center.

This device complies with Industry Canada Rules. This device complies with part 15 of the FCC Rules. Operation is subject to the following two conditions: (1) This device may not cause harmful interference, and (2) this device must accept any interference received, including interference that may cause undesired operation.

Unauthorized changes or modifications to the equipment, not approved by Radio Systems Corporation®, could result in not meeting compliance with FCC regulations and could void the user's authority to operate the equipment.

## **Australia**

This device complies with the applicable EMC requirements specified by the ACMA (Australian Communications and Media Authority).



# Customer Care International

Canada - Tel: 800-732-2677

Monday - Friday 8 AM - 8 PM / Saturday 9 AM – 5 PM

Australia - Tel: 1800 786 608

Monday - Friday 8:30 AM - 5 PM

New Zealand - Tel: 0800 543 054

Monday - Friday 10:30 AM - 7 PM

This product has the benefit of a limited manufacturer's warranty. Details of the warranty applicable to this product and its terms can be found at [www.petsafe.net](http://www.petsafe.net) and/or are available by sending a stamped addressed envelope to PetSafe® Ltd. Redthorn House, Unit 9, Chorley West Business Park, Ackhurst Road, Chorley, Lancashire PR7 1NL, United Kingdom.

# Warranty

## One Year Non-Transferrable Limited Warranty

This Product has the benefit of a limited manufacturer's warranty. Complete details of the warranty applicable to this Product and its terms can be found at [www.petsafe.net](http://www.petsafe.net).

**Australia/New Zealand - In compliance with the Australian Consumer Law, Warranties Against Defects, effective January 1, 2012, warranty details of this Product are as follows:**

## One Year Non-Transferrable Limited Warranty

What is covered: Radio Systems Australia Pty Ltd (hereinafter referred to as "Radio Systems") warrants to the original retail purchaser, and not any other purchaser or subsequent owner, that its Product, when subject to normal and proper residential use, will be free from defects in material or workmanship for a period of one (1) year from the purchase date. An "original retail consumer purchaser" is a person or entity who originally purchases the Product, or a gift recipient of a new Product that is unopened and in its original packaging. When serviced by Radio Systems Customer Service, Radio Systems covers labor and parts for the first year of ownership; after the first year, a service or upgrade charge will apply relative to replacement of the Product with new or refurbished items at Radio System's sole discretion.

The limited warranty is non-transferrable and shall automatically terminate if the original retail consumer purchaser resells the Radio Systems Product or transfers the property on which the Radio Systems Product is installed. This Limited Warranty excludes accidental damage due to dog chews; lightning damage; or neglect, alteration, and misuse. Consumers who purchase Products outside of Australia, New Zealand, or from an unauthorized dealer will need to return the Product to the original place of purchase for any warranty issues.

Please note that Radio Systems does not provide refunds, replacements, or upgrades for change of mind, or for any other reason outside of these Warranty terms.

Radio Systems® Corporation  
10427 PetSafe Way  
Knoxville, TN 37932  
1-800-732-2677  
[www.petsafe.net](http://www.petsafe.net)

Protected by US Patents 6,184,790; 6,327,999; 6,459,378;  
6,807,720; 7,046,152; 7,068,174; 7,117,822; 7,204,204;  
7,345,588; 7,394,390; 8,047,161; and 8,342,135.

400-003

©2013 Radio Systems Corporation