

Thermasheath®-3: Insulation for the Building Envelope

Roofing Application

Thermasheath®-3 is laid over a suitable roof deck such as tongue-and-groove timber, plywood or metal deck and covered with a suitable layer of plywood, wafer board or OSB. Asphalt or wood shingles, concrete or clay tiles or a standing seam metal roof may be installed over the insulated roof deck according to the roofing system instructions. NOTE: It may not be necessary to cover the insulation with a nailable surface when used under a standing seam metal roof assembly, consult manufacturer for details.

Refer to Thermasheath®-3 data sheet for additional application/installation, compliances, thermal and physical properties, limitations and warnings.

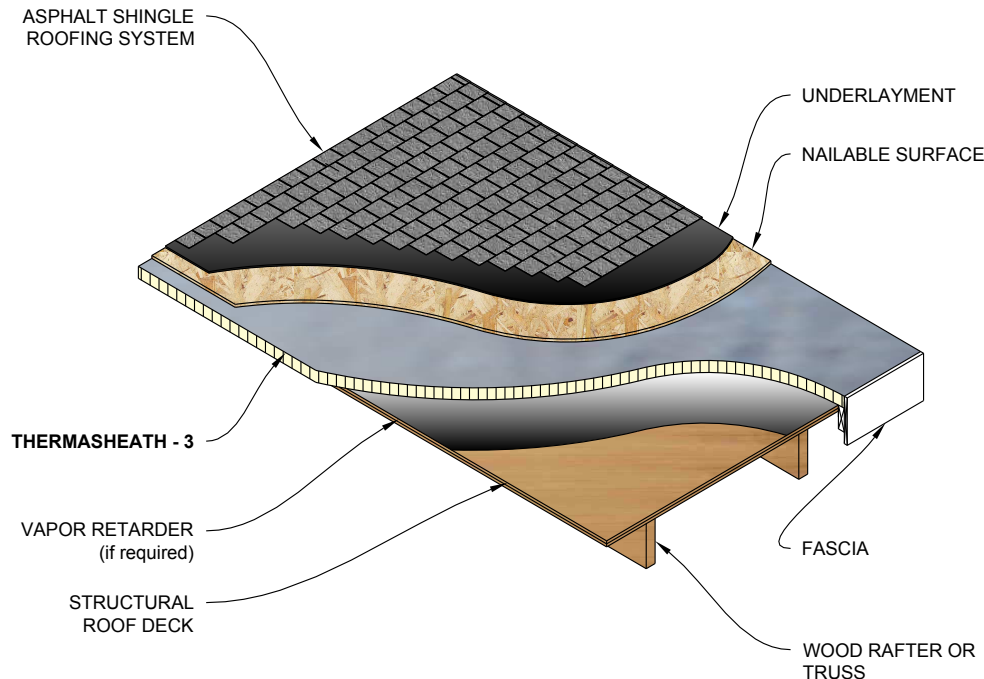

Notes:

1. Consult shingle manufacturer for above deck roofing ventilation requirements.
2. Refer to local code for requirement of thermal barrier.

*Warranty: See Rmax "Sales Policy" and "Fifteen Year Limited Thermal Warranty" for terms and conditions. Rmax does not assume any responsibility or liability for the performance of any products other than those manufactured by Rmax. **NOTE: All Rmax products must be tarped, placed on skids and kept dry before and throughout construction.***