

# Hunter Panels Xci Foil (Class A)

Class A Polyisocyanurate Insulation Manufactured On-Line to Reinforced Foil Facers for Exterior Commercial Wall Applications

## Xci Foil (Class A) Thermal Values

Thickness (inches)	Thickness (mm)	R-Value
1.0	25	6.3
1.5	38	9.5
1.6	41	10.1
2.0	51	13.0
2.5	64	16.0
3.0	76	19.0
3.5	89	22.0
4.0	102	25.2

Thermal values as per ASTM C 518 in accordance with ASTM C 1289.

## HUNTER PANELS Xci FOIL (CLASS A)

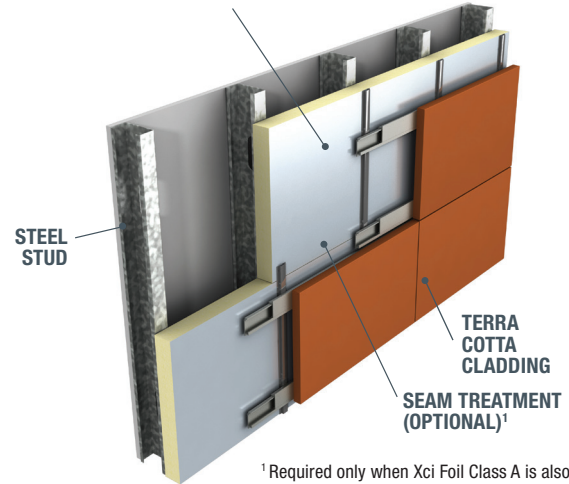

## Description

Xci Foil (Class A) is an energy efficient rigid insulation panel composed of a closed cell Class A polyisocyanurate foam core manufactured on-line to 15 mil reinforced foil facers on both sides. It is designed for use in commercial wall applications to provide continuous insulation and weather resistive barrier performance within the building envelope.

## Features and Benefits

- Polyiso offers increased R-value per inch vs mineral fiber, XPS or EPS options
- Designed for use in continuous insulation to assist in meeting the most current ASHRAE 90.1, IECC, IBC and IRC standards
- Manufactured with NexGen Chemistry: Zero Ozone Depleting Potential (ODP); Contains no CFCs, HCFCs or HFCs; Virtually zero Global Warming Potential (GWP). Use of Xci products helps reduce the carbon footprint of buildings.
- Can be installed directly on steel studs in a variety of wall assemblies without the need for gypsum sheathing
- Xci Foil (Class A) has been tested to meet air and water barrier requirements to provide all-in-one functionality when seams and penetrations are treated with approved materials
- Flame spread of <25 per ASTM E 84
- Provides R-Values from 6.3 to 25.2 in a single layer
- Superior fire performance, durability and dimensional stability

## Applications

- Provides continuous insulation (ci) for standard wood frame, FRT wood frame, steel stud, CMU and concrete exterior wall constructions
- Compatible with numerous claddings/finishes including masonry, fiber cement, stucco, terra cotta, mcm, metal, natural stone, stone aluminum

## Panel Characteristics

- ASTM C 1289 Type I, Class 1 Grade 2 (20 PSI) or Grade 3 (25 PSI)
- Available in 4' x 8' (1220mm x 2440mm) panels in thickness of 1" (25mm) – 4" (102mm)
- Other widths/lengths are available upon special request – (for example: 16" or 24" width)

## Codes and Compliances

- ASTM C 1289
- IBC Chapter 26 and IRC Section R316
- Numerous NFPA 285 compliant assemblies
- Numerous UL 263 hourly designs
- DRJ Technical Evaluation Report 1402-01
- ASTM E 2178 – less than 0.001 L (s·m<sup>2</sup>) at 75 Pa
- ASTM E 2357 – no leakage
- ASTM E 283 S – less than 0.04 cfm/ft<sup>2</sup>
- ASTM E 330 – less than 0.04 cfm/ft<sup>2</sup>
- ASTM E 331 – Pass, no leakage
- Miami Dade County Product Control Approved
- California Code of Regulations, Title 24, Insulation Quality Standard License #TI-1420
- California Bureau of Furnishings and Home Insulation
- CCMC 13460-L Type 3, Class 1
- CAN/ULC S-704 Type 1, Class 1

### LEED Potential credits for Polyiso use

- Energy and Atmosphere**
- Optimize Energy Performance
- Materials & Resources**
- Building Life-Cycle Impact Reduction
  - Environment Product Declaration
  - Material Reuse
  - 9% Pre-consumer Recycled Content
  - Construction and Demolition Waste Management
- Indoor Environmental Quality**
- Thermal Comfort

# Hunter Panels Xci Foil (Class A)

Class A Polyisocyanurate Insulation Manufactured On-Line to Reinforced Foil Facers for Exterior Commercial Wall Applications

## Typical Physical Property Data Chart

Property	Test Method	Value
Compressive Strength	ASTM D 1621	20 psi min.* (138 kPa, Grade 2)
Dimensional Stability	ASTM D 2126	2% linear change (7 days)
Moisture Vapor Permeance	ASTM E 96	<0.04 perm
Impact Resistance (Janka Ball Test)	ASTM C 1301	40
Service Temperature		-100° to 250° F (-73°C to 122°C)
Flame Spread Index (faced)	ASTM E 84	< 25
Smoke Developed (faced)	ASTM E 84	< 250
Recycled Content		9% pre-consumer

\*Also available in Grade 3 (25 psi)

## Installation

- Xci Foil (Class A) is not structural sheathing; exterior cladding must be attached through to the framing
- When Xci Foil (Class A) is being used as a WRB the seams must be treated with one of our approved options
- Always follow local codes for structural bracing
- Refer to local codes and practices for placement of the WRB in the wall assembly
- Follow cladding manufacturer's recommendation for attachment requirements
- Insulation installation may require separate fasteners or adhesives depending on the exterior cladding attachment
- Adhesives can be used for attachment to CMU, gypsum and concrete
- Metal furring strips can be installed on the exterior, fastened through the insulation to the structural wall to create a drainage plain
- Xci Foil (Class A) is compatible with most construction grade adhesives, sealants, caulks, tapes, and spray foams

## Post-Installation Exposure

During the time frame between installation of Xci Foil (Class A) and the application of the finished exterior cladding, it is recommended that a building wrap be applied to the Xci Foil (Class A). If a building wrap has not been specified, ALL UNFACED FOAM EXPOSED TO DIRECT DAYLIGHT (i.e. corners, window and door openings) should be taped with a compatible waterproof tape. When properly installed, Xci Foil (Class A) can remain uncovered up to 180 days. Please contact Hunter Panels for details.

## HUNTER PANELS XCI FOIL (CLASS A)

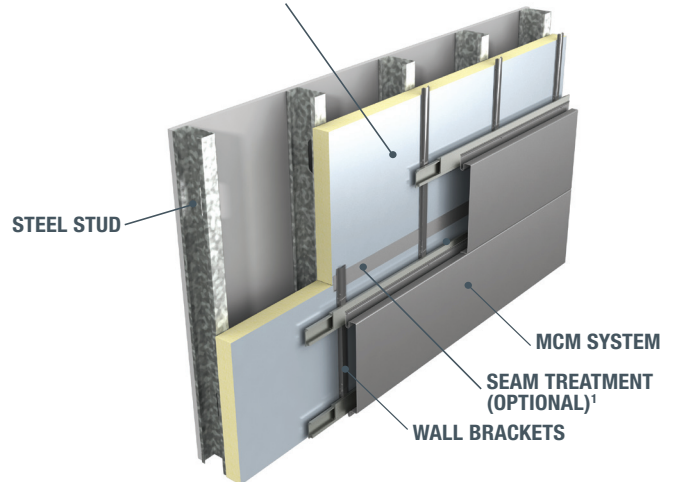

<sup>1</sup>Required only when Xci Foil (Class A) is also used as the WRB

## WRB

The incorporation of Weather Resistant Barriers (air, vapor and moisture) is a critical element of a wall assembly. A design professional familiar with local code requirements should specify the selection and placement of any WRB. Furthermore, it is recommended that a hygrothermal analysis of the proposed assembly be conducted to determine the type and location of a proposed WRB.

*Note: The NFPA 285 fire test is an assembly test. The performance of the WRB must also be considered. Please consult Hunter Panels for details and specifications.*

## Job-Site Storage

Good construction practice dictates that all insulations should be protected from moisture and direct sunlight during job-site storage. Pallets of Hunter Panels Xci Foil (Class A) are double packaged in a UV resistant polyethylene bag. This moisture resistant package is designed for protection from the elements during flat bed shipment from our factories to the job-site. Outdoor storage for extended periods of time requires waterproof tarpaulins and elevated storage above ground level a minimum of 2". Additionally, we recommend slitting the bundle packaging vertically down the center of the two short sides to prevent moisture accumulation within the package.

## Warnings and Limitations

Insulation must be protected from open flame. Hunter Panels will not be responsible for specific building design by others, for deficiencies in construction or workmanship, for dangerous conditions on the job site or for improper storage and handling. Technical specifications shown in this literature are intended to be used as general guidelines only and are subject to change without notice. Call Hunter Panels for more specific details.

