

PLANET OF THE VAPES
ONE

QUICK START GUIDE

COMPLETE GUIDE AT POTV.LIFE/ONE

ONE OVERVIEW

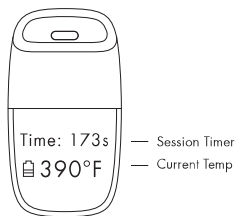
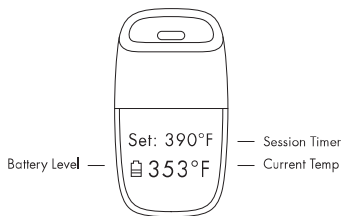

ONE OVERVIEW

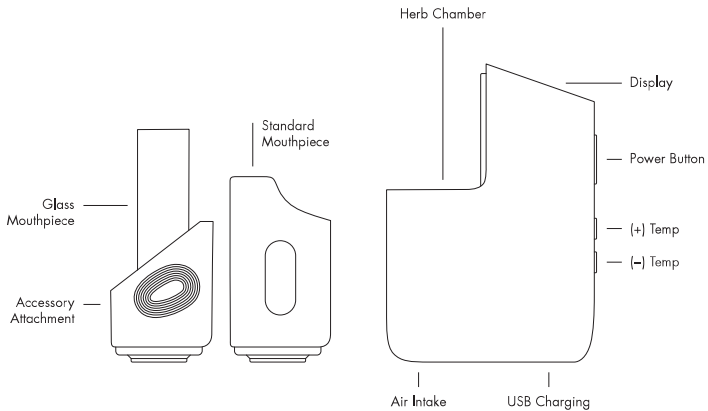

BEFORE USING ONE

CHARGING

1. Charge the ONE for two hours before your first use with the included micro-USB cable.
2. The battery icon will display as full when charging is complete.
3. Do not use it while it is charging.

BURN OFF

RUN A "BURN OFF" SESSION TO REMOVE ANY MANUFACTURING RESIDUE.

1. Turn the ONE on by pressing the power button three times quickly.
2. Set the temperature to maximum (430°F/221°C).
3. Let the ONE run until it shuts down.
4. Repeat steps 1–3 until any odors are gone.

ONE OPERATING GUIDE

GETTING STARTED

1. Remove the mouthpiece with a gentle pull. Do not push on the glass.
2. Dry herbs: Loosely fill the chamber with your ground herbal blend.
Concentrates: Insert the stainless steel mesh Extract Pad into the bottom of the chamber making sure it lies flat.
Then wipe, drip, or place your extract onto the center of the Extract Pad. Use a small amount at first, since large amounts can get messy.
3. Attach the mouthpiece.
4. Turn the ONE on by pressing the power button three times within two seconds. When it vibrates, it's on.
5. Set your favorite temperature with the plus or minus button. If you're new to vaporizing, try 390°F for dry herbs and 430°F for concentrates. Press and hold power and minus button simultaneously for 2 seconds to switch to °C.
6. The ONE will vibrate when it has reached your selected temperature. Time to vape!
7. Put the mouthpiece to your lips and inhale.
8. To turn the ONE off, press the power button three times within two seconds. It vibrates when it's off. It will automatically shut off after 4 minutes.

FOR THE COMPLETE GUIDE VISIT:

POTV.LIFE/ONE

ACCESSORY ATTACHMENT

VAPING WITH GLASS

The Planet of the Vapes ONE vaporizer comes with an accessory attachment which allows you to use different glass pieces to customize your vape experience.

Besides the included straight mouthpiece, we designed three different glass pieces to give you the vape experience you're looking for.

Bent Tube: For a cool, relaxed draw.

Water Pipe Adapter: To vape with your favorite glass.

Mini Bubbler: For water cooled vapor on-the-go.

Curved Mini Bubbler: Smoothest vapor with a relaxed style.

HOW ITS DONE

1. Attach the accessory attachment to the ONE
2. Insert the glass piece designed for the ONE
3. Enjoy vaping with glass!

ACCESSORY ATTACHMENT

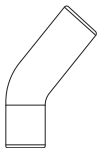

Bent Tube

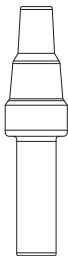

Water Pipe
Adapter (WPA)
10/14/18mm

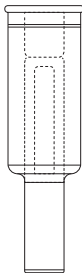

Mini
Bubbler

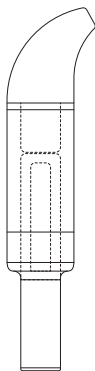

Curved
Mini Bubbler

FOR THE COMPLETE GUIDE VISIT:
POTV.LIFE/ONE

AND LEARN MORE ABOUT USING, CLEANING AND THE ADDITIONAL
FEATURES OF YOUR ONE VAPORIZER. ENJOY!