

ASSEMBLY AND INSTALLATION INSTRUCTIONS

SP56518

WARNING: BE SURE TO SHUT OFF POWER AT THE MAIN FUSE OR CIRCUIT BREAKER BOX BEFORE INSTALLING OR SERVICING THIS FIXTURE.

NOTE: 1. Before installing, consult local electrical codes for wiring and grounding requirements.
2. READ AND SAVE THESE INSTRUCTIONS.

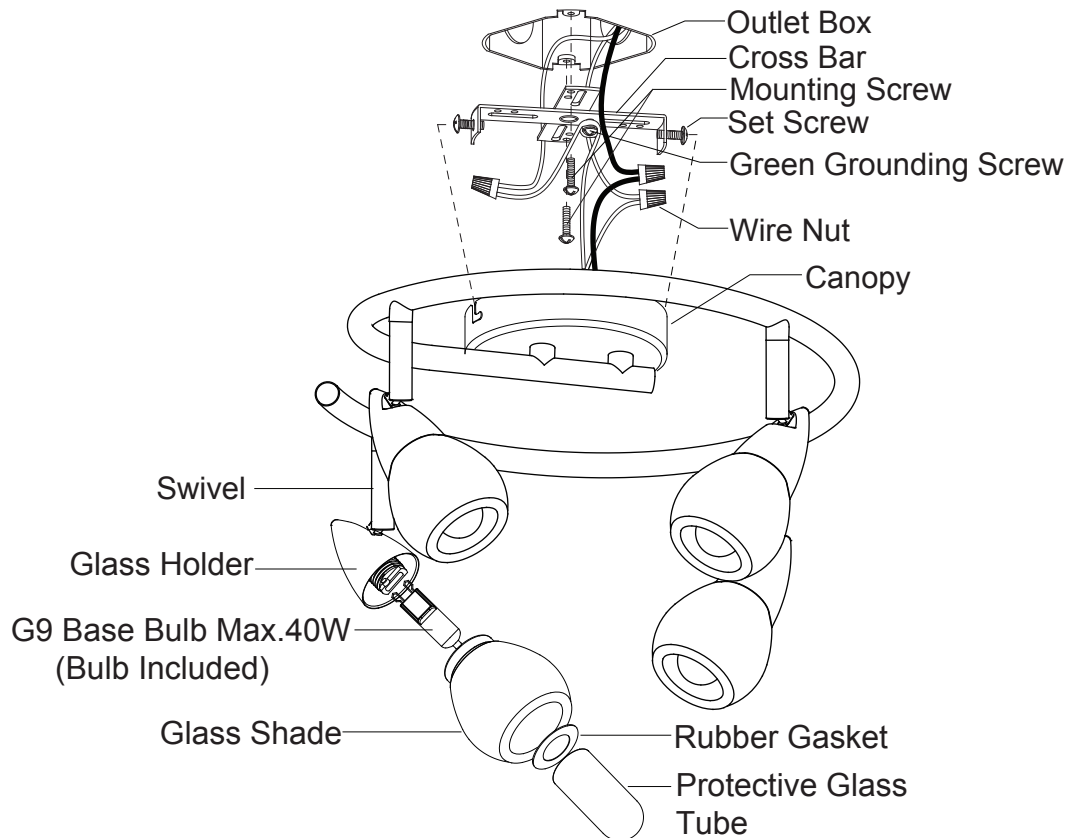

1. Attach the cross bar to the outlet box by using two mounting screws.
2. Pull out the outlet wires and house grounding wire from the outlet box. Make wire connections using the wire nuts:
 - The black wire from the fixture to the black wire from the power source.
 - The white wire from the fixture to the white wire from the power source.
 - The fixture grounding wire to the house grounding wire from the power source.Carefully put the wires back into the outlet box.
3. Attach the canopy to the cross bar by allowing two set screws to slide into the mating holes. Rotate the canopy clockwise until both screws from the cross bar drop into the slot recesses. Then tighten the set screws securely.
4. Insert the G9 bulbs into the sockets of the glass holders.
Caution: Turn off the power and allow the fixture to cool down completely before relamping the bulb.
5. Place the glass shades into the glass holders, and secure them using rubber gaskets and protective glass tubes.
Note: Adjust the fixture to a desired position by using the swivels.
6. Turn on the power at the main fuse or circuit breaker box.