

Camden

RF Controls



CM-RX-7

- One million unique transmitter codes pre-programmed at factory
- Auto-learn receivers accept from 10 to 480 codes
- 1, 2, 3, 4, or 5 channel handheld transmitters
- Fullsize or key chain formats
- Wireless keypad models
- Exclusive wall switch ready transmitter
- 5 Wire receiver with form c relay output
- IRM option for TX-7 & TX-8 improves accuracy of transmission



RX/TX Series

transmitters and receivers are ideal for varied commercial and handicap applications. Wireless operation eliminates the need to run wiring to the key switch or push button. Digital technology provides maximum range. Camden has full size and key chain transmitters, as well as wall-switch-ready and keypad models. Our receiver features the latest “push and learn” technology, and form C relay output. Camden exclusives include transmitter with Instant Response Module (pulse extender) and receivers with adjustable time delays.

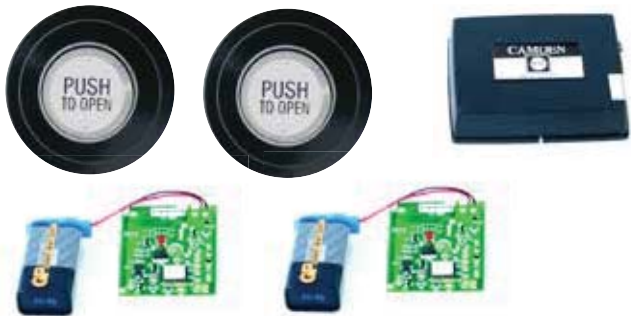

CM-RFP-404

INCLUDES THE FOLLOWING

- 2-EA CM49
- 2-EA CM-TX-7IRM
- 1-EA CM-RX-7

Stocked Product

- CMTX-1 - Hand Hold, One Channel
- CMTX-1M - Key Chain, One Channel
- CMTX-2 - Hand Hold, Two Channel
- CM-RFP404 Kit
- CM-RX-7 Receiver
- CM-RX-7TD One Channel Receiver, 30 Second Adjustable Timer