



**INDEL B S.p.A.**  
**Loc. Cà Baldone**  
**47866 Sant' Agata Feltria (RN) ITALY**  
**Tel.: +39 0541 848 711 - Fax: +39 0541 848 000**  
**[www.indelb.com](http://www.indelb.com)**  
**[indelb@indelb.com](mailto:indelb@indelb.com)**

**KENWORTH SP671-PT1132**  
**(Indel B PN SP671-SP658)**



**INDEX**

**CHAPTER 1: INSTRUCTIONS FOR USE ..... 2**

1.1 GENERAL INFORMATION..... 3

1.2 WIRING SYSTEM ..... 4

1.3 WIRING CONNECTIONS..... 4

1.4 SETTING THE INSIDE TEMPERATURE..... 5

1.5 MAINTENANCE ..... 5

**CHAPTER 2: HOW TO DETECT FUNCTIONAL PROBLEMS AND FIX THEM ..... 6**

2.1 FORM A HOW TO FIX LAMP ..... 8

2.2 PROBLEM: REFRIGERATOR DOES NOT WORK AT ALL / NO COOLING AND NO VIBRATION FROM  
MOTOR/ COMPRESSOR..... 10

2.3 PROBLEM: REFRIGERATOR DOES NOT WORK AT ALL / NO COOLING AND NO VIBRATION FROM  
MOTOR/ COMPRESSOR + FAN DOES NOT WORK..... 11

2.4 PROBLEM: REFRIGERATOR IS NOT COOLING ENOUGH BUT COMPRESSOR RUNS..... 12

2.5 FORM B HOW TO SHORT CIRCUIT THERMOSTAT ON ECU ..... 13

2.6 FORM C HOW TO REPLACE THERMOSTAT..... 14

2.7 FORM D HOW TO REPLACE ECU (ELECTRONIC CONTROL UNIT) ..... 18

2.8 FORM E HOW TO TEST AND REPLACE FAN ..... 19

**CHAPTER 3: HOW TO REPLACE AESTHETICAL PARTS..... 20**

**3.1 PART 1: COMPLETE DRAWER ..... 22**

3.2 PART 2: HANDLE ..... 23

3.3 PART 3: SPACER..... 25

3.4 PART 4: BOTTLE STOPPER..... 26

3.5 PART 5: DRAWER SIDEBOARD ..... 27

3.6 PART 6: SLIDE..... 29

3.7 PART 7: TOP DRAWER ..... 30

3.8 PART 8: BOTTLE RETAINER OF TOP DRAWER ..... 31

3.9 PART 9: UPPER SLIDE..... 32

**CHAPTER 4: SPARE PARTS..... 33**

4.1 COOLING UNIT - SPARE PARTS..... 34

4.2 PT1132-P658 CABINET - SPARE PARTS ..... 35

4.3 NGP-SP671 CABINET - SPARE PARTS..... 36

4.4 SPARE PARTS LIST..... 37

# **CHAPTER 1**

# **INSTRUCTIONS FOR USE**

## 1.1 GENERAL INFORMATION

Indel B refrigerators guarantee performance and reliability.

Provided with a totally hermetic compressor, they offer a minimal power consumption and noise level. All the models are extremely easy to install. They can work even if they are assembled at a slant of up to 30°. In order to make sure that your Indel B refrigerator works as efficiently as possible, please pay attention to the following general instructions:

- Opening the door of the refrigerator uselessly increases the waste of energy;
- Proper ventilation of the compressor and of the condenser unit reduces the energy consumption and also ensures the yield;
- The wiring system of the vehicle is in proper condition. Routinely check the batteries and the charge level. Follow the instructions about the cable cross sections and the fuse connections strictly;
- Keep the inside of the refrigerator clean and dry. Remove any condensate water which might gather in the tray under the freezer compartment;
- Keep the door of the refrigerator slightly open in order to air it out if you do not use it for a long time, for example in winter.

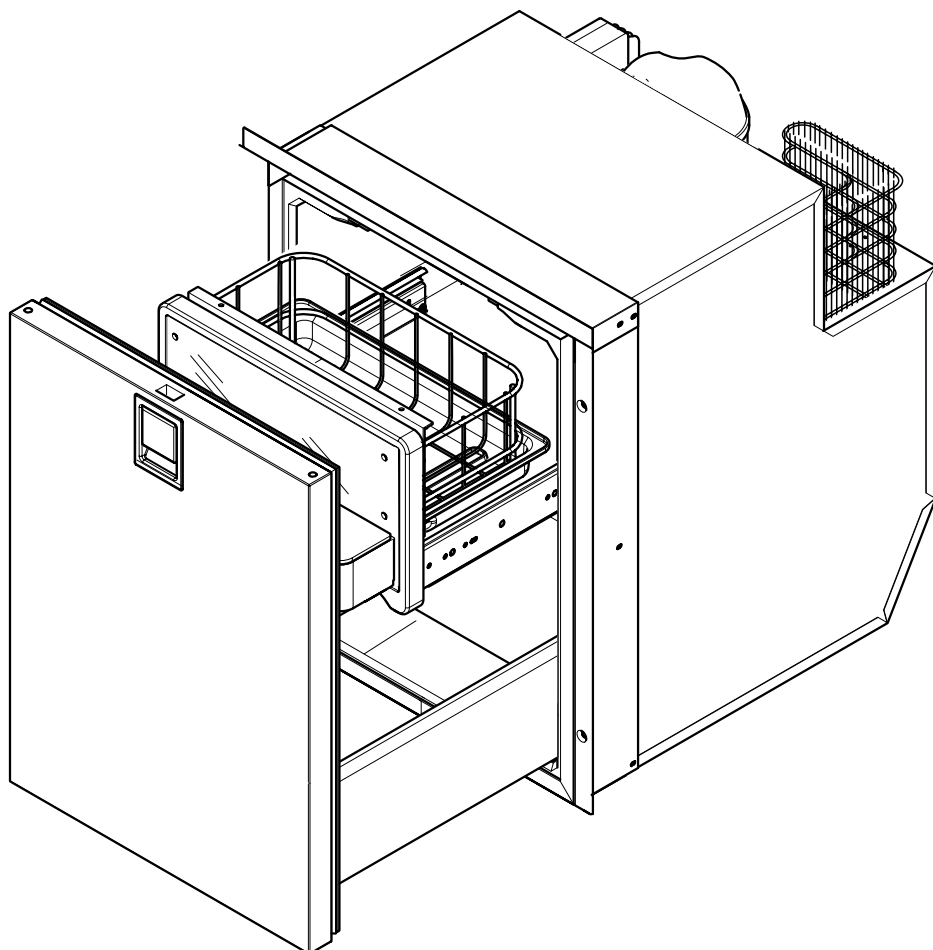

The refrigerators of the DRAWER type are pre-set for being assembled in a niche. Fastening can be done on the front frame.

It is very important for the refrigerating unit, consisting of the compressor and the condenser, to be well ventilated, with the cool air coming in from the bottom and going out from the top. You must ensure proper ventilation of the refrigerating unit.

## 1.2 WIRING SYSTEM

To have the refrigerator operate with the vehicle battery, please refer to the instruction manual of the vehicle's manufacturer.

### WIRING SYSTEM: FUNCTIONS AND FEATURES (WITH AUXILIARY BATTERY)

The electronic unit of the compressor is an electronic equipment which pilots the motor of the compressor and carries out all the controls and electrical protection of the system. Its main features are the following:

- Protection of the battery with automatic turning off of the compressor when the feeding voltage reaches the minimum threshold (cut out)
- The compressor will start up automatically again when the voltage goes back to normal values (cut in).

TABLE FOR BATTERY SAVER TRIPPING VOLTAGES

FEEDING	CUT OUT	CUT IN
12V	9,5V	11V

## 1.3 WIRING CONNECTIONS

When you connect the refrigerator, you must remember the following:

- 1) Use cables having the proper cross section (see table) to make the feeding lines. If possible, such cables should be without any joints on the leads which could lead to voltage drops.
- 2) If the wiring system of the vehicle is insufficient or not properly sized for the refrigerator, connect it directly to the battery without using intermediate wiring.
- 3) Any switches must have a breaking load not less than 20 A
- 4) Make sure the polarity is right: connect the red cable to the positive terminal (+) and the black cable to the negative terminal (-).
- 5) Protect the feeding line with a 15 A fuse.

CROSS SECTION CABLES mm <sup>2</sup>	Maximum lenght of cables in metres
	12V
2,5 (13 AWG)	2,5 (8 ft)
4 (11 AWG)	4 (13 ft)
6 (9 AWG)	6 (20 ft)
10 (7 AWG)	10 (33 ft)



### Warning

Never connect bare electric wires, and use only connectors of a size suitable to the cross section of the cable being used.

## 1.4 SETTING THE INSIDE TEMPERATURE

The refrigerators are provided with a manual thermostat. Turn it clockwise to lower the temperature, and turn it counterclockwise to raise the temperature and activate the ON-OFF switch in its end position. The knob of the thermostat is located inside the refrigerator, on the right side.

### 1.4.1 DEFROSTING

Defrosting must be carried out when the ice layer is thicker than 4 mm.

Set the thermostat at the OFF position. While defrosting, keep food and beverages in a cool place. Do not use any sharp metal object to remove the ice or frost. Do not start the refrigerator up again until it is completely defrosted and dry. Also empty the main tray.

## 1.5 MAINTENANCE



### Warning

Before every maintenance operation, disconnect the power supply from the electric outlet. In case of refrigerator wrong operation, contact the Indel B Service Center.

### 1.5.1 CLEANING

Periodically clean the inside of the refrigerator using sodium carbonate dissolved in lukewarm water. Avoid using abrasive products, cleaners or soaps. After cleaning, rinse with fresh water and dry with care. When you are not using the refrigerator, clean and dry its inside to prevent mould and bad smells formation.



### Warning

Do NOT wash the refrigerator drawers and parts in a Dishwasher.

## 1.6 USEFUL ADVICES

If the refrigerator does not work, or if it works wrongly, before referring to our after sales service (Customer Care Dept- Indel B North America - ph 502-863-0397), make sure that:

- a) power is not missing.
- b) the voltage which reaches the station is equal to the one shown on the plate.
- c) the connections are correctly made.
- d) the ventilation grids are not obstructed.
- e) the refrigerating unit is not near a source of heat.
- f) the fuse mounted on the feeding line is not blown.

1st - If nothing is running or only fan is running, using a volt meter on 20v DC setting, check voltage at fridge with truck off and fridge off . What is voltage? Turn fridge on and see if voltage drops below 11 volts. If yes, there is most likely a wiring issue with the truck. If no, proceed to next step (for details go to Chapter 2 "How to detect functional problems and fix them")

2nd - If fan does not run, bypass thermostat wires on ECU terminal C to T. If fan now runs, also check if compressor is now running and if yes replace thermostat.

3rd - If fan runs and compressor does not, change ECU and check if compressor is now running.



### Warning

the power cable must be replaced only by qualified technical personnel and, in any case, by a service authorized by the manufacturer.

INDEL B disclaims any responsibility if the above instructions and conditions are disattended or not met.

# **CHAPTER 2**

## **HOW TO DETECT FUNCTIONAL PROBLEMS AND FIX THEM**





## 2.1 FORM A HOW TO FIX LAMP

Time: 36 minutes



Switch (2 screws to unfix)



Wires to short circuit for test



New switch

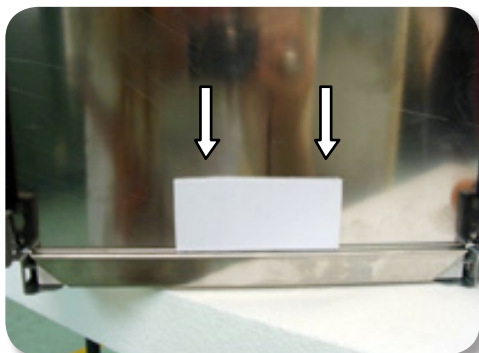

**Attention!** Before installing again the drawer check if the switch stopper is rightly assembled on the back of the drawer.

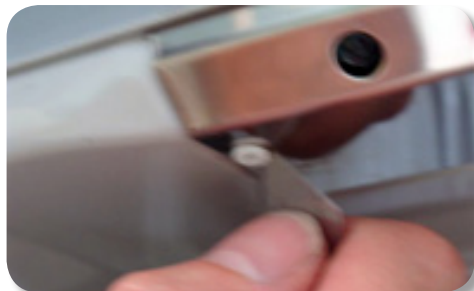

Lamp protection: remove the plastic bushes and pivots with the help of a flat blade (2 rivets and 2 bushes)

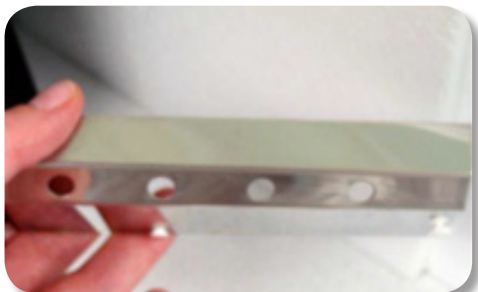

Lamp protection is removed and electronic board with led is now accessible for test



Remove electronic board pulling it out from one side and then from the other

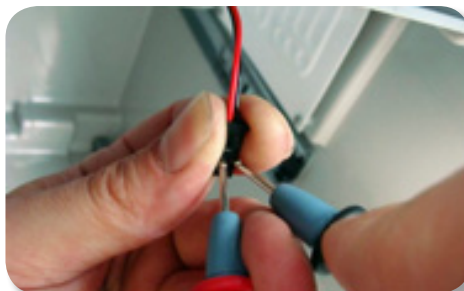

Use a multimeter to check if there is continuity from wires

## 2.2 PROBLEM: REFRIGERATOR DOES NOT WORK AT ALL / NO COOLING AND NO VIBRATION FROM MOTOR/ COMPRESSOR

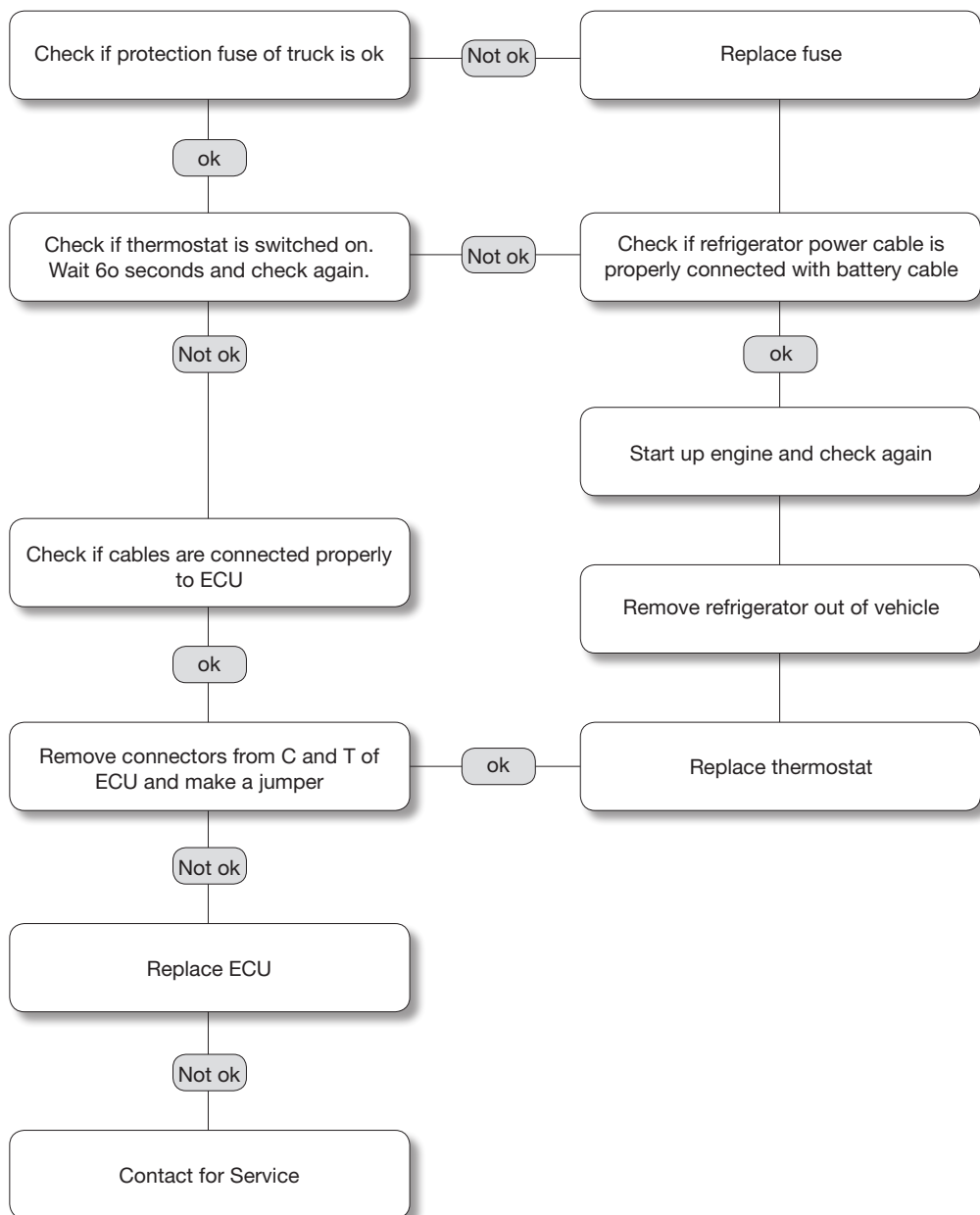

**2.3 PROBLEM: REFRIGERATOR DOES NOT WORK AT ALL / NO COOLING AND NO VIBRATION FROM MOTOR/ COMPRESSOR + FAN DOES NOT WORK**

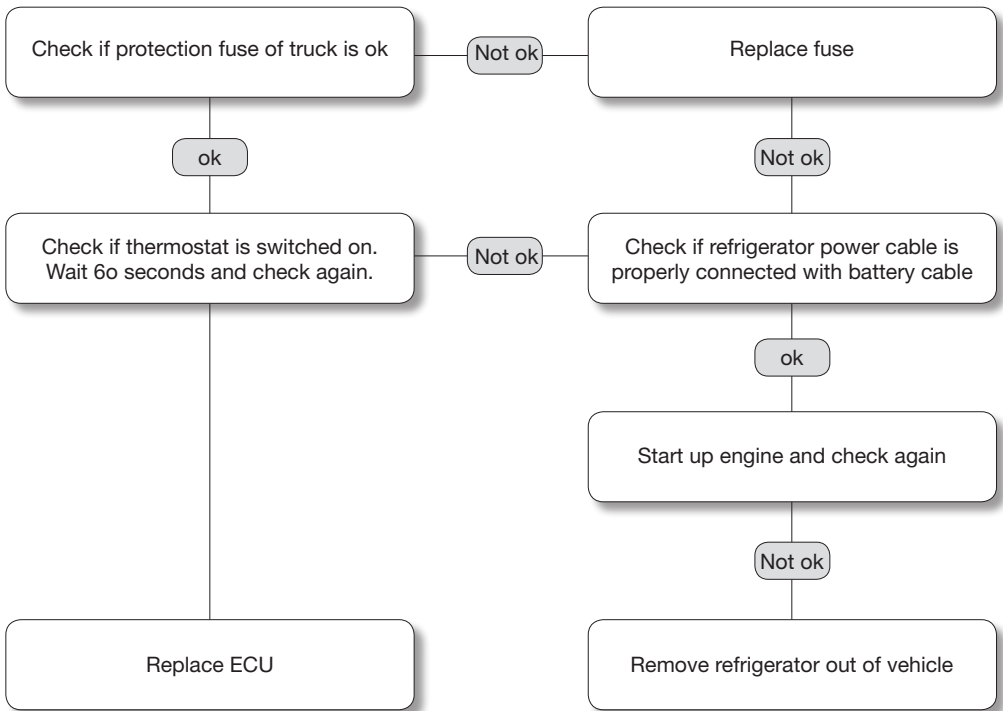

## 2.4 PROBLEM: REFRIGERATOR IS NOT COOLING ENOUGH BUT COMPRESSOR RUNS

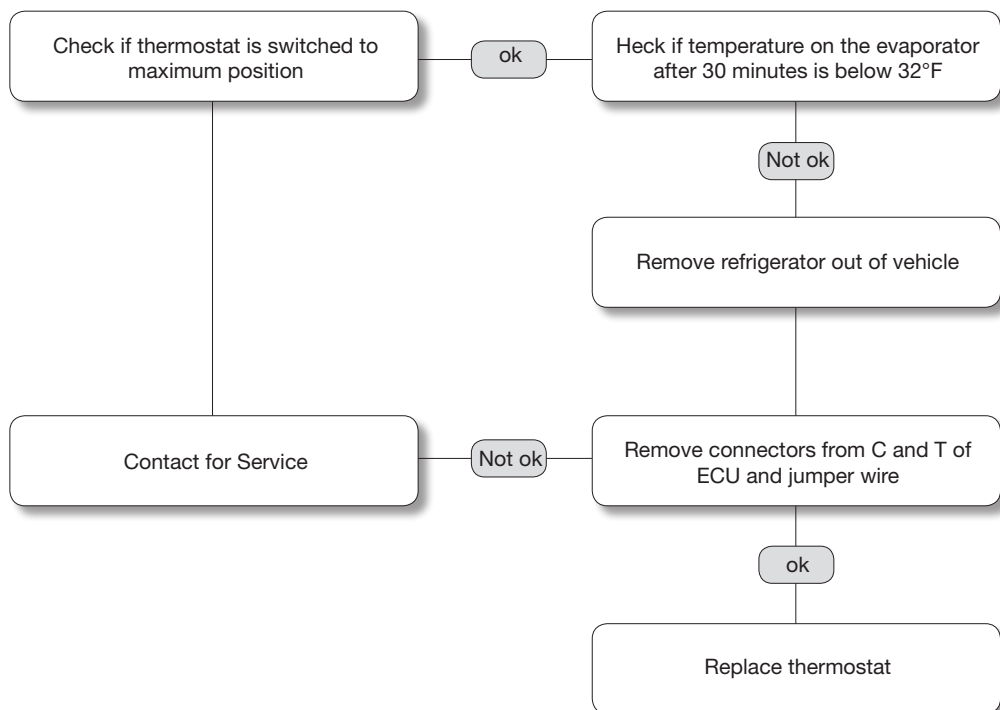

**2.5 FORM B HOW TO SHORT CIRCUIT THERMOSTAT ON ECU**

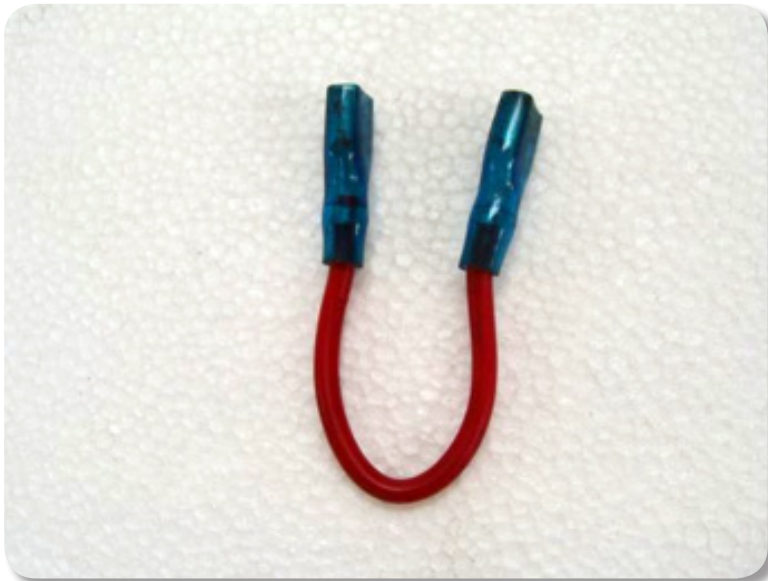
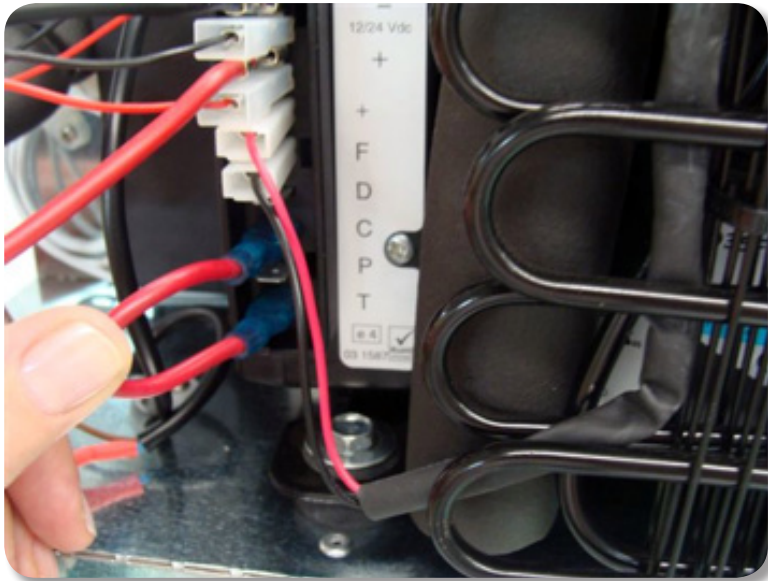

Jumper wire example



## 2.6 FORM C HOW TO REPLACE THERMOSTAT

*Time: 55 minutes*



Open the fridge, remove the drawer and pull out the thermostat knob



Unscrew evaporator from cabinet





After having unscrewed evaporator, the sensor of thermostat will be accessible



Work on the back side of the refrigerator and remove the rubber grey protection around the pipe of thermostat and evaporator sensor



Unscrew the plastic ring fixing the thermostat sensor



Pull out the sensor

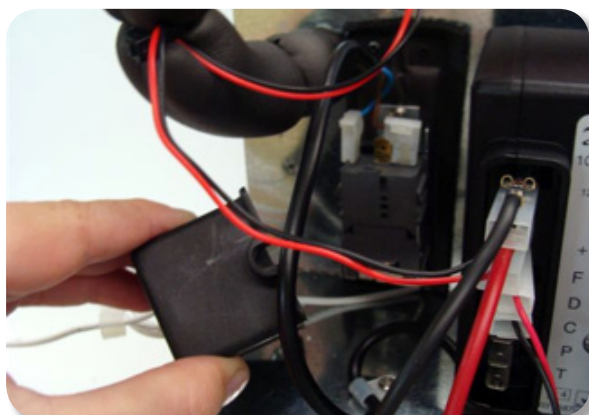
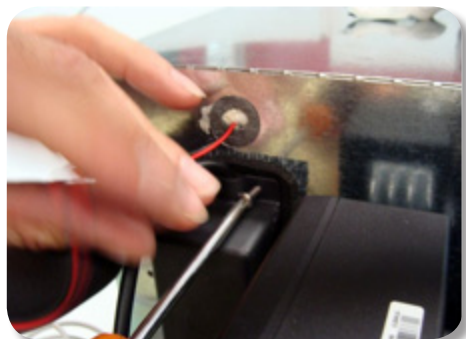

*Unscrew the cover of thermostat*

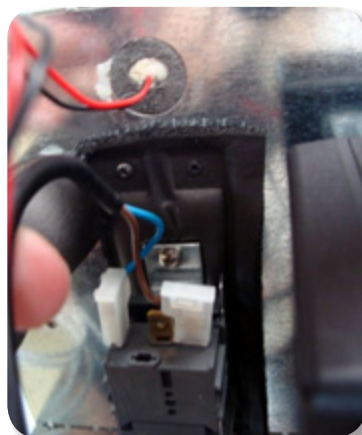

Unscrew the thermostat and disconnect the two wires from it (blue and brown).  
Reverse the procedure to install the thermostat

## 2.7 FORM D HOW TO REPLACE ECU (ELECTRONIC CONTROL UNIT)

Time: 33 minutes

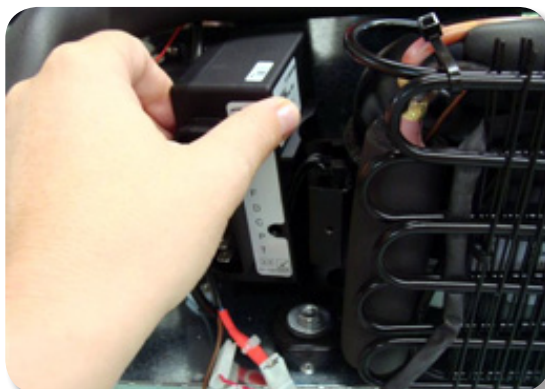
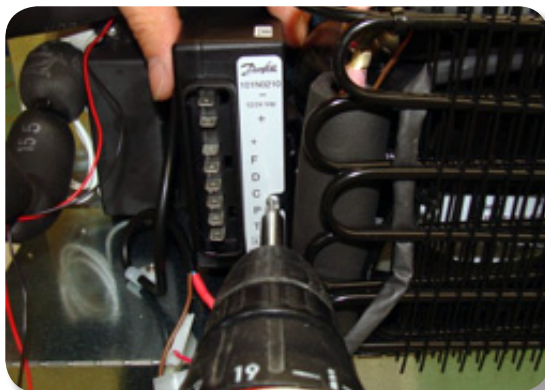

Disconnect all wires from ECU, unscrew it (one screw) and with the help of a screwdriver push the connector towards left side. Reverse the procedure to install the new ECU.

## 2.8 FORM E HOW TO TEST AND REPLACE FAN

Time: 32 minutes

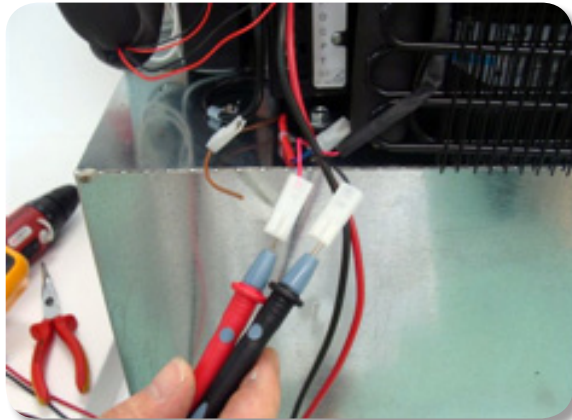

Disconnect wires of fan from + and F of the ECU and check if there is continuity. If not replace fan.



Cut the four black plastic strips holding the fan to the condenser



Remove the fan from condenser and reverse the procedure to install the new one



# **CHAPTER 3**

## **HOW TO REPLACE AESTHETICAL PARTS**



### 3.1 PART 1: COMPLETE DRAWER

**Description of operations:** pull out the drawer until 1 inch from stop of rails, lift it up. The drawer is now free and can be replaced with the new one reversing the procedure.

*Time: 1 minute*





## **3.2 PART 2: HANDLE**

**Description of operations:** lift up the handle and unscrew it (2 screws). Take the handle off from the bottom. Reverse the procedure to install the new handle.

*Time: 2 minutes*





### 3.3 PART 3: SPACER

**Description of operations:** Take the spacer and rotate it 30° to release.

Reverse the procedure to install the new spacer.

*Time: 30 seconds*

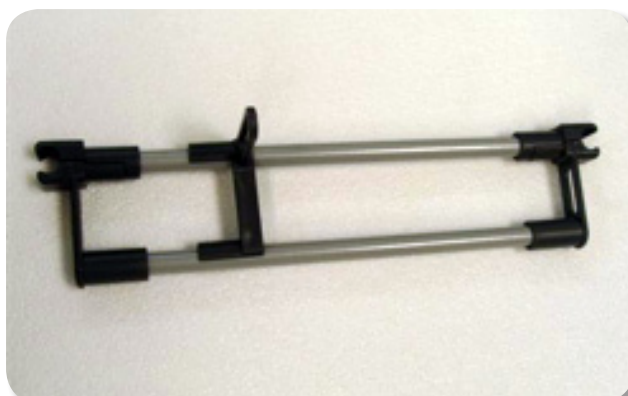

### 3.4 PART 4: BOTTLE STOPPER

**Description of operations:** Take off the bottle stopper and lift it to release.  
Reverse the procedure to install the new bottle stopper.

*Time: 30 seconds*

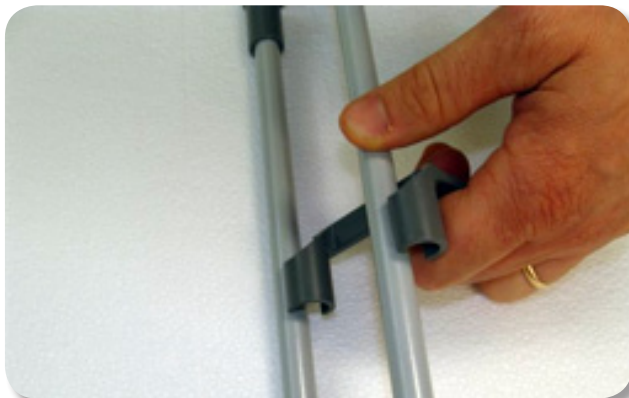
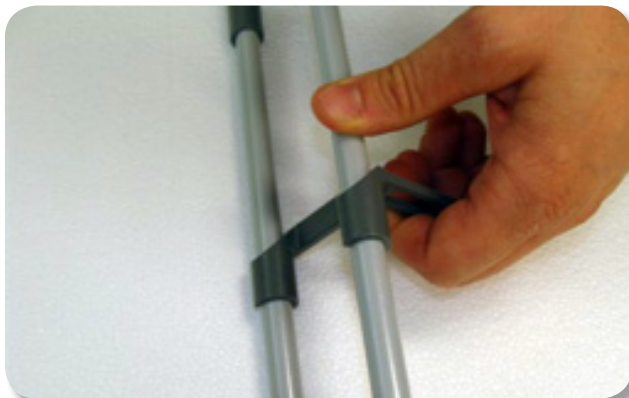

### 3.5 PART 5: DRAWER SIDEBOARD

**Description of operations:** On the backside of the drawer, turn the screw toward the outside of the sideboard with the help of a screwdriver (picture A and B). To uninstal it from the inner front side turn the sideboard in counter clockwise (picture C and D). To install the new sideboard put in line the plastic end of the back wall of the drawer (picture E) and use the original screw attaching the inner front panel of the drawer (picture F).

*Time: 6 minutes*

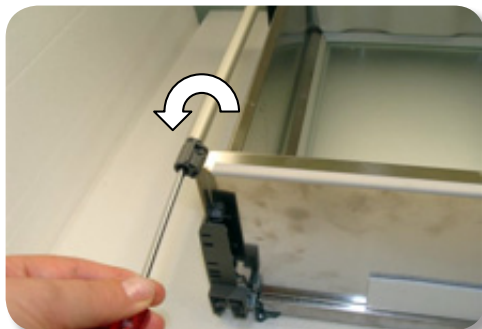
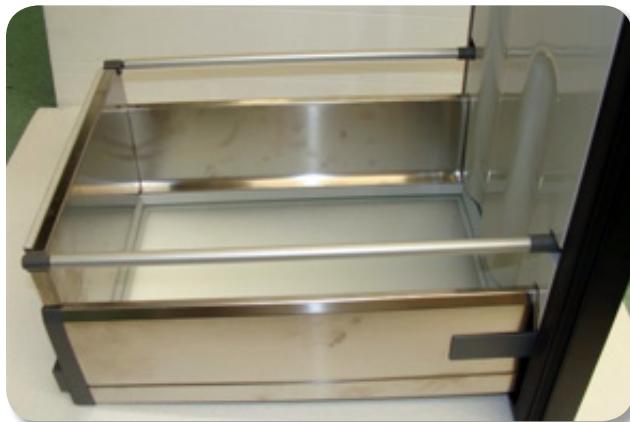

A

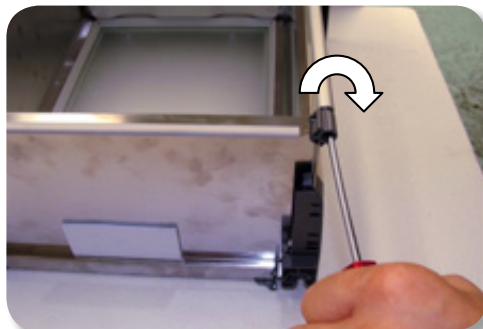

B



C



D



E

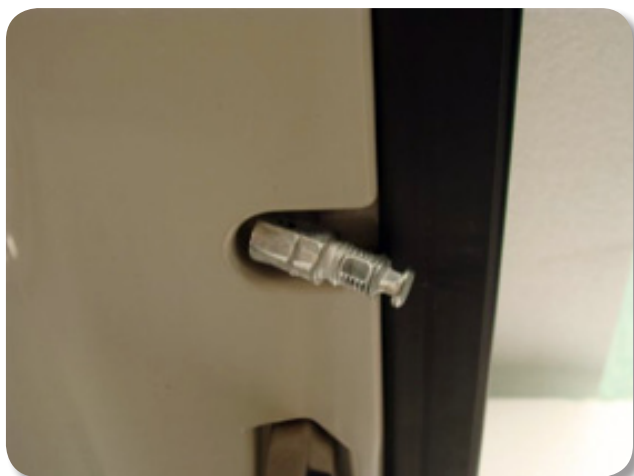

F

### 3.6 PART 6: SLIDE

**Description of operations:** remove the drawer and pull out the slide system. Unscrew the fixed part of the sliding system (3 screws – picture G). To install the new slide, placing it on the plastic inner body of the cabinet ( picture H). Start to attach it from the last screw towards the back wall of the cabinet, working forward.

*Time: 3,5 minutes*

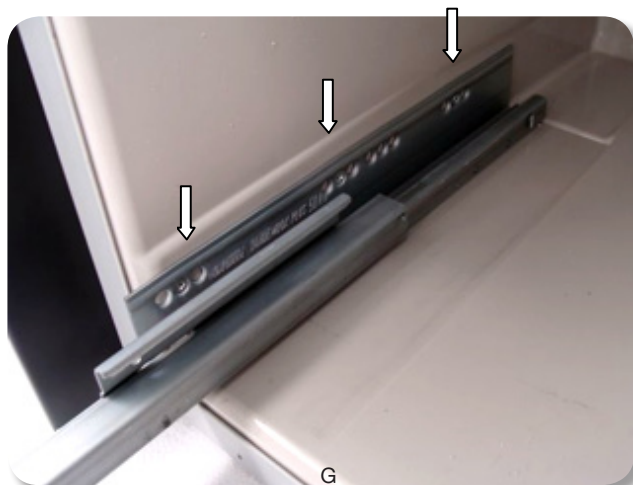



### 3.7 PART 7: TOP DRAWER

**Description of operations.** Pull out the drawer. To unfix the drawer work on the slide and the lift up the lever on the right slide and lift down the lever on the left slide. To install the new top drawer fix it firstly on one slide and after on the other.

*Time: 1,5 minutes*





### **3.8 PART 8: BOTTLE RETAINER OF TOP DRAWER**

**Description of operations.** Lift up the bottle retainer on the two sides to let it free from its stoppers.

*Time: 15 seconds*

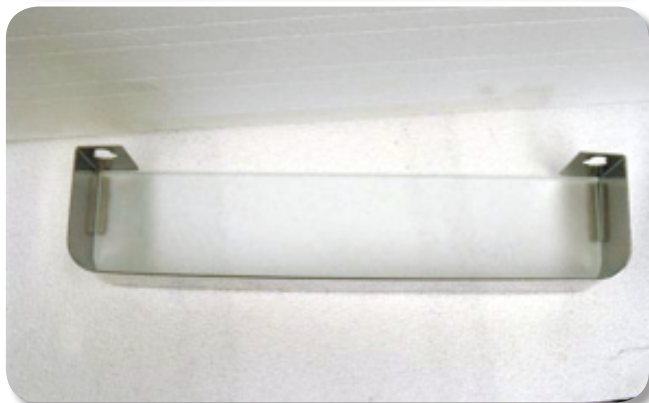
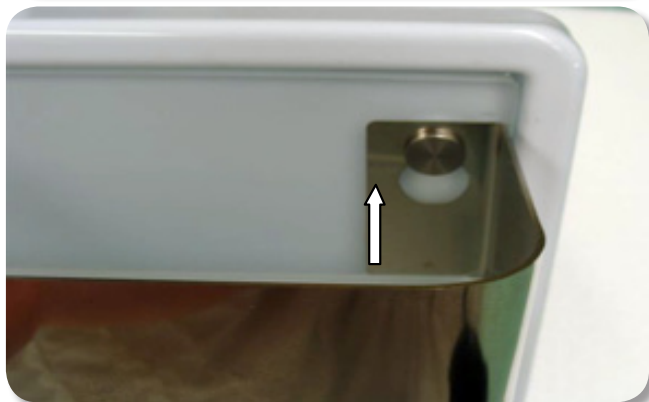

### 3.9 PART 9: UPPER SLIDE

**Description of operations:** remove the drawer and pull out the slide system. Unscrew the fixed part of the sliding system (3 screws). To install the new slide, placing it touching its housing on the plastic inner body of the cabinet Start to attach it from the last screw towards the back wall of the cabinet (picture I), working forward.

*Time: 3,5 minutes*

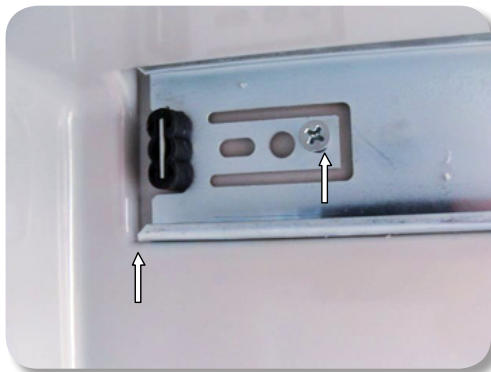
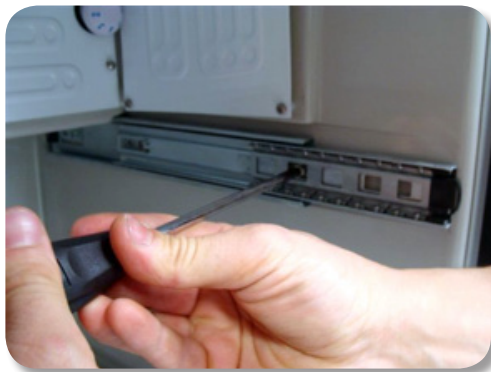

I



# **CHAPTER 4**

# **SPARE PARTS**

Rev. 08/2012

**SPARE PARTS**

**KENWORTH SP671 - PT1132 (Indel B PN SP671 - SP658) - COOLING UNIT**

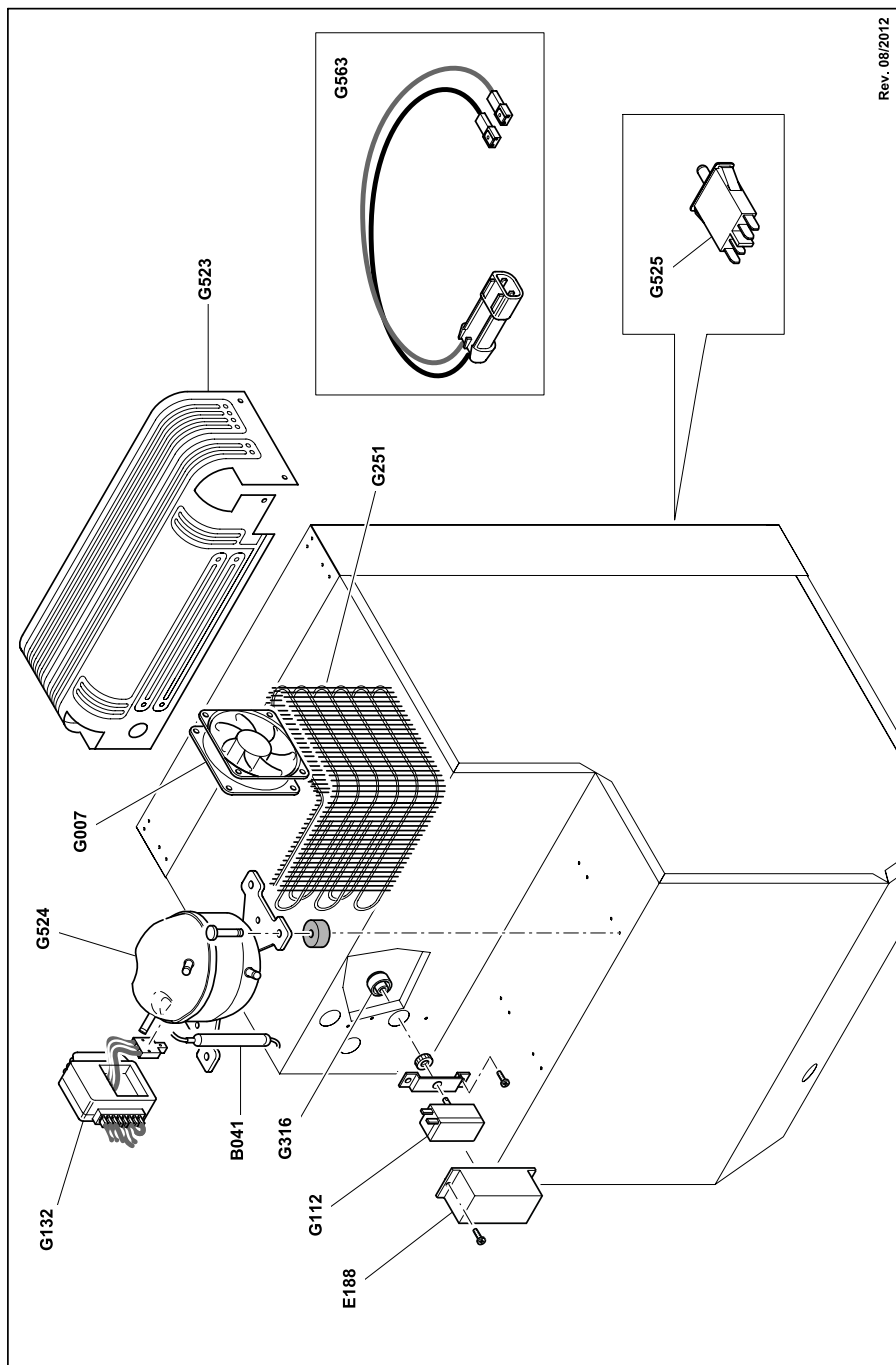

Rev. 08/2012

SPARE PARTS

KENWORTH PT1132 (Indel B PN SP658) - CABINET

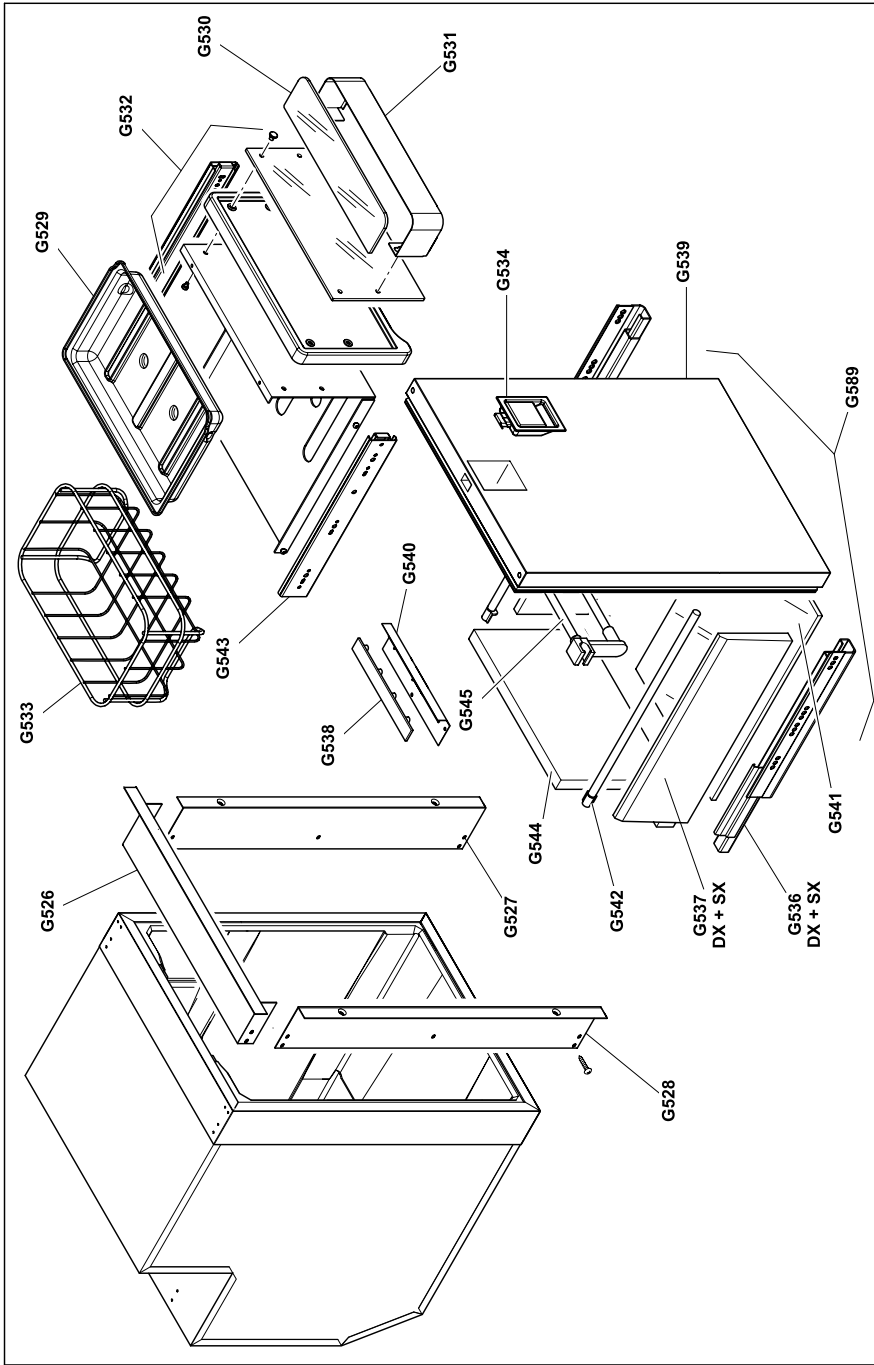

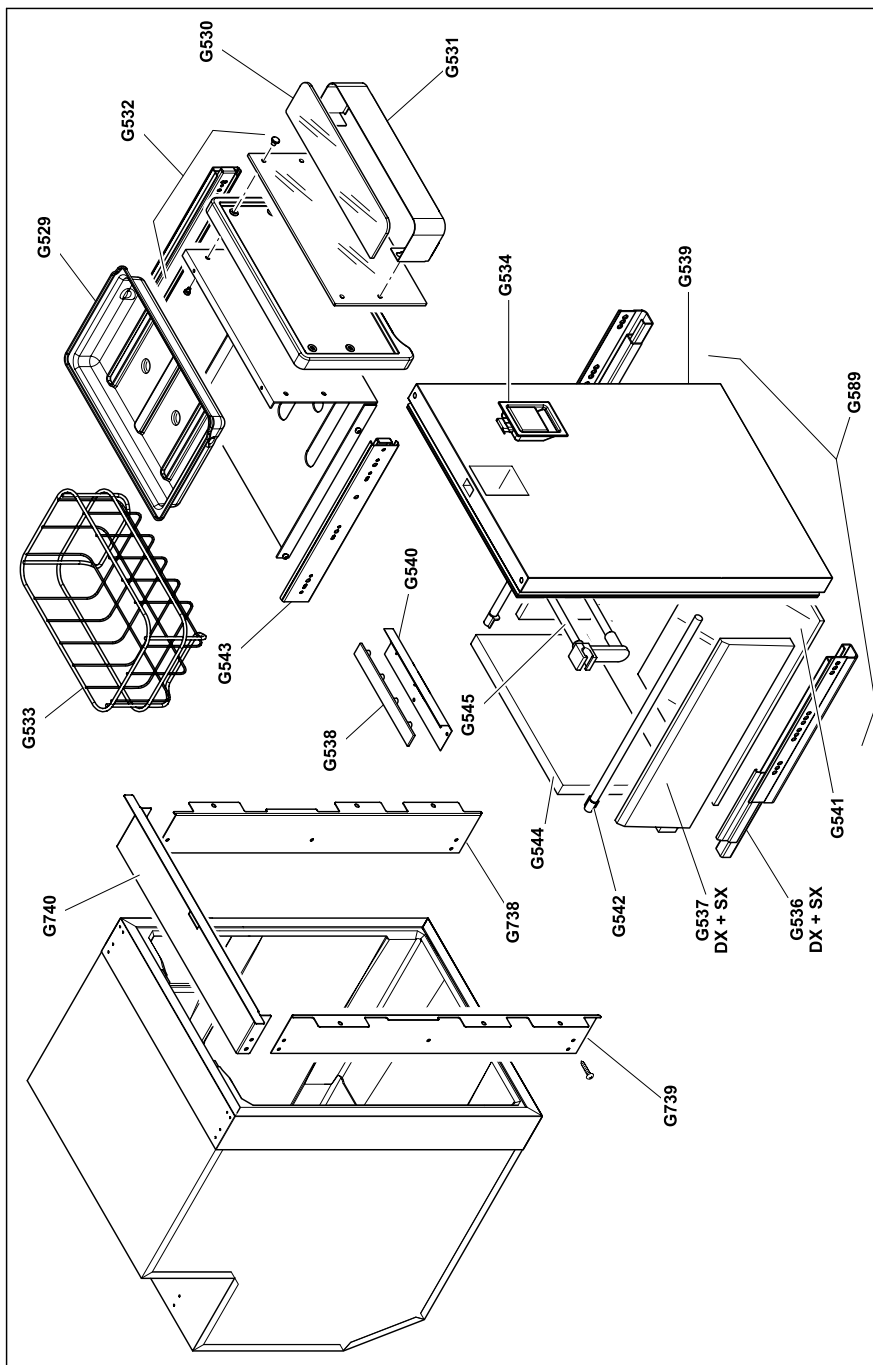

Rev. 08/2012

SPARE PARTS

KENWORTH SP671 (Indel B PN SP671) - CABINET

## 4.4 SPARE PARTS LIST

<b>B041</b>	FILTER
<b>E188</b>	THERMOSTAT BOX
<b>G007</b>	FAN
<b>G112</b>	THERMOSTAT
<b>G132</b>	ECU
<b>G251</b>	CONDENSER
<b>G316</b>	THERMOSTAT KNOB
<b>G523</b>	EVAPORATOR
<b>G524</b>	COMPRESSOR
<b>G525</b>	LAMP SWITCH
<b>G526</b>	TOP FRAME
<b>G527</b>	RIGHT FRAME
<b>G528</b>	LEFT FRAME
<b>G529</b>	DRIP TRAY
<b>G530</b>	GLASS OF BOTTLE HOLDER
<b>G531</b>	BOTTLE HOLDER
<b>G532</b>	KIT FREEZER DRAWER

<b>G533</b>	FREEZER BASKET
<b>G534</b>	COMPLETE HANDLE
<b>G536</b>	SLIDING HINGE OF THE DRAWER
<b>G537</b>	SLIDING HINGE OF THE FRIDGE
<b>G538</b>	LED LAMP
<b>G539</b>	DOOR
<b>G540</b>	LAMP PROTECTION
<b>G541</b>	GLASS SHELF
<b>G542</b>	BARS
<b>G544</b>	INNER PANEL
<b>G545</b>	LOWER DRAWER SPACER
<b>G563</b>	POWER SUPPLY CABLE
<b>G589</b>	COMPLETE DRAWER
<b>G738</b>	RIGHT FRAME
<b>G739</b>	LEFT FRAME
<b>G740</b>	TOP FRAME