

Model 3014 Stacking Banana Plug To Miniature Stacking Banana Plug

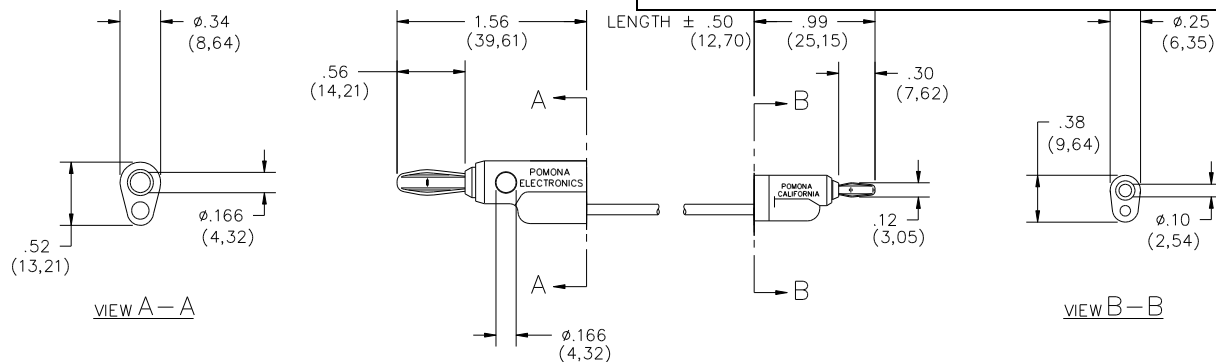

FEATURES:

- Converts a standard Banana Jack to a Mini Banana Plug or converts a Mini Banana Jack to a standard Banana Plug.
- Cross stacking type Banana Jack, vertical stacking Banana and Mini Banana Plug.

MATERIALS:

Conn: Stacking Banana Plug

Material: Spring, Beryllium Copper per QQ-C-533, Alloy 172, Cond. HT.

Plug Body – Brass per QQ-B-626, Alloy 360, ½ Hard.

Finish: Nickel plated per QQ-N-290, Class 2, 200/300 microinches.

Insulation: Polypropylene molded to plug body and wire. Color matches color of wire.

Marking: “POMONA ELECTRONICS POMONA CALIFORNIA.”

Wire: 20 AWG, stranding 41 x 36 t.c., PVC insulated, 2.1 (.087) O.D.

Color: See Ordering Information.

Marking: “POMONA 3014-XX-*”

Conn: Miniature Stacking Banana Plug

Material: Spring - Beryllium Copper per QQ-C-533, Alloy 172, Cond. HT.

Plug Body – Brass per QQ-B-626, Alloy 360, ½ Hard.

Finish: Gold plated per MIL-G-45204, Type II, Class 00 over electroless nickel

Insulation: Polypropylene molded to plug body and wire. Color matches color of wire.

Marking: “POMONA ELECTRONICS POMONA CALIFORNIA.”

RATINGS:

Operating Temperature: + 55°C. (+131°F.) Max.

Operating Voltage: Hand-held testing: 30VAC/60VDC Max.

Hands free testing in controlled voltage environments: 3000 WVDC Max.

Current: 5 Amperes

ORDERING INFORMATION: Model 3014-XX-*

XX = Cable Lengths, Standard Lengths. 36” (914), & 60” (1524).

Additional lengths and colors can be quoted upon request. *= Color, -0 Black, -2 Red.

All dimensions are in inches. Tolerances (except noted): .xx = ±.02” (.51 mm), .xxx = ± .005” (.127 mm).

All specifications are to the latest revisions. Specifications are subject to change without notice.

Registered trademarks are the property of their respective companies. Made in USA

Mouser Electronics

Authorized Distributor

Click to View Pricing, Inventory, Delivery & Lifecycle Information:

Pomona:

[3014-60-0](#) [3014-60-2](#) [3014-36-2](#) [3014-36-0](#)